

# TOOLING & MACHINERY SOLUTIONS FOR FOUNDRIES

# AHB

TOOLING & MACHINERY

COMPLETE METALWORKING SOLUTIONS

(800) 991-4225

[www.ahbinc.com](http://www.ahbinc.com)

ISO Certified

[customerservice@ahbinc.com](mailto:customerservice@ahbinc.com)

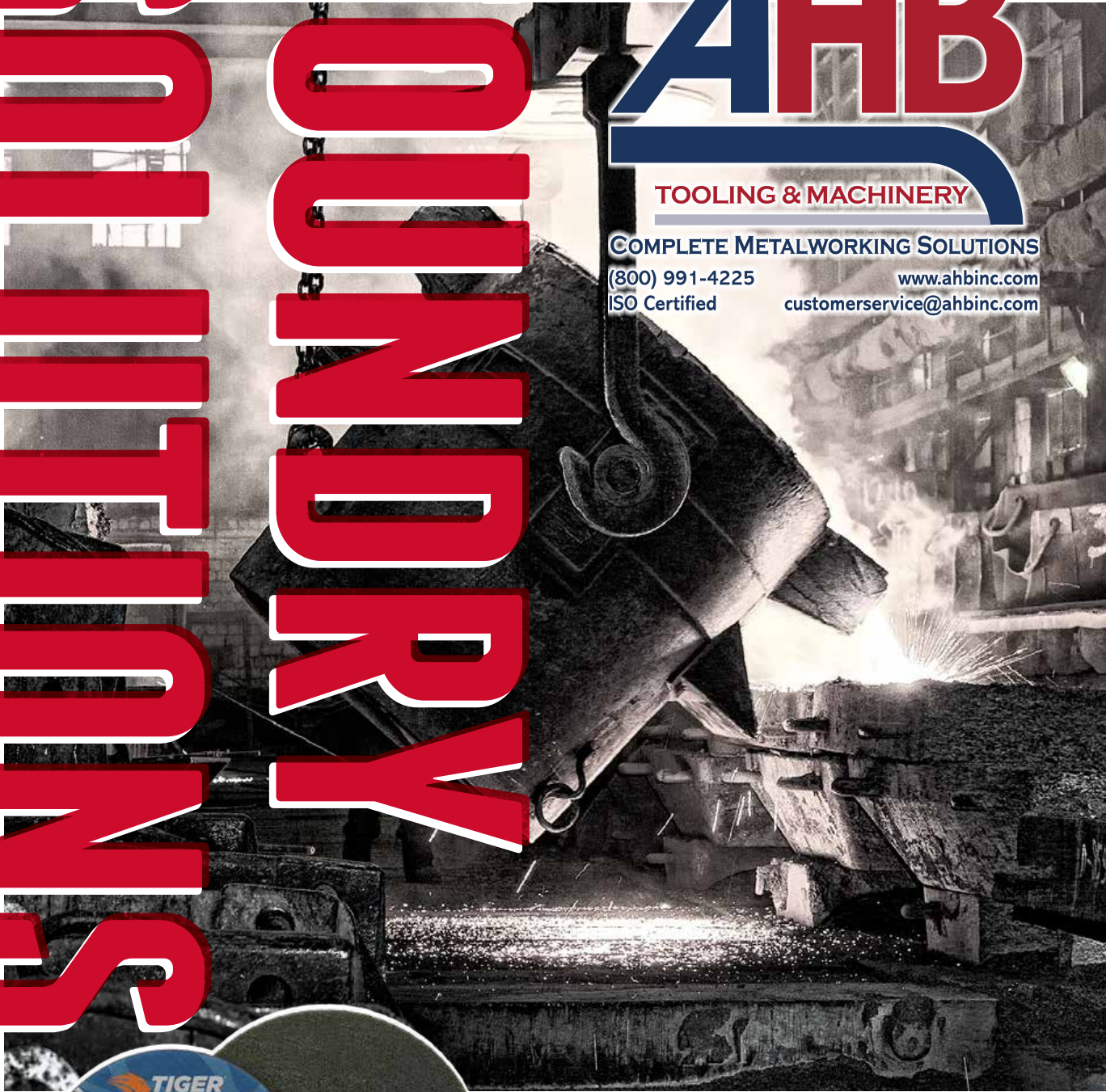

*Abrasives designed to deliver maximum performance in foundry applications.*



# JOIN THE NEXT **REVOLUTION** IN FOUNDRY GRINDING

The finishing process in foundries is a tough job. For decades, abrasives technology for off-hand grinding has remained unchanged. It's time for improvement, faster grinding rates, decreased cycle times and an improved operator experience. It's time for a revolution.

As an industry leader and global manufacturer of surface conditioning solutions, Weiler Abrasives is driven to help you overcome the toughest cleaning, grinding, cutting, deburring and finishing challenges. That's why we created a line of abrasives specifically designed to deliver maximum performance in foundry applications. From gate removal to id-cleaning, Weiler offers the right product solutions and expertise to help you find production and process efficiencies in your cleaning room.

Weiler Foundry Products — A **REVOLUTION** in foundry grinding.

## WE PROVIDE VALUE THROUGH:

- ▶ *Ground Breaking Abrasive Technology For Foundry Applications*
- ▶ *Enhanced Safety Features*
- ▶ *Improved Operator Experience*
- ▶ *Expert Abrasives On-Site Technical Support*
- ▶ *Product Available When You Need It*
- ▶ *Custom Engineered Solutions*
- ▶ *Maximum Productivity*
- ▶ *Lowest Cost Of Use*





# CUSTOMER PROGRAMS

For those who value safety and productivity-enhancing solutions for the toughest cutting, grinding, deburring, cleaning and finishing challenges, Weiler Abrasives provides the programs to help you gain a competitive edge.

## CONSUMABLE PRODUCTIVITY PROGRAM

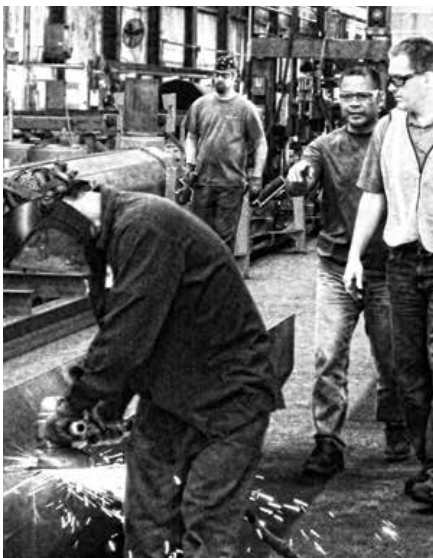

This program helps facilities find real cost savings. By conducting real-world testing and collecting hard data, we evaluate products to select abrasives that will reduce cycle times, save dollars and guarantee better results.

**WCP**

## SPOT SAFETY PROGRAM



We offer customers a Safety Training Program based on SPOT (Speed & Size, Pressure, Orientation, Time) to promote safe and proper product usage. Deploying our safety training program in your facility helps improve safety regardless of your application or work environment.

**THINK  
SPOT.**

## ENGINEERED PRODUCTS & CUSTOM SOLUTIONS



We understand that every production operation is different, so is every production challenge. One solution does not fit all.

Weiler experts can examine your specific production and product challenges and develop customized solutions that optimize your operation.

- Custom-engineered products to meet the demands of a specific application
- On-site or lab evaluations at no charge to solve complex problems

Talk to your local Weiler Representative or call us at 800.835.9999 to **learn more** about these programs.

# TYPE 11 FLARING CUP WHEELS



Weiler Tiger® type 11 flaring cup grinding wheels deliver the next evolution in technology for portable foundry grinding. From Tiger Ceramic, which provides superior productivity, to Tiger SiC for castings with burnt-in sand, our line offers the performance you need to get the job done fast. Tiger Ceramic sets a new standard for performance, delivering up to **30% faster cut-rate** compared to competitive zirconia cups. This faster material removal translates to better productivity in the cleaning room and less operator fatigue.



*Specifically designed with performance, safety and versatility in mind, Weiler cup wheels are:*

- Precision balanced to ensure smooth, **vibration-free operation** and reduced operator fatigue.
- Unique anchored safety nut locks the cup in place to **increase safety** and prevent product breakage.
- Zinc plated 5/8"-11 nut prevents oxidation, **eliminating contamination** and allows for easy spin-on, spin-off changeover.

**CUP APPLICATIONS:** Ideal for heavy metal removal, grinding, transitioning, rough beveling and removing cracks/flaws.

## ANCHORED NUT INCREASES SAFETY

Our testing shows that the Weiler anchored safety nut outperformed the industry standard metal back:

- **Up to 3X higher torque** holding strength
- **Double speed burst testing ratings**

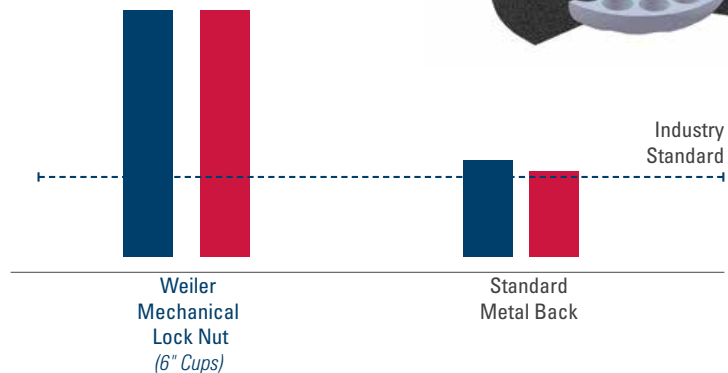
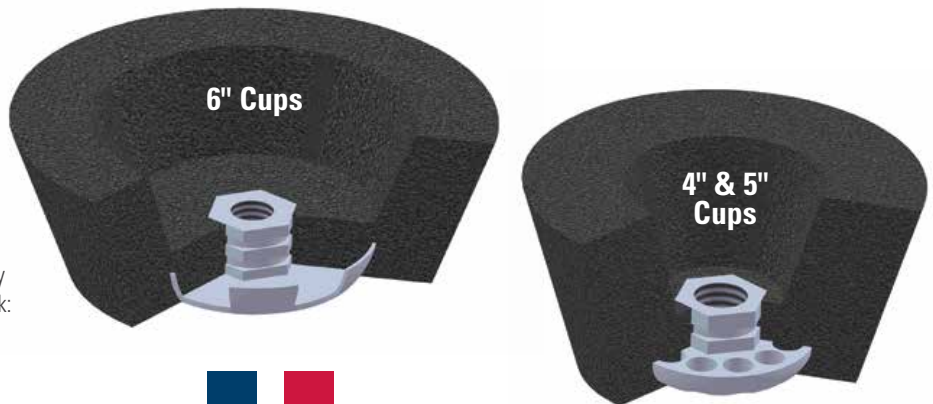

# PRODUCT SELECTION

Designed for use on medium to high power pneumatic and high frequency electric grinders.



## MAX PERFORMANCE SUPERIOR LIFE & CUT



### TIGER CERAMIC

Self-sharpening ceramic alumina grains provide ultra-high metal removal rates and optimal productivity.

#### BEST ON

- CAST IRON**   **DUCTILE IRON**
- CAST STEEL**   **HARD-TO-GRIND**

white iron, gray iron, high nickel alloy and stainless steel

## HIGH PERFORMANCE FAST CUT & LONG LIFE



### TIGER ZIRC

Sharp and durable zirconia alumina grains provide fast and consistent metal removal rates throughout the life of the abrasive.

#### BEST ON

- CAST IRON**   **DUCTILE IRON**
- CAST STEEL**

white iron, gray iron, high nickel alloy and stainless steel

## PERFORMANCE LONG LIFE



### TIGER SiC

Silicon carbide grains provide a consistent, controlled cut-rate on sand castings with burnt-in sand.

#### BEST ON

- BURNT IN SAND**

### TIGER AO

Aluminum oxide grains provide an even, sharp, clean cut-rate and consistent performance.

#### BEST ON

- CAST IRON**

ductile iron, carbon steel and stainless steel

### Type 11 Cup

0 - 15°  
for optimal  
performance



### RIM (W) WIDTH OPTIONS

- 1-1/2" RIM** | Large grinding zone to minimize grind time
- 1" RIM** | Medium grinding zone for maximum material removal in targeted areas
- 3/4" RIM** | Ideal for targeted material removal in small, hard-to-access areas

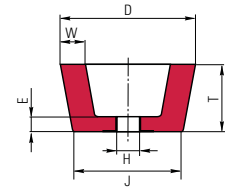

## MAX PERFORMANCE GRINDING

CAST IRON	DUCTILE IRON	CAST STEEL	HARD-TO-GRIND	TIGER CERAMIC / Superior Life & Cut				
Diameter (D / J)	Thickness (T)	Arbor (H)	Rim (W)	Back (E)	Grade	Max. RPM	Std. Pack	Item #
6" / 4-3/4"	2"	5/8"-11	1-1/2"	3/4"	HZA16Q	6,000	5	68400

## HIGH PERFORMANCE GRINDING

CAST IRON	DUCTILE IRON	CAST STEEL	TIGER ZIRC / Fast Cut & Long Life					
Diameter (D / J)	Thickness (T)	Arbor (H)	Rim (W)	Back (E)	Grade	Max. RPM	Std. Pack	Item #
4" / 3"	2"	5/8"-11	3/4"	3/4"	ZA16Q	9,070	5	68352
5" / 3-3/4"	2"	5/8"-11	1"	3/4"	ZA16Q	7,260	5	68355
6" / 4-3/4"	2"	5/8"-11	1"	3/4"	ZA16Q	6,000	5	68358
6" / 4-3/4"	2"	5/8"-11	1-1/2"	3/4"	ZAC16Q	6,000	5	68361+
6" / 4-3/4"	2"	5/8"-11	1-1/2"	3/4"	ZA16R	6,000	5	68362
6" / 4-3/4"	2"	5/8"-11	1-1/2"	3/4"	ZA16Q	6,000	5	68364

## PERFORMANCE GRINDING

BURNT IN SAND	TIGER SiC / Long Life							
Diameter (D / J)	Thickness (T)	Arbor (H)	Rim (W)	Back (E)	Grade	Max. RPM	Std. Pack	Item #
4" / 3"	2"	5/8"-11	3/4"	3/4"	C16Q	9,070	5	68351
5" / 3-3/4"	2"	5/8"-11	1"	3/4"	C16Q	7,260	5	68354
6" / 4-3/4"	2"	5/8"-11	1"	3/4"	C16Q	6,000	5	68357
6" / 4-3/4"	2"	5/8"-11	1-1/2"	3/4"	C16Q	6,000	5	68069

CAST IRON	TIGER AO / Long Life							
Diameter (D / J)	Thickness (T)	Arbor (H)	Rim (W)	Back (E)	Grade	Max. RPM	Std. Pack	Item #
4" / 3"	2"	5/8"-11	3/4"	3/4"	A16Q	9,070	5	68350
5" / 3-3/4"	2"	5/8"-11	1"	3/4"	A16Q	7,260	5	68353
6" / 4-3/4"	2"	5/8"-11	1"	3/4"	A16Q	6,000	5	68356
6" / 4-3/4"	2"	5/8"-11	1-1/2"	3/4"	A16Q	6,000	5	68359
6" / 4-3/4"	2"	5/8"-11	1-1/2"	3/4"	AC16Q	6,000	5	68360+

+ Includes silicon carbide for burnt-in sand and hard-to-grind metals.



68400



68352



68354



68356

## FLARING CUP WHEEL MOUNTING FLANGE

Fits over 5/8"-11 spindles

Diameter	Thickness	Std. Pack	Item #
2"	1/4"	1	73054

SAFETY WARNING: Using a flaring cup wheel without the proper flange is a violation of ANSI code.



73054



# TYPE 27 GRINDING WHEELS



Weiler Tiger type 27 grinding wheels deliver the next evolution in technology for portable foundry grinding. The line is available in three performance tiers, including Tiger Ceramic which sets a new standard for maximum performance. The ceramic grain leverages an engineered ultra-fine microstructure that self-sharpen for ultra-fast grinding. This technology allows Tiger Ceramic to remove up to **40% more material** over the life of the wheel compared to competitive zirconia products. This translates to better productivity in the cleaning room and a reduction in abrasives usage.



*Weiler grinding wheels offer several other advantages for the most challenging foundry grinding applications, including:*

- Advanced anti-chipping technology **improves safety** through the reduction of high energy debris emitted during the grinding process.
- 5/8"-11 nipped metal hub allows for **quick spin-on, spin-off changeover** and eliminates cross-threading or sticking to spindle due to heat build-up.
- Triple fiberglass reinforcement for **added strength**.
- 1/8" combination wheels offer **flexibility and efficiency** when switching between cutting and grinding applications.

## ANTI-CHIPPING TECHNOLOGY

eliminates uneven edge breakage and chipping. This technology advancement:

- **Improves operator safety** by reducing flying debris during the grinding process
- **Eliminates the need to dress the wheel** to regain a workable edge
- Provides **longer wheel life** and increased consistency





## MAX PERFORMANCE SUPERIOR CUT & LONG LIFE



### TIGER® CERAMIC

Self-sharpening ceramic alumina grains provide ultra-high metal removal rates and optimal productivity.

#### BEST ON

- CAST IRON**   **DUCTILE IRON**
- CAST STEEL**   **HARD-TO-GRIND**

white iron, gray iron, high nickel alloy and stainless steel

## HIGH PERFORMANCE FAST CUT & LONG LIFE



### TIGER ZIRC

Sharp and durable zirconia alumina grains provide fast and consistent metal removal rates throughout the life of the abrasive.

#### BEST ON

- CAST IRON**   **DUCTILE IRON**
- CAST STEEL**

white iron, gray iron, high nickel alloy and stainless steel

## PERFORMANCE LONG LIFE



### TIGER AO

Aluminum oxide grains provide an even, sharp, clean cut-rate and consistent performance.

#### BEST ON

- CAST IRON**
- ductile iron, carbon steel and stainless steel

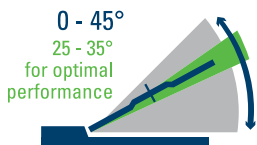

### 1/4" GRINDING WHEELS:

Ideal for heavy stock removal, removing cracks and surface imperfections, blending parting lines, removing flash, gate and riser removal.

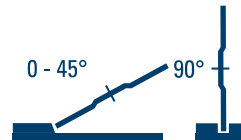

### 1/8" COMBO WHEELS:

Ideal for light grinding, blending parting lines, removing flash and cutting gates and risers.

## MAX PERFORMANCE

TIGER CERAMIC / Superior Cut & Long Life

- CAST IRON**   **DUCTILE IRON**   **CAST STEEL**   **HARD-TO-GRIND**

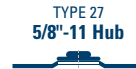

Diameter	Thickness	Grade	Max. RPM	Std. Pack	Item #	Std. Pack	Item #
<b>TYPE 27 DEPRESSED CENTER 1/4" GRINDING WHEELS</b>							
7"	1/4"	CER24T	8,500	10	68388	10	68389
9"	1/4"	CER24T	6,600	10	68392	10	68393
<b>TYPE 27 DEPRESSED CENTER 1/8" CUT &amp; GRIND COMBO WHEELS</b>							
7"	1/8"	CER30T	8,500	25	68386	10	68387
9"	1/8"	CER30T	6,600	25	68390	10	68391



68389

## HIGH PERFORMANCE

TIGER ZIRC / Fast Cut & Long Life

- CAST IRON**   **DUCTILE IRON**   **CAST STEEL**



Diameter	Thickness	Grade	Max. RPM	Std. Pack	Item #	Std. Pack	Item #
<b>TYPE 27 DEPRESSED CENTER 1/4" GRINDING WHEELS</b>							
7"	1/4"	Z24T	8,500	10	68380	10	68381
9"	1/4"	Z24T	6,600	10	68384	10	68385
<b>TYPE 27 DEPRESSED CENTER 1/8" CUT &amp; GRIND COMBO WHEELS</b>							
7"	1/8"	Z30T	8,500	25	68378	10	68379
9"	1/8"	Z30T	6,600	25	68382	10	68383



68380

## PERFORMANCE

TIGER AO / Long Life

- CAST IRON**



Diameter	Thickness	Grade	Max. RPM	Std. Pack	Item #	Std. Pack	Item #
<b>TYPE 27 DEPRESSED CENTER 1/4" GRINDING WHEELS</b>							
7"	1/4"	A24T	8,500	10	68372	10	68373
9"	1/4"	A24T	6,600	10	68376	10	68377
<b>TYPE 27 DEPRESSED CENTER 1/8" CUT &amp; GRIND COMBO WHEELS</b>							
7"	1/8"	A30T	8,500	25	68370	10	68371
9"	1/8"	A30T	6,600	25	68374	10	68375



68370



Using a cone to clean surface imperfections.



Weiler Tiger cones and plugs offer performance grinding solutions for ID cleaning, hole edge beveling, smoothing weld seams, removing parting lines and cleaning castings in hard-to-reach places. Designed with the operator in mind, these abrasives provide smooth, vibration free operation and instant cutting action right out of the box.

*Weiler cones & plugs offer several other advantages, including:*

- Open face design provides **aggressive cut-rate** right out of the box.
- Anchored hexagon nut secures the abrasive to the tool to **increase safety** and prevent product breakage.
- Zinc plated nut prevents oxidation, **eliminates contamination** and allows for easy mounting.
- Precision balanced to ensure smooth, **vibration free operation** and reduced operator fatigue.

**CONE & PLUG APPLICATIONS:** Ideal for ID cleaning, hole edge beveling, smoothing weld seams, removing parting lines and cleaning castings in hard-to-reach places.

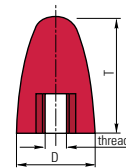
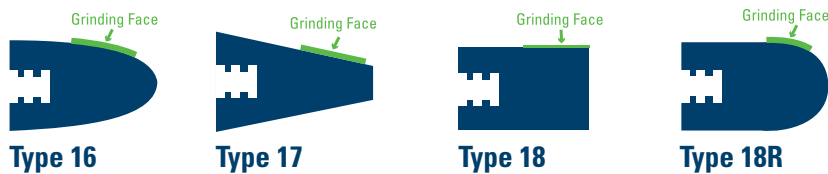

## MAX PERFORMANCE GRINDING

CAST IRON DUCTILE IRON CAST STEEL **HARD-TO-GRIND**

**TIGER CERAMIC TYPE 16 CONES** / Superior Life & Cut

Diameter (D)	Thickness (T)	Arbor (Thread)	Grade	Max. RPM	Std. Pack	Item #
2"	3"	5/8"-11 Nut	HZA20S	18,145	12	68403

## HIGH PERFORMANCE GRINDING

CAST IRON DUCTILE IRON CAST STEEL **TIGER ZIRC TYPE 16 CONES** / Fast Cut & Long Life

Diameter (D)	Thickness (T)	Arbor (Thread)	Grade	Max. RPM	Std. Pack	Item #
1"	3"	3/8"-24 Nut	ZA20S	36,290	12	68301
1-1/2"	2-1/2"	5/8"-11 Nut	ZA20S	24,190	12	68304
1-1/2"	2"	3/8"-24 Nut	ZA20S	24,190	12	68306
1-1/2"	3"	5/8"-11 Nut	ZA20S	24,190	12	68308
2"	3"	5/8"-11 Nut	ZA20S	18,145	12	68311
2-3/4"	3-1/2"	5/8"-11 Nut	ZA20S	13,195	12	68313

## PERFORMANCE GRINDING

CAST IRON **TIGER AO TYPE 16 CONES** / Long Life

Diameter (D)	Thickness (T)	Arbor (Thread)	Grade	Max. RPM	Std. Pack	Item #
1"	3"	3/8"-24 Nut	A24R	36,290	12	68300
1-1/2"	2-1/2"	3/8"-24 Nut	A24R	24,190	12	68302
1-1/2"	2-1/2"	5/8"-11 Nut	A24R	24,190	12	68303
1-1/2"	3"	3/8"-24 Nut	A24R	24,190	12	68305
1-1/2"	3"	5/8"-11 Nut	A24R	24,190	12	68307
2"	3"	3/8"-24 Nut	A24R	18,145	12	68309
2"	3"	5/8"-11 Nut	A24R	18,145	12	68310
2-3/4"	3"	5/8"-11 Nut	A24R	13,195	12	68312
3"	3"	5/8"-11 Nut	A24R	12,100	12	68314

## ANCHORED NUT INCREASES SAFETY

- **Heavy-duty steel hex nut** fully anchored into abrasive bond prevents separation and slippage during use.

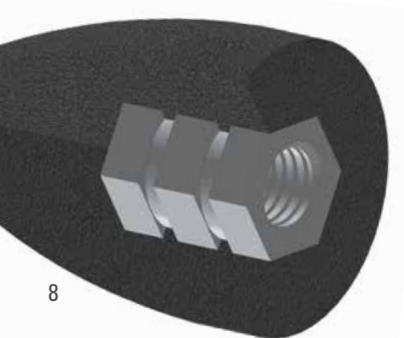



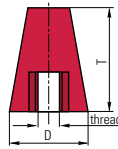

## MAX PERFORMANCE GRINDING

CAST IRON DUCTILE IRON CAST STEEL **HARD-TO-GRIND**

### TIGER CERAMIC TYPE 17 CONES / Superior Life & Cut

Diameter (D)	Thickness (T)	Arbor (Thread)	Grade	Max. RPM	Std. Pack	Item #
2"	3"	5/8"-11 Nut	HZA20S	18,145	12	68404



## HIGH PERFORMANCE GRINDING

CAST IRON DUCTILE IRON CAST STEEL **TIGER ZIRC TYPE 17 CONES / Fast Cut & Long Life**

Diameter (D)	Thickness (T)	Arbor (Thread)	Grade	Max. RPM	Std. Pack	Item #
2"	3"	5/8"-11 Nut	ZA20S	18,145	12	68365

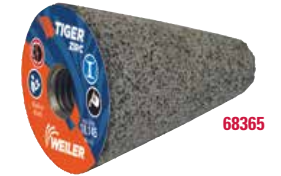

## PERFORMANCE GRINDING

CAST IRON **TIGER AO TYPE 17 CONES / Long Life**

Diameter (D)	Thickness (T)	Arbor (Thread)	Grade	Max. RPM	Std. Pack	Item #
1-1/2"	3"	3/8"-24 Nut	A24R	24,190	12	68315
1-3/4"	3"	5/8"-11 Nut	A24R	20,740	12	68316
2"	3"	5/8"-11 Nut	A24R	18,145	12	68317

## MAX PERFORMANCE GRINDING

CAST IRON DUCTILE IRON CAST STEEL **HARD-TO-GRIND**

### TIGER CERAMIC TYPE 18 PLUGS / Superior Life & Cut

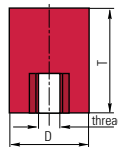

Diameter (D)	Thickness (T)	Arbor (Thread)	Grade	Max. RPM	Std. Pack	Item #
2"	3"	5/8"-11 Nut	HZA20S	18,145	12	68405

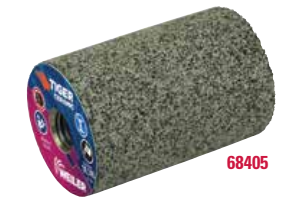

## HIGH PERFORMANCE GRINDING

CAST IRON DUCTILE IRON CAST STEEL **TIGER ZIRC TYPE 18 PLUGS / Fast Cut & Long Life**

Diameter (D)	Thickness (T)	Arbor (Thread)	Grade	Max. RPM	Std. Pack	Item #
1-1/2"	2-1/2"	5/8"-11 Nut	ZA20S	24,190	12	68320
1-1/2"	3"	5/8"-11 Nut	ZA20S	24,190	12	68322
2"	3"	5/8"-11 Nut	ZA20S	18,145	12	68324



## PERFORMANCE GRINDING

CAST IRON **TIGER AO TYPE 18 PLUGS / Long Life**

Diameter (D)	Thickness (T)	Arbor (Thread)	Grade	Max. RPM	Std. Pack	Item #
1-1/2"	2-1/2"	3/8"-24 Nut	A24R	24,190	12	68318
1-1/2"	2-1/2"	5/8"-11 Nut	A24R	24,190	12	68319
1-1/2"	3"	5/8"-11 Nut	A24R	24,190	12	68321
2"	3"	5/8"-11 Nut	A24R	18,145	12	68323

## MAX PERFORMANCE GRINDING

CAST IRON DUCTILE IRON CAST STEEL **HARD-TO-GRIND**

### TIGER CERAMIC TYPE 18R PLUGS / Superior Life & Cut

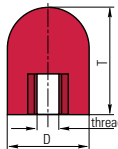

Diameter (D)	Thickness (T)	Arbor (Thread)	Grade	Max. RPM	Std. Pack	Item #
2"	3"	5/8"-11 Nut	HZA20S	18,145	12	68406

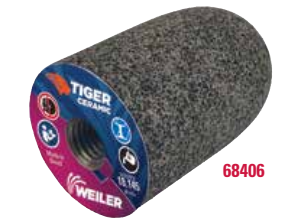

## HIGH PERFORMANCE GRINDING

CAST IRON DUCTILE IRON CAST STEEL **TIGER ZIRC TYPE 18R PLUGS / Fast Cut & Long Life**

Diameter (D)	Thickness (T)	Arbor (Thread)	Grade	Max. RPM	Std. Pack	Item #
1-1/2"	3"	3/8"-24 Nut	ZA20S	24,190	12	68326
1-1/2"	3"	5/8"-11 Nut	ZA20S	24,190	12	68328
2"	3"	5/8"-11 Nut	ZA20S	18,145	12	68330



## PERFORMANCE GRINDING

CAST IRON **TIGER AO TYPE 18R PLUGS / Long Life**

Diameter (D)	Thickness (T)	Arbor (Thread)	Grade	Max. RPM	Std. Pack	Item #
1-1/2"	3"	3/8"-24 Nut	A24R	24,190	12	68325
1-1/2"	3"	5/8"-11 Nut	A24R	24,190	12	68327
2"	3"	5/8"-11 Nut	A24R	18,145	12	68329
3"	3"	5/8"-11 Nut	A24R	12,100	12	68331



# SNAGGING WHEELS

For Pneumatic Straight Grinders, High Frequency Electric Straight Grinders, and Die Grinders



Portable snagging wheels are ideal for targeted heavy stock removal applications.



Weiler Tiger type 1 portable snagging wheels feature a flat face with a narrow contact area, making them ideal for heavy grinding, transitioning, rough beveling, and removing cracks and flaws. The line is available in three performance tiers, including Tiger Zirc, which provides an excellent combination of long product life and a fast, consistent cut-rate when grinding.

Tiger 6 & 8 inch snagging wheels are designed for medium to high power pneumatic and high frequency electric straight grinders, while the 3 inch wheels are used on die grinders. The arbor hole is produced with a precision phenolic resin insert to ensure a tight fit on the tool, minimizing vibration and enhancing the operator experience.

*Weiler snagging wheels offer several other advantages, including:*

- Open face design provides **aggressive cut-rate** right out of the box.
- Precision balanced to ensure smooth, **vibration-free operation** and reduced operator fatigue.
- Double fiberglass internal reinforcement in 6 & 8 inch wheels provide **added strength** for consistent product wear and reduced edge chipping.

**SNAGGING WHEEL APPLICATIONS:** Ideal for snagging, grinding, heavy stock removal, transitioning, rough beveling, removing cracks and flaws, blending parting lines and deflashing.

## Type 1 (Flat)



Features a flat face with narrow contact area



68402



68342



68340

### MAX PERFORMANCE SNAGGING

CAST IRON		DUCTILE IRON		TIGER CERAMIC	
CAST STEEL		HARD-TO-GRIND		Superior Life & Cut	
Diameter	Thickness	Grade	Max. RPM	Std. Pack	Item #
6"	1"	HZR16-R	8,000	5	68401
8"	1"	HZR16-R	6,000	5	68402

TYPE 1  
5/8" Arbor

### HIGH PERFORMANCE SNAGGING

CAST IRON		DUCTILE IRON		TIGER ZIRC			
CAST STEEL		HARD-TO-GRIND		Fast Cut & Long Life			
Diameter	Thickness	Grade	Max. RPM	Std. Pack	Item #	Std. Pack	Item #
3"	1/2"	ZA14S	18,080	10	68341	—	—
6"	1"	ZA16Q	8,000	—	—	5	68342
6"	1"	ZAC16Q	8,000	—	—	5	68343
6"	1"	ZA16R	8,000	—	—	5	68344
8"	1"	ZA16O	6,000	—	—	5	68345
8"	1"	ZA16Q	6,000	—	—	5	68346
8"	1"	ZAC16Q	6,000	—	—	5	68347
8"	1"	ZA16R	6,000	—	—	5	68348
8"	1"	ZA16T	6,000	—	—	5	68349

TYPE 1  
3/8" Arbor

TYPE 1  
5/8" Arbor

### PERFORMANCE GRINDING

CAST IRON		TIGER AO / Long Life			
Diameter	Thickness	Grade	Max. RPM	Std. Pack	Item #
3"	1/2"	A14P	18,080	10	68340

TYPE 1  
3/8" Arbor





Tiger mounted points are ideal for light grinding in hard-to-reach areas and removing cracks from castings.

Weiler Tiger Zirc mounted points come in various ANSI point shapes including A1, A11, A3, and W. A zirconia abrasive grain in combination with a strong bond delivers long product life and a consistent cut rate when grinding metal. The unique shapes allow for precise cleaning and grinding of parts with complex geometries and in hard-to-reach areas. Designed for die grinders, mounted points have a standard 1/4" shank diameter and a 1-1/2" shank length.

*Weiler mounted points offer several other advantages, including:*

- Dressed working surface **eliminates break-in** and provides a consistent finish.
- Engineered stem bonding adds **strength and stability** to the point, improving safety.
- Tailored product geometry provides **optimal control** for precise grinding of critical parts.

**MOUNTED POINT APPLICATIONS:** Ideal for cleaning ID's, corners and hard-to-reach areas, edge chamfering, light grinding, stock removal and hole edge beveling.

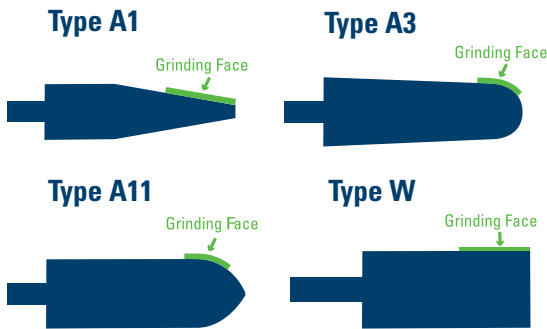

## HIGH PERFORMANCE GRINDING

CAST IRON   DUCTILE IRON   CAST STEEL

TIGER ZIRC / Fast Cut & Long Life

Diameter	Length	Shape	Grade	Max. RPM	Std. Pack	Item #
3/4"	1/2"	A1	RZA24U	19,800	10	68332
7/8"	2"	A11	RZA24U	19,860	10	68333
1"	2-3/4"	A3	RZA24U	16,100	10	68334
1/2"	2"	W189	RZA24U	24,000	10	68335
3/4"	1-1/2"	W207	RZA24U	24,000	10	68336
3/4"	2"	W208	RZA24U	18,750	10	68337
1"	1-1/2"	W221	RZA24U	19,120	10	68338
1"	2"	W222	RZA24U	15,900	10	68339
5/8"	2"	W197	RZA24U	21,000	10	68366





Weiler Abrasives is driven to help you overcome the toughest cleaning room challenges. For additional Foundry related resources, visit our website at [www.weilerabrasives.com](http://www.weilerabrasives.com)



# AHB

**TOOLING & MACHINERY**

**COMPLETE METALWORKING SOLUTIONS**

(800) 991-4225  
ISO Certified

[www.ahbinc.com](http://www.ahbinc.com)  
[customerservice@ahbinc.com](mailto:customerservice@ahbinc.com)

## WEILER ABRASIVES GROUP

**Weiler Global Headquarters**  
**One Weiler Drive**  
**Cresco, PA 18326 USA**

Weiler de México  
Querétaro, México

Weiler do Brasil  
São Paulo, Brazil

Weiler Germany  
Bindlach, Germany

Weiler Slovenia  
• Maribor (HQ)  
• Zreče  
• Loče  
• Oplotnica

All products meet ANSI B7.1

Refer to ANSI B7.1 for storage & handling details

