

NEW!



COMPLETE
METALWORKING
SOLUTIONS

(800) 991-4225
www.ahbinc.com
ISO Certified
customerservice@ahbinc.com



FRANKEN
TiNox-Cut

TINOX-CUT END MILLS
FOR AEROSPACE MATERIALS

High Performance End Mills for Aerospace materials and other demanding applications.

TiNox-Cut End Mills are application-specific for the machining of tough materials and are guaranteed to deliver unmatched metal removal rates and tool life.



NEW TiNox-Cut N
5-Flute Design for
Roughing-Finishing
Applications
Ideal for
Titanium Alloys



TiNox-Cut NF
for Inconel
Applications



TiNox-Cut Base
for Stainless
Steel
Applications

NEW 5-Flute TiNox-Cut N:

- Made specifically for Titanium Alloys
- 5 flutes for high feed rates
- Raised land increases chip clearance

TiNox-Cut NF:

- Preferable in Inconel and Titanium
- Fine chip breaker reduces chip size, while reducing cutting forces

TiNox-Cut Base:

- Entry-level universal solution
- Preferable in Stainless steels and acid-resistant steels
- Roughing and finishing

TiNox-Cut Trochoidal:

- High performance tool for trochoidal milling
- Preferable in Titanium and Stainless
- Newly developed geometry with chip breaker
- Low-vibration machining

*German engineered
EMUGE-FRANKEN quality*

Four end mill types for semi-roughing and finishing applications

- **Impressive surface roughness results** when compared to traditional end mills
- **Advanced PVD applied coatings** for heat and wear resistance
- **Made from premium ultra-fine grade carbide** with a maximized transverse rupture strength for high impact applications
- **Axial internal coolant** channel design for maximum chip evacuation performance and chip cooling ability
- **Weldon flat** shank construction that mates with an anti-pullout pin lock system available in EMUGE-FRANKEN FPC Milling Chucks
- **Standard corner radius** offering available along with modification service located in the USA



S	2.6
	2.5
	2.4
	2.3
	2.2
S	2.1
	1.3
	1.2
M	1.1
	4.1
	3.1
	2.1
	1.1

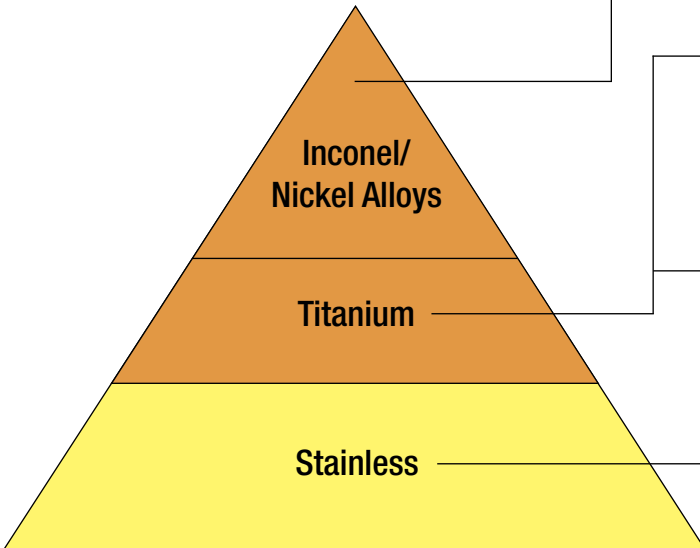

TiNox-Cut NF



High performance roughing tool for difficult to machine Nickel Alloys

TiNox-Cut N



High performance tool specially designed for machining of Titanium and Titanium Alloys

TiNox-Cut Trochoidal



High metal removal rate reduces stress and vibration for difficult materials

TiNox-Cut Base



Universal tool for machining of Stainless- and acid-resistant steels

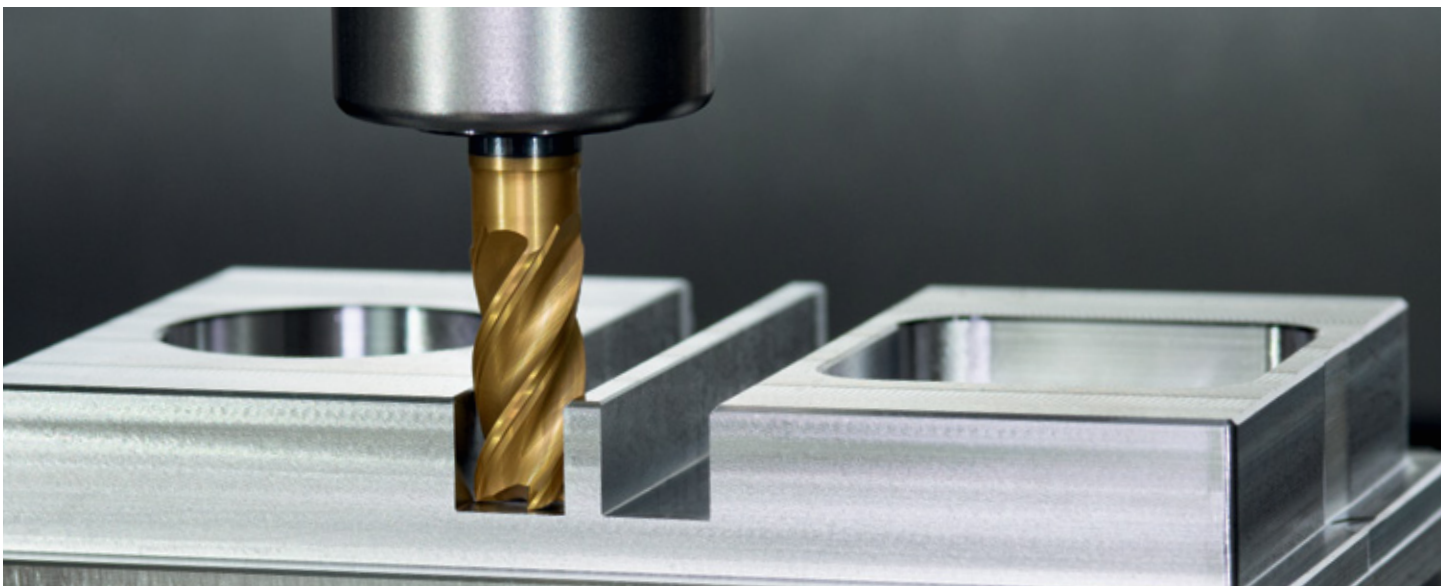

Trochoidal Milling

Trochoidal milling is the overlapping of a circular path with a linear movement and thus the conversion of slot milling into contour milling. Just as in finishing operations, the chip is peeled from the workpiece with a low radial depth of cut and a maximum axial depth of cut ($2 \times D$ to $4 \times D$). **The small contact angle reduces heat generation during machining and less thermal stress provides increased material removal and longer tool life.**

High metal removal rates can be generated even on low-powered machines and wear is reduced during full slot milling, particularly in difficult to machine materials. Plus, the end mill is utilized over the entire flute length, and as a result **wear is evenly spaced over the full cutting edge length, increasing tool life.**

Advantages of EMUGE-FRANKEN Trochoidal Milling

- Particularly suitable for difficult to machine materials and thin-walled components
- Reduced stress on tools and machine
- Increased metal removal rate on low-powered dynamic machines
- Suitable for unstable workpiece clamping conditions
- Enables high axial depth of cut up to $4 \times D$

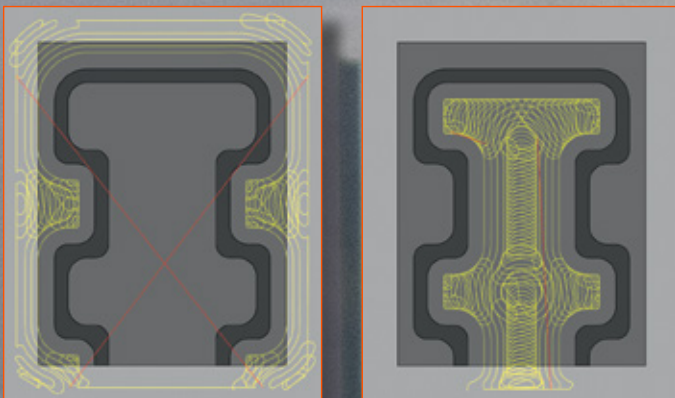

New CAD/CAM programming systems enable the machining of complex contours and deep pockets in 2D and 3D parts with a trochoidal milling strategy. **The objective of these new strategies is the optimized calculation of milling paths to avoid unproductive tool motion.**

Slot Milling Strategy Comparisons

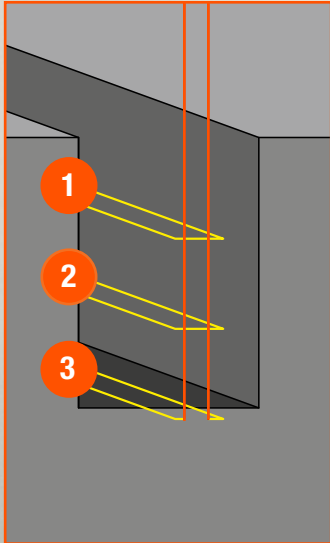

HPC Slot Milling with standard solid carbide end mill

Slot L x W x H:	18" x 3/4" x 1-3/4"
Material:	4140 Steel
Tool:	2994L.0625
Diameter:	5/8"
Cutting length:	1-1/4"
Flutes:	4
Cutting speed (V _c):	490 SFM
Feed per tooth (f _z):	.003"
Axial depth of cut (a _p):	.60"
Radial depth of cut (a _e):	5/8"

Machining time: 3:13 Minutes

**Milling strategy requires
3 tool paths**

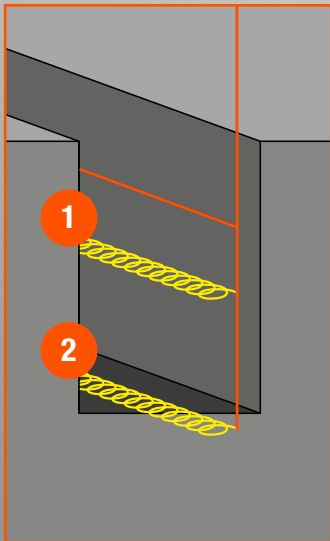

Trochoidal Slot Milling with standard solid carbide end mill

Slot L x W x H:	18" x 3/4" x 1-3/4"
Material:	4140 Steel
Tool:	2994L.0625
Diameter:	5/8"
Cutting length:	1-1/4"
Flutes:	4
Cutting speed (V _c):	655 SFM
Feed per tooth (f _z):	.005"
Axial depth of cut (a _p):	7/8"
Radial depth of cut (a _e):	.090"

Machining time: 2:57 Minutes

**Milling strategy requires
2 tool paths**

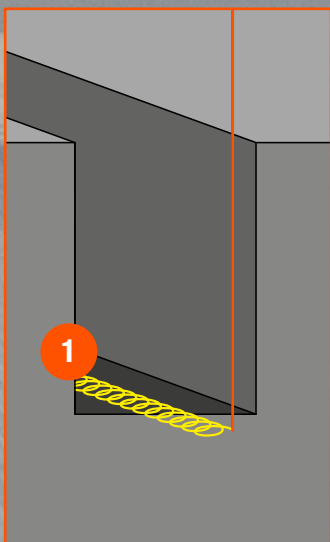

Trochoidal Slot Milling with EMUGE-FRANKEN Trochoidal Solid Carbide End Mill







Slot L x W x H:	18" x 3/4" x 1-3/4"
Material:	4140 Steel
Tool:	2573L.0625
Diameter:	5/8"
Flutes:	5
Cutting speed (V _c):	655 SFM
Feed per tooth (f _z):	.005"
Axial depth of cut (a _p):	1-3/4"
Radial depth of cut (a _e):	.050"

Machining time: 2:07 Minutes



**Milling strategy requires only
1 tool path**







						
		Corner Radius				
Tool	TiNox-Cut N	TiNox-Cut N	TiNox-Cut NF	TiNox-Cut NF Solid	TiNox-Cut Base / Stub	TiNox-Cut Base / Standard
Page	8	8	9	9	10	10
Length	Standard	Standard	Standard	Standard	Stub	Standard
Coating	ALCR	ALCR	TIN / TIALN	TIN / TIALN	TIN / TIALN	TIN / TIALN
Flutes	5	5	4-5	4	4	4
Size Range	1/4" - 1" \varnothing	1/4" - 1" \varnothing	1/4" - 1" \varnothing	1/4" - 1" \varnothing	1/8" - 3/4" \varnothing	1/8" - 3/4" \varnothing
Preferable Materials	Titanium Alloys	Titanium Alloys	Inconel	Inconel	Stainless Steel	Stainless Steel
Suitable Materials	Stainless Steels	Stainless Steels	Titanium Alloys	Titanium Alloys	Titanium Alloys	Titanium Alloys
Application	Rougher-Finisher	Rougher-Finisher with Corner Radius	Semi-Finisher	Semi-Finisher	Rougher-Finisher	Rougher-Finisher



TiNox-Cut Base

TiNox-Cut Trochoidal

					
Tool	TiNox-Cut Trochoidal 2 x D	TiNox-Cut Trochoidal 3 x D	TiNox-Cut Trochoidal 4 x D	TiNox-Cut Trochoidal 3 x D Corner Radius	TiNox-Cut Trochoidal 4 x D Corner Radius
Page	11	11	11	12	12
Length	Standard	Long	Extra Long	Long	Extra Long
Coating	TIN / TIALN	TIN / TIALN	TIN / TIALN	TIN / TIALN	TIN / TIALN
Flutes	4-5	4-5	4-5	4-5	4-5
Size Range	1/4" - 3/4" ϕ	1/4" - 3/4" ϕ	1/4" - 3/4" ϕ	1/4" - 3/4" ϕ	1/4" - 3/4" ϕ
Preferable Materials	Titanium, Stainless Steel	Titanium, Stainless Steel	Titanium, Stainless Steel	Titanium, Stainless Steel	Titanium, Stainless Steel
Suitable Materials	Inconel	Inconel	Inconel	Inconel	Inconel
Application	Rougher-Finisher	Rougher-Finisher	Rougher-Finisher	Rougher-Finisher with Corner Radius	Rougher-Finisher with Corner Radius

Rougher-Finisher

- High performance tool for roughing and finishing
- 5 flutes for high feed rates
- Raised land increases chip clearance
- Special geometry prevents vibration
- Axial coolant hole for better chip evacuation
- Internal coolant (ICA)

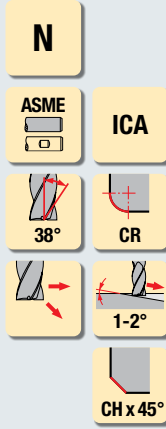

Rougher-Finisher with Corner Radius

- Different corner radii per diameter

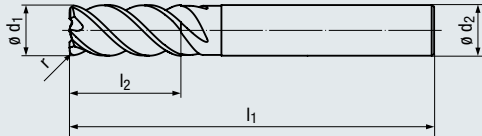

Icon descriptions (see page 17)

Corner Radius

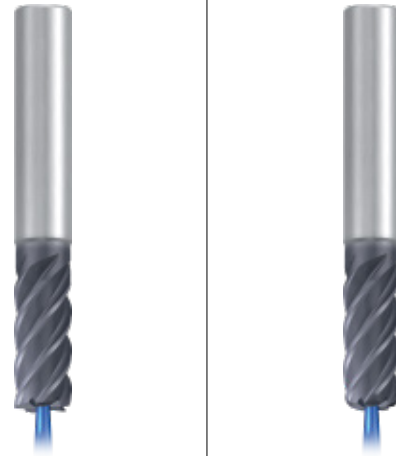

Coating

ALCR

Applications / Materials and Cutting Data (see page 13)

- Especially made for Titanium Alloys
- Suitable for HPC roughing and finishing
- For efficient machining of Stainless Steel

M	1.1-4.1
S	1.1-1.3
S	2.1-2.6

Standard length

$\varnothing d_1$ h10	l_2	l_1	$\varnothing d_2$ h6	Chamfer	# Flutes	Tool No. Straight Shank
1/4	3/4	2 1/2	1/4	0.005	5	2962LZ.0250
5/16	3/4	2 1/2	5/16	0.005	5	2962LZ.03125
3/8	7/8	2 1/2	3/8	0.008	5	2962LZ.0375
1/2	1 1/4	3	1/2	0.008	5	2962LZ.0500
5/8	1 1/4	3 1/2	5/8	0.008	5	2962LZ.0625
3/4	1 1/2	4	3/4	0.012	5	2962LZ.0750
1	1 3/4	4 1/2	1	0.012	5	2962LZ.1000

Standard length – Corner Radius

$\varnothing d_1$ h11	l_2	l_1	$\varnothing d_2$ h6	r ± 0.0004	# Flutes	Tool No. Straight Shank
1/4	3/4	2 1/2	1/4	0.015	5	2966LZ.025015
1/4	3/4	2 1/2	1/4	0.030	5	2966LZ.025030
5/16	3/4	2 1/2	5/16	0.015	5	2966LZ.031015
5/16	3/4	2 1/2	5/16	0.030	5	2966LZ.031030
3/8	7/8	2 1/2	3/8	0.015	5	2966LZ.037015
3/8	7/8	2 1/2	3/8	0.030	5	2966LZ.037030
1/2	1 1/4	3	1/2	0.015	5	2966LZ.050015
1/2	1 1/4	3	1/2	0.030	5	2966LZ.050030
1/2	1 1/4	3	1/2	0.060	5	2966LZ.050060
1/2	1 1/4	3	1/2	0.090	5	2966LZ.050090
1/2	1 1/4	3	1/2	0.120	5	2966LZ.050120
5/8	1 1/4	3 1/2	5/8	0.015	5	2966LZ.062015
5/8	1 1/4	3 1/2	5/8	0.030	5	2966LZ.062030
5/8	1 1/4	3 1/2	5/8	0.060	5	2966LZ.062060
3/4	1 1/2	4	3/4	0.015	5	2966LZ.075015
3/4	1 1/2	4	3/4	0.030	5	2966LZ.075030
3/4	1 1/2	4	3/4	0.060	5	2966LZ.075060
3/4	1 1/2	4	3/4	0.090	5	2966LZ.075090
3/4	1 1/2	4	3/4	0.120	5	2966LZ.075120
1	1 3/4	4 1/2	1	0.015	5	2966LZ.100015
1	1 3/4	4 1/2	1	0.030	5	2966LZ.100030
1	1 3/4	4 1/2	1	0.060	5	2966LZ.100060
1	1 3/4	4 1/2	1	0.090	5	2966LZ.100090
1	1 3/4	4 1/2	1	0.120	5	2966LZ.100120

Semi-Finisher

- Fine semi-finishing profile
- Variable index
- TiN/TIALN PVD multi-layer coating increases tool life
- Sub-micro grain carbide
- Axial coolant hole for better chip evacuation
- Axial internal coolant supply (ICA)

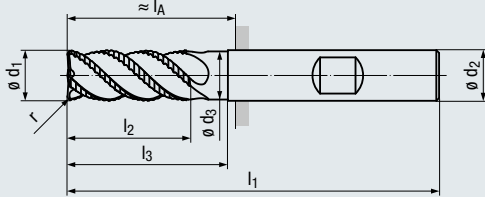

Design I₄:

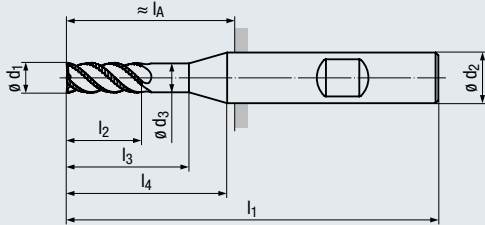

Icon descriptions (see page 17)

NF fine

ASME **ICA**

45° 45°

3-5°

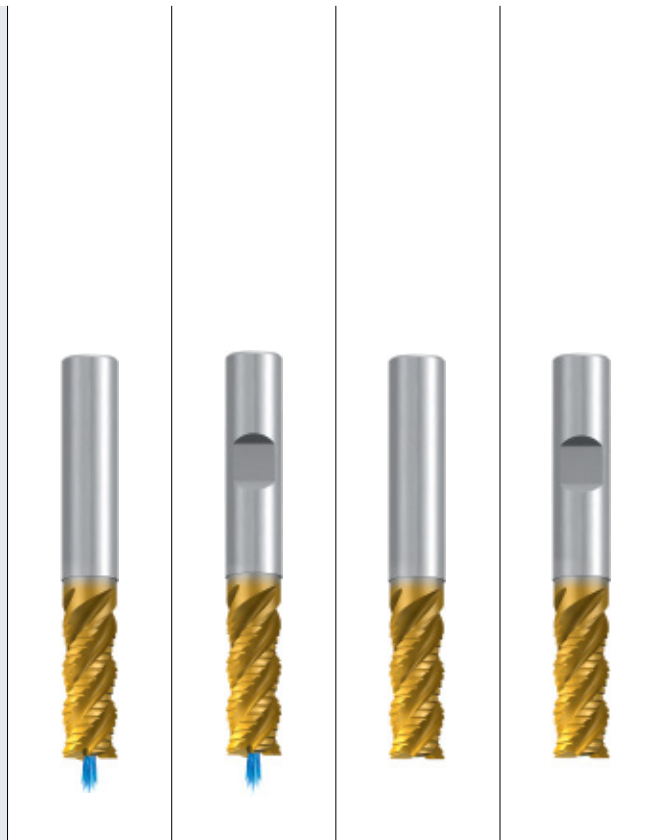

Coating

TIN / TIALN

Applications / Materials and Cutting Data (see page 14)

- Ideal for difficult to cut materials such as nickel alloys and Titanium, preferable in Inconel
- Suitable for high productivity cutting, roughing

S 2.1-2.6

S 1.1-1.3

Standard length – with Coolant Through

ϕd_1 h11	l_2	l_3	l_1	ϕd_3	l_4	ϕd_2 h6	l_A	# Flutes	Tool No. Straight Shank	Tool No. Weldon Shank
1/4	17/32	3/4	2 1/2	0.236	7/8	3/8	15/16	4	2648TZ.0250	2649TZ.0250
5/16	3/4	7/8	2 1/2	0.295	15/16	3/8	15/16	4	2648TZ.03125	2649TZ.03125
3/8	7/8	1 1/8	2 3/4	0.358	–	3/8	1 3/16	4	2648TZ.0375	2649TZ.0375
1/2	1 1/8	1 3/8	3 1/4	0.480	–	1/2	1 15/32	4	2648TZ.0500	2649TZ.0500
5/8	1 1/4	1 1/2	3 1/2	0.605	–	5/8	1 19/32	4	2648TZ.0625	2649TZ.0625
3/4	1 1/2	1 7/8	4	0.730	–	3/4	1 31/32	4	2648TZ.0750	2649TZ.0750
1	1 3/4	2 5/8	5	0.969	–	1	2 23/32	5	2648TZ.1000	2649TZ.1000

Standard length – Solid

ϕd_1 h11	l_2	l_1	ϕd_3	ϕd_2 h6	# Flutes	Tool No. Straight Shank	Tool No. Weldon Shank
1/4	17/32	2 1/2	0.236	1/4	4	2958T.0250	–
5/16	3/4	2 1/2	0.295	5/16	4	2958T.03125	–
3/8	7/8	2 3/4	0.358	3/8	4	2958T.0375	–
1/2	1 1/8	3 1/4	0.480	1/2	4	2958T.0500	2959T.0500
5/8	1 1/4	3 1/2	0.605	5/8	4	2958T.0625	2959T.0625
3/4	1 1/2	4	0.730	3/4	4	2958T.0750	2959T.0750
1	1 3/4	5	0.969	1	5	2958T.1000	2959T.1000

Rougher-Finisher

- Ideal entry-level universal tool solution
- High performance tool
- Finishing end mill for tough materials
- Special geometry prevents vibration
- Variable spacing

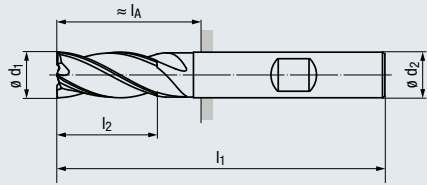

Design l₄:

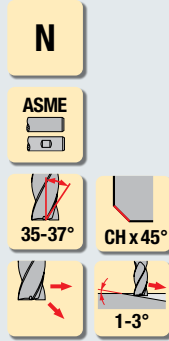
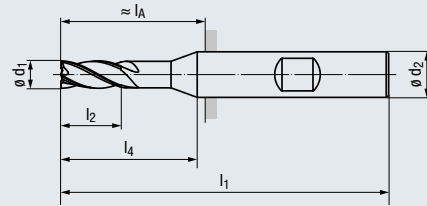

Icon descriptions (see page 17)

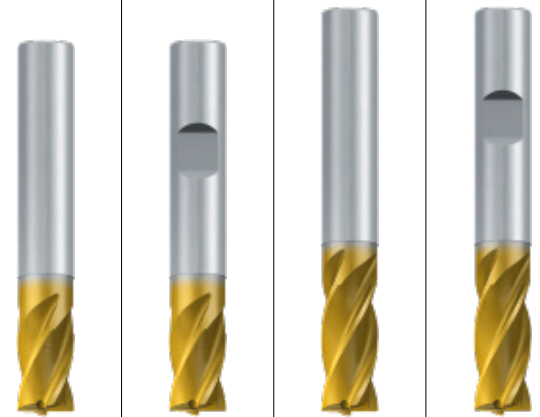

Coating

TiN / TiAlN

Applications / Materials and Cutting Data (see page 15)

- Especially suitable for Stainless Steel materials
- Suitable for Titanium, Alloyed Steels, HPC roughing and finishing

M	1.1-4.1
S	1.1-1.3

Stub length

$\varnothing d_1$ h10	l_2	l_1	l_4	$\varnothing d_2$ h6	l_A 	Chamfer	# Flutes	Tool No. Straight Shank	Tool No. Weldon Shank
1/8	1/4	2	5/8	1/4	5/8	0.003	4	2975T.0125	-
3/16	3/8	2	5/8	1/4	5/8	0.005	4	2975T.01875	-
1/4	1/2	2	-	1/4	5/8	0.005	4	2975T.0250	-
5/16	9/16	2 1/4	-	5/16	7/8	0.005	4	2975T.03125	-
3/8	5/8	2 1/2	-	3/8	15/16	0.008	4	2975T.0375	-
1/2	5/8	2 3/4	-	1/2	31/32	0.008	4	2975T.0500	2976T.0500
5/8	3/4	3	-	5/8	1 3/32	0.008	4	2975T.0625	2976T.0625
3/4	1	3 1/2	-	3/4	1 15/32	0.012	4	2975T.0750	2976T.0750

Standard length

$\varnothing d_1$ h10	l_2	l_1	l_4	$\varnothing d_2$ h6	l_A 	Chamfer	# Flutes	Tool No. Straight Shank	Tool No. Weldon Shank
1/8	3/8	2 1/4	7/8	1/4	7/8	0.003	4	2977T.0125	-
3/16	9/16	2 1/4	7/8	1/4	7/8	0.005	4	2977T.01875	-
1/4	3/4	2 1/2	-	1/4	1 1/8	0.005	4	2977T.0250	-
5/16	13/16	2 1/2	-	5/16	1 1/8	0.005	4	2977T.03125	-
3/8	7/8	2 3/4	-	3/8	1 3/16	0.008	4	2977T.0375	-
1/2	1	3	-	1/2	1 7/32	0.008	4	2977T.0500	2978T.0500
5/8	1 1/4	3 1/2	-	5/8	1 19/32	0.008	4	2977T.0625	2978T.0625
3/4	1 1/2	4	-	3/4	1 31/32	0.012	4	2977T.0750	2978T.0750

- High performance tool for trochoidal milling
- Newly developed geometry with chip breaker
- Low-vibration machining
- Axial depths of cut up to 4 x D
- Axial internal coolant supply (ICA)

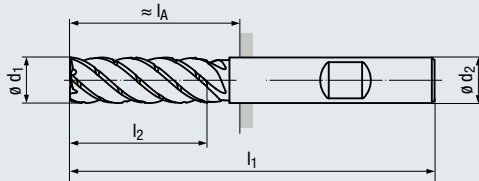
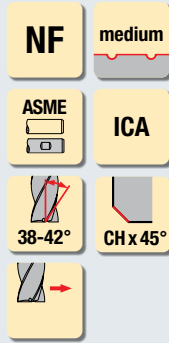

Icon descriptions (see page 17)

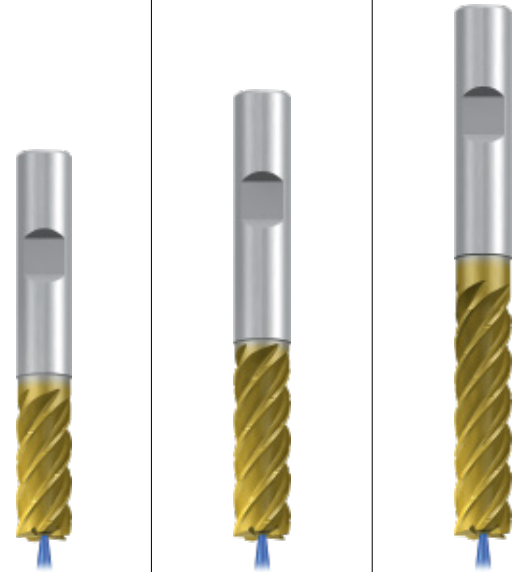

Coating

TIN/TIALN

Applications / Materials and Cutting Data (see page 16)

- For process-reliable trochoidal roughing operations
- Suitable for finishing
- Especially suitable for difficult-to-cut materials such as Titanium

M	1.1-4.1
S	1.1-1.3
S	2.1-2.6

2 x D – Standard length

$\varnothing d_1$ h10	l_2	l_1	$\varnothing d_2$ h6	l_A 	Chamfer	# Flutes	Tool No. Weldon Shank
1/4	1/2	2 1/4	1/4	7/8	0.005	4	2577TZ.0250
5/16	13/16	2 1/2	5/16	1 1/8	0.005	5	2577TZ.03125
3/8	7/8	3	3/8	1 7/16	0.008	5	2577TZ.0375
1/2	1	3 1/4	1/2	1 15/32	0.008	5	2577TZ.0500
5/8	1 1/4	3 3/4	5/8	1 27/32	0.008	5	2577TZ.0625
3/4	1 1/2	4 1/4	3/4	2 7/32	0.012	5	2577TZ.0750

3 x D – Long length

$\varnothing d_1$ h10	l_2	l_1	$\varnothing d_2$ h6	l_A 	Chamfer	# Flutes	Tool No. Weldon Shank
1/4	3/4	2 1/2	1/4	1 1/8	0.005	4	2579TZ.0250
5/16	1	2 3/4	5/16	1 3/8	0.005	5	2579TZ.03125
3/8	1 1/8	3 1/4	3/8	1 11/16	0.008	5	2579TZ.0375
1/2	1 1/2	3 3/4	1/2	1 31/32	0.008	5	2579TZ.0500
5/8	1 7/8	4 1/4	5/8	2 11/32	0.008	5	2579TZ.0625
3/4	2 1/4	5	3/4	2 31/32	0.012	5	2579TZ.0750

4 x D – Extra long length

$\varnothing d_1$ h10	l_2	l_1	$\varnothing d_2$ h6	l_A 	Chamfer	# Flutes	Tool No. Weldon Shank
1/4	1	2 3/4	1/4	1 3/8	0.005	4	2581TZ.0250
5/16	1 1/4	3	5/16	1 5/8	0.005	5	2581TZ.03125
3/8	1 1/2	3 3/4	3/8	2 3/16	0.008	5	2581TZ.0375
1/2	2	4 1/4	1/2	2 15/32	0.008	5	2581TZ.0500
5/8	2 1/2	5	5/8	3 3/32	0.008	5	2581TZ.0625
3/4	3	6	3/4	3 31/32	0.012	5	2581TZ.0750

- High performance tool for trochoidal milling
- Newly developed geometry with chip breaker
- Low-vibration machining
- Axial depths of cut up to 4 x D
- Axial internal coolant supply (ICA)

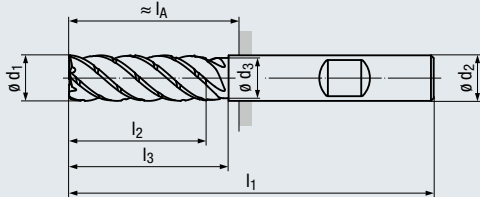
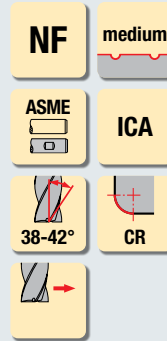

Icon descriptions (see page 17)

Corner Radius

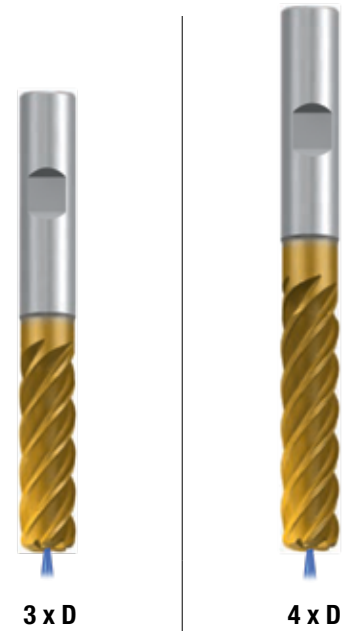

Coating

TIN / TiAlN

Applications / Materials and Cutting Data (see page 16)

- For process-reliable trochoidal roughing operations
- Suitable for finishing
- Especially suitable for difficult-to-cut materials such as Titanium

M	1.1-4.1
S	1.1-1.3
S	2.1-2.6

3 x D and 4 x D – Corner Radius

$\varnothing d_1$ h10	r	Long length 3 x D			Extra long length 4 x D			$\varnothing d_2$ h6	# Flutes	Tool No. Weldon Shank	Tool No. Weldon Shank
		l_1	l_2	l_A 	l_1	l_2	l_A 				
1/4	0.010	2 1/2	3/4	1 1/8	2 3/4	1	1 3/8	1/4	4	3911TZ.025010	3913TZ.025010
1/4	0.015	2 1/2	3/4	1 1/8	2 3/4	1	1 3/8	1/4	4	3911TZ.025015	3913TZ.025015
1/4	0.020	2 1/2	3/4	1 1/8	2 3/4	1	1 3/8	1/4	4	3911TZ.025020	3913TZ.025020
1/4	0.030	2 1/2	3/4	1 1/8	2 3/4	1	1 3/8	1/4	4	3911TZ.025030	3913TZ.025030
1/4	0.060	2 1/2	3/4	1 1/8	2 3/4	1	1 3/8	1/4	4	3911TZ.025060	3913TZ.025060
5/16	0.015	2 3/4	1	1 3/8	3	1 1/4	1 5/8	5/16	5	3911TZ.031015	3913TZ.031015
5/16	0.030	2 3/4	1	1 3/8	3	1 1/4	1 5/8	5/16	5	3911TZ.031030	3913TZ.031030
5/16	0.060	2 3/4	1	1 3/8	3	1 1/4	1 5/8	5/16	5	3911TZ.031060	3913TZ.031060
3/8	0.010	3 1/4	1 1/8	1 11/16	3 3/4	1 1/2	2 3/16	3/8	5	3911TZ.037010	3913TZ.037010
3/8	0.015	3 1/4	1 1/8	1 11/16	3 3/4	1 1/2	2 3/16	3/8	5	3911TZ.037015	3913TZ.037015
3/8	0.020	3 1/4	1 1/8	1 11/16	3 3/4	1 1/2	2 3/16	3/8	5	3911TZ.037020	3913TZ.037020
3/8	0.030	3 1/4	1 1/8	1 11/16	3 3/4	1 1/2	2 3/16	3/8	5	3911TZ.037030	3913TZ.037030
3/8	0.060	3 1/4	1 1/8	1 11/16	3 3/4	1 1/2	2 3/16	3/8	5	3911TZ.037060	3913TZ.037060
3/8	0.090	3 1/4	1 1/8	1 11/16	3 3/4	1 1/2	2 3/16	3/8	5	3911TZ.037090	3913TZ.037090
1/2	0.010	3 3/4	1 1/2	1 31/32	4 1/4	2	2 15/32	1/2	5	3911TZ.050010	3913TZ.050010
1/2	0.015	3 3/4	1 1/2	1 31/32	4 1/4	2	2 15/32	1/2	5	3911TZ.050015	3913TZ.050015
1/2	0.020	3 3/4	1 1/2	1 31/32	4 1/4	2	2 15/32	1/2	5	3911TZ.050020	3913TZ.050020
1/2	0.030	3 3/4	1 1/2	1 31/32	4 1/4	2	2 15/32	1/2	5	3911TZ.050030	3913TZ.050030
1/2	0.060	3 3/4	1 1/2	1 31/32	4 1/4	2	2 15/32	1/2	5	3911TZ.050060	3913TZ.050060
1/2	0.090	3 3/4	1 1/2	1 31/32	4 1/4	2	2 15/32	1/2	5	3911TZ.050090	3913TZ.050090
1/2	0.120	3 3/4	1 1/2	1 31/32	4 1/4	2	2 15/32	1/2	5	3911TZ.050120	3913TZ.050120
5/8	0.030	4 1/4	1 7/8	2 11/32	5	2 1/2	3 3/32	5/8	5	3911TZ.062030	3913TZ.062030
5/8	0.060	4 1/4	1 7/8	2 11/32	5	2 1/2	3 3/32	5/8	5	3911TZ.062060	3913TZ.062060
5/8	0.090	4 1/4	1 7/8	2 11/32	5	2 1/2	3 3/32	5/8	5	3911TZ.062090	3913TZ.062090
5/8	0.120	4 1/4	1 7/8	2 11/32	5	2 1/2	3 3/32	5/8	5	3911TZ.062120	3913TZ.062120
3/4	0.020	5	2 1/4	2 31/32	6	3	3 31/32	3/4	5	3911TZ.075020	3913TZ.075020
3/4	0.030	5	2 1/4	2 31/32	6	3	3 31/32	3/4	5	3911TZ.075030	3913TZ.075030
3/4	0.060	5	2 1/4	2 31/32	6	3	3 31/32	3/4	5	3911TZ.075060	3913TZ.075060
3/4	0.090	5	2 1/4	2 31/32	6	3	3 31/32	3/4	5	3911TZ.075090	3913TZ.075090
3/4	0.120	5	2 1/4	2 31/32	6	3	3 31/32	3/4	5	3911TZ.075120	3913TZ.075120
3/4	0.190	5	2 1/4	2 31/32	6	3	3 31/32	3/4	5	3911TZ.075190	3913TZ.075190

STANDARD LENGTH - WITH COOLANT THROUGH

Valid for Tool No:

2962LZ

HELPFUL FORMULAS:

SFM = (RPM x D in) / 3.82

RPM = (SFM x 3.82) / D in

f_z feed/tooth = IPM / (#teeth x RPM)

IPM = RPM x #teeth x f_z



v_c = Cutting speed
f_z = Feed per tooth

	v _c [sfm]	f _z [inch]	v _c [sfm]	f _z [inch]	v _c [sfm]	f _z [inch]	v _c [sfm]	f _z [inch]
--	----------------------	-----------------------	----------------------	-----------------------	----------------------	-----------------------	----------------------	-----------------------

Suitable	M	Stainless Steel Materials									
		1.1	Ferritic, Martensitic: 410 / 440 / 440C / 17-4 PH	295	0.003 x d ₁	360	0.004 x d ₁	425	0.004 x d ₁	460	0.005 x d ₁
	2.1	Austenitic: 303 / 304 / 316 / 316L / 321	260	0.003 x d ₁	325	0.003 x d ₁	360	0.004 x d ₁	425	0.004 x d ₁	
	3.1	Austenitic-ferritic (Duplex)	130	0.003 x d ₁	165	0.003 x d ₁	195	0.004 x d ₁	195	0.004 x d ₁	
	4.1	Austenitic-ferritic heat-resistant (Super Duplex)	100	0.002 x d ₁	130	0.003 x d ₁	130	0.003 x d ₁	165	0.004 x d ₁	
Preferable	S	Special Materials									
		Titanium Alloys									
		1.1	Pure Titanium	195	0.003 x d ₁	230	0.004 x d ₁	260	0.004 x d ₁	325	0.005 x d ₁
		1.2	Titanium Alloys	165	0.002 x d ₁	195	0.003 x d ₁	230	0.003 x d ₁	260	0.004 x d ₁
	1.3	Titanium Alloys	100	0.002 x d ₁	130	0.002 x d ₁	130	0.003 x d ₁	165	0.003 x d ₁	

STANDARD LENGTH - WITH CORNER RADIUS - WITH COOLANT THROUGH

Valid for Tool No:

2966LZ

HELPFUL FORMULAS:

SFM = (RPM x D in) / 3.82

RPM = (SFM x 3.82) / D in

f_z feed/tooth = IPM / (#teeth x RPM)

IPM = RPM x #teeth x f_z



v_c = Cutting speed
f_z = Feed per tooth

	v _c [sfm]	f _z [inch]	v _c [sfm]	f _z [inch]	v _c [sfm]	f _z [inch]	v _c [sfm]	f _z [inch]
--	----------------------	-----------------------	----------------------	-----------------------	----------------------	-----------------------	----------------------	-----------------------

Suitable	M	Stainless Steel Materials									
		1.1	Ferritic, Martensitic: 410 / 440 / 440C / 17-4 PH	325	0.004 x d ₁	395	0.004 x d ₁	460	0.005 x d ₁	525	0.006 x d ₁
	2.1	Austenitic: 303 / 304 / 316 / 316L / 321	260	0.004 x d ₁	325	0.004 x d ₁	360	0.005 x d ₁	425	0.006 x d ₁	
	3.1	Austenitic-ferritic (Duplex)	165	0.003 x d ₁	195	0.003 x d ₁	230	0.004 x d ₁	260	0.004 x d ₁	
	4.1	Austenitic-ferritic heat-resistant (Super Duplex)	130	0.003 x d ₁	165	0.003 x d ₁	195	0.004 x d ₁	195	0.004 x d ₁	
Preferable	S	Special Materials									
		Titanium Alloys									
		1.1	Pure Titanium	230	0.005 x d ₁	260	0.005 x d ₁	325	0.006 x d ₁	360	0.007 x d ₁
		1.2	Titanium Alloys	195	0.004 x d ₁	230	0.004 x d ₁	260	0.005 x d ₁	325	0.006 x d ₁
	1.3	Titanium Alloys	100	0.003 x d ₁	130	0.003 x d ₁	130	0.004 x d ₁	165	0.004 x d ₁	

Note: All cutting data serve for orientation only and should be adapted individually to the technical conditions on location.

STANDARD LENGTH – WITH COOLANT THROUGH

Valid for Tool Nos:

2648TZ
2649TZ

HELPFUL FORMULAS:

SFM = (RPM x D in) / 3.82

RPM = (SFM x 3.82) / D in

f_z feed/tooth = IPM / (#teeth x RPM)

IPM = RPM x #teeth x f_z

v_c = Cutting speed

f_z = Feed per tooth

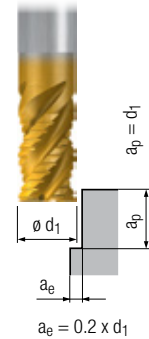
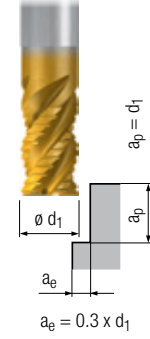
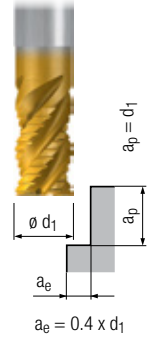
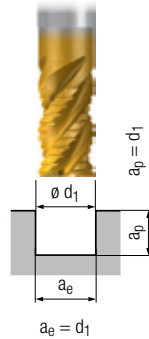

	v _c [sfm]	f _z [inch]	v _c [sfm]	f _z [inch]	v _c [sfm]	f _z [inch]	v _c [sfm]	f _z [inch]
--	----------------------	-----------------------	----------------------	-----------------------	----------------------	-----------------------	----------------------	-----------------------

Suitable	Special Materials										
	Titanium Alloys										
Preferable	S	1.1	Pure Titanium	230	0.005 x d ₁	260	0.005 x d ₁	325	0.006 x d ₁	360	0.007 x d ₁
		1.2	Titanium Alloys	195	0.004 x d ₁	230	0.004 x d ₁	260	0.005 x d ₁	325	0.006 x d ₁
		1.3	Titanium Alloys	100	0.003 x d ₁	130	0.003 x d ₁	130	0.004 x d ₁	165	0.004 x d ₁
		Nickel Alloys, Cobalt Alloys and Iron Alloys									
		2.1	Pure Nickel	230	0.004 x d ₁	260	0.004 x d ₁	325	0.005 x d ₁	360	0.006 x d ₁
		2.2	Monel 500 / 718 Inconel annealed	65	0.003 x d ₁	65	0.004 x d ₁	80	0.004 x d ₁	100	0.005 x d ₁
2.3	Nickel-base Alloys: 718 Inconel	30	0.002 x d ₁	50	0.002 x d ₁	50	0.003 x d ₁	65	0.003 x d ₁		
2.4	Cobalt-base Alloys	65	0.003 x d ₁	80	0.003 x d ₁	115	0.004 x d ₁	100	0.004 x d ₁		
2.5	Cobalt-base Alloys	30	0.002 x d ₁	30	0.002 x d ₁	30	0.003 x d ₁	65	0.003 x d ₁		
2.6	Iron-base Alloys	30	0.003 x d ₁	30	0.003 x d ₁	30	0.004 x d ₁	65	0.004 x d ₁		

STANDARD LENGTH – SOLID SHANK

Valid for Tool Nos:

2958T
2959T

HELPFUL FORMULAS:

SFM = (RPM x D in) / 3.82

RPM = (SFM x 3.82) / D in

f_z feed/tooth = IPM / (#teeth x RPM)

IPM = RPM x #teeth x f_z

v_c = Cutting speed

f_z = Feed per tooth

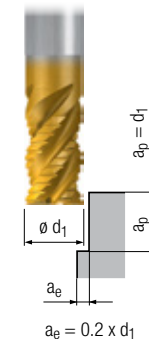
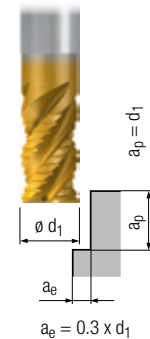
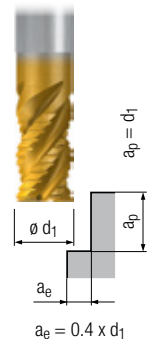
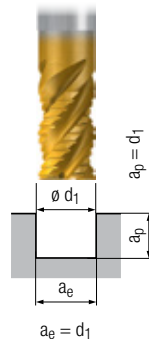

	v _c [sfm]	f _z [inch]	v _c [sfm]	f _z [inch]	v _c [sfm]	f _z [inch]	v _c [sfm]	f _z [inch]
--	----------------------	-----------------------	----------------------	-----------------------	----------------------	-----------------------	----------------------	-----------------------

Suitable	Special Materials										
	Titanium Alloys										
Preferable	S	1.1	Pure Titanium	205	0.004 x d ₁	240	0.005 x d ₁	295	0.006 x d ₁	325	0.007 x d ₁
		1.2	Titanium Alloys	180	0.003 x d ₁	205	0.004 x d ₁	240	0.005 x d ₁	295	0.008 x d ₁
		1.3	Titanium Alloys	90	0.002 x d ₁	120	0.003 x d ₁	120	0.004 x d ₁	150	0.004 x d ₁
		Nickel Alloys, Cobalt Alloys and Iron Alloys									
		2.1	Pure Nickel	205	0.003 x d ₁	240	0.004 x d ₁	295	0.005 x d ₁	325	0.006 x d ₁
		2.2	Monel 500 / 718 Inconel annealed	60	0.002 x d ₁	60	0.004 x d ₁	75	0.004 x d ₁	90	0.005 x d ₁
2.3	Nickel-base Alloys: 718 Inconel	30	0.002 x d ₁	45	0.002 x d ₁	45	0.003 x d ₁	60	0.003 x d ₁		
2.4	Cobalt-base Alloys	60	0.002 x d ₁	75	0.003 x d ₁	105	0.004 x d ₁	90	0.004 x d ₁		
2.5	Cobalt-base Alloys	30	0.002 x d ₁	30	0.002 x d ₁	30	0.003 x d ₁	60	0.003 x d ₁		
2.6	Iron-base Alloys	30	0.002 x d ₁	30	0.003 x d ₁	30	0.004 x d ₁	60	0.004 x d ₁		

Note: All cutting data serve for orientation only and should be adapted individually to the technical conditions on location.

STUB LENGTH – SOLID SHANK

Valid for Tool Nos:

2975T
2976T

HELPFUL FORMULAS:

SFM = (RPM x D in) / 3.82

RPM = (SFM x 3.82) / D in

f_z feed/tooth = IPM / (#teeth x RPM)

IPM = RPM x #teeth x f_z

v_c = Cutting speed

f_z = Feed per tooth

N

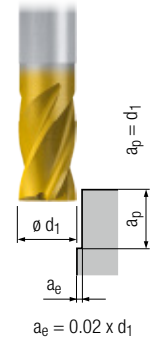
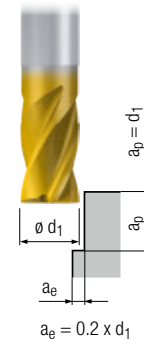
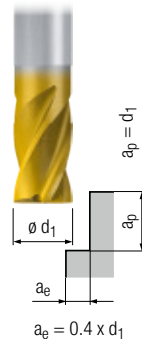
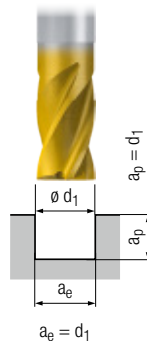

		Stainless Steel Materials									
		v _c [sfm]	f _z [inch]	v _c [sfm]	f _z [inch]	v _c [sfm]	f _z [inch]	v _c [sfm]	f _z [inch]		
Preferable	M	1.1	Ferritic, Martensitic: 410 / 440 / 440C / 17-4 PH	325	0.004 x d ₁	395	0.004 x d ₁	460	0.005 x d ₁	525	0.006 x d ₁
		2.1	Austenitic: 303 / 304 / 316 / 316L / 321	260	0.004 x d ₁	325	0.004 x d ₁	360	0.005 x d ₁	425	0.006 x d ₁
		3.1	Austenitic-ferritic (Duplex)	165	0.003 x d ₁	195	0.003 x d ₁	230	0.004 x d ₁	260	0.004 x d ₁
		4.1	Austenitic-ferritic heat-resistant (Super Duplex)	130	0.003 x d ₁	165	0.003 x d ₁	195	0.004 x d ₁	195	0.004 x d ₁
Suitable	S	Special Materials									
		Titanium Alloys									
		1.1	Pure Titanium	230	0.005 x d ₁	260	0.005 x d ₁	325	0.006 x d ₁	360	0.007 x d ₁
		1.2	Titanium Alloys	195	0.004 x d ₁	230	0.004 x d ₁	260	0.005 x d ₁	325	0.006 x d ₁
	1.3	Titanium Alloys	100	0.003 x d ₁	130	0.003 x d ₁	130	0.004 x d ₁	165	0.004 x d ₁	

STANDARD LENGTH – SOLID SHANK

Valid for Tool Nos:

2977T
2978T

HELPFUL FORMULAS:

SFM = (RPM x D in) / 3.82

RPM = (SFM x 3.82) / D in

f_z feed/tooth = IPM / (#teeth x RPM)

IPM = RPM x #teeth x f_z

v_c = Cutting speed

f_z = Feed per tooth

N

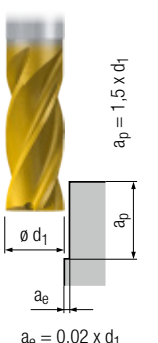
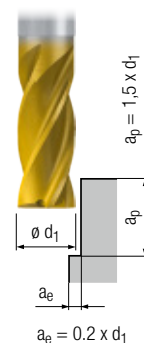
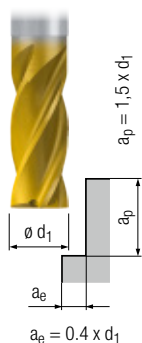
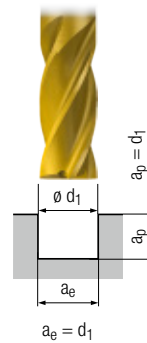

		Stainless Steel Materials									
		v _c [sfm]	f _z [inch]	v _c [sfm]	f _z [inch]	v _c [sfm]	f _z [inch]	v _c [sfm]	f _z [inch]		
Preferable	M	1.1	Ferritic, Martensitic: 410 / 440 / 440C / 17-4 PH	325	0.004 x d ₁	395	0.004 x d ₁	460	0.005 x d ₁	525	0.006 x d ₁
		2.1	Austenitic: 303 / 304 / 316 / 316L / 321	260	0.004 x d ₁	325	0.004 x d ₁	360	0.005 x d ₁	425	0.006 x d ₁
		3.1	Austenitic-ferritic (Duplex)	165	0.003 x d ₁	195	0.003 x d ₁	230	0.004 x d ₁	260	0.004 x d ₁
		4.1	Austenitic-ferritic heat-resistant (Super Duplex)	130	0.003 x d ₁	165	0.003 x d ₁	195	0.004 x d ₁	195	0.004 x d ₁
Suitable	S	Special Materials									
		Titanium Alloys									
		1.1	Pure Titanium	230	0.005 x d ₁	260	0.005 x d ₁	325	0.006 x d ₁	360	0.007 x d ₁
		1.2	Titanium Alloys	195	0.004 x d ₁	230	0.004 x d ₁	260	0.005 x d ₁	325	0.006 x d ₁
	1.3	Titanium Alloys	100	0.003 x d ₁	130	0.003 x d ₁	130	0.004 x d ₁	165	0.004 x d ₁	

Note: All cutting data serve for orientation only and should be adapted individually to the technical conditions on location.

WITH COOLANT THROUGH



Valid for Tool Nos:

2577TZ WITH CORNER RADIUS:
 2579TZ 3911TZ
 2581TZ 3913TZ

HELPFUL FORMULAS:

SFM = (RPM x D in) / 3.82
 RPM = (SFM x 3.82) / D in
 f_z feed/tooth = IPM / (#teeth x RPM)
 IPM = RPM x #teeth x f_z

2 X D

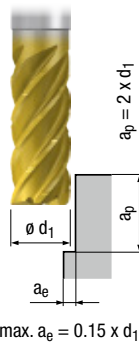

3 X D

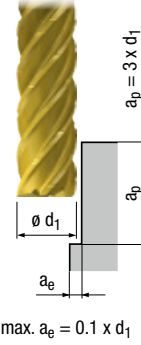

4 X D

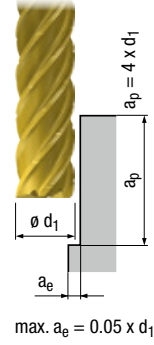









v_c = Cutting speed
 f_z = Feed per tooth

		v_c [sfm]	f_z [inch]	v_c [sfm]	f_z [inch]	v_c [sfm]	f_z [inch]	
Stainless Steel Materials								
Preferable M	1.1	Ferritic, Martensitic: 410 / 440 / 440C / 17-4 PH	490	0.008 x d1	455	0.008 x d1	425	0.008 x d1
	2.1	Austenitic: 303 / 304 / 316 / 316L / 321	425	0.008 x d1	390	0.008 x d1	360	0.008 x d1
	3.1	Austenitic-ferritic (Duplex)	360	0.007 x d1	325	0.007 x d1	295	0.007 x d1
	4.1	Austenitic-ferritic heat-resistant (Super Duplex)	325	0.007 x d1	295	0.007 x d1	260	0.007 x d1
Special materials								
Titanium alloys								
Preferable	1.1	Pure Titanium	460	0.007 x d1	425	0.007 x d1	395	0.007 x d1
	1.2	Titanium Alloys	425	0.007 x d1	395	0.007 x d1	360	0.007 x d1
	1.3		395	0.006 x d1	360	0.006 x d1	325	0.006 x d1
Nickel Alloys, Cobalt Alloys and Iron Alloys								
Suitable S	2.1	Pure Nickel	325	0.004 x d1	295	0.004 x d1	260	0.004 x d1
	2.2	Monel 500 / 718 Inconel annealed	100	0.004 x d1	100	0.004 x d1	80	0.004 x d1
	2.3	Nickel-base Alloys: 718 Inconel	130	0.004 x d1	130	0.004 x d1	115	0.004 x d1
	2.4	Cobalt-base Alloys	130	0.004 x d1	130	0.004 x d1	115	0.004 x d1
	2.5		130	0.004 x d1	115	0.004 x d1	100	0.004 x d1
	2.6		Iron-base Alloys	100	0.004 x d1	100	0.004 x d1	80

Note: All cutting data serve for orientation only and should be adapted individually to the technical conditions on location.

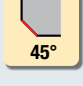
Icon Descriptions

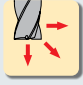
	<p>Tool type Finishing end mill design without chip breaker</p> 		<p>Tool type Semi-finishing end mill design with flat chip breaker</p> 
	<p>Internal coolant supply ICA = Internal coolant supply, axial exit</p>		<p>Coolant through</p>
 <p>Shank design for inch straight tools</p>  <p>Shank design for inch weldon shank</p>  <p>Shank design for inch straight and weldon shank</p>	<p>Shank design The shank designs to be found on the respective page are marked in gray.</p>	 <p>medium</p>  <p>fine</p>	<p>Chip breaker Depending on form (e.g. round or flat) and size (coarse, medium, fine) of the chip breakers, end mills generate appropriate milling marks shown.</p>
 <p>30°</p>	<p>Helix angle The helix angle of tools is shown. If there are variable helix angles, they are also shown.</p>	 <p>CR</p>	<p>Corner radius</p>
 <p>45°</p>  <p>CH x 45°</p>	<p>Chamfer</p>	 <p>3-5°</p>	<p>Ramping angle The specified angle is the recommended angle for ramping applications.</p>
	<p>Feed direction The red arrows mark the recommended feed directions of the respective cutters.</p>		



Ask about our tool grinding/ reconditioning services for EMUGE- FRANKEN end mills, taps and drills.

EMUGE-FRANKEN has the knowledge and manufacturing expertise to refurbish an EMUGE-FRANKEN tool to its original condition and specification, providing maximum performance levels, predictable operation, and longer life for a modest investment.

Reconditioning examples – End Mills



EMUGE-FRANKEN Reconditioning includes:

- Complete inspection and quotation.
- Complete regrinding to the original geometry of the tool.
- Reconditioning of EMUGE-FRANKEN end mills, drills and taps, or other brands of drills and end mills.
- Corner radius, Weldon flats and other modifications to standard end mills.
- PVD Coatings via state-of-the-art coating system.
- Prompt delivery of reground tools.

To learn more, visit:
emuge.com/reconditioning

EMUGE Corp.
1800 Century Drive, West Boylston, MA 01583
800-991-4225

© 2021 Emuge Corp. 5M-5/21MA Printed in USA

EMUGE-FRANKEN has been the product technology and performance leader in their field for 100 years. Emuge manufactures an extensive line of taps, drills, thread mills, end mills, toolholders, clamping devices and other rotary cutting tools, over 40,000 items sold through distributors worldwide.