

# QuadGroove<sup>®</sup>

*for Grooving*



# AHB

TOOLING & MACHINERY

COMPLETE METALWORKING SOLUTIONS

(800) 991-4225

[www.ahbinc.com](http://www.ahbinc.com)

ISO Certified

[customerservice@ahbinc.com](mailto:customerservice@ahbinc.com)

Edition 2019-05

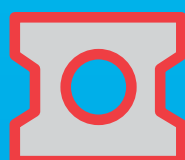

**Scandinavian  
Tool Systems**

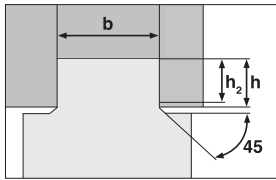

# Circlip grooves

DIN 471  
EXTERNAL GROOVING

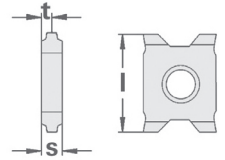

Circlip	Catalogue number	l	s	t	Dimensions			Stock standard		Price-group
					b ± 0.02	h	h <sub>2</sub> ± 0.02	T10C	T10R	
1.0	12E C1.1-0.2	12	2.4	1.2	1.21	0.2	0.16	*	*	31
1.0	12E C1.1-0.25	12	2.4	1.2	1.21	0.25	0.21	*	*	31
1.0	12E C1.1-0.3	12	2.4	1.2	1.21	0.3	0.26	*	*	31
1.0	12E C1.1-0.35	12	2.4	1.2	1.21	0.35	0.31	*	*	31
1.0	12E C1.1-0.4	12	2.4	1.2	1.21	0.4	0.36	*	*	31
1.2	12E C1.3-0.5	12	2.4	1.2	1.41	0.5	0.43	*	*	31
1.2	12E C1.3-0.55	12	2.4	1.2	1.41	0.55	0.48	*	*	31
1.2	12E C1.3-0.7	12	2.4	1.2	1.41	0.7	0.63	*	*	31
1.5	12E C1.6-0.7	12	2.4	1.2	1.71	0.7	0.60	*	*	31
1.5	12E C1.6-0.85	12	2.4	1.2	1.71	0.85	0.75	*	*	31
1.5	12E C1.6-1.0	12	2.4	1.2	1.71	1.0	0.90	*	*	31
1.75	12E C1.85-1.0	12	2.4	1.2	1.96	1.0	0.85	*	*	31
1.75	12E C1.85-1.25	12	2.4	1.2	1.96	1.25	1.10	*	*	31

Circlip	Catalogue number	l	s	t	Dimensions			Stock standard		Price-group
					b ± 0.02	h	h <sub>2</sub> ± 0.02	K20C	K20R	
2.0	20E C2.15-1.5	20	4.6	2.3	2.26	1.5	1.35	*	*	33
2.5	20E C2.65-1.5	20	4.6	2.3	2.76	1.5	1.35	*	*	33
2.5	20E C2.65-1.75	20	4.6	2.3	2.76	1.75	1.60	*	*	33
3.0	20E C3.15-1.75	20	4.6	2.3	3.26	1.75	1.60	*	*	33
4.0	20E C4.15-2.0	20	4.6	2.3	4.26	2.0	1.85	*	*	33
4.0	20E C4.15-2.5	20	4.6	2.3	4.26	2.5	2.35	*	*	33

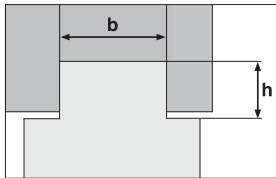

# Circlip grooves

DIN 471  
EXTERNAL GROOVING

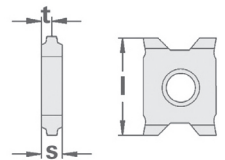

Circlip	Catalogue number	l	s	t	Dimensions		Stock standard		Price-group
					b ± 0.02	h	T10C	T10R	
0.8	12E C0.9-0.8	12	2.4	1.2	0.90	1.0	*	*	31
1.0	12E C1.1-1.0	12	2.4	1.2	1.10	1.2	*	*	31
1.2	12E C1.3-1.3	12	2.4	1.2	1.30	1.5	*	*	31
1.5	12E C1.6-1.5	12	2.4	1.2	1.60	1.8	*	*	31
1.75	12E C1.85-2.5	12	2.4	1.2	1.85	3.0	*	*	31

Circlip	Catalogue number	l	s	t	Dimensions		Stock standard		Price-group
					b ± 0.02	h	K20C	K20R	
2.0	20E C2.15-2.5	20	4.6	2.3	2.15	3.0	*	*	33
2.5	20E C2.65-2.5	20	4.6	2.3	2.65	3.0	*	*	33
3.0	20E C3.15-2.5	20	4.6	2.3	3.15	3.0	*	*	33
4.0	20E C4.15-3.5	20	4.6	2.3	4.15	3.5	*	*	33

Scandinavian tool System, Inc.

640 lakeview plaza blvd, suite c • Phone 800-991-4225  
Worthington, OH 43085