

Jetmix : Cleaning of the Nozzle

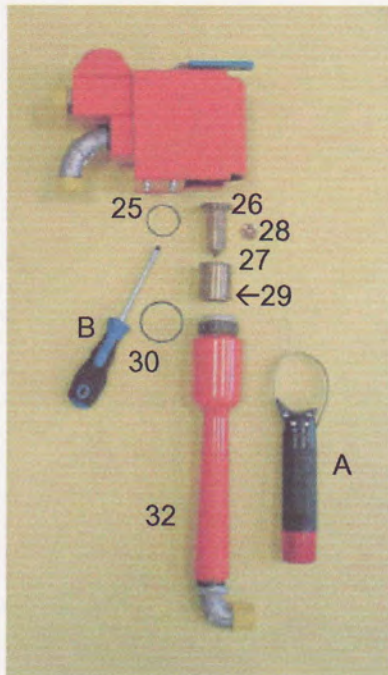

Legend :
 25 O-Ring
 26 Nozzle
 27 Spacer sleeve
 28 Twist
 29 Pin
 30 O-Ring
 32 Jetpipe
 A Grip wrench
 B Screw driver

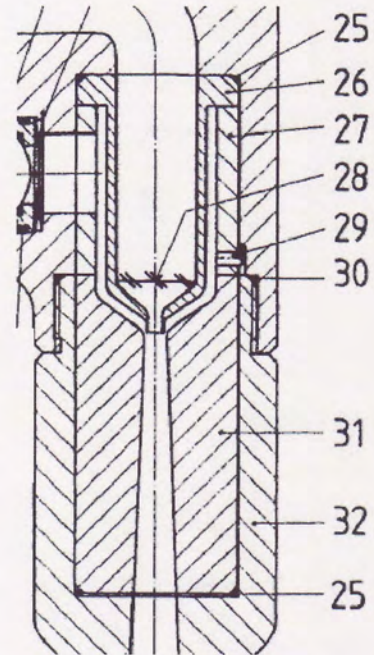

The most frequent cause for Jetmix device failures are blocked or clogged nozzles. They can easily be cleaned, however, by trained people. To clean the nozzles, use a grip wrench (A) and a screw driver (B). The O-rings must also be replaced (30 + ev. 25). Remove the Jetmix from the drum, the wall and the water pipe to clean it (→ step 6 a – b).

Procedure :

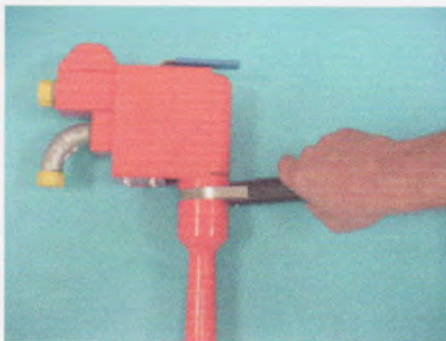

1. Unscrew jetpipe (32) with grip wrench or in a vise



2. Remove nozzle (26) with spacer sleeve (27) and twist (28)

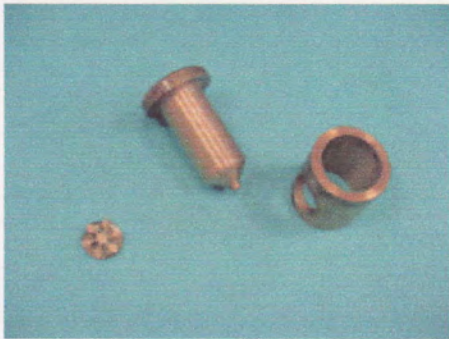

3. Clean nozzle (26), spacer sleeve (27) and twist (28)

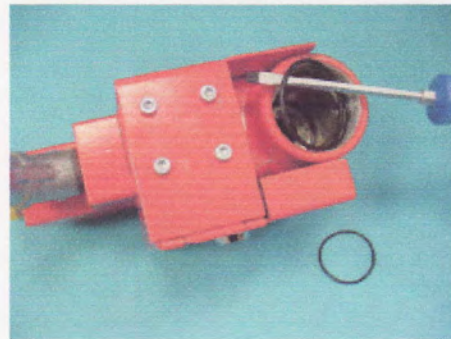

4. Replace O-Rings (30 + ev. 25)

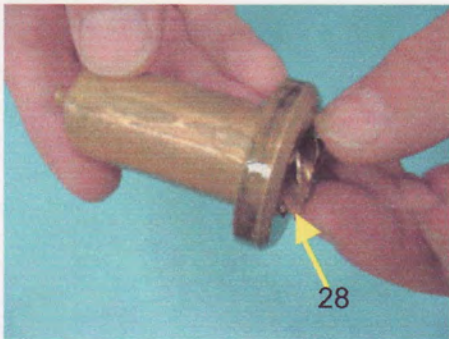

5. Carefully insert the twist (28) into the nozzle (26). Make sure it is not jammed.

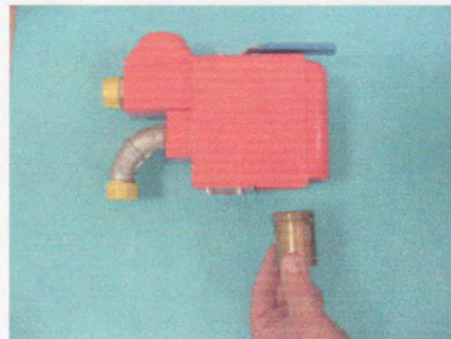

6 a) Install the completed nozzle (26+28) and the spacer sleeve (27) into Jetmix

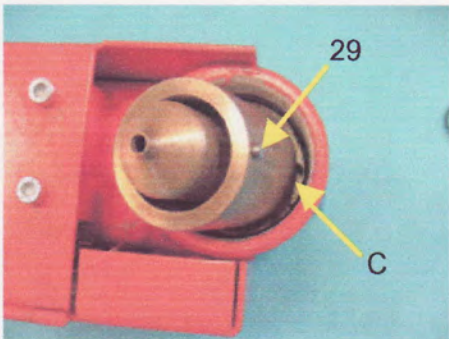

6 b) **Important** : Pin (29) must fit in slot (C)



7. Fasten jetpipe (32)