

LIQUIDTOOL.

AHB

TOOLING & MACHINERY

COMPLETE METALWORKING SOLUTIONS

(800) 991-4225

www.ahbinc.com

ISO Certified

customerservice@ahbinc.com



LIQUIDTOOL Sensor 01

Datasheet

Characteristics

- Plug & Play Installation
- Automatic measurement of concentration
- Magnetic mount
- Automatic measurement of temperature
- Low maintenance
- self cleaning refractometer

Three-side view

Front



Back

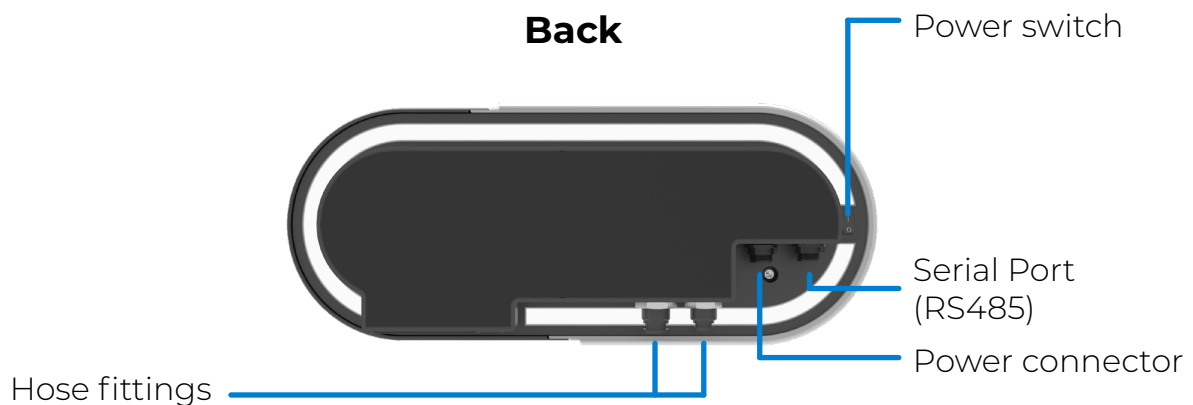

Bottom

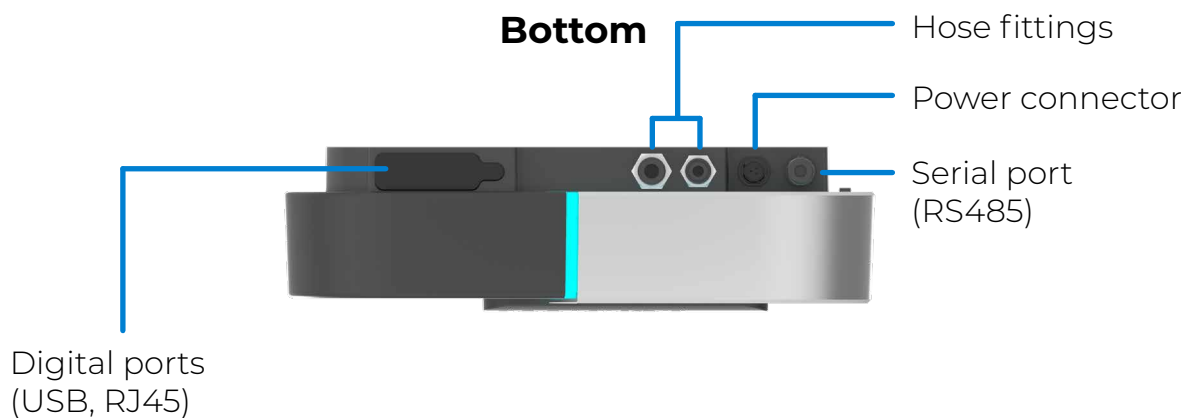

Specification

Name	LIQUIDTOOL Sensor 01 (LTS)		
Weight	Net: 3.1 kg	Gross: 4.5 kg	
Size (W x H x D) (mm)	317 x 130 x 84		
		Range	Resolution
Concentration [Brix]	Optical Refractometer (Total Reflection)	0 - 20 (+/- 0.3) - Below 2 Bx a one-time manual calibration may be necessary	0.1
Temperature [°C]	PT100/PT1000	0 - 50 (+/- 1)	1
Measuring Interval [min]	Selective	15 min - 60 min	15 min
Connections & Interfaces	Power Supply	100-240V 50/60Hz	24VDC / 2.5A screwed connector WEIPU SPI112/P2 N
	Digital Ports	RJ45, Bluetooth, USB, WiFi	USB disabled (not functional)
	Serial Port	RS485	Protocol: Modbus
	Tube connections	8 mm (Intake) 6 mm (Outlet)	
Device	Pump	Piston pump	Pump volume: 400 ml/min
	Filter	Particle size: 100µm	
	Tubing	Suction lift: 150 cm max.	
	IP enclosure rating	IP44	
	Fixation	Magnetic	
Operation conditions	5 to 40 °C; 0 to 95 % relative Humidity		
Storage temperature	-25 to 60 °C (dry)		

Scope of delivery

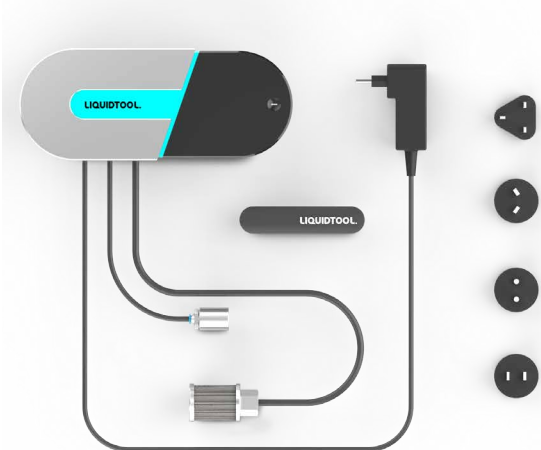

- 1 Sensor device
- 1 NFC token
- 2 Hoses (1x 8mm intake, 1x 6mm outlet)
- 1 Outlet weight
- 1 Intake filter
- 1 Power supply
- 4 Adapter plugs