

ITEM NO.	PART NUMBER	DESCRIPTION	QTY.
1	12106	80PSI HIGH PRESSURE GAUGE, BOTTOM MOUNT, 6IN DIAL	1
2	12327	ADAPTER, ACCUVALVE 50 3/8 HPF	1
3	12828	ACCUVALVE ACTUATOR ASSY	1
4	13157-60-6	3/8" HP COLLAR	3
5	13158-60-6	3/8" HP GLAND	3
6	13162-60-6F4M	ADAPTER 3/4"F-1/4"M	1
7	13165-60-6	3/8" HP CROSS	1
8	13166-60-6	3/8" HP TWO WAY STRAIGHT VALVE	1
9	13168-60-6-3	3/8" NIPPLE, 3" LONG	3
10	13168-60-6-6.5	3/8" HP NIPPLE 6.500 LONG	1
11	14141	VALVE BODY, WITH MOUNTING HOLES	2
12	11010	ACCU SEAT	2
13	11043	HP VALVE SEAL ASSEMBLY	2
14	11562	STRAIGHT NEEDLE	2
15	11743	FLOW REDUCER	1
16	12178	GUIDE, NEEDLE	2
17	14200	ADAPTER, ACCUVALVE TO 1/4" HP FEMALE	1
18	14207	COMPACT AIR ACTUATOR, NORMALLY OPEN	1
19	14727	MOUNTING PLATE FOR BLOCK AND BLEED	1
20	14728	BRACKET, HIGH PERFORMANCE VALVE	2
21	14729	BRACKET, 2-WAY VALVE	1
22	14755	SPACER, .5" OD X 1-1/16" L, FOR 1/4 SCREW	3
23	-	1/4" LOCK WASHER	3
24	-	1/4" WASHER	10
25	-	1/4-20 X 3/8" SOCKET BUTTON HEAD CAP SCREW	6
26	-	1/4-20 X 1/4" SOCKET BUTTON HEAD CAP SCREW	2
27	-	1/4-20 X 2-1/2" SOCKET HEAD CAP SCREW	3
28	-	1/4-28 X 1/2" SOCKET HEAD CAP SCREW	4
29	-	#10-24 X 1-1/2 SOCKET HEAD CAP SCREW	2
30	-	#10 WASHER	4
31	-	#10-24 LOCK NUT	2

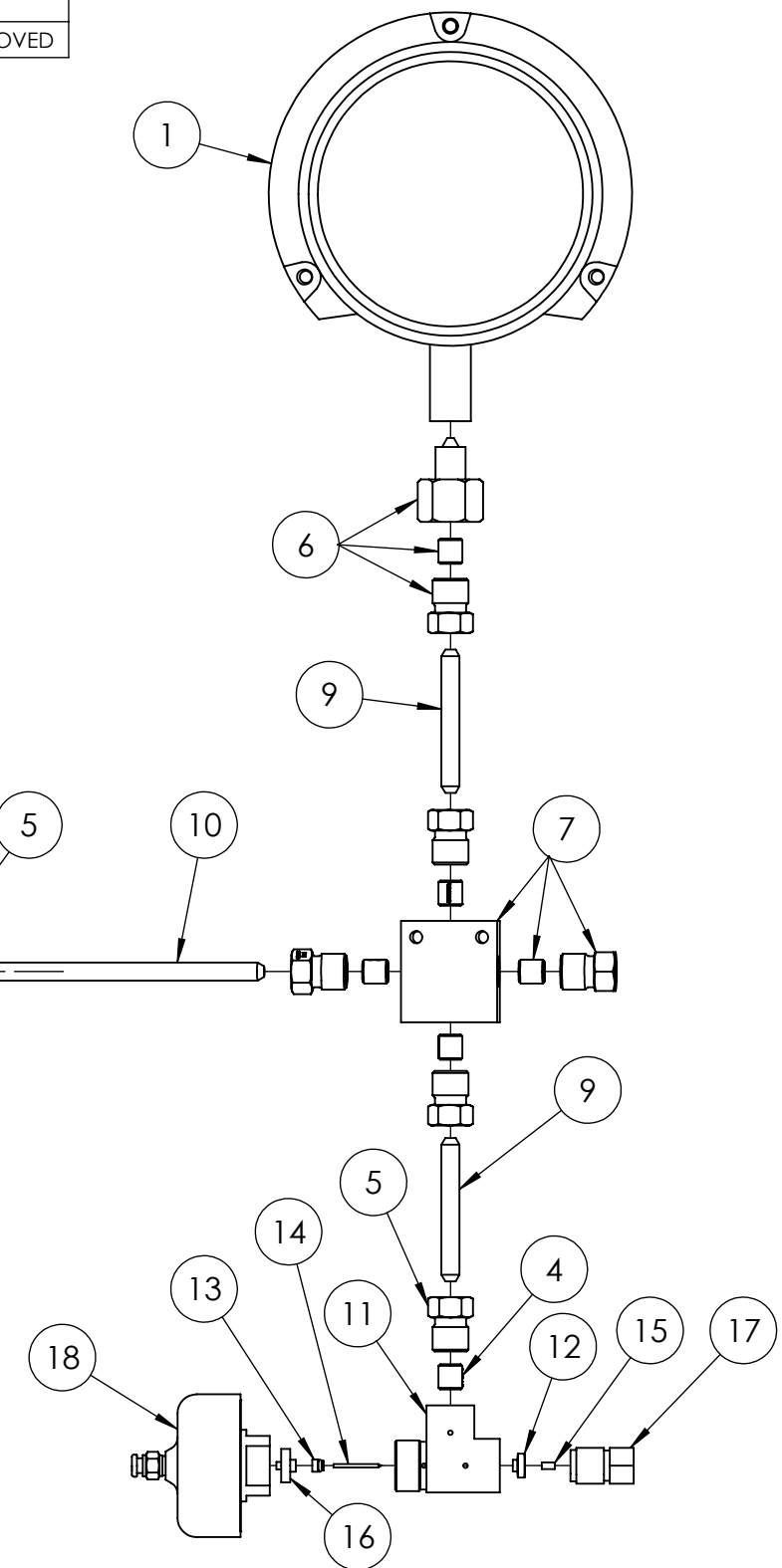
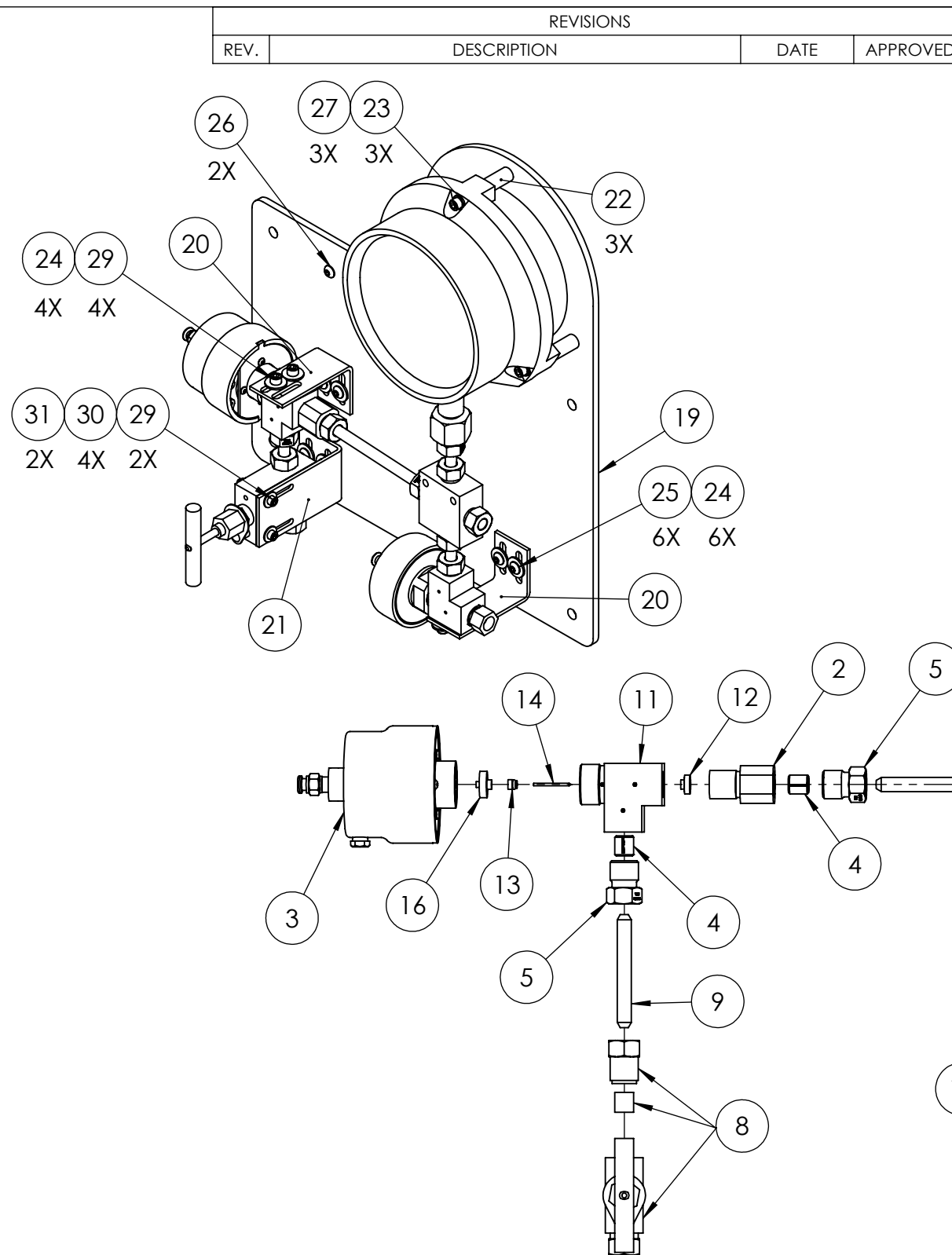

<b>HIGHLY CONFIDENTIAL PROPRIETARY INFORMATION</b>	<b>AccuStream™</b> <i>waterjet products</i>	ACCUSTREAM, INC. 309 5TH AVENUE NW    PHONE: 651-294-8600 NEW BRIGHTON, MN 55112    FAX: 651-294-8620 EMAIL: INFO@ACCUSTREAM.COM WEB: WWW.ACCUSTREAM.COM	TITLE:  <b>BLOCK AND BLEED</b>																		
ALL DATA AND INFORMATION ON THIS DOCUMENT IS FOR THE SOLE USE OF ACCUSTREAM AND ITS LICENSEES AND MAY NOT BE USED WITHOUT PERMISSION	-TOLERANCES- UNLESS OTHERWISE SPECIFIED DIMENSIONS IN INCHES  ANGULAR: MACH ± 1    BEND ± 1 ONE PLACE DECIMAL ± .05 TWO PLACE DECIMAL ± .015 THREE PLACE DECIMAL ± .005	<table border="1" style="width: 100%; border-collapse: collapse;"> <thead> <tr> <th>NAME</th> <th>DATE</th> <th>MATERIAL</th> </tr> </thead> <tbody> <tr> <td>DRAWN</td> <td>NMS 8/3/2012</td> <td>Material &lt;not specified&gt;</td> </tr> <tr> <td>CHECKED</td> <td>AJV 8/6/2012</td> <td>HARDNESS</td> </tr> <tr> <td>ENG APPR.</td> <td>AJV 8/6/2012</td> <td>WEIGHT</td> </tr> </tbody> </table>	NAME	DATE	MATERIAL	DRAWN	NMS 8/3/2012	Material <not specified>	CHECKED	AJV 8/6/2012	HARDNESS	ENG APPR.	AJV 8/6/2012	WEIGHT	<table border="1" style="width: 100%; border-collapse: collapse;"> <tr> <td style="width: 15%;">SHEET 1 OF 1</td> <td style="width: 15%;">SCALE: 1:4</td> <td style="width: 15%;">FINISH -</td> </tr> <tr> <td style="width: 15%;">SIZE <b>B</b></td> <td style="width: 45%;">DWG. NO. <b>14752</b></td> <td style="width: 25%;">REV <b>A</b></td> </tr> </table>	SHEET 1 OF 1	SCALE: 1:4	FINISH -	SIZE <b>B</b>	DWG. NO. <b>14752</b>	REV <b>A</b>
NAME	DATE	MATERIAL																			
DRAWN	NMS 8/3/2012	Material <not specified>																			
CHECKED	AJV 8/6/2012	HARDNESS																			
ENG APPR.	AJV 8/6/2012	WEIGHT																			
SHEET 1 OF 1	SCALE: 1:4	FINISH -																			
SIZE <b>B</b>	DWG. NO. <b>14752</b>	REV <b>A</b>																			
<b>BREAK AND DEBURR ALL EDGES .015 MAX</b>																					