



**J E T**®

**AIR TOOLS,  
HYDRAULIC AND SHOP**

**MAKING TOUGH JOBS EASY**

**JETTOOLS.COM**



# JET®



## TABLE OF CONTENTS

LIGHT INDUSTRIAL

|                                 |       |
|---------------------------------|-------|
| ANGLE GRINDERS .....            | 3     |
| DIE GRINDERS.....               | 4-5   |
| DRILLS.....                     | 6-7   |
| IMPACT WRENCHES .....           | 8-9   |
| SCREWDRIVERS .....              | 10-11 |
| RATCHETS .....                  | 12    |
| RIVETING HAMMERS .....          | 13    |
| MINI BELT SANDERS .....         | 14    |
| SANDERS & POLISHERS ....        | 15    |
| MISCELLANEOUS<br>AIR TOOLS..... | 16-17 |
| AIR TOOL ACCESSORIES ....       | 18-19 |

INDUSTRIAL

|                           |    |
|---------------------------|----|
| IMPACT WRENCHES .....     | 20 |
| PNEUMATIC DRILL .....     | 21 |
| ROCK DRILL.....           | 21 |
| HORIZONTAL GRINDERS ..... | 22 |
| SAND RAMMERS.....         | 22 |
| RIVET BUSTERS .....       | 22 |
| CHIPPING HAMMERS.....     | 23 |
| PAVING BREAKERS .....     | 24 |

HYDRAULIC & SHOP

|                                    |       |
|------------------------------------|-------|
| HYDRAULIC<br>BOTTLE JACKS .....    | 25-26 |
| TOE AND SCREW JACKS ...            | 27    |
| BODY REPAIR KIT .....              | 28    |
| SERVICE JACKS .....                | 28    |
| AIR/HYDRAULIC<br>SERVICE JACK..... | 29    |
| HEAVY-DUTY<br>JACK STANDS .....    | 29    |
| FARM JACK.....                     | 30    |
| WARRANTY<br>INFORMATION.....       | 31    |



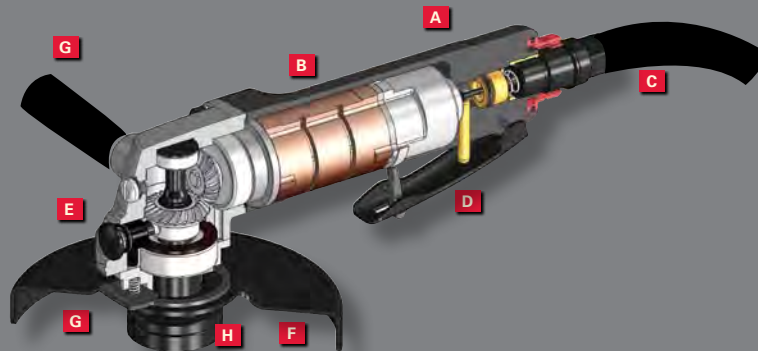

- A | Ergonomic handle design for increased comfort
- B | Light weight composite body
- C | Rear exhaust silencer
- D | Safety throttle lever
- E | Convenient spindle lock
- F | Swiveling wheel guard
- G | Vibration absorbing handle
- H | Tool less wheel nut (available only on (526345))

**AG ERGO GRIP ANGLE GRINDERS**

- Speed regulating governor maintains constant speed and torque control while grinding and prevents over-speed with free running
- Light weight composite body
- Wheel guard adjusts to 9 different positions without tools
- Vibration absorbing handle allows longer use without operator fatigue
- Quiet operation. Grinder operates at 79db
- Throttle lever features automatic lock for added safety
- Heavy Duty ball bearing construction for vibration free performance
- Durable precision machined and hardened steel gears
- Grinding wheel not included



ERGO GRIP™

**SPECIFICATIONS**

| STOCK NUMBER | MODEL NUMBER | WHEEL SIZE (DIA X BORE X THK/IN) | SPINDLE THREAD (IN/TPI) | HORSE POWER (HP) | FREE SPEED (RPM) | AIR PRESSURE (PSI) | AIR CONSUMP. (CFM) | AIR INLET (NPT/IN) | AIR HOSE (ID/IN) | VIBRATION VALUE (M/S2) | OVERALL LENGTH (IN) | NOISE LEVEL (DB) | WEIGHT (LBS) |
|--------------|--------------|----------------------------------|-------------------------|------------------|------------------|--------------------|--------------------|--------------------|------------------|------------------------|---------------------|------------------|--------------|
| 526340       | AG-4S        | 4 x 5/8 x 1/4                    | 3/8-24                  | 3/4              | 10000            | 90                 | 4                  | 1/4                | 3/8              | 0.65                   | 9                   | 83               | 9-3/4        |
| 526345       | AG-4.5S      | 4.5 x 5/8 x 1/4                  | 5/8-11                  | 3/4              | 10000            | 90                 | 4                  | 1/4                | 3/8              | 0.65                   | 9                   | 83               | 10           |

**JSG ANGLE GRINDERS**

- Heavy Duty ball bearing construction
- Durable precision machined and hardened steel gears
- Rugged aluminum alloy housing with steel wheel guards
- Features safety lock throttle and dead handles
- Grinding wheel not included



**SPECIFICATIONS**

| STOCK NUMBER | WHEEL SIZE (DIA X BORE X THK/IN) | SPINDLE THREAD (IN/TPI) | HORSE POWER (HP) | FREE SPEED (RPM) | AIR PRESSURE (PSI) | AIR CONSUMP. (CFM) | AIR INLET (NPT/IN) | AIR HOSE (ID/IN) | VIBRATION VALUE (M/S2) | OVERALL LENGTH (IN) | NOISE LEVEL (DB) | WEIGHT (LBS) |
|--------------|----------------------------------|-------------------------|------------------|------------------|--------------------|--------------------|--------------------|------------------|------------------------|---------------------|------------------|--------------|
| JSG-0522     | 7 x 7/8 x 1/4                    | 5/8-11                  | 1                | 7000             | 90                 | 7                  | 1/4                | 3/8              | 2.6                    | 14                  | 108              | 7.01         |
| JSM-619      | 4 x 5/8 x 1/4                    | 3/8-24                  | 1/2              | 11,000           | 90                 | 4                  | 1/4                | 3/8              | 2.7                    | 6-3/4               | 96               | 3.75         |
| JSM-6195B    | 5 x 5/8 x 1/4                    | 5/8-11                  | 1/2              | 11,000           | 90                 | 4                  | 1/4                | 3/8              | 2.7                    | 6-3/4               | 96               | 3.86         |

**JNS ANGLE GRINDER**

- Built In regulator for speed control
- Features safety lock throttle and dead handle
- Soft molded grip for increased comfort



**SPECIFICATIONS**

| STOCK NUMBER | WHEEL SIZE (DIA X BORE X THK/IN) | SPINDLE THREAD (IN/TPI) | HORSE POWER (HP) | FREE SPEED (RPM) | AIR PRESSURE (PSI) | AIR CONSUMPTION (CFM) | AIR INLET (NPT/IN) | AIR HOSE (ID/IN) | VIBRATION VALUE (M/S2) | OVERALL LENGTH (IN) | NOISE LEVEL (DB) | WEIGHT (LBS) |
|--------------|----------------------------------|-------------------------|------------------|------------------|--------------------|-----------------------|--------------------|------------------|------------------------|---------------------|------------------|--------------|
| JNS-185      | 4 x 5/8 x 1/4                    | 3/8-24                  | 1/4              | 11,000           | 90                 | 4                     | 1/4                | 3/8              | 2.7                    | 6-3/4               | 96               | 3            |





# DIE GRINDERS



- A** Ergonomic handle design for increased comfort
- B** Built in hose swivel keeps air hose from getting tangled
- C** Built in air regulator for precise speed control
- D** Safety throttle lock – Prevents accidental use
- E** Industrial duty designed air motor for increased power and long tool life

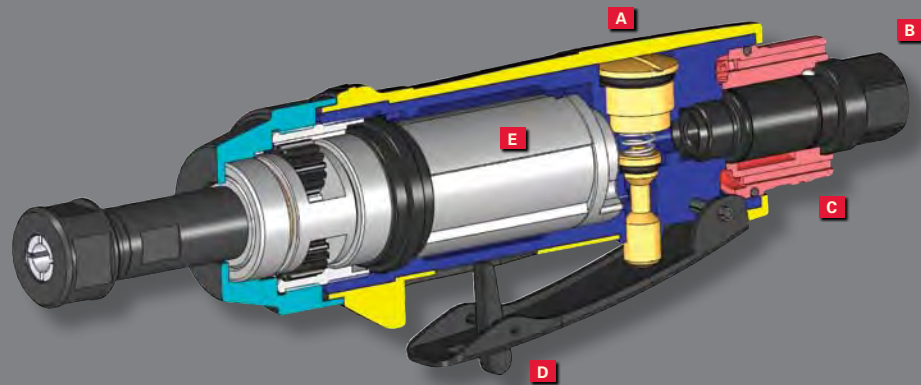

# ERGO GRIP™



JSM-5130



JSM-5252



JSM-5430



JSM-5130L



## JSM ERGO GRIP DIE GRINDERS

- Ergonomic grip for operator comfort
- Built in air regulator for precise speed control
- Equipped with a safety throttle lock
- Heavy duty ball bearing construction
- Rotating air inlet keeps air hose twist free
- Low noise volume for operator comfort

### SPECIFICATIONS

| STOCK NUMBER | COLLET SIZE (IN) | HORSE POWER (HP) | FREE SPEED (RPM) | AIR PRESSURE (PSI) | AIR CONSUMPTION (CFM) | AIR INLET (NPT/IN) | AIR HOSE (ID/IN) | VIBRATION VALUE (M/S <sup>2</sup> ) | OVERALL LENGTH (IN) | NOISE LEVEL (DB) | WEIGHT (LBS) |
|--------------|------------------|------------------|------------------|--------------------|-----------------------|--------------------|------------------|-------------------------------------|---------------------|------------------|--------------|
| JSM-5130     | 1/4              | 1/2              | 20,000           | 90                 | 4                     | 1/4                | 3/8              | 1.68                                | 7-2/5               | 79               | 1-1/2        |
| JSM-5430     | 1/4              | 1/2              | 4,000            | 90                 | 4                     | 1/4                | 3/8              | 2.2                                 | 8-3/5               | 79               | 2            |
| JSM-5130L    | 1/4              | 1/2              | 20,000           | 90                 | 4                     | 1/4                | 3/8              | 1.15                                | 13-7/10             | 79               | 3            |
| JSM-5252     | 1/4              | 1/4              | 20,000           | 90                 | 4                     | 1/4                | 3/8              | 1.24                                | 6-1/4               | 79               | 1            |



JSM-516N



JSM-501



JSM-512F



JSM-532



JSM-512A



JSM-522A



526201



**JSM DIE GRINDERS**

- Lightweight yet powerful and compact design
- Heavy-duty ball bearing construction for vibration-free performance
- Durable precision machined hand hardened steel gears
- Variable speed throttle with self-closing lever
- All models except MG-1B feature safety throttle lock
- Front exhaust on JSM-501 and MG-1B models keeps work area clean
- JSM-516N includes 68-3/4" air hose with fitting

**SPECIFICATIONS**

| STOCK NUMBER | COLLET SIZE (IN) | SPINDLE THREAD (IN/TPI) | HORSE POWER (HP) | FREE SPEED (RPM) | AIR PRESSURE (PSI) | AIR CONSUMPTION (CFM) | AIR INLET (NPT/IN) | AIR HOSE (ID/IN) | VIBRATION VALUE (M/S2) | OVERALL LENGTH (IN) | NOISE LEVEL (DB) | WEIGHT (LBS) |
|--------------|------------------|-------------------------|------------------|------------------|--------------------|-----------------------|--------------------|------------------|------------------------|---------------------|------------------|--------------|
| JSM-516N     | 1/8              | -                       | 1/16             | 54,000           | 90                 | 4                     | 1/8                | 3/8              | 4.8                    | 5-1/4               | 88               | 1/4          |
| JSM-501      | 1/4              | -                       | 1/4              | 22,000           | 90                 | 4                     | 1/                 | 3/8              | 3                      | 7                   | 81               | 1-1/4        |
| JSM-512A     | 1/4              | -                       | 1/4              | 22,000           | 90                 | 4                     | 1/4                | 3/8              | 5.4                    | 6-3/4               | 93               | 1-1/8        |
| JSM-512F     | 1/4              | -                       | 1/4              | 22,000           | 90                 | 4                     | 1/4                | 3/8              | 5.4                    | 13-1/4              | 93               | 2-1/2        |
| JSM-522A     | 1/4              | -                       | 1/4              | 22,000           | 90                 | 4                     | 1/4                | 3/8              | 2.2                    | 6-1/4               | 85               | 1            |
| JSM-532      | 1/4              | -                       | 1/4              | 25,000           | 90                 | 4                     | 1/4                | 3/8              | .9                     | 6                   | 91               | 1            |
| 526201       | 1/4              | 3/8-24                  | 1/2              | 20,000           | 90                 | 12                    | 1/4                | 3/8              | 10.2                   | 6-1/16              | 77               | 1-1/4        |



JNS-7034



JNS-7033E



JNS-7032



JNS-7033



**JNS DIE GRINDERS**

- All models feature throttle lever safety lock
- Built in air regulator for precise speed control
- Lightweight design
- Soft molded grip for increased comfort during use

**SPECIFICATIONS**

| STOCK NUMBER | COLLET SIZE (IN) | SPINDLE THREAD (IN/TPI) | HORSE POWER (HP) | FREE SPEED (RPM) | AIR PRESSURE (PSI) | AIR CONSUMPTION (CFM) | AIR INLET (NPT/IN) | AIR HOSE (ID/IN) | VIBRATION VALUE (M/S2) | OVERALL LENGTH (IN) | NOISE LEVEL (DB) | WEIGHT (LBS) |
|--------------|------------------|-------------------------|------------------|------------------|--------------------|-----------------------|--------------------|------------------|------------------------|---------------------|------------------|--------------|
| JNS-7032     | 1/4              | -                       | 1/4              | 25,000           | 90                 | 4                     | 1/4                | 3/8              | 2.2                    | 6                   | 93               | 1            |
| JNS-7033     | 1/4              | -                       | 1/4              | 22,000           | 90                 | 4                     | 1/4                | 3/8              | 5.4                    | 6-3/4               | 85               | 1-1/8        |
| JNS-7033E    | 1/4              | -                       | 1/4              | 22,000           | 90                 | 4                     | 1/4                | 3/8              | 5.4                    | 10-1/4              | 93               | 2            |
| JNS-7034     | 1/4              | -                       | 1/4              | 20,000           | 90                 | 4                     | 1/4                | 3/8              | 2.2                    | 6-1/4               | 85               | 1            |

- A | Conveniently located, top mounted Forward/Reverse switch
- B | Ergonomic Grip for operator comfort
- C | Rotating air inlet keeps air hose tangle free
- D | Variable speed throttle valve for positive speed control
- E | Industrial Duty Jacobs Keyed Chuck
- F | Industrial duty designed air motor



## ERGO GRIP™



JSM-7572

JSM-7472



### JSM ERGO GRIP AIR DRILLS

- Ball bearing and needle bearing construction for more efficient performance
- Muffled Handle Exhaust for quiet operation
- Pistol grip models have variable speed triggers for positive control
- All models equipped with Jacobs chucks
- 1/2" model has an auxiliary side handle for better control

#### SPECIFICATIONS

| STOCK NUMBER | REVERSIBLE | CHUCK SIZE (IN) | SPINDLE THREAD (IN/TPI) | HORSE POWER (HP) | FREE SPEED (RPM) | AIR PRESSURE (PSI) | AIR CONSUMPTION (CFM) | AIR INLET (NPT/IN) | AIR HOSE (ID/IN) | VIBRATION VALUE (M/S2) | OVERALL LENGTH (IN) | NOISE LEVEL (DB) | WEIGHT (LBS) |
|--------------|------------|-----------------|-------------------------|------------------|------------------|--------------------|-----------------------|--------------------|------------------|------------------------|---------------------|------------------|--------------|
| JSM-7572     | YES        | 3/8             | 3/8-24                  | 1/2              | 1800             | 90                 | 4                     | 1/4                | 3/8              | 0.4                    | 7-1/3               | 83               | 3            |
| JSM-7472     | YES        | 1/2             | 3/8-24                  | 1/2              | 800              | 90                 | 4                     | 1/4                | 3/8              | 0.2                    | 8-4/5               | 83               | 3-3/4        |





JSM-704



JSM-705



JSM-709R



JSM-724



JSM-725



**JSM AIR DRILLS**

- Ball bearing and needle bearing construction for more efficient performance
- Muffled Handle Exhaust for quiet operation
- All pistol grip models have variable speed triggers for positive control
- All models equipped with Jacobs Industrial chucks
- All 1/2" models have an auxiliary side handle for better control

**SPECIFICATIONS**

| STOCK NUMBER | REVERSIBLE | CHUCK SIZE (IN) | SPINDLE THREAD (IN/TPI) | HORSE POWER (HP) | FREE SPEED (RPM) | AIR PRESSURE (PSI) | AIR CONSUMPTION (CFM) | AIR INLET (NPT/IN) | AIR HOSE (ID/IN) | VIBRATION VALUE (M/S <sup>2</sup> ) | OVERALL LENGTH (IN) | NOISE LEVEL (DB) | WEIGHT (LBS) |
|--------------|------------|-----------------|-------------------------|------------------|------------------|--------------------|-----------------------|--------------------|------------------|-------------------------------------|---------------------|------------------|--------------|
| JSM-704      | YES        | 1/2             | 3/8-24                  | 1/2              | 800              | 90                 | 4                     | 1/4                | 3/8              | 2.2                                 | 7                   | 90               | 3-1/8        |
| JSM-705      | YES        | 3/8             | 3/8-24                  | 1/2              | 1800             | 90                 | 4                     | 1/4                | 3/8              | 5.4                                 | 6-1/2               | 89               | 2-3/8        |
| JSM-709R     | YES        | 3/8             | 3/8-24                  | 1/2              | 1900             | 90                 | 4                     | 1/4                | 3/8              | 2.6                                 | 8-1/4               | 91               | 2-1/2        |
| JSM-724      | YES        | 1/2             | 3/8-24                  | 1/2              | 800              | 90                 | 4                     | 1/4                | 3/8              | 2.2                                 | 7-1/2               | 90               | 3-1/8        |
| JSM-725      | YES        | 3/8             | 3/8-24                  | 1/2              | 1800             | 90                 | 4                     | 1/4                | 3/8              | 4.4                                 | 7                   | 89               | 2-1/2        |

**JNS AIR DRILLS**

- Models feature comfort grips
- Both models feature keyless chucks
- Variable speed throttle
- Heavy duty ball bearing construction
- Handle exhaust



JNS-4031KL

JNS-4041KL

**SPECIFICATIONS**

| STOCK NUMBER | REVERSIBLE | CHUCK SIZE (IN) | SPINDLE THREAD (IN/TPI) | HORSE POWER (HP) | FREE SPEED (RPM) | AIR PRESSURE (PSI) | AIR CONSUMPTION (CFM) | AIR INLET (NPT/IN) | AIR HOSE (ID/IN) | VIBRATION VALUE (M/S <sup>2</sup> ) | OVERALL LENGTH (IN) | NOISE LEVEL (DB) | WEIGHT (LBS) |
|--------------|------------|-----------------|-------------------------|------------------|------------------|--------------------|-----------------------|--------------------|------------------|-------------------------------------|---------------------|------------------|--------------|
| JNS-4041KL   | YES        | 1/2             | 3/8-24                  | 1/4              | 400              | 90                 | 8                     | 1/4                | 3/8              | 2.2                                 | 8                   | 79               | 3-1/2        |
| JNS-4031KL   | YES        | 3/8             | 3/8-24                  | 1/4              | 1800             | 90                 | 4                     | 1/4                | 3/8              | 5.4                                 | 7                   | 78               | 2-1/2        |

- A | Heavy-duty, lightweight composite motor housing
- B | Variable torque settings
- C | Advanced trigger design, for precise control
- D | Powerful twin hammer mechanism for maximum torque
- E | Heavy-duty industrial air motor
- F | Rotating air inlet

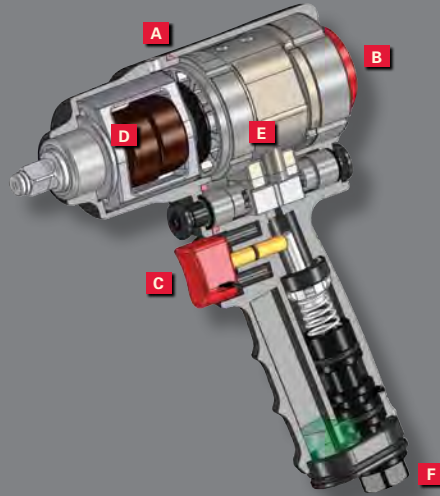

ERGO GRIP™



### JSM ERGO GRIP IMPACT WRENCHES

- Ergonomic Grip for increased operator comfort
- Multiple torque setting available with easy to use dial on back of impact wrench
- Heavy duty ball bearing construction
- Rotating air inlet keeps air hose twist free
- Low noise volume
- Super light weight composite design
- All models feature powerful twin hammer mechanism

#### SPECIFICATIONS

| STOCK NUMBER | SQUARE DRIVE (IN) | BOLT CAPACITY (IN) | ANVIL RETAINER TYPE | MAX TORQUE (FT/LBS) | FREE SPEED (RPM) | AIR PRESSURE (PSI) | AIR CONSUMPTION (CFM) | AIR INLET (NPT/IN) | AIR HOSE (ID/IN) | VIBRATION VALUE (M/S <sup>2</sup> ) | NOISE LEVEL (DB) | OVERALL LENGTH (IN) | WEIGHT (LBS) |
|--------------|-------------------|--------------------|---------------------|---------------------|------------------|--------------------|-----------------------|--------------------|------------------|-------------------------------------|------------------|---------------------|--------------|
| JSM-4340     | 1/2               | 3/4                | RING                | 600                 | 7000             | 90                 | 4.4                   | 1/4                | 3/8              | 2.8                                 | 88               | 8                   | 5            |
| JSM-4140     | 3/8               | 1/2                | RING                | 200                 | 9000             | 90                 | 4                     | 1/4                | 3/8              | 3.9                                 | 83               | 6                   | 2-3/4        |
| JSM-4341     | 1/2               | 1/2                | RING                | 250                 | 9000             | 90                 | 4                     | 1/4                | 3/8              | 3.9                                 | 83               | 6                   | 2-3/4        |
| JSM-4540     | 3/4               | 1-1/2              | RING                | 1400                | 5500             | 90                 | 4                     | 1/4                | 3/8              | 3.9                                 | 83               | 6                   | 8            |
| JSM-4072     | 1/4               | 3/8                | RING                | 75                  | 11,000           | 90                 | 4                     | 1/4                | 3/8              | 3.9                                 | 83               | 6                   | 2.35         |







JSM-401



JSM-403



JSG-0716N



JSG-0717SH



JSG-0750



**JSM/JSG IMPACT WRENCHES**

- Built in air regulator for positive speed control
- Front and or rear bumper guards
- Models JSM-401 and JSM-403 feature a single hammer clutch mechanism
- Models JSG-0716N, JSG-0750, JSG-0717SH, feature a powerful pin clutch hammer mechanism

**SPECIFICATIONS**

| STOCK NUMBER | SQUARE DRIVE (IN) | BOLT CAPACITY (IN) | ANVIL RETAINER TYPE | MAX TORQUE (FT/LBS) | FREE SPEED (RPM) | AIR PRESSURE (PSI) | AIR CONSUMPTION (CFM) | AIR INLET (NPT/IN) | AIR HOSE (ID/IN) | VIBRATION VALUE (M/S <sup>2</sup> ) | NOISE LEVEL (DB) | OVERALL LENGTH (IN) | WEIGHT (LBS) |
|--------------|-------------------|--------------------|---------------------|---------------------|------------------|--------------------|-----------------------|--------------------|------------------|-------------------------------------|------------------|---------------------|--------------|
| JSM-401      | 3/8               | 3/8                | RING                | 75                  | 10000            | 90                 | 3                     | 1/4                | 3/8              | 13.4                                | 108              | 5                   | 2            |
| JSM-403      | 1/2               | 5/8                | RING                | 250                 | 7000             | 90                 | 4                     | 1/4                | 3/8              | 11.6                                | 108              | 6-1/4               | 5            |
| JSG-0716N    | 1/2               | 5/8                | RING                | 280                 | 7000             | 90                 | 4                     | 1/4                | 3/8              | 2.8                                 | 101              | 7-1/4               | 5            |
| JSG-0717SH   | 1/2               | 5/8                | RING                | 380                 | 7000             | 90                 | 5                     | 1/4                | 3/8              | 2.5                                 | 88.2             | 7-5/8               | 6            |
| JSG-0750     | 3/4               | 1                  | RING/HOLE           | 500                 | 4500             | 90                 | 10                    | 1/4                | 3/8              | 11                                  | 105              | 8                   | 10           |

**JNS IMPACT WRENCHES**

- Light weight aluminum body
- Built In air regulator
- Swivel air inlet for easy maneuvering
- Compact size for tight spaces



JNS-5030

**SPECIFICATIONS**

| STOCK NUMBER | SQUARE DRIVE (IN) | BOLT CAPACITY (IN) | ANVIL RETAINER TYPE | MAX TORQUE (FT/LBS) | FREE SPEED (RPM) | AIR PRESSURE (PSI) | AIR CONSUMPTION (CFM) | AIR INLET (NPT/IN) | AIR HOSE (ID/IN) | VIBRATION VALUE (M/S <sup>2</sup> ) | NOISE LEVEL (DB) | OVERALL LENGTH (IN) | WEIGHT (LBS) |
|--------------|-------------------|--------------------|---------------------|---------------------|------------------|--------------------|-----------------------|--------------------|------------------|-------------------------------------|------------------|---------------------|--------------|
| JNS-5030     | 3/8               | 3/8                | RING                | 75                  | 10000            | 90                 | 3                     | 1/4                | 3/8              | 13.4                                | 108              | 5                   | 2            |



# AIR SCREWDRIVERS



- A | Conveniently located top mounted forward / reverse switch
- B | Ergonomic grip for operator comfort
- C | Rotating air inlet keeps air hose tangle free
- D | Variable speed throttle valve for positive speed control
- E | Industrial duty designed air motor



## ERGO GRIP™



### JSM ERGO GRIP AIR SCREWDRIVERS

- Ergonomic handle design
- Ball and needle bearing construction for more efficient performance
- Muffled handle exhaust for quiet operation
- All pistol grip models have variable speed triggers for positive control
- All models have quick action reversing valve and quick change chuck to accept standard 1/4" hex bits
- All adjustable clutch models have minimum torque
- Rotating air inlet
- Rear exhaust

#### REPLACEMENT CLUTCH SPRINGS

| STOCK NUMBER | COLOR  | TORQUE RANGE |
|--------------|--------|--------------|
| J80237G      | GREEN  | 45-90        |
| J80237B      | BLACK  | 45-115       |
| J80237Y      | YELLOW | 45-145       |



J80237G



J80237B



J80237Y

#### SPECIFICATIONS

| STOCK NUMBER | CHUCK TYPE | CHUCK SIZE (IN) | HORSE POWER (HP) | FREE SPEED (RPM) | TORQUE (FT/LBS) | AIR PRESSURE (PSI) | AIR CONSUMPTION (CFM) | AIR INLET (NPT/IN) | AIR HOSE (ID/IN) | VIBRATION VALUE (M/S <sup>2</sup> ) | OVERALL LENGTH (IN) | NOISE LEVEL (DB) | WEIGHT (LBS) |
|--------------|------------|-----------------|------------------|------------------|-----------------|--------------------|-----------------------|--------------------|------------------|-------------------------------------|---------------------|------------------|--------------|
| JSM-8272     | ADJUSTABLE | 1/4             | 1/2              | 1800             | 45-115          | 90                 | 4                     | 1/4                | 3/8              | 0.3                                 | 7-3/4               | 83               | 2-3/4        |
| JSM-8372     | ADJUSTABLE | 1/4             | 1/2              | 800              | 45-145          | 90                 | 4                     | 1/4                | 3/8              | 0.3                                 | 8-3/8               | 83               | 3            |
| JSM-8672     | POSITIVE   | 1/4             | 1/2              | 800              | 145             | 90                 | 4                     | 1/4                | 3/8              | 0.3                                 | 7-3/16              | 83               | 3-1/2        |
| JSM-8472     | POSITIVE   | 1/4             | 1/2              | 1800             | 115             | 90                 | 4                     | 1/4                | 3/8              | 0.3                                 | 7-3/8               | 83               | 2-1/2        |





**JSM AIR SCREWDRIVERS**

- Ball and needle bearing construction for more efficient performance
- Muffled handle exhaust for quiet operation
- All pistol grip models have variable speed triggers for positive control
- All models have quick action reversing valve and quick change chuck to accept standard 1/4" hex bits
- All adjustable clutch models have minimum torque

**SPECIFICATIONS**

| STOCK NUMBER | CHUCK TYPE | CHUCK SIZE (IN) | HORSE POWER (HP) | FREE SPEED (RPM) | TORQUE (FT/LBS) | AIR PRESSURE (PSI) | AIR CONSUMPTION (CFM) | AIR INLET (NPT/IN) | AIR HOSE (ID/IN) | VIBRATION VALUE (M/S <sup>2</sup> ) | OVERALL LENGTH (IN) | NOISE LEVEL (DB) | WEIGHT (LBS) |
|--------------|------------|-----------------|------------------|------------------|-----------------|--------------------|-----------------------|--------------------|------------------|-------------------------------------|---------------------|------------------|--------------|
| JSM-802      | ADJUSTABLE | 1/4             | 1/2              | 1800             | 45/115          | 90                 | 4                     | 1/4                | 3/8              | .6                                  | 7                   | 98               | 2-1/2        |
| JSM-804      | POSITIVE   | 1/4             | 1/2              | 1800             | 115             | 90                 | 4                     | 1/4                | 3/8              | .6                                  | 7                   | 99               | 2-1/3        |

**REPLACEMENT CLUTCH SPRINGS**

| STOCK NUMBER | COLOR  | TORQUE RANGE |
|--------------|--------|--------------|
| J80237G      | GREEN  | 45-90        |
| J80237B      | BLACK  | 45-115       |
| J80237Y      | YELLOW | 45-145       |



J80237G



J80237B



J80237Y



# RATCHETS



ERGO GRIP™



JSM-3330



JSM-3430

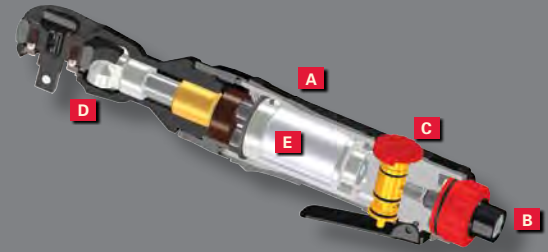

- A | Ergonomic handle design for increased comfort
- B | Built in hose swivel keeps air hose from getting tangled
- C | Built in air regulator for precise speed control
- D | Hardened steel gears for long life
- E | Industrial duty designed air motor for increased power and long tool life

## JSM ERGO GRIP AIR RATCHETS

- Heavy duty ball and needle bearing construction
- Full gear cage
- Ergonomic grip
- Built in air regulator for precise control
- Rear exhaust
- Low operating volume
- Swiveling air inlet keeps air hose tangle free

### SPECIFICATIONS

| STOCK NUMBER | SQUARE DRIVE (IN) | BOLT CAPACITY (IN) | ANVIL RETAINER TYPE | MAXIMUM TORQUE (FT/LBS) | FREE SPEED (RPM) | AIR PRESSURE (PSI) | AIR CONSUMPTION (CFM) | AIR INLET (NPT/IN) | AIR HOSE (ID/IN) | VIBRATION VALUE (M/S <sup>2</sup> ) | NOISE LEVEL (DB) | OVERALL LENGTH (IN) | WEIGHT (LBS) |
|--------------|-------------------|--------------------|---------------------|-------------------------|------------------|--------------------|-----------------------|--------------------|------------------|-------------------------------------|------------------|---------------------|--------------|
| JSM-3330     | 3/8               | 1/2                | BALL                | 50                      | 150              | 90                 | 4                     | 1/4                | 3/8              | 2.6                                 | 79               | 10                  | 2-5/8        |
| JSM-3430     | 1/2               | 1/2                | BALL                | 50                      | 150              | 90                 | 4                     | 1/4                | 3/8              | 2.6                                 | 79               | 10                  | 2-5/8        |



JSG-0719

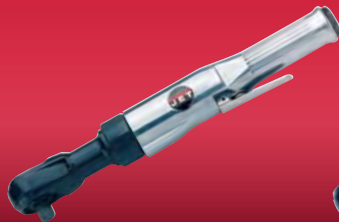

JSG-0735



JSM-30



JSM-31



## JSM AIR RATCHETS

- Steel Ball retainers for rapid socket changing
- Variable speed throttle for better speed control
- Hardened steel gears for long tool life
- Ball bearing construction throughout

### SPECIFICATIONS

| STOCK NUMBER | SQUARE DRIVE (IN) | BOLT CAPACITY (IN) | ANVIL RETAINER TYPE | MAXIMUM TORQUE (FT/LBS) | FREE SPEED (RPM) | AIR PRESSURE (PSI) | AIR CONSUMPTION (CFM) | AIR INLET (NPT/IN) | AIR HOSE (ID/IN) | VIBRATION VALUE (M/S <sup>2</sup> ) | NOISE LEVEL (DB) | OVERALL LENGTH (IN) | WEIGHT (LBS) |
|--------------|-------------------|--------------------|---------------------|-------------------------|------------------|--------------------|-----------------------|--------------------|------------------|-------------------------------------|------------------|---------------------|--------------|
| JSG-0719     | 1/4               | 1/4                | BALL                | 18                      | 240              | 90                 | 3                     | 1/4                | 1/4              | 4.4                                 | 99               | 6-5/16              | 1            |
| JSM-30       | 3/8               | 3/8                | BALL                | 50                      | 150              | 90                 | 4                     | 1/4                | 3/8              | 4.5                                 | 108              | 10                  | 2-1/2        |
| JSM-31       | 1/2               | 3/8                | BALL                | 50                      | 150              | 90                 | 4                     | 1/4                | 3/8              | 4.5                                 | 108              | 10                  | 2-1/2        |
| JSG-0735     | 1/2               | 1/2                | BALL                | 90                      | 150              | 90                 | 5                     | 1/4                | 3/8              | 3.7                                 | 102              | 14-3/8              | 4-1/2        |

## JNS AIR RATCHET

- Light weight aluminum body
- Ball bearing construction
- Comfort grip
- Mid-body exhaust



JNS-5052



### SPECIFICATIONS

| STOCK NUMBER | SQUARE DRIVE (IN) | BOLT CAPACITY (IN) | ANVIL RETAINER TYPE | MAXIMUM TORQUE (FT/LBS) | FREE SPEED (RPM) | AIR PRESSURE (PSI) | AIR CONSUMPTION (CFM) | AIR INLET (NPT/IN) | AIR HOSE (ID/IN) | VIBRATION VALUE (M/S <sup>2</sup> ) | NOISE LEVEL (DB) | OVERALL LENGTH (IN) | WEIGHT (LBS) |
|--------------|-------------------|--------------------|---------------------|-------------------------|------------------|--------------------|-----------------------|--------------------|------------------|-------------------------------------|------------------|---------------------|--------------|
| JNS-5052     | 3/8               | 3/8                | BALL                | 50                      | 160              | 90                 | 4                     | 1/4                | 3/8              | 4.5                                 | 108              | 10                  | 2-1/2        |





**1**  
YEAR  
WARRANTY

**90**  
DAY  
WARRANTY

**JSG RIVETING HAMMERS**

- Special heat treated hardened steel barrel and piston for longer tool life
- Built in tease trigger and air regulator for precise control
- Standard spring retainer for quick tool changes

**SPECIFICATIONS**

| STOCK NUMBER | STROKE LENGTH (IN) | BORE SIZE (IN) | BLOWS PER MINUTE | SHANK SIZE (IN) | AIR PRESSURE (PSI) | AIR CONSUMPTION (CFM) | AIR INLET (NPT/IN) | AIR HOSE (ID/IN) | VIBRATION VALUE (M/S2) | NOISE LEVEL (DB) | OVERALL LENGTH (IN) | WEIGHT (LBS) |
|--------------|--------------------|----------------|------------------|-----------------|--------------------|-----------------------|--------------------|------------------|------------------------|------------------|---------------------|--------------|
| JSG-0101R    | 1-5/8              | 3/4            | 5000             | .401 PARKER     | 90                 | 4                     | 1/4                | 3/8              | 8.4                    | 104              | 5-1/4               | 2-1/4        |
| JSG-0204R    | 2-5/8              | 3/4            | 3200             | .401 PARKER     | 90                 | 4                     | 1/4                | 3/8              | 6.7                    | 111              | 6-3/4               | 3-1/4        |
| JSG-0304R    | 3-1/2              | 3/4            | 2000             | .401 PARKER     | 90                 | 4                     | 1/4                | 3/8              | 5.6                    | 112              | 9                   | 3-1/2        |

**JNS RIVETING HAMMER**

- Hardened Steel barrel and piston for less wear and longer life
- Lightweight aluminum pistol grip housing with comfort grip
- Built in air regulator
- Quick release chisel holder

**SPECIFICATIONS**

| STOCK NUMBER | STROKE LENGTH (IN) | BORE SIZE (IN) | BLOWS PER MINUTE | SHANK SIZE (IN) | AIR PRESSURE (PSI) | AIR CONSUMPTION (CFM) | AIR INLET (NPT/IN) | AIR HOSE (ID/IN) | VIBRATION VALUE (M/S2) | NOISE LEVEL (DB) | OVERALL LENGTH (IN) | WEIGHT (LBS) |
|--------------|--------------------|----------------|------------------|-----------------|--------------------|-----------------------|--------------------|------------------|------------------------|------------------|---------------------|--------------|
| JNS-2060     | 2-5/8              | 3/4            | 5000             | .401 PARKER     | 90                 | 4                     | 1/4                | 3/8              | 8.4                    | 111              | 5-1/4               | 3            |

**REPLACEMENT CHISEL SET FOR JSG AND JNS RIVETING HAMMERS**

**JSG-1304 CONTAINS:**

- JSG-1304 5" Penning Tool
- 5" Nut Splitter, 3mm opening
- 5" Flat Chisel
- 5" Panel Cutter



**REPLACEMENT SPRING RETAINERS FOR JSG RIVETING HAMMERS**

- J0101S** QUICK CHANGE SPRING RETAINER
- J0101B** BEEHIVE SPRING RETAINER



NEEDLE SCALERS / FLUX CHIPPERS



**1**  
YEAR  
WARRANTY

**NEEDLE SCALERS / FLUX CHIPPERS**

- Heat-treated barrels and pistons for extended tool life
- Wide angle chisel standard with F-25 and F-25NS
- Lever lock retainer on Model JSG-9121
- Ball lock retainer on model F-25
- Needle scalers can be used either as a scaler or flux chipper by removing scaler attachment

**SPECIFICATIONS**

| STOCK NUMBER | BLOWS PER MINUTE | STROKE LENGTH (IN) | NUMBER OF NEEDLES | SIZE OF NEEDLES (MM) | AIR PRESS. (PSI) | AIR CONSUMPTION (CFM) | AIR INLET (NPT/IN) | AIR HOSE (ID/IN) | VIBRATION VALUE (M/S2) | OVERALL LENGTH FOLDED (IN) | WEIGHT (LBS) |
|--------------|------------------|--------------------|-------------------|----------------------|------------------|-----------------------|--------------------|------------------|------------------------|----------------------------|--------------|
| JSG-9121     | 4600             | 1-1/8              | -                 | -                    | 90               | 4                     | 1/4                | 3/8              | 2.5                    | 11                         | 4            |
| JSG-9121NS   | 4600             | 1-1/8              | 19                | 3                    | 90               | 4                     | 1/4                | 3/8              | 10.2                   | 15                         | 7            |
| F-25         | 4000             | 7/8                | -                 | -                    | 90               | 4                     | 1/4                | 3/8              | 2.5                    | 8-3/8                      | 5            |
| F-25NS       | 4000             | 7/8                | 19                | 3                    | 90               | 4                     | 1/4                | 3/8              | 14.5                   | 16-3/8                     | 6            |
| JSG-3328NS   | 4500             | 5/8                | 27 or 14          | 3 or 4               | 90               | 8                     | 1/4                | 3/8              | 14.6                   | 14                         | 8            |

**REPLACEMENT NEEDLES**

|              |  |
|--------------|--|
| <b>NS-25</b> | NEEDLE SCALER ATTACHMENT FOR F-25 OR REPLACEMENT SCALER FOR F-25NS |
| <b>N307</b>  | 19-PIECE PACKAGE OF 3MM x 180MM REPLACEMENT NEEDLES                |
| <b>N407</b>  | 14-PIECE PACKAGE OF 4MM x 18MM REPLACEMENT NEEDLES                 |



# MINI BELT SANDERS



ERGO GRIP™



JSM-6100

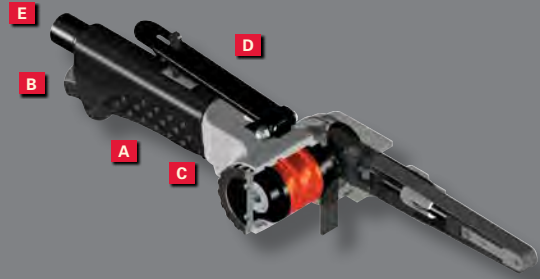

- A | Ergonomic handle design for increased comfort
- B | Built in hose swivel keeps air hose tangle free
- C | Built in air regulator for precise speed control
- D | Safety throttle lock for increased operator safety
- E | Built in exhaust silencer

### JSM ERGO GRIP MINI BELT SANDER

- Ergonomic Handle design
- Throttle features safety lock switch
- Built in air swivel keeps air hose twist free
- Rear exhaust directs air away from work
- Equipped with exhaust silencer for noise reduction
- Built in regulator for positive speed control

- 360 degree head rotation provides versatility for every job
- Belt tracking adjustment is conveniently located
- Comes with 120 grit sanding belt

#### JSM ERGO GRIP MINI BELT SANDERS SPECIFICATIONS

| STOCK NUMBER | BELT SIZE (WXL/IN) | NOISE LEVEL (DB) | HORSE POWER (HP) | FREE SPEED (RPM) | SURFACE FEET PER MINUTE (SPPM) | AIR PRESSURE (PSI) | AIR CONSUMPTION (CFM) | AIR INLET (NPT/IN) | AIR HOSE (ID/IN) | OVERALL LENGTH FOLDED (IN) | OVERALL LENGTH OPEN (IN) | VIBRATION VALUE (M/S2) | WEIGHT (LBS) |
|--------------|--------------------|------------------|------------------|------------------|--------------------------------|--------------------|-----------------------|--------------------|------------------|----------------------------|--------------------------|------------------------|--------------|
| JSM-6100     | 3/8 X 13           | 80               | 1/2              | 18,000           | 3900                           | 90                 | 4                     | 1/4                | 3/8              | 8                          | 12-3/4                   | 1.3                    | 1-7/8        |

### JSM MINI BELT SANDERS

- Rear exhaust directs air away from work
- Equipped with exhaust silencer for noise reduction
- Built in regulator for positive speed control
- 360 degree head rotation provides versatility for every job
- Belt tracking adjustment is conveniently located
- Comes with 120 grit sanding belt



#### JSM MINI BELT SANDERS SPECIFICATIONS

| STOCK NUMBER | BELT SIZE (WXL/IN) | NOISE LEVEL (DB) | HORSE POWER (HP) | FREE SPEED (RPM) | SURFACE FEET PER MINUTE (SPPM) | AIR PRESSURE (PSI) | AIR CONSUMPTION (CFM) | AIR INLET (NPT/IN) | AIR HOSE (ID/IN) | OVERALL LENGTH FOLDED (IN) | OVERALL LENGTH OPEN (IN) | VIBRATION VALUE (M/S2) | WEIGHT (LBS) |
|--------------|--------------------|------------------|------------------|------------------|--------------------------------|--------------------|-----------------------|--------------------|------------------|----------------------------|--------------------------|------------------------|--------------|
| JSM-610      | 3/8 X 13           | 80               | 1/4              | 20,000           | 4325                           | 90                 | 14.2                  | 1/4                | 3/8              | 10-7/16                    | 15-3/4                   | 3.8                    | 2            |
| JSM-612      | 1/2 X 24           | 80               | 1/4              | 20,000           | 4325                           | 90                 | 14.2                  | 1/4                | 3/8              | 12-1/8                     | 21-3/8                   | 3.8                    | 2            |
| JSM-620      | 3/4 X 20-1/2       | 82               | 1/2              | 18,000           | 3900                           | 90                 | 18.4                  | 1/4                | 3/8              | 11-7/8                     | 18-1/2                   | 3.1                    | 3-1/4        |





JSG-0402



JSG-0470



JSG-0420



JSG-0416



JSM-603-5



**SANDERS AND POLISHERS**

- Heavy-duty, balanced, ball bearing construction
- Built-in regulator for positive speed control on models JSG-0402 and JSG-0420
- Dynamic counterweight vibration isolators for low vibration sanding
- Model JSG-0416 feature quick-action paper clamps
- Random orbital dual action models, JSG-0420 and JSM-603-5 provide superior swirl-free finish
- Model JSG-0470 has a dead handle that mounts for left or right hand operation

**SPECIFICATIONS**

| STOCK NUMBER | PAD SIZE (IN)         | SPINDLE THREAD (IN/TPI) | HORSE POWER (HP) | FREE SPEED (RPM) | AIR PRESSURE (PSI) | AIR CONSUMPTION (CFM) | AIR INLET (NPT/IN) | AIR HOSE (ID/IN) | VIBRATION VALUE (M/S <sup>2</sup> ) | OVERALL LENGTH (IN) | NOISE LEVEL (DB) | WEIGHT (LBS) |
|--------------|-----------------------|-------------------------|------------------|------------------|--------------------|-----------------------|--------------------|------------------|-------------------------------------|---------------------|------------------|--------------|
| JSG-0402     | 3, 4-1/2, 5-1/2 ROUND | 7/16 - 20               | 1/2              | 18,000           | 90                 | 4                     | 1/4                | 3/8              | 1.9                                 | 7-1/2               | 106              | 2-1/2        |
| JSG-0416     | 3-2/3X 6-1/2          | -                       | 1/2              | 8000             | 90                 | 4                     | 1/4                | 3/8              | 8                                   | 7-3/8               | 96               | 4-1/2        |
| JSG-0420     | 6 ROUND               | 5/16 - 24               | 1/2              | 10,000           | 90                 | 4                     | 1/4                | 3/8              | 2.6                                 | 8-1/4               | 100              | 4-1/2        |
| JSG-0470     | 7 ROUND               | 5/8 - 11                | 1                | 4500             | 90                 | 12                    | 1/4                | 3/8              | 6.5                                 | 16                  | 103              | 5-1/4        |
| JSM-603-5    | 5 ROUND               | 5/16 - 24               | 1/2              | 10,000           | 90                 | 18                    | 1/4                | 3/8              | 7.3                                 | 6                   | 96               | 2-3/4        |



# MISCELLANEOUS AIR TOOLS



## AIR SHEARS

- Cuts metal up to 18 gauge thick (.048")
- Replaceable heavy-duty cutting jaws and blades
- Heavy-duty, ball bearing design for tough cutting jobs and extended tool life
- Double idler planetary gear system for maximum power

### SPECIFICATIONS

| STOCK NUMBER | METAL CAPACITY (GAUGE) | FREE SPEED (RPM) | AIR PRESS. (PSI) | AIR CONSUMP. (CFM) | AIR INLET (NPT/IN) | AIR HOSE (ID/IN) | VIBRATION VALUE (M/S2) | OVERALL LENGTH (IN) | WEIGHT (LBS) |
|--------------|------------------------|------------------|------------------|--------------------|--------------------|------------------|------------------------|---------------------|--------------|
| JSM-204      | 18                     | 2200             | 90               | 4                  | 1/4                | 3/8              | 4.2                    | 8-1/4               | 6            |



## UTILITY CUT-OFF TOOL

- Able to cut through metal up to 3/4" thick
- Built-in speed regulator matches speed to job
- Spark guard rotates 360 for greater safety
- Model JSG-0516 features a safety lock throttle and rear exhaust
- Model JSG-0510 features a contoured lever throttle and front exhaust
- Ball bearing construction for longer tool life
- 3" x 1/16" x 3/8" cut-off wheel standard

### SPECIFICATIONS

| STOCK NUMBER | WHEEL SIZE (IN) | HORSE POWER (HP) | FREE SPEED (RPM) | AIR PRESS. (PSI) | AIR CONSUMP. (CFM) | AIR INLET (NPT/IN) | AIR HOSE (ID/IN) | VIBRATION VALUE (M/S2) | OVERALL LENGTH (IN) | WEIGHT (LBS) |
|--------------|-----------------|------------------|------------------|------------------|--------------------|--------------------|------------------|------------------------|---------------------|--------------|
| JSG-0516     | 3 X 3/8         | 1/2              | 2000             | 90               | 4                  | 1/4                | 3/8              | 2.2                    | 8                   | 3            |



## AIR RIVETER

- Continuous production capability
- Four nose pieces (3/32", 1/8", 5/32" and 3/16") to set blind rivets
- Quick-release air valve
- Up to 2000 pounds of pull for tough jobs
- 3/16" capacity in mild steel

### SPECIFICATIONS

| STOCK NUMBER | AIR PRESS. (PSI) | AIR CONSUMP. (CFM) | AIR INLET (NPT/IN) | AIR HOSE (ID/IN.) | OVERALL LENGTH (IN) | WEIGHT (LBS) |
|--------------|------------------|--------------------|--------------------|-------------------|---------------------|--------------|
| JSG-0810     | 70 - 100         | 1 - 4              | 1/4                | 3/8               | 6-1/4               | 3-1/2        |





**TOUCH-UP SPRAY GUN**

- Professional quality for touch-up spraying, edging, shading or precision detail painting
- Eight-ounce clamp type paint cup

**SPECIFICATIONS**

| STOCK NUMBER | AIR PRESS. (PSI) | AIR CONSUMP. (CFM) | AIR INLET (NPT/IN) | AIR HOSE (ID/IN.) | WEIGHT (LBS) |
|--------------|------------------|--------------------|--------------------|-------------------|--------------|
| JSG-1052     | 70-100           | 1-4                | 1/4                | 3/8               | 5            |



**SPRAY GUN**

- Industrial quality with dripless cup
- Cup tested to 800 pounds
- Handles all kinds of paint, lacquer, stains, enamel etc.
- May be used with external pressure tank
- One quart cup is Teflon®-coated for easy clean out
- Spray nozzle and head made of brass; will not corrode

**OPTIONAL ACCESSORIES**

- C-802 Teflon®-Coated Replacement Cup

**SPECIFICATIONS**

| STOCK NUMBER | AIR PRESS. (PSI) | AIR CONSUMP. (CFM) | AIR INLET (NPT/IN) | AIR HOSE (ID/IN) | OVERALL LENGTH (IN) | WEIGHT (LBS) |
|--------------|------------------|--------------------|--------------------|------------------|---------------------|--------------|
| JSG-1046     | 50-60            | 4-7                | 1/4                | 3/8              | 7                   | 4            |







# AIR TOOL ACCESSORIES



## AIR HOSE

- High performance, synthetic PVC blend
- 300 PSI working pressure
- Excellent weather and U.V. resistance
- 1/4" NPT threads



JAH-3825



### SPECIFICATIONS

| STOCK NUMBER | DESCRIPTION         |
|--------------|---------------------|
| JAH-3825     | 3/8" X 25' AIR HOSE |
| JAH-3850     | 3/8" X 50' AIR HOSE |

## AIR TOOL ACCESSORIES



AIR BLOW GUN

AIR SWIVEL



5-PIECE QUICK COUPLER SET

### SPECIFICATIONS

| STOCK NUMBER | DESCRIPTION               |
|--------------|---------------------------|
| JSG-2008     | 5-PIECE QUICK COUPLER SET |
| JSG-1063     | AIR BLOW GUN              |
| JAS-12       | AIR SWIVEL                |
| JAS-14       | AIR SWIVEL                |
| JAS-38       | AIR SWIVEL                |



## AIR / WATER HOSE REEL

- All steel construction for industrial application
- Durable powder coat paint finish
- Spring powered auto-rewind with multi-position ratchet
- Reel mounts on wall, floor or ceiling
- Non-snag rollers reduce hose wear
- 3/8" leak proof brass swivel



### SPECIFICATIONS

| STOCK NUMBER | MODEL  | HOSE TYPE | HOSE SIZE (ID/IN) | HOSE LENGTH (FT) | WORKING PRESS. (PSI) | HOSE INLET SIZE (IN) | HOSE OUTLET SIZE (IN) | OVERALL DIMENSION (LXWXH/IN) | WEIGHT (LBS) |
|--------------|--------|-----------|-------------------|------------------|----------------------|----------------------|-----------------------|------------------------------|--------------|
| 426238       | AHR-50 | RUBBER    | 3/8               | 50               | 300                  | 3/8                  | 1/4                   | 20-1/2 X 9 X 22              | 51           |

## POLYPROPYLENE AIR / WATER HOSE REEL

- Lightweight polypropylene construction
- Spring powered auto-rewind with multi-position ratchet
- Reel mounts on wall or ceiling
- Non-snag rollers reduce hose wear
- 3' lead-in hose included



### SPECIFICATIONS

| STOCK NUMBER | MODEL  | HOSE TYPE | HOSE SIZE (ID/IN) | HOSE LENGTH (FT) | WORKING PRESS. (PSI) | HOSE INLET SIZE (IN) | HOSE OUTLET SIZE (IN) | OVERALL DIMENSION (LXWXH/IN) | WEIGHT (LBS) |
|--------------|--------|-----------|-------------------|------------------|----------------------|----------------------|-----------------------|------------------------------|--------------|
| 426237       | PHR-50 | RUBBER    | 3/8               | 50               | 300                  | 3/8                  | 1/4                   | 18 X 9 X 18-1/2              | 26           |



**FILTER / REGULATOR / LUBRICATOR**

- Air filter and oiler feature shatterproof plastic bowls with protective metal cups
- The air filter removes solid particles and condensates moisture accompanying compressed air
- Micro-fog lubricator supplies lubricating oil to the pneumatic tool in proper proportion to the air consumption
- Air pressure can be maintained by the stepless regulator accurately over a wide range of flows as necessary for each application



**SPECIFICATIONS**

| STOCK NUMBER                                | MODEL   | DESCRIPTION                     | CONNECTION PORT (NPT/IN) | MAX. TEMP. (F) | MAX. PRESS. (PSI) |
|---|---------|---------------------------------|--------------------------|----------------|-------------------|
| <b>JAS Air Swivel</b>                       |         |                                 |                          |                |                   |
| JAS-12                                      | JAS-12  | AIR SWIVEL                      | 1/2"                     | -              | -                 |
| JAS-14                                      | JAS-14  | AIR SWIVEL                      | 1/4"                     | -              | -                 |
| JAS-38                                      | JAS-38  | AIR SWIVEL                      | 3/8"                     | -              | -                 |
| <b>JFR Filter/Regulator</b>                 |         |                                 |                          |                |                   |
| JFR-14                                      | JFR-14  | FILTER/REGULATOR                | 1/4"                     | 140            | 150               |
| JFR-38                                      | JFR-38  | FILTER/REGULATOR                | 3/8"                     | 140            | 150               |
| JFR-12                                      | JFR-12  | FILTER/REGULATOR                | 1/2"                     | 140            | 150               |
| <b>JAF Air Filter</b>                       |         |                                 |                          |                |                   |
| JAF-14                                      | JAF-14  | AIR FILTER                      | 1/4"                     | 140            | 150               |
| JAF-38                                      | JAF-38  | AIR FILTER                      | 3/8"                     | 140            | 150               |
| JAF-12                                      | JAF-12  | AIR FILTER                      | 1/2"                     | 140            | 150               |
| <b>JFRL Air Filter/Regulator/Lubricator</b> |         |                                 |                          |                |                   |
| JFRL-14                                     | JFRL-14 | AIR FILTER/REGULATOR/LUBRICATOR | 1/4"                     | 140            | 150               |
| JFRL-38                                     | JFRL-38 | AIR FILTER/REGULATOR/LUBRICATOR | 3/8"                     | 140            | 150               |
| JFRL-12                                     | JFRL-12 | AIR FILTER/REGULATOR/LUBRICATOR | 1/2"                     | 140            | 150               |
| <b>JAR Air Regulator</b>                    |         |                                 |                          |                |                   |
| JAR-14                                      | JAR-14  | AIR REGULATOR                   | 1/4"                     | 140            | 150               |
| JAR-38                                      | JAR-38  | AIR REGULATOR                   | 3/8"                     | 140            | 150               |
| JAR-12                                      | JAR-12  | AIR REGULATOR                   | 1/2"                     | 140            | 150               |



JFRL-12



JAF-12



JFR-12



JAR-12



# IMPACT WRENCHES



INDUSTRIAL



### 1/2" SQUARE DRIVE IMPACT WRENCHES

- Twin hammer clutch provides superior torque
- Variable speed teasing throttle
- Single handed operation for forward and reverse direction changes
- Front exhaust

### 3/4" SQUARE DRIVE IMPACT WRENCHES

- Unique pinless hammer provides for stability
- Distinctive clutch design generates maximum power
- Variable speed teasing throttle
- Built-in regulator
- Pistol grip style body
- Muffled handle exhaust
- Pistol grip design with center balanced hanger ring
- J-2000PL has 5" extended anvil
- J-3800 has cushion grip dead handle

### 1" SQUARE DRIVE IMPACT WRENCHES

- Unique pinless hammer provides for stability
- Distinctive clutch design generates maximum power
- Variable speed teasing throttle
- Built in regulator
- Incredible power-to-weight ratio
- Cushioned grip dead handle
- Side-mounted bumper guards

#### SPECIFICATIONS

| STOCK NUMBER                               | MODEL    | SQUARE DRIVE (IN) | BOLT CAPACITY (IN) | ANVIL RETAINER TYPE | MAX TORQUE (FT/LBS) | FREE SPEED (RPM) | AIR PRESS. (PSI) | AIR CONSUMPTION (CFM) | AIR INLET (NPT/IN) | AIR HOSE (ID/IN.) | VIBRATION VALUE (M/S2) | OVERALL LENGTH (IN) | WEIGHT (LBS) |
|--|----------|-------------------|--------------------|---------------------|---------------------|------------------|------------------|-----------------------|--------------------|-------------------|------------------------|---------------------|--------------|
| <b>1/2" Square Drive Impact Wrenches</b>   |          |                   |                    |                     |                     |                  |                  |                       |                    |                   |                        |                     |              |
| 505983                                     | J-1700P  | 1/2               | 5/8                | RING                | 407                 | 6500             | 90               | 23                    | 1/4                | 3/8               | 3.2                    | 7                   | 7            |
| <b>3/4" Square Drive Impact Wrenches</b>   |          |                   |                    |                     |                     |                  |                  |                       |                    |                   |                        |                     |              |
| 505972                                     | J-2000P  | 3/4               | 13/16              | Ring/Hole           | 550                 | 5500             | 90               | 39                    | 3/8                | 3/8               | 4                      | 8-7/8               | 11           |
| 505974                                     | J-2000D  | 3/4               | 7/8                | Ring/Hole           | 510                 | 5500             | 90               | 39                    | 3/8                | 3/8               | 4                      | 12-3/16             | 13           |
| <b>1" Square Drive Impact Wrenches</b>     |          |                   |                    |                     |                     |                  |                  |                       |                    |                   |                        |                     |              |
| 505941                                     | JET-1010 | 1                 | 1-1/4              | Ring/Hole           | 1250                | 4100             | 90               | 35                    | 1/2                | 1/2               | 8                      | 16-3/16             | 33           |
| 505976                                     | J-3800P  | 1                 | 1-1/2              | Ring                | 1400                | 4700             | 90               | 57                    | 1/2                | 1/2               | 8                      | 11-1/16             | 23           |
| 505977                                     | J-3800D  | 1                 | 1-1/2              | Ring                | 1400                | 4700             | 90               | 57                    | 1/2                | 1/2               | 8                      | 13                  | 23           |
| <b>1-1/2" Square Drive Impact Wrenches</b> |          |                   |                    |                     |                     |                  |                  |                       |                    |                   |                        |                     |              |
| 505955                                     | JET-5000 | 1-1/2             | 2                  | Hole                | 3400                | 3000             | 90               | 44                    | 1/2                | 3/4               | 8.3                    | 16                  | 34           |





**HEAVY-DUTY INDUSTRIAL PNEUMATIC DRILL**

- Heavy-duty industrial quality 1/2" drill
- "Teasing" throttle
- Compact design
- D-type handle with inside trigger
- Zerk fittings for external lubrication
- Dead handle

**SPECIFICATIONS**

| STOCK NUMBER | MODEL  | FREE SPEED (RPM) | AIR PRESSURE (PSI) | AIR CONSUMPTION (CFM) | AIR INLET (NPT/IN) | AIR HOSE (ID/IN) | VIBRATION VALUE (M/S2) | OVERALL LENGTH (IN) | WEIGHT (LBS) |
|--------------|--------|------------------|--------------------|-----------------------|--------------------|------------------|------------------------|---------------------|--------------|
| 556420       | RD-12A | 1200             | 90                 | 30                    | 1/4                | 1/2              | -                      | 12-1/2              | 6-3/4        |



**ROCK DRILLS**

- Latch type tooling retainer
- T-style handle, with rubber grips
- Forged steel parts
- Heavy-duty ratchet and pawl

**SPECIFICATIONS**

| STOCK NUMBER | MODEL   | HEX SHANK SIZE (IN) | PISTON DIAMETER (IN) | PISTON STROKE (IN) | CHUCK ROTATION | FREE SPEED (RPM) | BLOWS PER MINUTE | FT/LBS. PER BLOW @ 90 PSI | AIR PRESSURE (PSI) | AIR CONSUMPTION (CFM) | AIR INLET (NPT/IN) | AIR HOSE (ID/IN) | VIBRATION VALUE (M/S2) | OVERALL LENGTH (IN) | WEIGHT (LBS) |
|--------------|---------|---------------------|----------------------|--------------------|----------------|------------------|------------------|---------------------------|--------------------|-----------------------|--------------------|------------------|------------------------|---------------------|--------------|
| 550022       | RD-60-1 | 1 X 4-1/4           | 2-9/16               | 2-9/16             | LEFT           | 200              | 1800             | 75                        | 90                 | 91                    | 3/4                | 3/4              | 17.5                   | 22-3/8              | 60           |

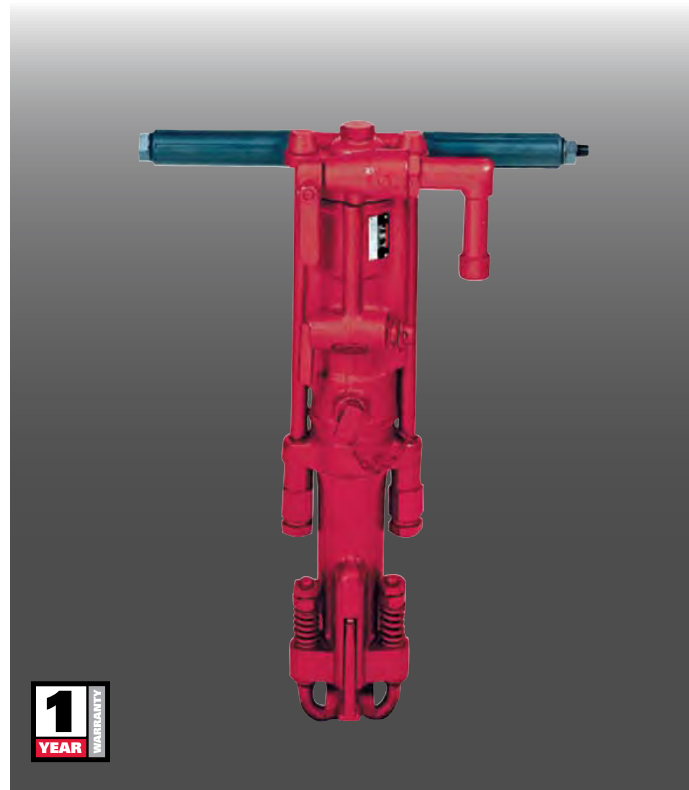

# GRINDERS, SAND RAMMERS, AND RIVET BUSTERS



## HEAVY-DUTY INDUSTRIAL HORIZONTAL GRINDERS

- Powerful motor for superior performance
- Torque drive speed governor
- Speed regulating valve maintains constant speed control when grinding and prevents over-speed when free running
- Ball bearing construction
- Safety self-closing lever throttle



### SPECIFICATIONS

| STOCK NUMBER | MODEL | WHEEL SIZE (IN) | SPINDLE THREAD (TPI/IN.) | HORSE-POWER (HP) | FREE SPEED (RPM) | AIR PRESSURE (PSI) | AIR CONSUMP. (CFM) | AIR INLET (NPT/IN) | AIR HOSE (ID/IN.) | VIBRATION VALUE (M/S2) | OVERALL LENGTH (IN) | WEIGHT (LBS) |
|--------------|-------|-----------------|--------------------------|------------------|------------------|--------------------|--------------------|--------------------|-------------------|------------------------|---------------------|--------------|
| 526205       | HG-2L | 2               | 3/4-24                   | .9               | 11,000           | 90                 | 18                 | 3/8                | 3/8               | 6.4                    | 14-1/4              | 4            |
| 526207       | HG-4L | 4               | 5/8-11                   | 1.3              | 7000             | 90                 | 43                 | 3/8                | 1/2               | 5.7                    | 18-1/2              | 7            |



## BENCH MODEL SAND RAMMERS

- Light- to medium-duty applications
- Equipped with rubber butts

## FLOOR MODEL SAND RAMMERS

- Heavy-duty applications
- JET-2T equipped with rubber butt
- JET-06 equipped with steel butt



### SPECIFICATIONS

| STOCK NUMBER | MODEL   | BUTT DIAMETER (IN) | BORE & STROKE (IN) | OVERALL LENGTH (IN) | SHIP WEIGHT (LBS) | TYPE  |
|--------------|---------|--------------------|--------------------|---------------------|-------------------|-------|
| 556631       | JET-00T | 2                  | 3/4 X 2            | 11                  | 4                 | BENCH |
| 556632       | JET-0T  | 2                  | 7/8 X 2-1/2        | 16                  | 6                 | BENCH |
| 556633       | JET-1T  | 2-5/8              | 1 X 4              | 20                  | 12                | BENCH |
| 556634       | JET-2T  | 3                  | 1-1/4 X 5          | 44                  | 20                | FLOOR |
| 556606       | JET-06  | 5-3/4              | 1-1/2 X 5-1/2      | 49                  | 37                | FLOOR |

### REPLACEMENT PARTS

| STOCK NUMBER | MODEL   | BUTT TYPE |
|--------------|---------|-----------|
| 556632       | JET-0T  | RUBBER    |
| 556631       | JET-00T | RUBBER    |
| 556633       | JET-1T  | RUBBER    |
| 556634       | JET-2T  | RUBBER    |
| 556606       | JET-06  | STEEL     |



## RIVET BUSTERS

- Hard hitting, powerful hammers for cutting off bolt and rivet heads
- May be used for heavy-duty chipping and nail driving applications
- Comes equipped with Arrow™ retainer, bushings and retainer springs



### SPECIFICATIONS

| STOCK NUMBER | MODEL   | TOOLING SIZE (IN) | RIVET CAPACITY (IN) | STROKE LENGTH (IN) | BORE SIZE (IN) | BLOWS PER MINUTE | FT/LBS PER BLOW @90 PSI | AIR PRESSURE (PSI) | AIR CONSUMPTION (CFM) | AIR INLET (NPT/IN) | AIR HOSE (ID/IN.) | VIBRATION VALUE (M/S2) | OVERALL LENGTH (IN) | WEIGHT (LBS) |
|--------------|---------|-------------------|---------------------|--------------------|----------------|------------------|-------------------------|--------------------|-----------------------|--------------------|-------------------|------------------------|---------------------|--------------|
| 550095K      | RB-90   | 1                 | 1-1/4               | 9                  | 1-1/16         | 900              | 43                      | 90                 | 28                    | 3/8                | 1/2               | 16.9                   | 20-1/4              | 23           |
| 550094K      | RB-91   | 1-1/8             | 1-1/4               | 9                  | 1-1/16         | 900              | 43                      | 90                 | 28                    | 3/8                | 1/2               | 16.9                   | 20-1/4              | 23           |
| 560090       | JRB-133 | 1-1/8             | 7/8                 | 8                  | 1-3/16         | 960              | -                       | 90                 | -                     | -                  | -                 | -                      | -                   | -            |



**FOUR BOLT CHIPPING HAMMERS**

- Available with four different stroke lengths, 2" – 4"
- D-handle for extra strength and better grip
- Four-bolt handle design reduces handle breakage
- Exhaust deflector diverts exhaust while providing a comfortable grip
- Will accommodate standard oval collar chisel and retainers
- Comes with standard type retainer

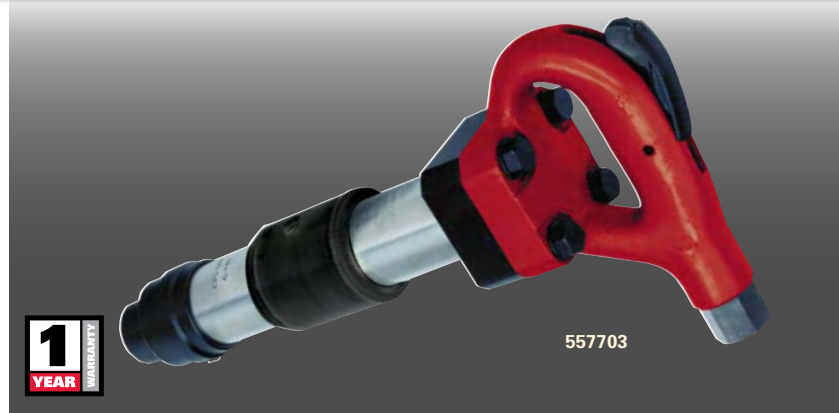

**FOUR BOLT CHIPPING HAMMERS**

| STOCK NUMBER | MODEL   | SHANK BUSHING STYLE | SHANK BUSHING SIZE (IN) | STROKE LENGTH (IN) | BORE SIZE (IN) | BLOWS PER MIN | FT/LBS PER BLOW @ 90 PSI | AIR PRESSURE (PSI) | AIR CONSUMPTION (CFM) | AIR INLET (NPT/IN) | AIR HOSE (ID/IN) | VIBRATION VALUE (M/S <sup>2</sup> ) | OVERALL LENGTH (IN) | WEIGHT (LBS) |
|--------------|---------|---------------------|-------------------------|--------------------|----------------|---------------|--------------------------|--------------------|-----------------------|--------------------|------------------|-------------------------------------|---------------------|--------------|
| 557702       | FBCH-2R | ROUND               | .680                    | 2-1/2              | 1-1/8          | 2000          | 24                       | 90                 | 28                    | 7/8-24             | 1/2              | 8.1                                 | 15-5/8              | 19           |
| 557703       | FBCH-3R | ROUND               | .680                    | 3                  | 1-1/8          | 1900          | 31                       | 90                 | 28                    | 7/8-24             | 1/2              | 14.4                                | 16-5/8              | 20           |

**SAW TOOTH HANDLE CHIPPING HAMMERS**

- New Saw Tooth style handle dissipates impact energy more efficiently than other designs
- Available in 2"-4" stroke lengths
- Drop-forged saw tooth style handle
- Outside trigger and open handle design
- Will accommodate standard oval collar chisel and retainers
- Comes with standard type retainer
- New urethane Damper Seat works like a shock absorber against vibration and dry fires

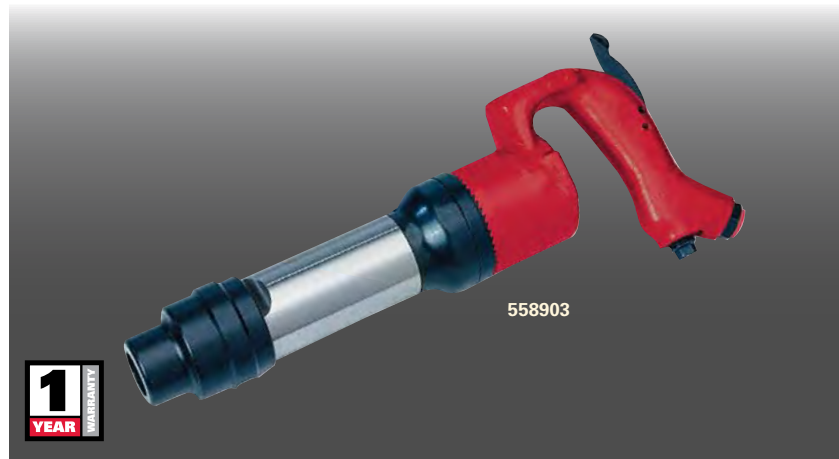

**CASTLE TOOTH HANDLE CHIPPING HAMMERS**

| STOCK NUMBER | MODEL NUMBER | SHANK BUSHING STYLE | SHANK BUSHING SIZE (IN) | STROKE LENGTH (IN) | BORE SIZE (IN) | BLOWS PER MIN | FT/LBS PER BLOW @ 90 PSI | AIR PRESSURE (PSI) | AIR CONSUMPTION (CFM) | AIR INLET (NPT/IN) | AIR HOSE (ID/IN) | VIBRATION VALUE (M/S <sup>2</sup> ) | OVERALL LENGTH (IN) | WEIGHT (LBS) |
|--------------|--------------|---------------------|-------------------------|--------------------|----------------|---------------|--------------------------|--------------------|-----------------------|--------------------|------------------|-------------------------------------|---------------------|--------------|
| 558902       | JCO-2R-ST    | ROUND               | .680                    | 2                  | 1-1/8          | 2300          | 18                       | 90                 | 29                    | 3/8                | 1/2              | 14.4                                | 16-1/4              | 13-1/2       |
| 558906       | JCO-2H-ST    | HEX                 | .580                    | 2                  | 1-1/8          | 2300          | 18                       | 90                 | 29                    | 3/8                | 1/2              | 14.4                                | 16-1/4              | 13-1/2       |
| 558903       | JCO-3R-ST    | ROUND               | .680                    | 3                  | 1-1/8          | 2200          | 25                       | 90                 | 31                    | 3/8                | 1/2              | 14.4                                | 18                  | 15           |
| 558907       | JCO-3H-ST    | HEX                 | .580                    | 3                  | 1-1/8          | 2200          | 25                       | 90                 | 31                    | 3/8                | 1/2              | 14.4                                | 18                  | 15           |
| 558904       | JCO-4R-ST    | ROUND               | .680                    | 4                  | 1-1/8          | 1800          | 42                       | 90                 | 33                    | 3/8                | 1/2              | 9.1                                 | 19                  | 16           |
| 558908       | JCO-4H-ST    | HEX                 | .580                    | 4                  | 1-1/8          | 1800          | 42                       | 90                 | 33                    | 3/8                | 1/2              | 9.1                                 | 19                  | 16           |

**OPTIONAL ACCESSORIES FOR JET JCO & FBCH CHIPPING HAMMERS**

|                             |        |
|-----------------------------|--------|
| Quick change retainer       | 557909 |
| Ball type retainer          | 557910 |
| Standard retainer           | 557911 |
| 7/8" – 24 hose swivel       | 557913 |
| Retainer strings, 25 pieces | 557912 |







# PAVING BREAKERS



JPB-60



JPB-90



## PAVING BREAKERS

- Large diameter, smooth stroke piston
- Full control throttle
- Replaceable front head bushing
- Four-bolt head-to-cylinder construction
- Efficient valve chest for low-maintenance
- Drop-forged cylinder
- Chisel retainer latch
- Rubber handle grips
- All shank sizes accommodate standard steel

### SPECIFICATIONS

| STOCK NUMBER | MODEL        | HEX SHANK SIZE (IN) | PISTON DIAMETER (IN) | PISTON STROKE (IN) | BLOWS PER MINUTE | FT / LBS PER BLOW@90 PSI | AIR PRESSURE (PSI) | AIR CONSUMPTION (CFM) | AIR INLET (NPT/IN) | AIR HOSE (ID/IN) | VIBRATION VALUE (M/S2) | OVERALL LENGTH (IN) | WEIGHT (LBS) |
|--------------|--------------|---------------------|----------------------|--------------------|------------------|--------------------------|--------------------|-----------------------|--------------------|------------------|------------------------|---------------------|--------------|
| 550076       | JPB-60-1-1/4 | 1-1/4 X 6           | 2-1/4                | 5                  | 1400             | 89                       | 90                 | 58                    | 3/4                | 3/4              | 15.6                   | 25-3/8              | 66           |
| 550077       | JPB-90-1-1/8 | 1-1/8 X 6           | 2-5/8                | 6-1/2              | 1250             | 181                      | 90                 | 77                    | 3/4                | 3/4              | 17.3                   | 28-1/2              | 93           |
| 550078       | JPB-90-1-1/4 | 1-1/4 X 6           | 2-5/8                | 6-1/2              | 1250             | 181                      | 90                 | 77                    | 3/4                | 3/4              | 17.3                   | 28-1/2              | 93           |

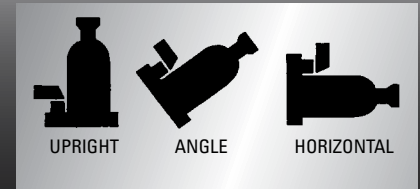

**NOTE**  
When used at an angle or in the horizontal position, the pump must be in upright position and piston movement is reduced.



**JHJ SERIES HEAVY-DUTY INDUSTRIAL BOTTLE JACKS**

- For lifting, pushing, spreading, bending, pressing or straightening requirements
- Not affected by temperature extremes
- Low profile truck models or standard models
- Electrically welded base and cylinders to assure strength and eliminate leaks
- All models work in upright, angle or horizontal position
- Pump handle included
- Carrying handles on 12-1/2- to 100-ton models
- Complies with ANSI/ASME B30.1 and PALD-1 standards

**SPECIFICATIONS**

| STOCK NO. | MODEL       | RATED CAP'Y (TON) | MINIMUM HEIGHT (IN) | PISTON HEIGHT (IN) | HEAD SCREW (H/IN) | MAX. HEIGHT (IN) | BASE SIZE (LXW/IN) | WEIGHT (LBS) |
|-----------|-------------|-------------------|---------------------|--------------------|-------------------|------------------|--------------------|--------------|
| 453301    | JHJ-2       | 2                 | 7-1/8               | 4-1/2              | 2                 | 13-5/8           | 4-1/2 X 2-1/2      | 5            |
| 453303    | JHJ-3       | 3                 | 7-1/2               | 4-1/2              | 2-3/8             | 14-3/8           | 4-9/16 X 2-13/16   | 6            |
| 453305    | JHJ-5       | 5                 | 7-7/8               | 4-5/8              | 2-3/4             | 15-1/2           | 5-5/8 X 3-1/4      | 9            |
| 453308    | JHJ-8       | 8                 | 7-7/8               | 4-5/8              | 2-3/4             | 15-1/2           | 6 X 3-1/2          | 13           |
| 453312    | JHJ-12 1/2  | 12-1/2            | 9-1/2               | 5-7/8              | 3-1/8             | 18-1/2           | 6-1/2 X 4-1/8      | 18           |
| 453313K   | JHJ-12 1/2L | 12-1/2            | 6-3/4               | 3-3/4              | 3                 | 13-3/8           | 6-1/2 X 4-1/8      | 15           |
| 453317    | JHJ-17 1/2  | 17-1/2            | 10-3/8              | 6-1/2              | 3-1/8             | 20               | 7-1/8 X 4-5/8      | 24           |
| 453318K   | JHJ-17 1/2L | 17-1/2            | 6-3/4               | 3-1/2              | 2-3/4             | 13               | 7-1/8 X 4-5/8      | 19           |
| 453322    | JHJ-22 1/2  | 22-1/2            | 10-5/8              | 6-1/4              | -                 | 16-7/8           | 7-1/8 X 5-1/2      | 28           |
| 453323K   | JHJ-22 1/2L | 22-1/2            | 7-1/8               | 3-3/8              | 1-1/2             | 12               | 7-1/4 X 5-1/16     | 23           |
| 453325K   | JHJ-35      | 35                | 11                  | 6-1/4              | -                 | 17-1/4           | 8-3/8 X 5-1/2      | 48           |
| 453360K   | JHJ-60      | 60                | 12                  | 6-3/4              | -                 | 8-5/8            | 9-1/4 X 7-3/8      | 82           |
| 453399K   | JHJ-100     | 100               | 12                  | 5-23/32            | -                 | 17-11/16         | 14-31/32 X 10-7/16 | 225          |

# JBJ & AHJ SERIES HYDRAULIC BOTTLE JACKS



## JBJ SERIES HYDRAULIC BOTTLE JACKS

- For lifting, pushing, spreading, bending, pressing or straightening requirements
- Not affected by temperature extremes
- Low profile truck models or standard models
- Electrically welded base and cylinders to assure strength and eliminate leaks
- All models work in upright, angle or horizontal position
- Pump handle included
- Carrying handles on 12-1/2- to 100-ton models
- Complies with ANSI/ASME B30.1 and PALD-1 standards

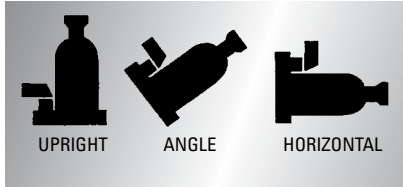

### NOTE

When used at an angle or in the horizontal position, the pump must be in upright position and piston movement is reduced.



**2**  
YEAR  
WARRANTY

### SPECIFICATIONS

| STOCK NUMBER | MODEL   | RATED CAPACITY (TON) | MINIMUM HEIGHT (IN) | PISTON LIFT (IN) | HEAD SCREW LIFT (IN) | MAXIMUM HEIGHT (IN) | BASE SIZE (LXW/IN) | WEIGHT (LBS) |
|--------------|---------|----------------------|---------------------|------------------|----------------------|---------------------|--------------------|--------------|
| 655550       | JBJ-2   | 2                    | 7                   | 4-5/8            | 2-1/8                | 13-11/16            | 4-1/3 X 2-9/16     | 6-1/2        |
| 655551       | JBJ-3   | 3                    | 7-1/2               | 4-1/2            | 2-7/16               | 14-3/8              | 4-1/2 X 2-7/8      | 7-3/4        |
| 655552       | JBJ-5   | 5                    | 7-3/4               | 4-3/4            | 2-3/4                | 15-3/8              | 5-1/8 X 3          | 10           |
| 655558       | JBJ-8   | 8                    | 7-7/8               | 4-7/8            | 2-7/8                | 15-5/8              | 5-7/8 X 3-1/2      | 14-1/4       |
| 655554       | JBJ-12  | 12                   | 9-1/2               | 5-7/8            | 3-1/8                | 18-1/2              | 6-1/2 X 4-1/8      | 21           |
| 655555       | JBJ-12L | 12                   | 6-3/4               | 3-3/4            | 3                    | 13-3/8              | 6-1/2 X 4-1/8      | 15           |
| 655556       | JBJ-22  | 22                   | 10-5/8              | 6-1/4            | -                    | 16-7/8              | 7-1/8 X 5-1/2      | 24           |
| 655557       | JBJ-22L | 22                   | 7-1/8               | 3-3/8            | 1-1/2                | 12                  | 7-1/8 X 5-1/2      | 19           |

## AHJ SERIES AIR/HYDRAULIC BOTTLE JACKS

- For lifting, pushing, spreading, bending, pressing or straightening requirements
- Not affected by temperature extremes
- All models work in upright, angle, or horizontal position
- Electrically welded base and cylinders to assure strength and eliminate leaks
- Equipped with labor saving air pump
- Carrying handle included
- Pump handle included
- Comes packaged in heavy duty blow molded case
- Available in 12- or 20-ton capacities
- Complies with ANSI/ASME B30.1 and PALD-1 standards



**2**  
YEAR  
WARRANTY

### SPECIFICATIONS

| STOCK NO. | MODEL    | RATED CAPACITY TOE (TON) | RATED CAPACITY HEAD (TON) | TOE HT MIN (IN) | TOE LIFT (IN) | TOE HT MAX (IN) | HEAD HT MIN (IN) | HEAD HT MAX (IN) | TOE SIZE (LXW/IN) | BASE (LXW/IN)  | WEIGHT (LBS) |
|-----------|----------|--------------------------|---------------------------|-----------------|---------------|-----------------|------------------|------------------|-------------------|----------------|--------------|
| 453502    | JTJ-2SV  | 2                        | 3                         | 5/8             | 4-7/16        | 5-1/16          | 9-3/8            | 13-3/4           | 2 X 2             | 5 X 7          | 18           |
| 453505    | JTJ-5SV  | 5                        | 6                         | 7/8             | 4-3/4         | 5-9/16          | 11-3/4           | 16-1/8           | 2-1/4 X 3         | 10-5/8 X 7-1/4 | 53           |
| 453510    | JTJ-10SV | 10                       | 14                        | 1-1/8           | 5-3/4         | 6-13/16         | 13-1/8           | 18-1/2           | 2-3/8 X 4         | 11-1/4 X 9-1/2 | 84           |





**HEAVY-DUTY INDUSTRIAL TOE JACKS**

- Heavy-duty, industrial quality, dual purpose jack
- Designed for lifting loads with very low minimum clearances (toe) or high clearances (head)
- Ideal for house moving, machinery installation and application at shipyard, bridge, building, or plant construction sites
- Great companion tool for machinery type rollers
- Convenient swivel socket for easy operation in any direction on 5-ton and 10-ton models
- Safety valve for overload protection
- Features spring assisted return and overtravel protection on 5- or 10-ton models
- Ram is made of heat treated special steel to resist rust and assure strength
- Electrically welded base and cylinders to assure strength
- Not affected by temperature extremes
- Pump handle included
- Complies with ANSI/ASME B30.1 standards



**SPECIFICATIONS**

| STOCK NO. | MODEL    | RATED CAPACITY TOE (TON) | RATED CAPACITY HEAD (TON) | TOE HT MIN (IN) | TOE LIFT (IN) | TOE HT MAX (IN) | HEAD HT MIN (IN) | HEAD HT MAX (IN) | TOE SIZE (LXW/IN) | BASE (LXW/IN)  | WEIGHT (LBS) |
|-----------|----------|--------------------------|---------------------------|-----------------|---------------|-----------------|------------------|------------------|-------------------|----------------|--------------|
| 453502    | JTJ-2SV  | 2                        | 3                         | 5/8             | 4-7/16        | 5-1/16          | 9-3/8            | 13-3/4           | 2 X 2             | 5 X 7          | 18           |
| 453505    | JTJ-5SV  | 5                        | 6                         | 7/8             | 4-3/4         | 5-9/16          | 11-3/4           | 16-1/8           | 2-1/4 X 3         | 10-5/8 X 7-1/4 | 53           |
| 453510    | JTJ-10SV | 10                       | 14                        | 1-1/8           | 5-3/4         | 6-13/16         | 13-1/8           | 18-1/2           | 2-3/8 X 4         | 11-1/4 X 9-1/2 | 84           |

**SJ SERIES SCREW JACKS**

- Contractor quality mechanical jack for all-purpose lifts and supports
- Holds heavy loads indefinitely - will not creep
- Heavy-duty bell shaped cast base
- Less effort required to lift capacity load with new design
- Corrugated steel swivel head turns easily under load
- Easy to carry and position with built-in handle
- Compliance: ANSI/AMSE B30.1 standards
- Head pivots to provide maximum contact
- Turning bar not included



**SPECIFICATIONS**

| STOCK NO. | MODEL | CAPACITY (TON) | SCREW SIZE (ODXL) | BAR HOLE SIZE (IN) | HEAD DIA. (IN) | BASE SIZE (IN) | HEIGHT CLOSED (IN) | HEIGHT EXTND (IN) | WEIGHT (LBS) |
|-----------|-------|----------------|-------------------|--------------------|----------------|----------------|--------------------|-------------------|--------------|
| 441305    | SJ-5  | 5              | 1 X 6             | 9/16               | 2-3/8          | 4-1/2          | 9                  | 13                | 7            |
| 441310    | SJ-10 | 10             | 1-1/2 X 8-3/8     | 11/16              | 3-1/16         | 5-1/4          | 11                 | 17-1/2            | 19           |
| 441315    | SJ-15 | 15             | 1-5/8 X 10-1/2    | 13/16              | 3-1/2          | 6              | 13-3/4             | 21                | 28           |
| 441320    | SJ-20 | 20             | 2 X 12            | 13/16              | 4-1/8          | 6-7/8          | 16                 | 25                | 36           |
| 441325    | SJ-25 | 25             | 2-1/2 X 12        | 13/16              | 4-3/8          | 8              | 16-1/2             | 25-1/4            | 44           |

**SCREW JACK TURNING BARS**

| STOCK NO. | MODEL    | SIZE (IN) | FITS JACK | WEIGHT (LBS) |
|-----------|----------|-----------|-----------|--------------|
| 440301    | SJTB-1/2 | 1/2 X 18  | SJ-5      | 3            |
| 440302    | SJTB-5/8 | 5/8 X 24  | SJ-10     | 4            |
| 440303    | SJTB-3/4 | 3/4 X 36  | SJ-15-25  | 5            |
| 440304    | SJTB-1   | 3/4 X 42  | SJ-15-25  | 8            |



# HYDRAULIC BODY REPAIR KITS & SERVICE JACKS



**2**  
YEAR  
WARRANTY

## BRK SERIES HYDRAULIC BODY REPAIR KITS

- Let hydraulic power make light work of body or collision repairs
- Straighten, bend, press or spread steel with 4-ton or 10-ton capacity models
- Quick-connect design allows assembly in seconds
- Automatic safety overload system protects equipment
- Heavy wall extension tubes for tough jobs
- Rugged blow molded case keeps tools organized
- Proof tested and certified to meet ANSI/ASME B30.1 standards
- Two-stage piston for quick-action pump with BRK10A
- BRK-10A features wheels for transportation ease

### SPECIFICATIONS

| STOCK NO. | MODEL   | PUMP CAP'Y (TON) | MAX. HANDLE EFFORT (LBS) | OIL CAPACITY (CU/IN) | PUMP PISTON DIA. (IN) | PISTON STROKE (IN) | OVERALL STROKE (IN) | MIN./MAX. HEIGHT (IN) | MAX. CYLINDER PRESS. (PSI) | SERRATED SADDLE (CU/IN) | WEIGHT (LBS) |
|-----------|---------|------------------|--------------------------|----------------------|-----------------------|--------------------|---------------------|-----------------------|----------------------------|-------------------------|--------------|
| 680004    | BRK-4A  | 4                | 132                      | 20                   | 1/2                   | 3/4                | 5                   | 11 / 16               | 9000                       | 1-3/8                   | 44           |
| 680010    | BRK-10A | 10               | 132                      | 35                   | 1/2 AND 1             | 3/4                | 6                   | 15 / 21               | 9000                       | 2                       | 85           |



**5**  
YEAR  
WARRANTY

## JSJ SERIES SHORT CHASSIS SERVICE JACKS

- Features automatic safety overload bypass system
- Full swivel, ball bearing rear casters are positioned for best load distribution and optimal maneuvering
- "Quick Lift" pump feature with no load
- Complies with ANSI/ASME PALD-10 standards

### SPECIFICATIONS

| STOCK NO. | MODEL      | CAPACITY (TON) | MIN. HEIGHT (IN) | MAX. HEIGHT (IN) | SADDLE (DIA/IN) | OVERALL LENGTH (IN) | OVERALL WIDTH (IN) | HANDLE LENGTH (IN) | WEIGHT (LBS) |
|-----------|------------|----------------|------------------|------------------|-----------------|---------------------|--------------------|--------------------|--------------|
| 454227    | JSJ-2-1/4X | 2-1/4          | 4-1/2            | 19-1/4           | 4-3/4           | 26-1/2              | 13-7/8             | 39-7/8 (2PC.)      | 44           |
| 454223    | JSJ-3X     | 3              | 4-1/2            | 21               | 5-1/8           | 26                  | 13                 | 37-3/4 (2PC.)      | 85           |



### JASJ SERIES AIR/HYDRUALIC SERVICE JACK

- Equipped with a labor-saving air pump and a high-speed cylinder piston that increases lifting speeds and efficiency
- Suitable for use on large trucks
- 3-1/8" extension screw height
- Lifting time with rated load 120 seconds; 35 seconds with no load
- 90 to 150PSI, 3HP compressor required



#### SPECIFICATIONS

| STOCK NO. | MODEL    | CAPACITY (TON) | MINIMUM HEIGHT (IN) | MAXIMUM HEIGHT (IN) | SADDLE (DIA/IN) | OVERALL LENGTH (IN) | OVERALL WIDTH (IN) | HANDLE LENGTH (IN) | WEIGHT (LBS) |
|-----------|----------|----------------|---------------------|---------------------|-----------------|---------------------|--------------------|--------------------|--------------|
| 454200C   | JASJ-22C | 22             | 8-1/4               | 20-5/8              | 2-5/8           | 41-3/8              | 12-1/4             | 41-3/8             | 44           |

### HEAVY-DUTY JACK STANDS

- Heavy-duty, welded steel construction
- The weight of the load prevents the ratchet pawl from disengaging while under load
- Reinforced legs for use on asphalt
- Rated capacities of 3, 6 and 12 tons
- Sold and for use in pairs only
- Complies with ANSI/ASME PALD-4 standards

#### SPECIFICATIONS

| STOCK NO. | MODEL  | MIN. HEIGHT (IN) | MAX. HEIGHT (IN) | BASE SIZE (IN)  | WEIGHT (LBS) |
|-----------|--------|------------------|------------------|-----------------|--------------|
| 441003    | JSS-3  | 11-3/4           | 17-1/4           | 7-5/8 X 8-5/8   | 19           |
| 441006    | JSS-6  | 15               | 24-1/4           | 10 X 11-1/4     | 34           |
| 441012    | JSS-12 | 19               | 30-3/8           | 12-3/8 X 14-1/4 | 78           |







# FARM JACK



**2**  
YEAR  
WARRANTY

## FARM JACK

- Multi-purpose jack to lift, push, pull, or clamp
- Rugged steel construction throughout
- Automatic step-by-step operation for raising and lowering load
- Large cast iron base for stability
- Adjustable cast steel top clamp clevis for clamping operations
- Safety shear pin protects lifting saddle and dropping of load if jack is overloaded
- Cast steel large and small runners
- Reversible upright steel bar for long life
- Bar holes will accommodate chains, cables, etc.
- Quick disengage with no load
- Working parts exposed for easy cleaning and lubrication
- Rust resistant powder coat finish on handle

## SPECIFICATIONS

| STOCK NO. | MODEL    | LIFTING CAPACITY AT 1' (LBS) | WINCHING/PULLING CAPACITY (LBS) | CLAMPING CAPACITY (LBS) | MIN. HEIGHT (IN) | MAX. HEIGHT (IN) | LIFT PER HANDLE STROKE (IN) | BASE DIM. (LXW/IN) | HANDLE LENGTH (IN) | WEIGHT (LBS) |
|-----------|----------|------------------------------|---------------------------------|-------------------------|------------------|------------------|-----------------------------|--------------------|--------------------|--------------|
| 440435    | FJ-3-1/2 | 7000                         | 5000                            | 750                     | 4-1/2            | 43-3/8           | 3/4                         | 7 X 4              | 30                 | 35           |

### WARRANTY AND SERVICE



Walter Meier (Manufacturing) Inc., warrants every product it sells. If one of our tools needs service or repair, one of our Authorized Service Centers located throughout the United States can give you quick service. In most cases, any of these Walter Meier Authorized Service Centers can authorize warranty repair, assist you in obtaining parts, or perform routine maintenance and major repair on your JET® tools. For the name of an Authorized Service Center in your area call 1-800-274-6848.

#### MORE INFORMATION

Walter Meier is consistently adding new products to the line. For complete, up-to-date product information, check with your local Walter Meier distributor, or visit [jettools.com](http://jettools.com).

### WARRANTY

JET products carry a limited warranty which varies in duration based upon the product. (MW = Metalworking, WW = Woodworking)

|  |   |
|--|---|
|   |    |
| <ul style="list-style-type: none"> <li>Lathe Accessories</li> <li>Machine Accessories</li> <li>Mobile Bases</li> <li>Safety Equipment</li> <li>Specialty Items</li> <li>Vise Accessories</li> <li>Air Tools</li> </ul> | <ul style="list-style-type: none"> <li>Air Tools-Contractor</li> <li>Air Tools-Industrial</li> <li>Air Tools-Light Industrial</li> <li>Lubrication</li> </ul> |

#### WHAT IS COVERED?

This warranty covers any defects in workmanship or materials subject to the exceptions stated below. Cutting tools, abrasives and other consumables are excluded from warranty coverage.

#### WHO IS COVERED?

This warranty covers only the initial purchaser of the product.

#### WHAT IS THE PERIOD OF COVERAGE?

The general JET warranty lasts for the time period specified in the product literature of each product.

#### WHAT IS NOT COVERED?

This warranty does not cover defects due directly or indirectly to misuse, abuse, negligence or accidents, normal wear-and-tear, improper repair or alterations, or lack of maintenance.

#### HOW TO GET SERVICE

The product or part must be returned for examination, postage prepaid, to a location designated by us. For the name of the location nearest you, please call 1-800-274-6848.

You must provide proof of initial purchase date and an explanation of the complaint must accompany the merchandise. If our inspection discloses a defect, we will repair or replace the product, or refund the purchase price, at our option.

We will return the repaired product or replacement at our expense unless it is determined by us that there is no defect, or that the defect resulted from causes not within the scope of our warranty in which case we will, at your direction, dispose of or return the product. In the event you choose to have the product returned, you will be responsible for the shipping and handling costs of the return.

#### HOW STATE LAW APPLIES

This warranty gives you specific legal rights; you may also have other rights which vary from state to state.

#### LIMITATIONS ON THIS WARRANTY

WALTER MEIER LIMITS ALL IMPLIED WARRANTIES TO THE PERIOD OF THE LIMITED WARRANTY FOR EACH PRODUCT. EXCEPT AS STATED HEREIN, ANY IMPLIED WARRANTIES OR MERCHANTABILITY AND FITNESS ARE EXCLUDED. SOME STATES DO NOT ALLOW LIMITATIONS ON HOW LONG THE IMPLIED WARRANTY LASTS, SO THE ABOVE LIMITATION MAY NOT APPLY TO YOU.

WALTER MEIER SHALL IN NO EVENT BE LIABLE FOR DEATH, INJURIES TO PERSONS OR PROPERTY, OR FOR INCIDENTAL, CONTINGENT, SPECIAL, OR CONSEQUENTIAL DAMAGES ARISING FROM THE USE OF OUR PRODUCTS. SOME STATES DO NOT ALLOW THE EXCLUSION OR LIMITATION OF INCIDENTAL OR CONSEQUENTIAL DAMAGES, SO THE ABOVE LIMITATION OR EXCLUSION MAY NOT APPLY TO YOU.

Walter Meier sells through distributors only. The specifications in WMH catalogs are given as general information and are not binding. Members of Walter Meier reserve the right to effect at any time, without prior notice, those alterations to parts, fittings, and accessory equipment which they may deem necessary for any reason whatsoever. JET® branded products are not sold in Canada by Walter Meier.

