

NOTES:

101. FINISH: PAINT FLOW LIGHT GRAY (WMC) PER FLOW SPECIFICATION ES-1073. LIQUID PAINT ONLY.

102 APPLY ANTISEIZE TO MALE THREADS AND TORQUE TO 16 FT-LB.

103 CENTER NUTS ON OUTER HOLES IN THE FLANGES OF ITEM 1 AND WELD ON ANY TWO OPPOSITE FLATS.

104. ESTIMATED WEIGHT = 37.6 KG. (83 LBS).

105 ITEMS NOT SHOWN. BAG FASTENERS SEPARATELY AND ZIP TIE PACKAGE TO THE PLATFORM ASSEMBLY FOR SHIPMENT. SEE USER MANUAL FOR PROPER USAGE OF THESE FASTENERS DURING INSTALLATION OF THE PLATFORM IN THE CATCHER TANK.

- 11 -22 ONLY 4X
- 10 -22 ONLY 8X
- 9 -22 ONLY 4X
- 5 -2 ONLY 4X
- 4 -2 ONLY 8X
- 3 -2 ONLY 4X

102

- 7 2X -22 ONLY
- 1 2X -2 ONLY

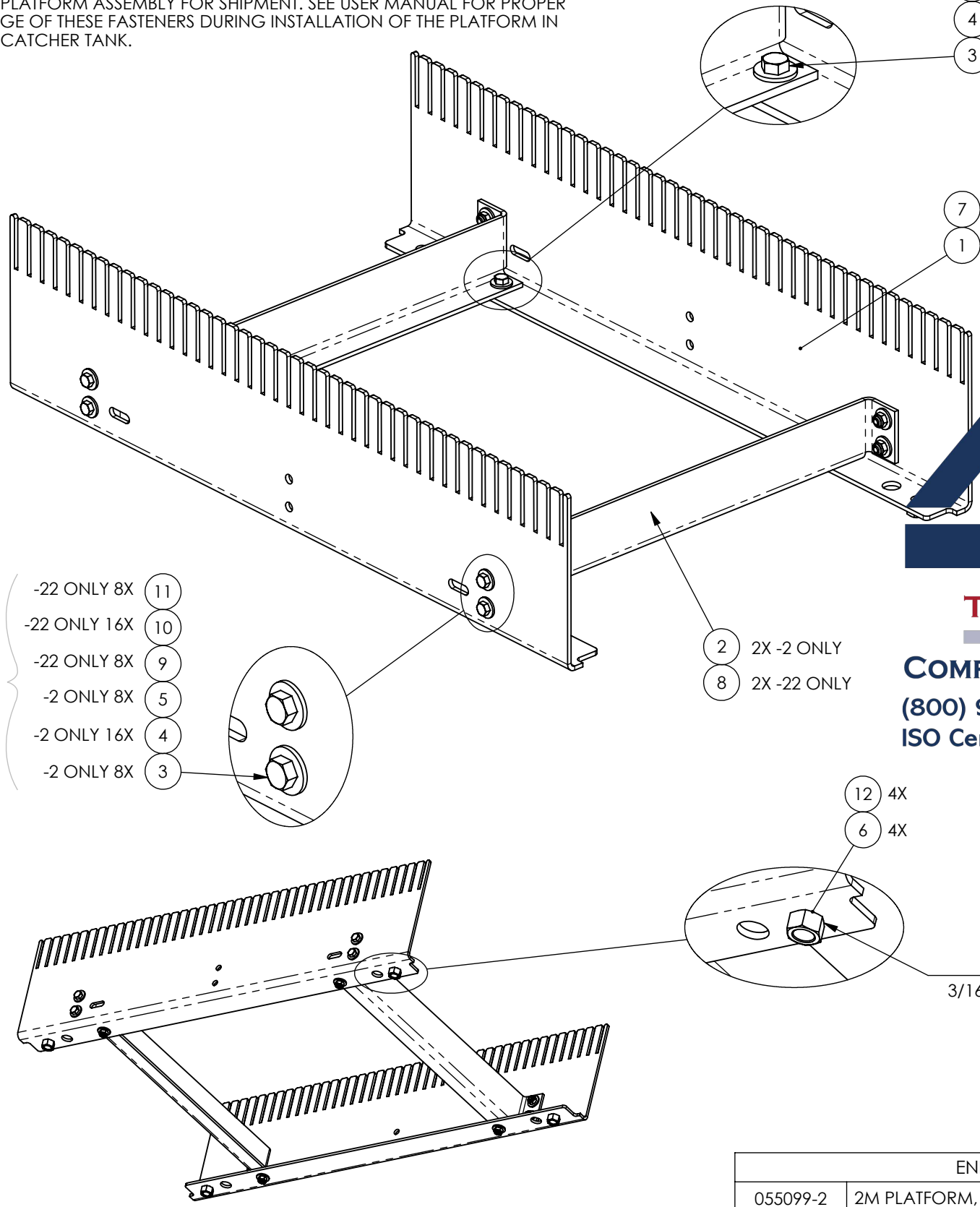

- 22 ONLY 8X 11
- 22 ONLY 16X 10
- 22 ONLY 8X 9
- 2 ONLY 8X 5
- 2 ONLY 16X 4
- 2 ONLY 8X 3

102

- 2 2X -2 ONLY
- 8 2X -22 ONLY

- 12 4X
- 6 4X

3/16 4X 103



COMPLETE METALWORKING SOLUTIONS
 (800) 991-4225 www.ahbinc.com
 ISO Certified customerservice@ahbinc.com

ITEM	-22	-2	U/M	PART NUMBER	DESCRIPTION
1	-	2	EA	055094-2	SLAT SUPPORT;STL;2M
2	-	2	EA	055096-1	SUPPORT;HORIZONTAL;A36 STEEL
3	-	12	EA	A-0171-9	SCREW;HEX HD;CS;M10X1.5;30MM
4	-	24	EA	A-20086-10	WASHER;FLAT;STL;ZINC;M10
5	-	12	EA	A-30070-6	NUT;HEX;SELF-LOCKING;STEEL;M10
6	-	4	EA	A-0311-35	NUT;HEX;STL;M16X2.0
7	2	-	EA	055094-22	SLAT SUPPORT;SST;2M
8	2	-	EA	055096-2	SUPPORT;HORIZONTAL;304 SST
9	12	-	EA	A-00641-4	SCREW;HEX;FT;SST;M10X1.5;30MM
10	24	-	EA	A-00642-6	WASHER;FLAT;METRIC;SST;M10
11	12	-	EA	A-20306-6	LOCKNUT;HEX;NYLON-INSERT;M10
12	4	-	EA	A-00643-10	NUT;HEX;SST;M16X2.0
105	13	-	EA	A-26570-120	SCREW;HHCS;FTHD;CBS;ZINC;GR 8;M16X2.0
105	14	-	EA	A-20086-16	WASHER;FLAT;STL;ZINC;M16
105	15	8	EA	A-14871-11	SCREW;HHCS;FTHD;SST;M16X2.0;120 MM
105	16	4	EA	A-00642-10	WASHER;FLAT;SST;M16

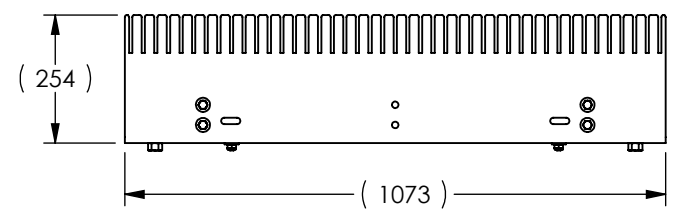
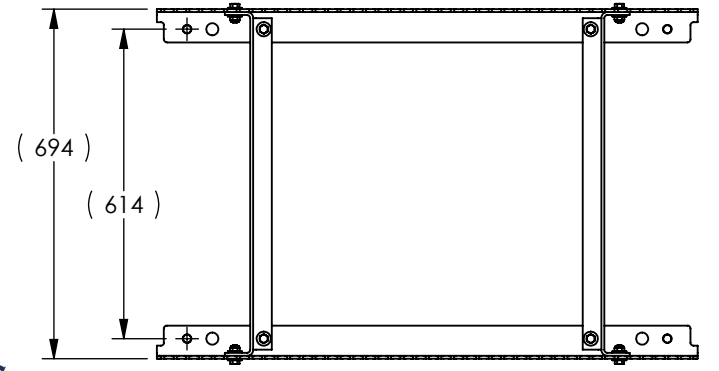

ENGINEERING REFERENCE	
055099-2	2M PLATFORM, STEEL CONSTRUCTION, PAINT REQUIRED
055099-22	2M PLATFORM, STAINLESS STEEL CONSTRUCTION, PAINT REQUIRED

UNCONTROLLED COPY. USER IS RESPONSIBLE FOR VERIFYING THE CURRENT REVISION LEVEL.

THIRD ANGLE PROJECTION		THIS DRAWING IS THE PROPERTY OF FLOW INTERNATIONAL CORPORATION AND IS NOT TO BE COPIED OR REPRODUCED WITHOUT THE WRITTEN CONSENT OF FLOW INTERNATIONAL CORPORATION.	
		MATERIAL	SEE BOM
REVISION 01	MODELED IN SOLIDWORKS	TITLE WORK PLATFORM ASSEMBLY SMART CATCHER	
DRAWN BY K. CLAEYS	STARTED 11/21/2012	BASE PART NUMBER 055099	
ENG J. HOPKINS	SCALE 1:7	1 OF 3	

NOTES:

201. FINISH: PAINT FLOW LIGHT GRAY (WMC) PER FLOW SPECIFICATION ES-1073. LIQUID PAINT ONLY.

202. APPLY ANTISEIZE TO MALE THREADS AND TORQUE TO 16 LB-FT.

203. CENTER NUTS ON OUTER HOLES IN THE FLANGES OF ITEM 1 AND WELD ON ANY TWO OPPOSITE FLATS.

204. ESTIMATED WEIGHT = 55.4 KG. (122 LBS).

205. ITEMS NOT SHOWN. BAG FASTENERS SEPARATELY AND ZIP TIE PACKAGE TO THE PLATFORM ASSEMBLY FOR SHIPMENT. SEE USER MANUAL FOR PROPER USAGE OF THESE FASTENERS DURING INSTALLATION OF THE PLATFORM IN THE CATCHER TANK.

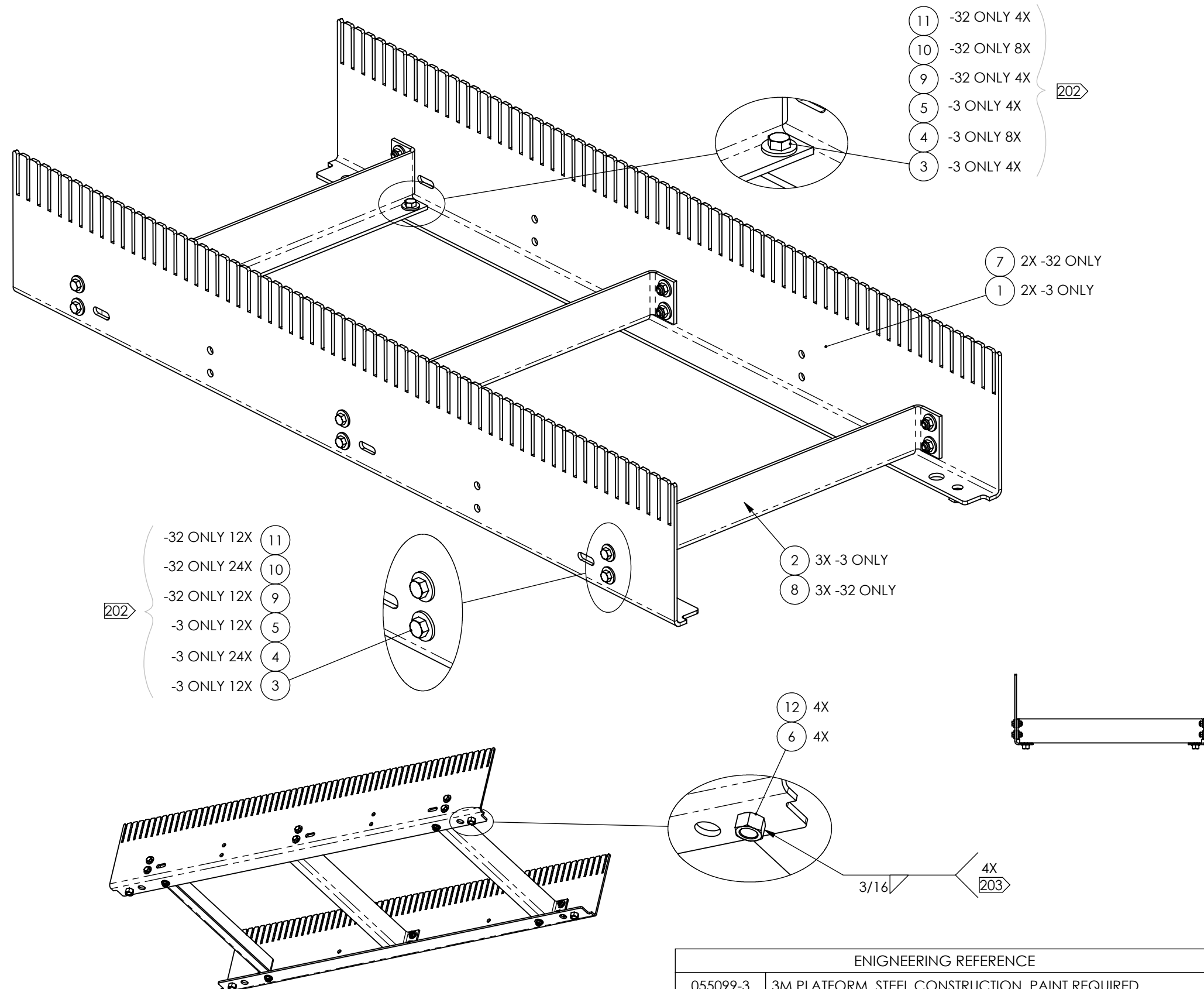

ITEM	-32	-3	U/M	PART NUMBER	DESCRIPTION
1	-	2	EA	055094-3	SLAT SUPPORT;SLT;3M
2	-	3	EA	055096-1	SUPPORT;HORIZONTAL;A36 STEEL
3	-	16	EA	A-0171-9	SCREW;HEX HD;CS;M10X1.5;30MM
4	-	32	EA	A-20086-10	WASHER;FLAT;STL;ZINC;M10
5	-	16	EA	A-30070-6	NUT;HEX;SELF-LOCKING;STEEL;M10
6	-	4	EA	A-0311-35	NUT;HEX;STL;M16X2.0
7	2	-	EA	055094-32	SLAT SUPPORT;SST;3M
8	3	-	EA	055096-2	SUPPORT;HORIZONTAL;304 SST
9	16	-	EA	A-00641-4	SCREW;HEX;FT;SST;M10X1.5;30MM
10	32	-	EA	A-00642-6	WASHER;FLAT;METRIC;SST;M10
11	16	-	EA	A-20306-6	LOCKNUT;HEX;NYLON-INSERT;M10
12	4	-	EA	A-00643-10	NUT;HEX;SST;M16X2.0
205	13	-	EA	A-26570-120	SCREW;HHCS;FTHD;CBS;ZINC;GR 8;M16X2.0
205	14	-	EA	A-20086-16	WASHER;FLAT;STL;ZINC;M16
205	15	8	EA	A-14871-11	SCREW;HHCS;FTHD;SST;M16X2.0;120 MM
205	16	4	EA	A-00642-10	WASHER;FLAT;SST;M16

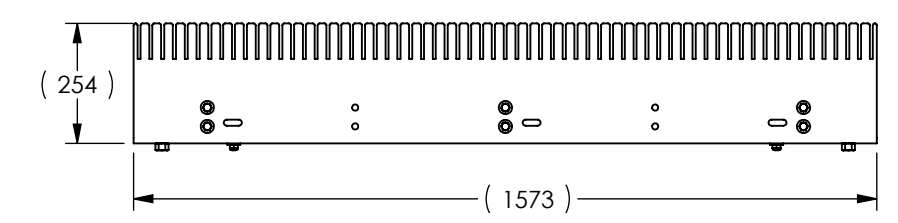
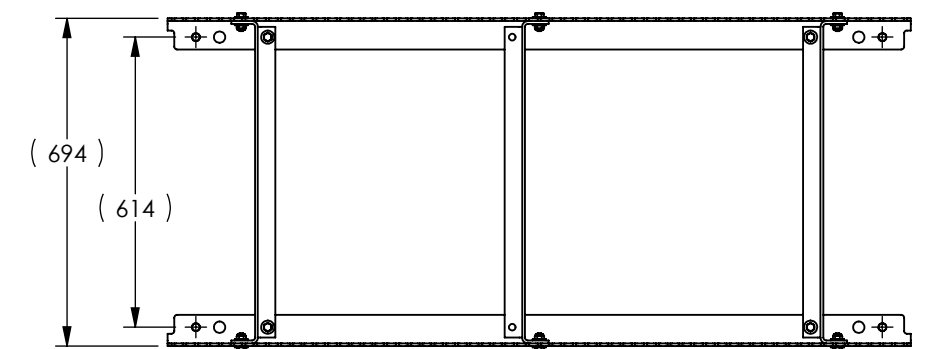

ENGINEERING REFERENCE	
055099-3	3M PLATFORM, STEEL CONSTRUCTION, PAINT REQUIRED
055099-32	3M PLATFORM, STAINLESS STEEL CONSTRUCTION, PAINT REQUIRED

THIRD ANGLE PROJECTION		THIS DRAWING IS THE PROPERTY OF FLOW INTERNATIONAL CORPORATION AND IS NOT TO BE COPIED OR REPRODUCED WITHOUT THE WRITTEN CONSENT OF FLOW INTERNATIONAL CORPORATION.	
		MATERIAL	SEE BOM
REVISION 01	MODELED IN SOLIDWORKS	TITLE WORK PLATFORM ASSEMBLY	
DRAWN BY K. CLAEYS	STARTED 11/21/2012	SMART CATCHER	
ENG J. HOPKINS	SCALE 1:7	BASE PART NUMBER	055099
			2 OF 3

NOTES:

301. FINISH: PAINT FLOW LIGHT GRAY (WMC) PER FLOW SPECIFICATION ES-1073. LIQUID PAINT ONLY.

302 APPLY ANTISEIZE TO MALE THREADS AND TORQUE TO 16 FT-LB.

303 CENTER NUTS ON OUTER HOLES IN THE FLANGES OF ITEM 1 AND WELD ON ANY TWO OPPOSITE FLATS.

304 ESTIMATED WEIGHT = 69.8 KG. (154 LBS).

305 ITEMS NOT SHOWN. BAG FASTENERS SEPARATELY AND ZIP TIE PACKAGE TO THE PLATFORM ASSEMBLY FOR SHIPMENT. SEE USER MANUAL FOR PROPER USAGE OF THESE FASTENERS DURING INSTALLATION OF THE PLATFORM IN THE CATCHER TANK.

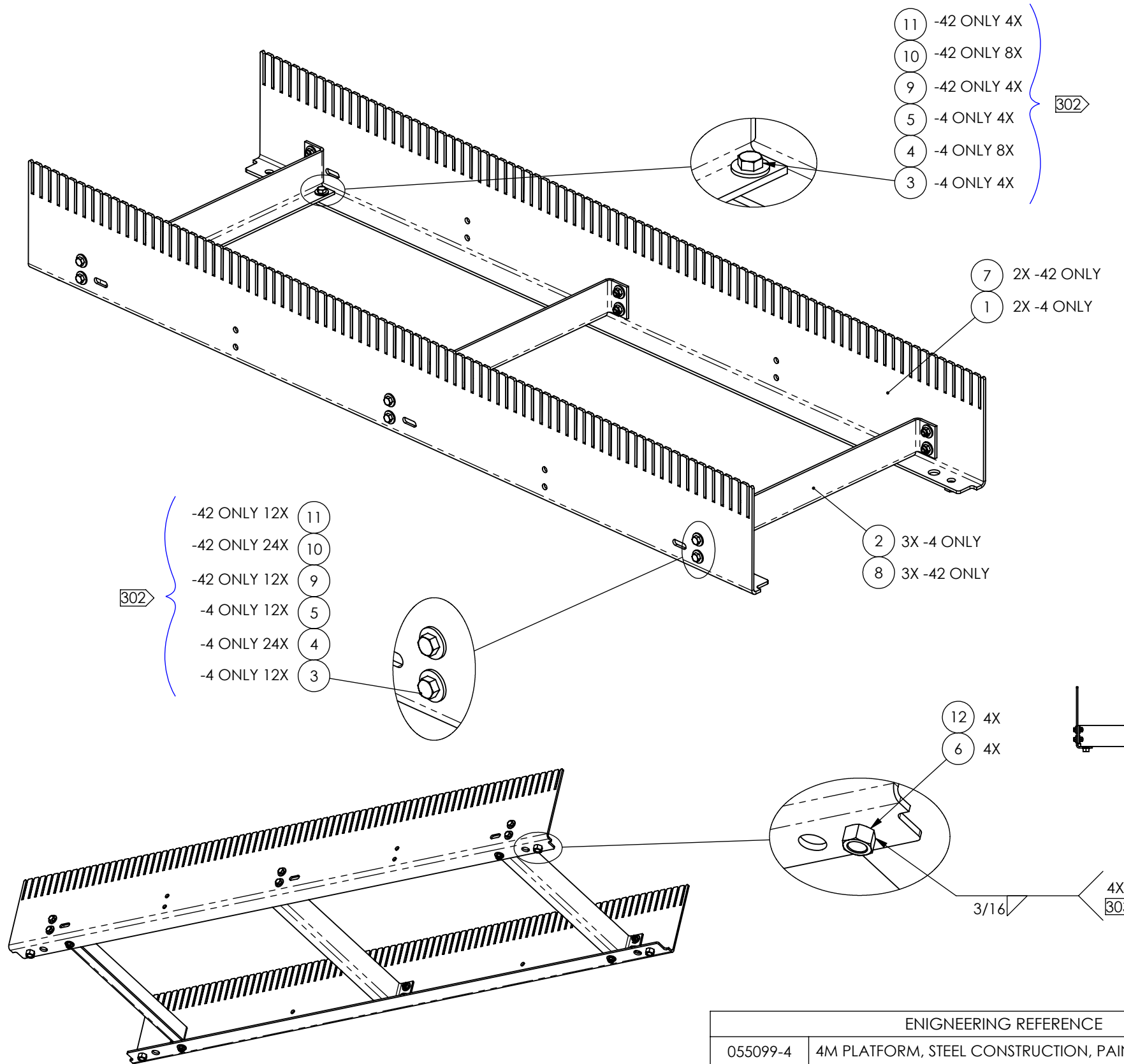

ITEM	-42	-4	U/M	PART NUMBER	DESCRIPTION
1	-	2	EA	055094-4	SLAT SUPPORT;STL;4M
2	-	3	EA	055096-1	SUPPORT;HORIZONTAL;A36 STEEL
3	-	16	EA	A-0171-9	SCREW;HEX HD;CS;M10X1.5;30MM
4	-	32	EA	A-20086-10	WASHER;FLAT;STL;ZINC;M10
5	-	16	EA	A-30070-6	NUT;HEX;SELF-LOCKING;STEEL;M10
6	-	4	EA	A-0311-35	NUT;HEX;STL;M16X2.0
7	2	-	EA	055094-42	SLAT SUPPORT;SST;4M
8	3	-	EA	055096-2	SUPPORT;HORIZONTAL;304 SST
9	16	-	EA	A-00641-4	SCREW;HEX;FT;SST;M10X1.5;30MM
10	32	-	EA	A-00642-6	WASHER;FLAT;METRIC;SST;M10
11	16	-	EA	A-20306-6	LOCKNUT;HEX;NYLON-INSERT;M10
12	4	-	EA	A-00643-10	NUT;HEX;SST;M16X2.0
305	13	-	EA	A-26570-120	SCREW;HHCS;FTHD;CBS;ZINC;GR 8;M16X2.0
305	14	-	EA	A-20086-16	WASHER;FLAT;STL;ZINC;M16
305	15	8	EA	A-14871-11	SCREW;HHCS;FTHD;SST;M16X2.0;120 MM
305	16	4	EA	A-00642-10	WASHER;FLAT;SST;M16

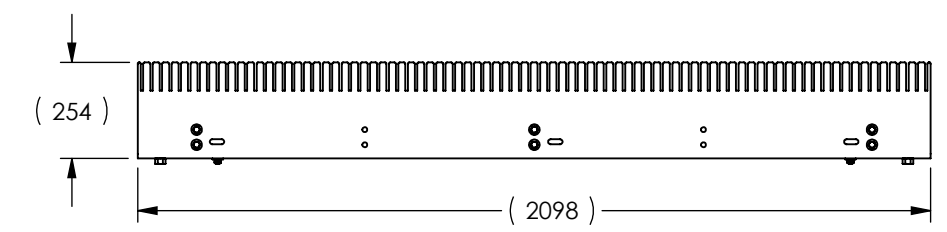
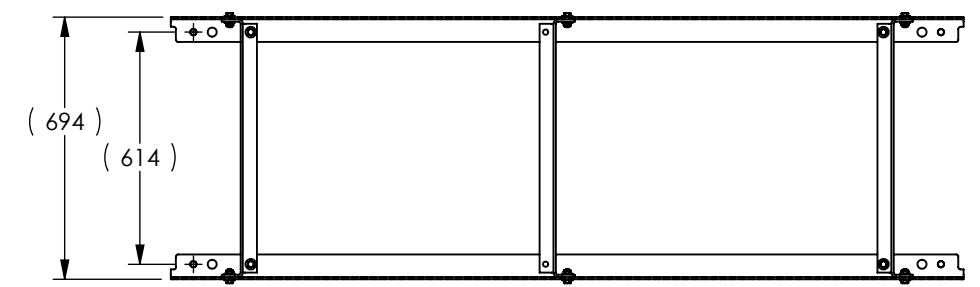

ENGINEERING REFERENCE	
055099-4	4M PLATFORM, STEEL CONSTRUCTION, PAINT REQUIRED
055099-42	4M PLATFORM, STAINLESS STEEL CONSTRUCTION, PAINT REQUIRED

THIRD ANGLE PROJECTION		THIS DRAWING IS THE PROPERTY OF FLOW INTERNATIONAL CORPORATION AND IS NOT TO BE COPIED OR REPRODUCED WITHOUT THE WRITTEN CONSENT OF FLOW INTERNATIONAL CORPORATION.	
		MATERIAL	SEE BOM
REVISION 01	MODELED IN SOLIDWORKS	TITLE WORK PLATFORM ASSEMBLY	
DRAWN BY K. CLAEYS	STARTED 11/21/2012	SMART CATCHER	
ENG J. HOPKINS	SCALE 1:10	BASE PART NUMBER	055099
			3 OF 3