

FACILITY REQUIREMENTS				
ITEM	TYPE	DESCRIPTION	CAPACITY	INTERFACE TYPE
1	AIR	PRESSURE CONTROL VALVE	6.2-8.3 BAR (90-120 PSI), 10 MICRON FILTERED	1/4" NPT FEMALE
2	WATER	5 MICRON FILTERED INLET	<ul style="list-style-type: none"> • 30 HP: 7.6 L/MIN (2 GPM) @ 3.9 BAR (57 PSI), 12.8-21.1° C (55-70° F) • 50 HP: 11.4 L/MIN (3 GPM) @ 4.5 BAR (65 PSI), 12.8-21.1° C (55-70° F) 	1/2" NPT FEMALE
3	DRAIN	BLEED-DOWN DRAIN	<ul style="list-style-type: none"> • 30 HP: 3.4 L/MIN (0.9 GPM), 100° C (212° F) • 50 HP: 5.7 L/MIN (1.5 GPM), 100° C (212° F) 	1/2" NPT FEMALE
4	POWER	SEE ELECTRICAL REQUIREMENTS TABLE		

NOTES:

101. 1.9 L (2.0 QT) OF SHELL MORLINA 100 OIL IS REQUIRED FOR PUMP RESERVOIR. OTHER BRANDS OF EQUIVALENT ISO 100 OIL MAY BE USED. LATER MODEL CRANKCASES REQUIRE 4.0 L (4.2 QT) OF OIL. VISUAL VERIFICATION OF DIPSTICK LEVEL WILL ASSURE PROPER OIL VOLUME.
102. COOLING AND FILTERED INLET WATER TO HIGH-PRESSURE PUMP MUST BE WITHIN THE RANGE OF PRESSURE, TEMPERATURE AND FLOW RATE GIVEN IN TABLE ABOVE. ANCILLARY HARDWARE SUCH AS BOOST PUMPS, CHILLERS OR WATER SOFTENERS TO MEET THESE REQUIREMENTS ARE THE RESPONSIBILITY OF THE END USER.
103. MAXIMUM AMBIENT TEMPERATURE IS 40° C (104° F)
104. WATER CHEMISTRY REQUIREMENTS ARE REFERENCED IN SB-0265
- 105 FULL-LOAD AMPERAGES ARE FOR PUMP ONLY. X-Y TABLE FULL-LOAD AMPERAGES WILL REQUIRE CONSIDERATION IN DETERMINING WIRE-DROP SIZING.
- 106 ELECTRICAL MOTOR STARTER MAY BE LOCATED EITHER ON-BOARD PUMP OR EXTERNALLY WALL-MOUNTED. ADDITIONALLY, SOME PUMPS ARE OFFERED WITHOUT MOTOR STARTERS.
107. SEPARATE COOLING WATER SUPPLY LINE NOT REQUIRED FOR THIS PUMP
- 108 "UTILIZATION" VOLTAGE IS 3-5% LOWER THAN NOMINAL SYSTEM VOLTAGE. WHERE REFERENCED, THE UTILIZATION VOLTAGE IS EQUIVALENT TO THE NAMEPLATE VOLTAGE OF A PRODUCT.

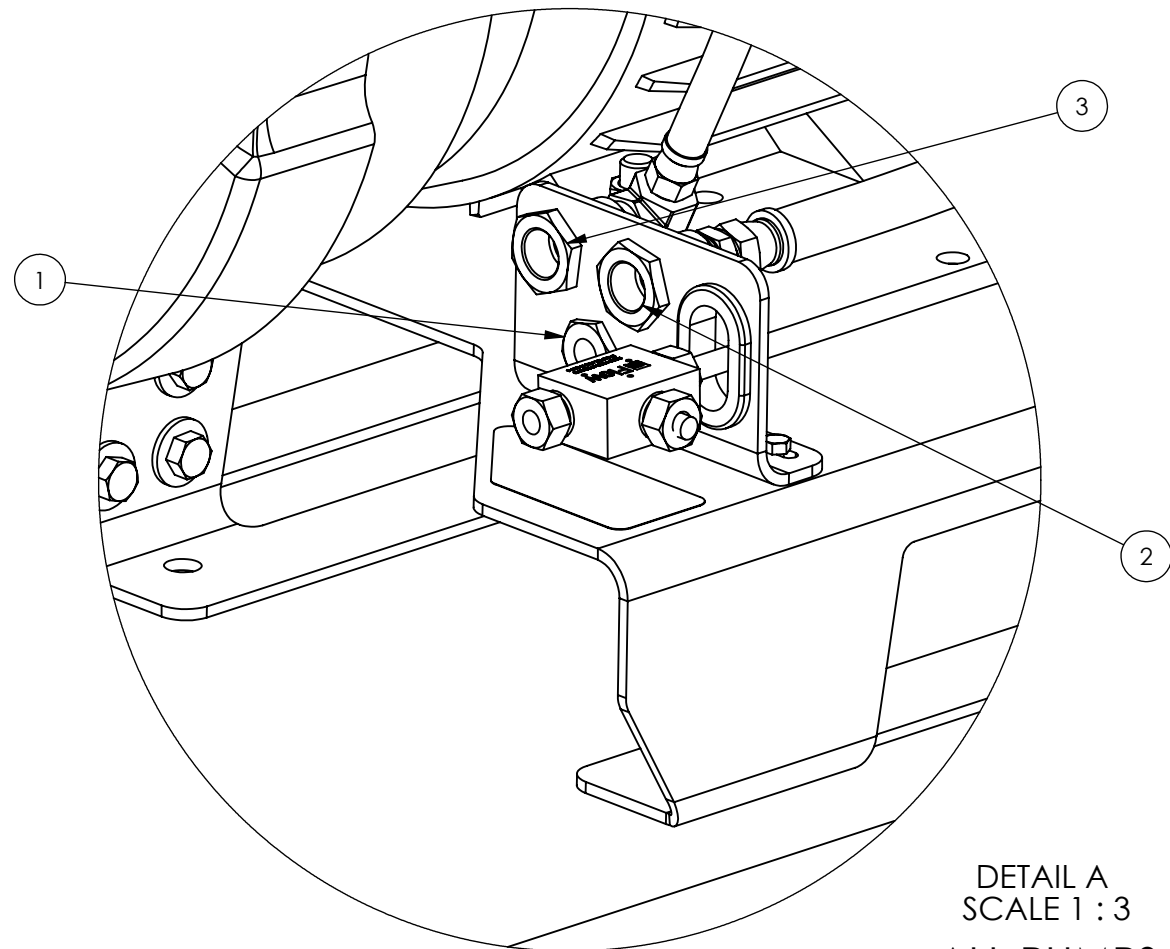

DETAIL A
SCALE 1 : 3
ALL PUMPS

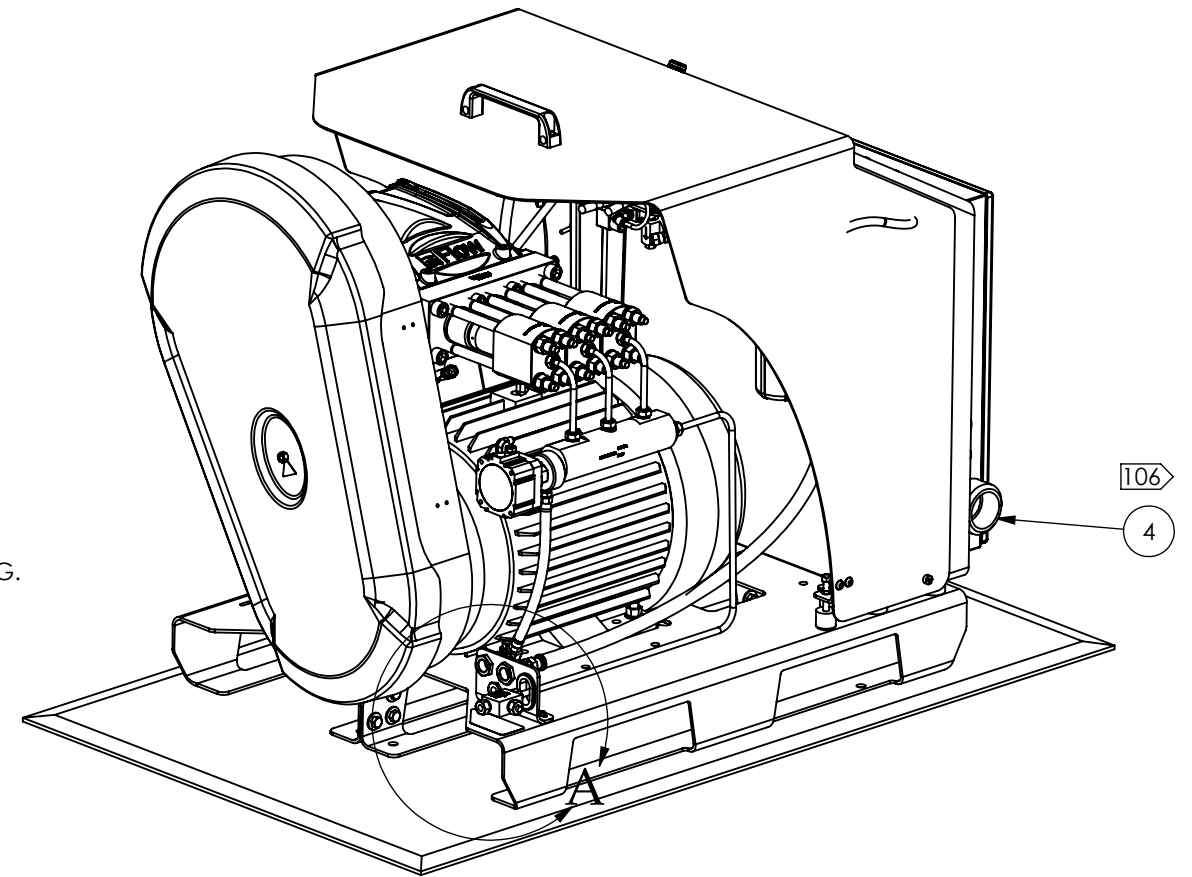

PUMPS WITH ON-BOARD
MOTOR STARTER

ELECTRICAL REQUIREMENTS			
3-PHASE NOMINAL SYSTEM VOLTAGE/FREQUENCY	HP	PUMP FULL-LOAD AMPERAGE	MOTOR STARTER CIRCUIT BREAKER SIZE
108		105 106	106
200V - 50/60 HZ		NOT SUPPORTED	
208V - 60 HZ			
230V - 50 HZ			
240V - 60 HZ	30/50	74A/114A	175A/250A
380V - 60 HZ		NOT SUPPORTED	
400V - 50 HZ	30/50	40A/67A	100A/175A
480V - 60 HZ	30/50	37A/58A	100A/175A

THIRD ANGLE
PROJECTION



Flow

THIS DRAWING IS THE PROPERTY OF FLOW INTERNATIONAL CORPORATION AND IS NOT TO BE COPIED OR REPRODUCED WITHOUT THE WRITTEN CONSENT OF FLOW INTERNATIONAL CORPORATION.

MATERIAL

DRAWN BY J.OROVA STARTED 4/3/2012 ENG J.HOPKINS EST WEIGHT N/A MODELED IN SOLIDWORKS

TITLE PRE-INSTALL;HYPLEX PRIME;DIRECT DRIVE

REVISION A SCALE 1:12 BASE PART NUMBER 052284 1 OF 3

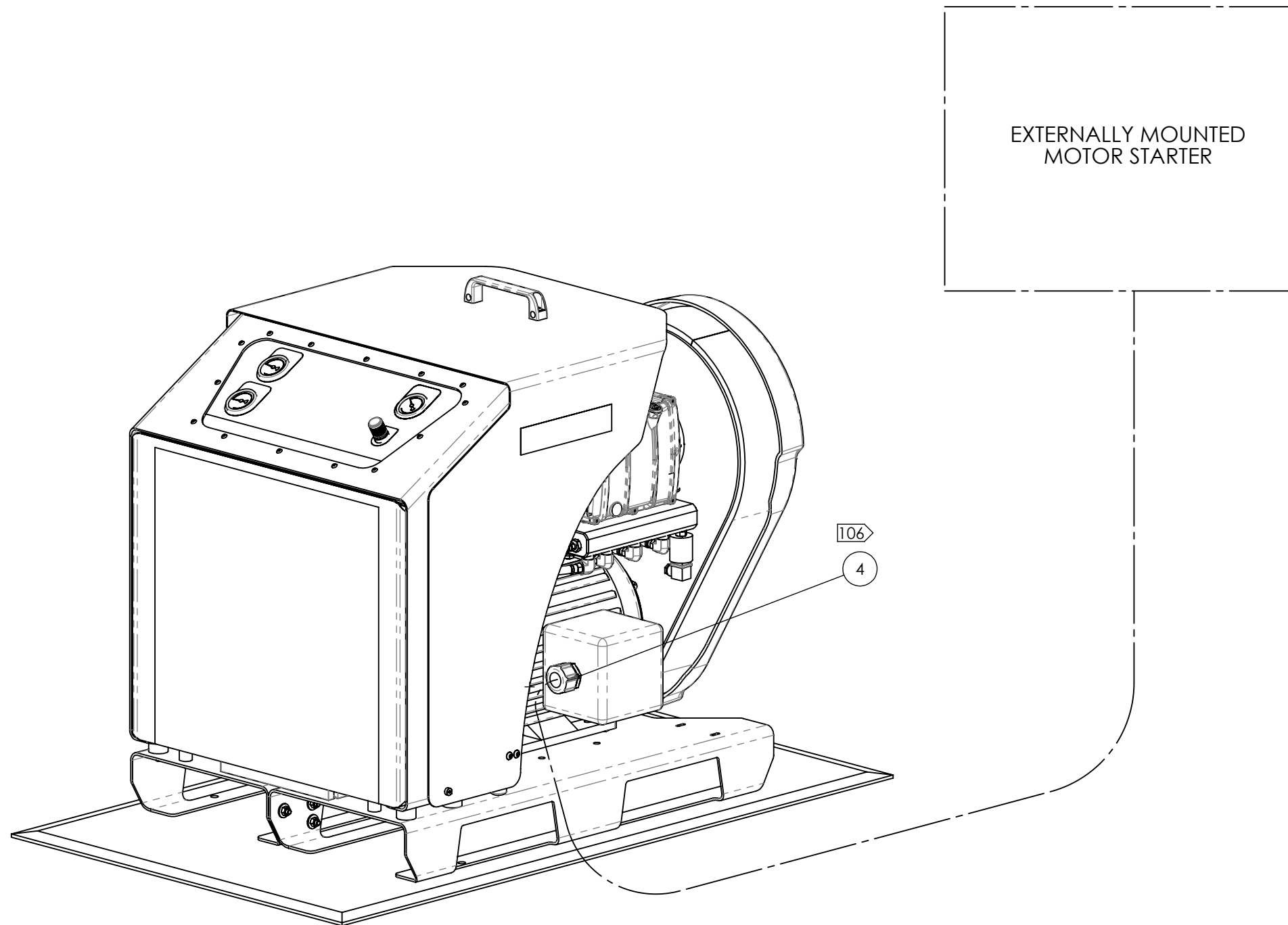

PUMPS WITH EXTERNAL
MOTOR STARTER

THIRD ANGLE PROJECTION		THIS DRAWING IS THE PROPERTY OF FLOW INTERNATIONAL CORPORATION AND IS NOT TO BE COPIED OR REPRODUCED WITHOUT THE WRITTEN CONSENT OF FLOW INTERNATIONAL CORPORATION.		
	MATERIAL			
DRAWN BY J.OROVA	STARTED 4/3/2012	ENG J.HOPKINS	EST WEIGHT N/A	MODELED IN SOLIDWORKS
TITLE PRE-INSTALL;HYPLEX PRIME;DIRECT DRIVE				
REVISION A	SCALE 1:10	BASE PART NUMBER	052284	2 OF 3

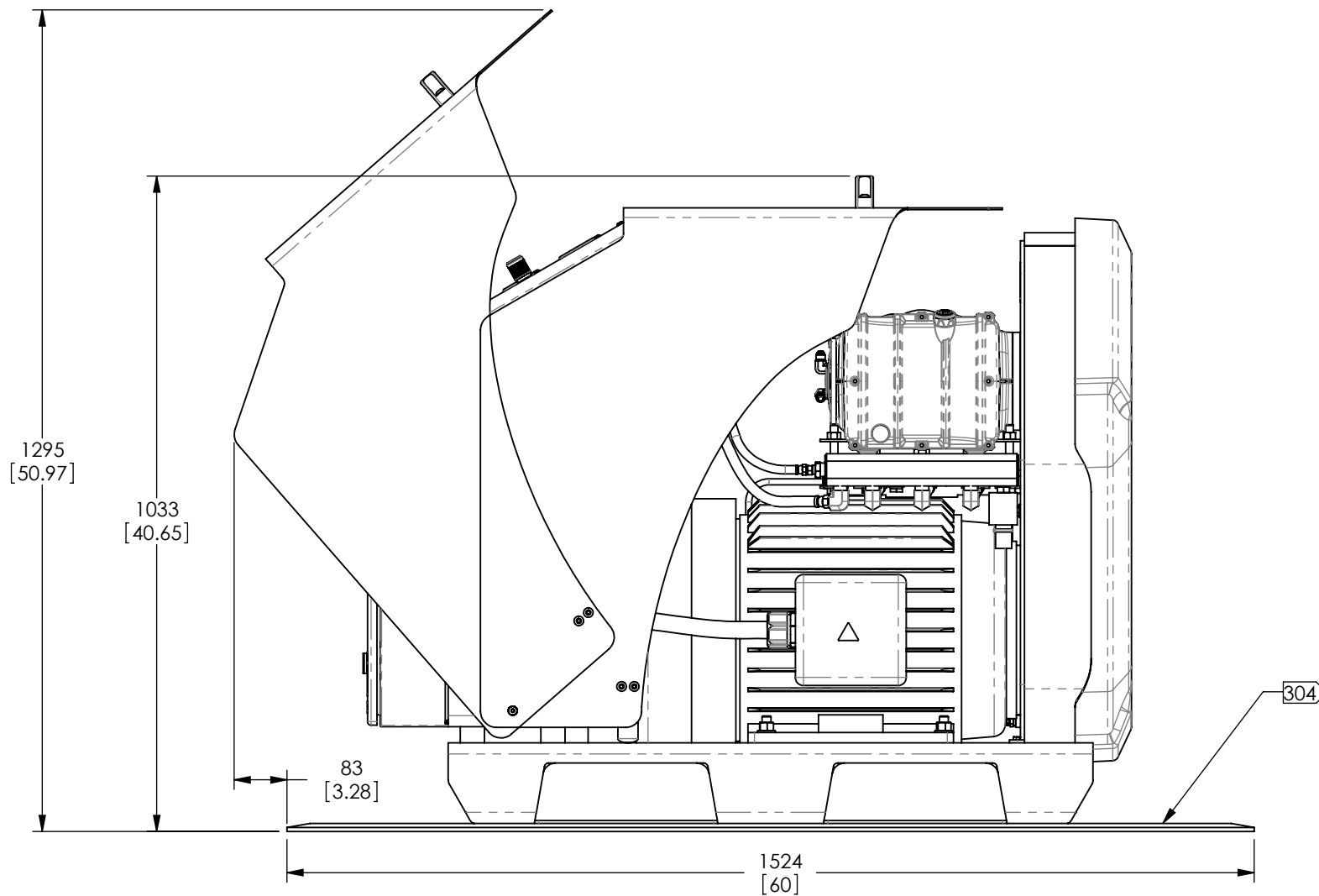
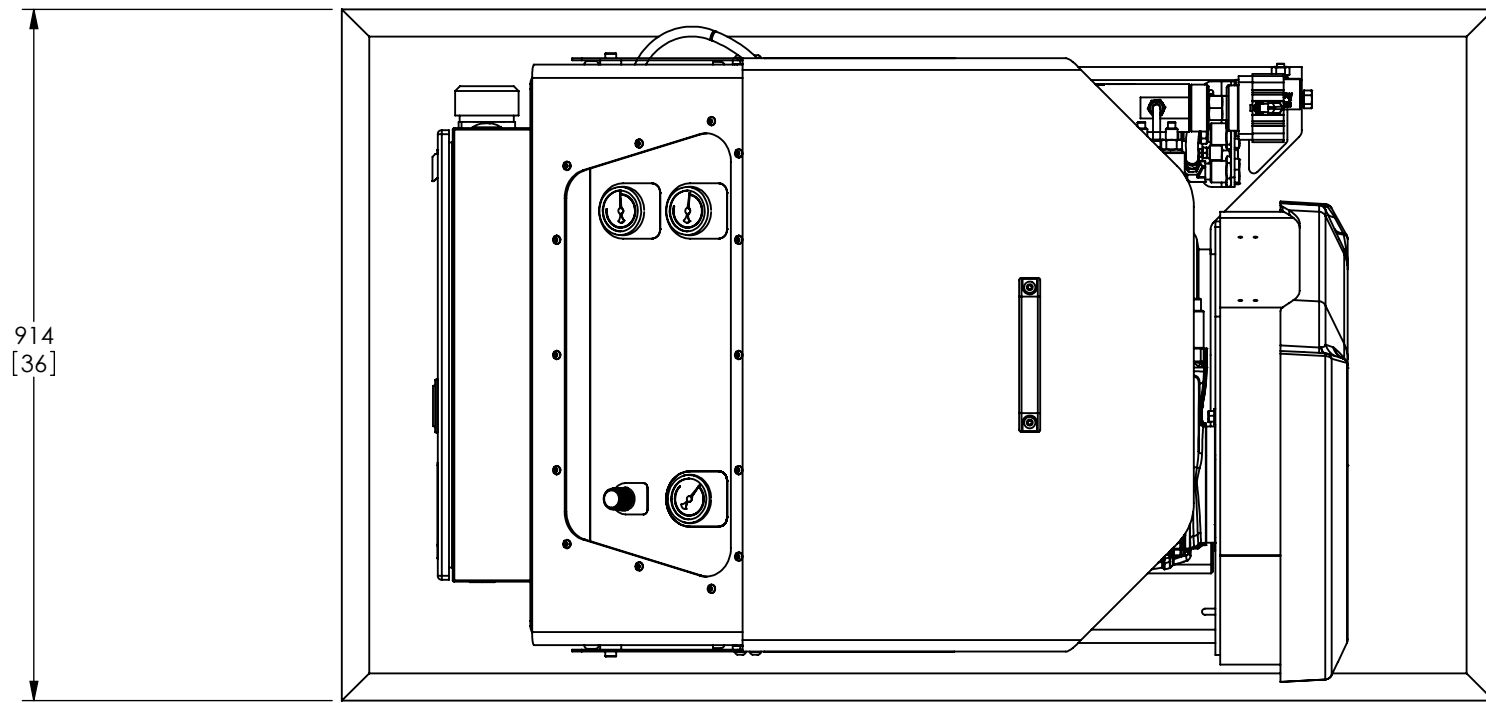

NOTES:

301. THE FOLLOWING LENGTHS OF UHP TUBING RUNS MUST BE AVOIDED:
- 30 HP: 13.7 M (45 FT)
 - 50 HP: 9.1 M (30 FT)
302. PUMP WEIGHT IS APPROXIMATELY 477 KG (1050 LB).
303. DIMENSIONS ARE IN MILLIMETERS. DIMENSIONS IN BRACKETS ARE IN INCHES.
- 304 PUMP MUST BE INSTALLED ON SUPPLIED RUBBER MAT.

THIRD ANGLE PROJECTION			THIS DRAWING IS THE PROPERTY OF FLOW INTERNATIONAL CORPORATION AND IS NOT TO BE COPIED OR REPRODUCED WITHOUT THE WRITTEN CONSENT OF FLOW INTERNATIONAL CORPORATION.		
	MATERIAL				
DRAWN BY J.OROVA	STARTED 4/3/2012	ENG J.HOPKINS	EST WEIGHT N/A	MODELED IN SOLIDWORKS	
TITLE PRE-INSTALL;HYPLEX PRIME;DIRECT DRIVE					
REVISION A	SCALE 1:10	BASE PART NUMBER	052284		3 OF 3