

 **Nakamura-Tome**
Precision Industry Co., Ltd.



TW10

**GET
THE
MOST
FROM
YOUR
TURNING
CENTER**



*High Precision Tool Holders And Spindle Units
For Most CNC Turning Machines*

BARDONS & OLIVER • HITACHI SEIKI
• OMNITURN • BARUFFALDI •
HURCO • PROEBA • BENZINGER
• HWACHEON • REPUBLIC CLAGUN
• BOEHRINGER • HYUNDAI KIA
• ROMI • BIGLIA • IKEGAI •
SMT TRICEPT • CINCINNATI •
INDEX • STAR • CITIZEN • JINN
FA • TAKISAWA • CLAUSING
• JOHN FORD • TONGIL •
DAEWOO • JONES & LAMSON •
TORNOS • DOOSAN • KIA •
TOSHIBA • DOOSAN INFRACORE
• KINGSBURY • TRAUB •
EMAG • LEADWELL • TSUGAMI
• EMCO MAIER • LODGE &
SHIPLEY • VICTOR • ESCO •
KINGSTON • MATRA • SOUTH
BEND • WASINO • EUROTECH
• MAZAK • WEILER • FAMAR
• MIGHTY SPINNER • FAMOT
• MILLTRONICS • FORTUNE •
MIYANO • GUNGS & LEWIS
• MCGHEE • ALDEMI
• TORAL
• NAKAMURA • HAAK • NEW
BRITAIN • HARDINGE • OKUMA
• BARDONS & OLIVER • HITACHI
SEIKI • HURCO • PROEBA
• BENZINGER • CLAUSING
• JOHN FORD • TONGIL •



ITI TOOLING COMPANY INC. is a unique and experienced supply company, offering an extensive range of top-quality "Driven" and "Static" tool holding solutions for most CNC Lathes from around the world.

We supply the world's finest CNC Lathe Tool Holders, manufactured by companies who have been recognized as industry leaders for decades. Our clients have gained confidence in the quality and "know-how" that comes from our many years experience addressing a broad spectrum of applications in all industries. Applications that utilize not only our standard Tool Holders but also "Multi-Head" and "Multi-Spindle" Units, along with other custom designs, which have economically solved problems for today's more demanding, multi-tasking and highly competitive manufacturing environments.

We offer precision, top quality toolholders and spindle units designed as Bolt-on, VDI and other styles of mounting systems that are available and manufactured to meet the highest standards of quality using only the finest materials available.



ITI TOOLING COMPANY INC.

37 Orchard St., Ramsey, N.J. 07446 1-888-88-INDEX



What we are made of...

Our focus is on the highest quality standards and utmost commitment to ensure the optimal design of our products in form and function. For this purpose, we systematically invest in state-of-the-art production lines and develop methods for quality assurance in cooperation with external institutions.

Competence and reliability in our advisory services, our daily communication and project management – these are the core elements convincing our customers of our performance and services over and over again.

www.ITITooling.com

*Even the finest "state of the art" cutting tools used on the best lathes
are only as good as the **tool holders** that support them.*



Twelve reasons to specify ITI Tooling Co.

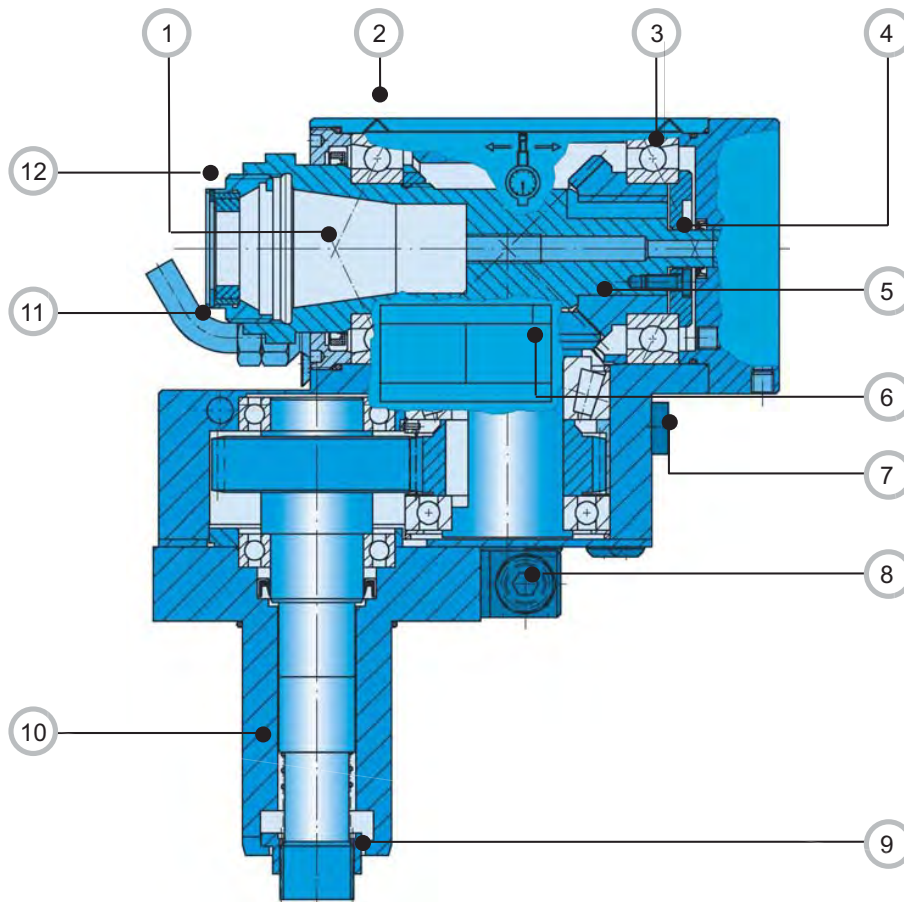

- | | |
|--|---|
| <ul style="list-style-type: none"> ① Highest possible rotational accuracy. ② Qualified datum surface for rapid alignment. ③ Optimum pre-loaded bearing configurations for maximum stiffness ■ ④ Patented high-pressure internal coolant delivery system. ⑤ High-precision gear train of optimum power and performance. ⑥ Laser etched identification plate. ⑦ Independent external coolant connection ■ ⑧ Unique “rapid-set” spindle alignment device to minimize tool change and set-up time. | <ul style="list-style-type: none"> ⑨ Patented spindle orientation detent for rapid tool drive engagement ⑩ Many units offered with a Universal mounting shank with double tooth rack for right-hand or left-hand operation ⑪ External coolant supply – can be individually fitted ⑫ Many units have a recessed collet clamping nit ensuring maximum stiffness and an optimum interference free zone |
|--|---|

All spindle units undergo stringent monitoring during a running-in procedure testing, including thermal testing and prior to delivery, to ensure guaranteed performance immediately upon being placed into service.

ITI - Axial (straight) Drilling and Milling Head

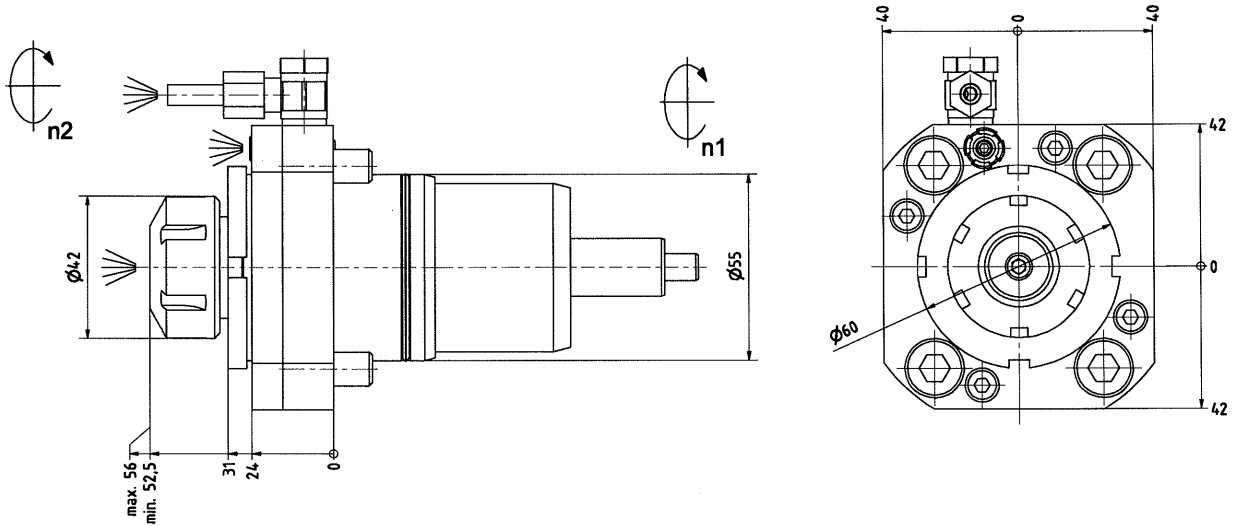

Part No.

40.5525TW10-IK

Subject to technical modifications

Coolant	i	M1	M2	n1	n2	Collet	Clamping Range
Int. / Ext.	1:1	25 Nm	25 Nm	6000 1/min	6000 1/min	ER25	1.0-16.0

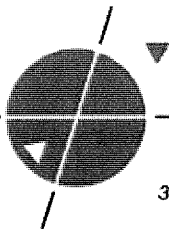
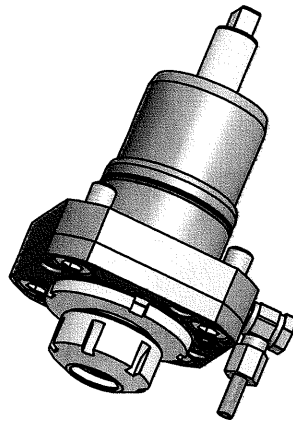

ITI TOOLING COMPANY

A Division of **INDEXING TECHNOLOGIES INC.**

37 Orchard Street., Ramsey, NJ. 07446 - Phone (201) 934-6333 - Fax (201) 934-6333 www.indexingtechnologies.com
www.ititooling.com

ITI - Axial (straight) Drilling and Milling Head

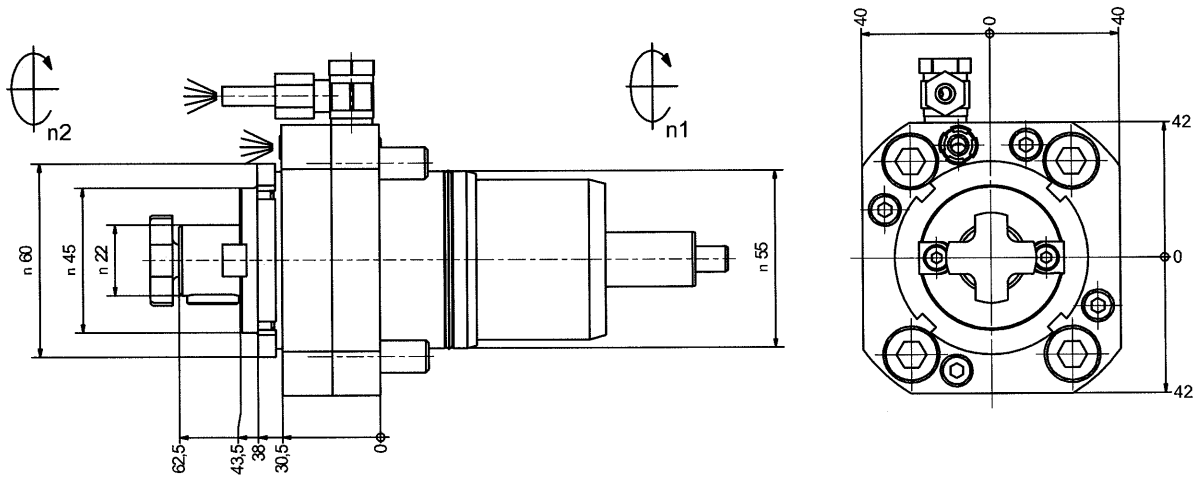

Part No.
42.5522TW10

Subject to technical modifications

Coolant	i	M1	M2	n1	n2
Ext.	1:1	25 Nm	25 Nm	6000 1/min	6000 1/min

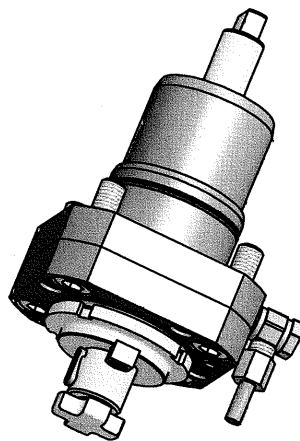

ITI TOOLING COMPANY

A Division of **INDEXING TECHNOLOGIES INC.**

37 Orchard Street., Ramsey, NJ. 07446 - Phone (201) 934-6333 - Fax (201) 934-6333 www.indexingtechnologies.com
www.ititooling.com

ITI - Axial (straight) Drilling and Milling Head

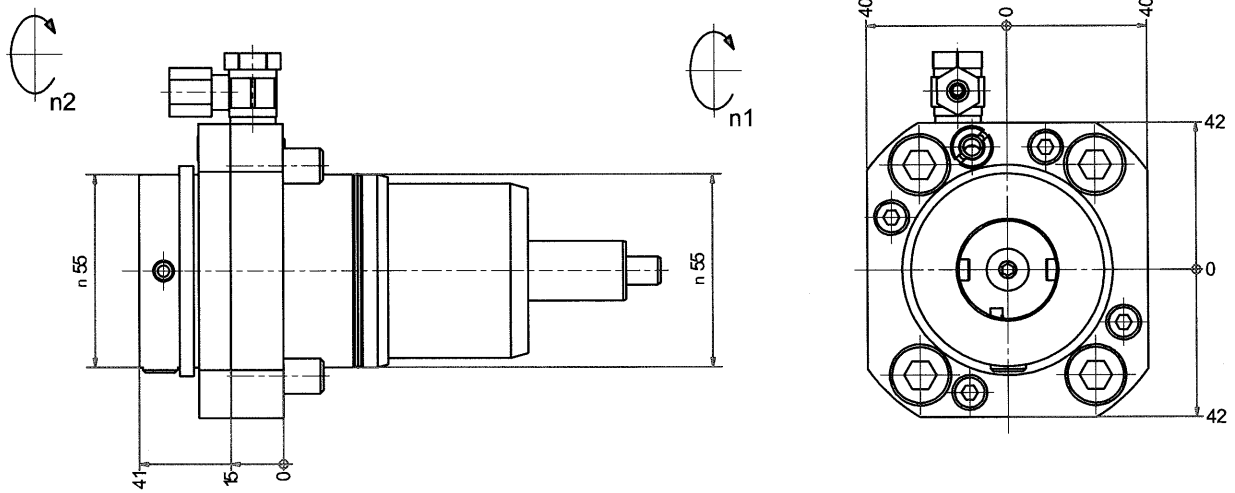

Part No.
40.55V3TW10

Subject to technical modifications

Coolant	i	M1	M2	n1	n2	Tooling System
Ext.	1:1	25 Nm	25 Nm	6000 1/min	6000 1/min	Varia - V3

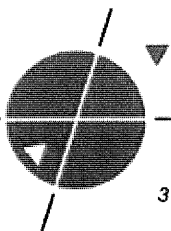
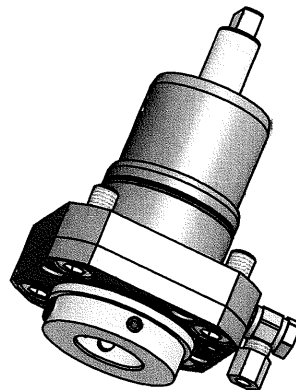

ITI TOOLING COMPANY

A Division of **INDEXING TECHNOLOGIES INC.**

37 Orchard Street., Ramsey, NJ, 07446 - Phone (201) 934-6333 - Fax (201) 934-6333 www.indexingtechnologies.com
www.ititooling.com

ITI - Axial (straight) Drilling and Milling Head

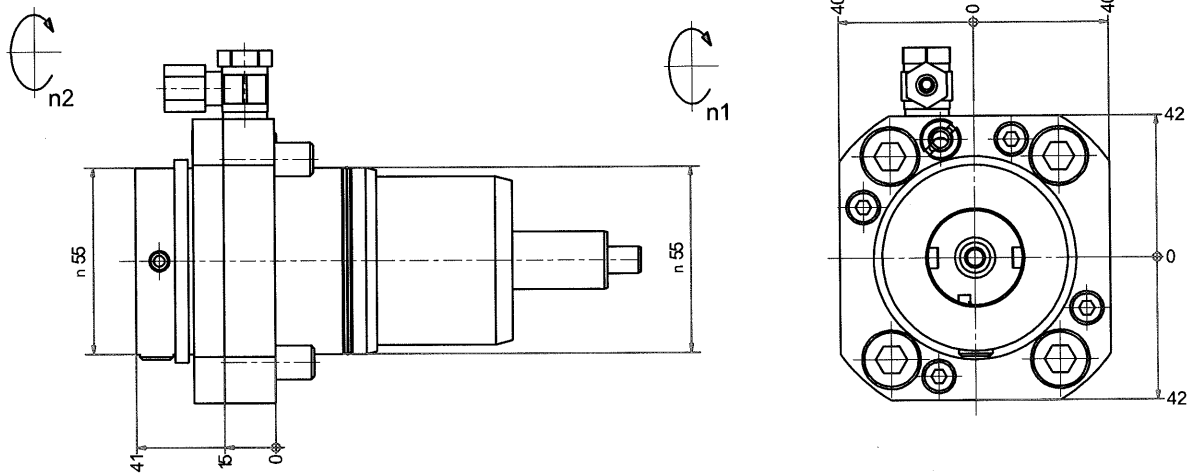

Part No.
40.55V3TW10-IK

Subject to technical modifications

Coolant	i	M1	M2	n1	n2	Tooling System
Int. / Ext.	1:1	25 Nm	25 Nm	6000 1/min	6000 1/min	Varia - V3

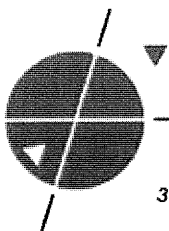
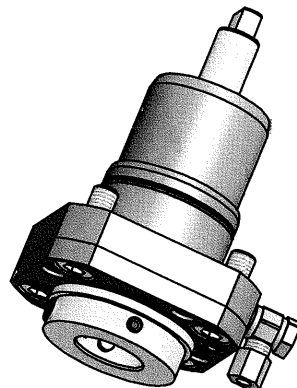

ITI TOOLING COMPANY

A Division of **INDEXING TECHNOLOGIES INC.**

37 Orchard Street., Ramsey, NJ. 07446 - Phone (201) 934-6333 - Fax (201) 934-6333 www.indexingtechnologies.com
www.ititooling.com

ITI - Radial (90°) Drilling and Milling Head

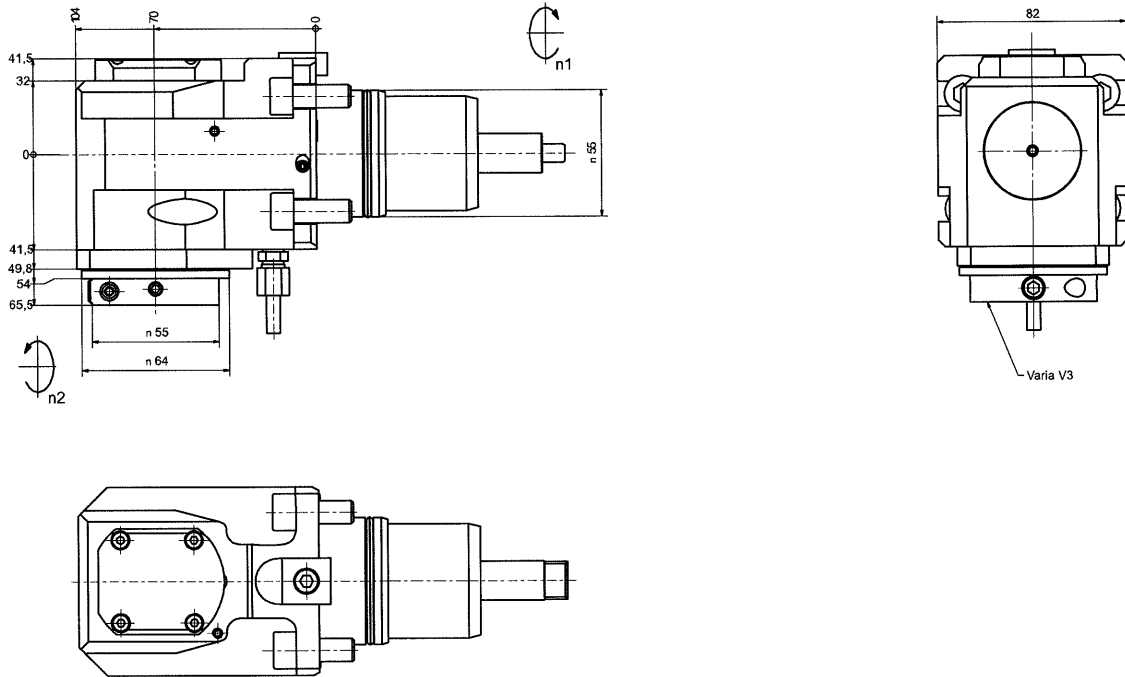

Part No.

60.55V3TW10

Subject to technical modifications

Coolant	i	M1	M2	n1	n2	Tooling System
Ext.	1:1	25 Nm	25 Nm	6000 1/min	6000 1/min	Varia - V3

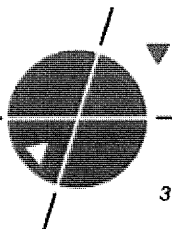
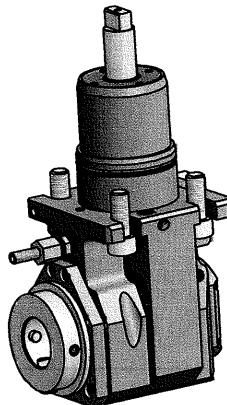

ITI TOOLING COMPANY

A Division of **INDEXING TECHNOLOGIES INC.**

37 Orchard Street., Ramsey, NJ. 07446 - Phone (201) 934-6333 - Fax (201) 934-6333 www.indexingtechnologies.com
www.ititooling.com

ITI - Radial (90°) Drilling and Milling Head

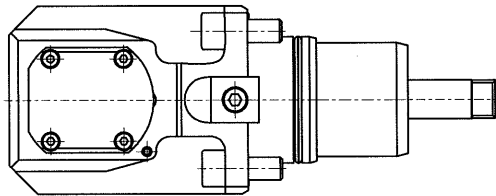
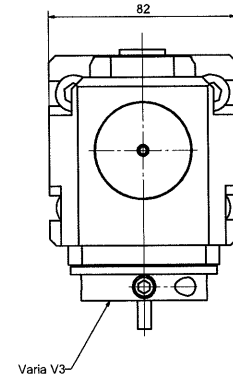
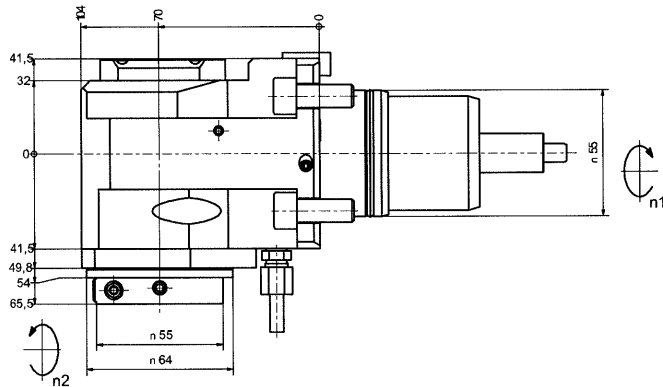

Part No.
60.55V3TW10i1

Subject to technical modifications

Coolant	i	M1	M2	n1	n2	Tooling System
Ext.	1:1	24 Nm	12 Nm	6000 1/min	12000 1/min	Varia - V3

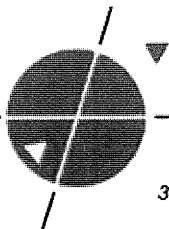
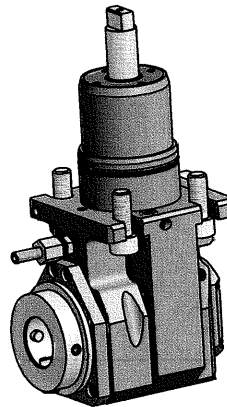

ITI TOOLING COMPANY

A Division of **INDEXING TECHNOLOGIES INC.**

37 Orchard Street., Ramsey, NJ. 07446 - Phone (201) 934-6333 - Fax (201) 934-6333 www.indexingtechnologies.com
www.ititooling.com

ITI - Radial (90°) Drilling and Milling Head

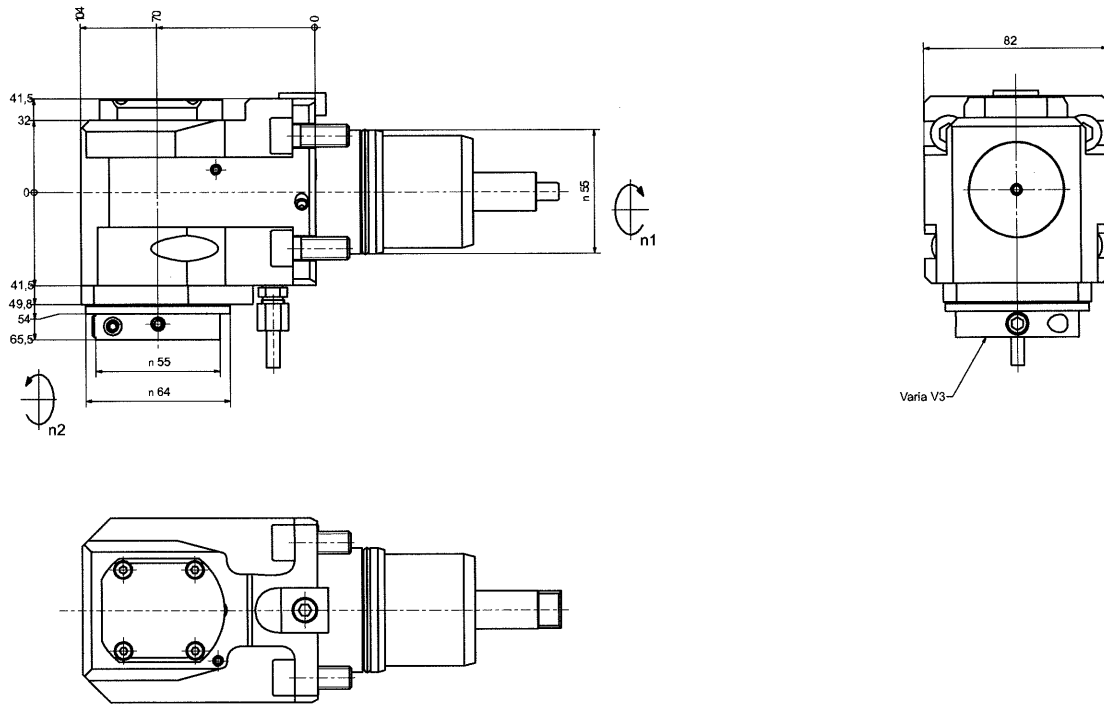

Part No.
60.55V3TW10i2

Subject to technical modifications

Coolant	i	M1	M2	n1	n2	Tooling System
Ext.	2:1	25 Nm	50 Nm	6000 1/min	3000 1/min	Varia - V3

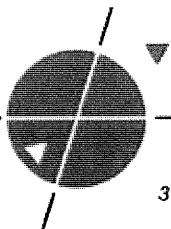
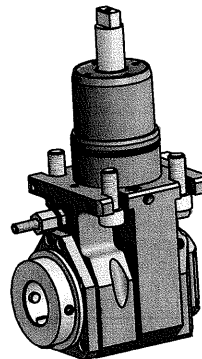

ITI TOOLING COMPANY

A Division of **INDEXING TECHNOLOGIES INC.**

37 Orchard Street., Ramsey, NJ. 07446 - Phone (201) 934-6333 - Fax (201) 934-6333 www.indexingtechnologies.com
www.ititooling.com

ITI - Radial (90°) Drilling and Milling Head

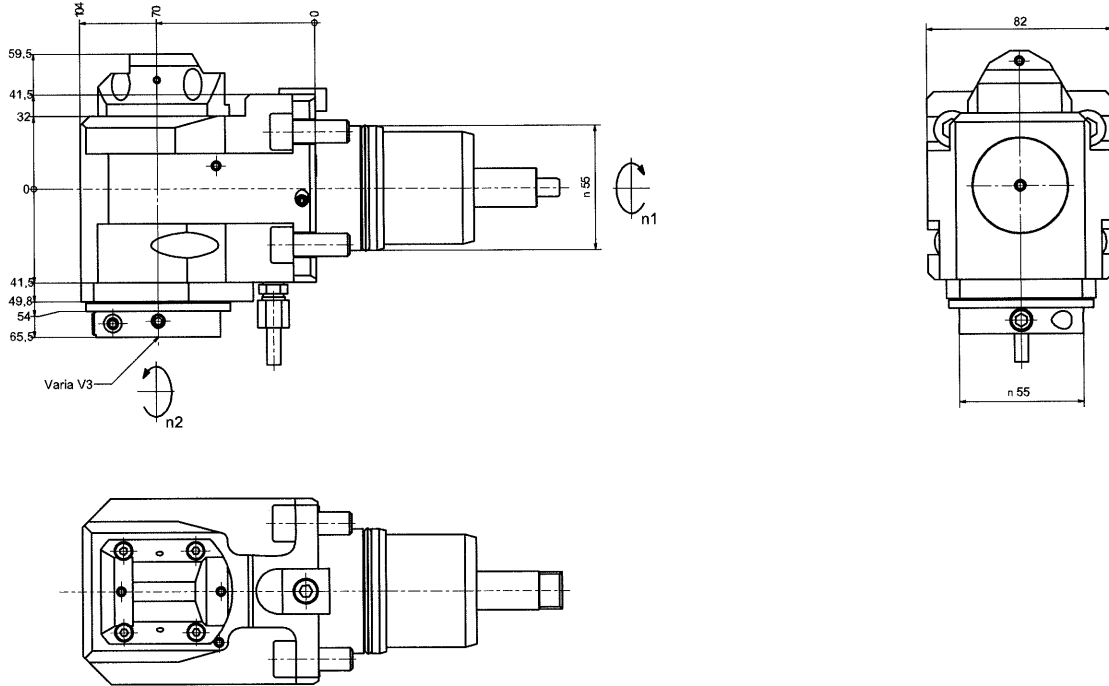

Part No.

60.55V3TW10-IK

Subject to technical modifications

Coolant	i	M1	M2	n1	n2	Tooling System
Ext.	1:1	25 Nm	25 Nm	6000 1/min	6000 1/min	Varia - V3

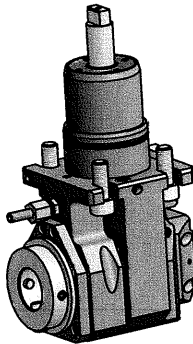

ITI TOOLING COMPANY

A Division of **INDEXING TECHNOLOGIES INC.**

37 Orchard Street., Ramsey, NJ. 07446 - Phone (201) 934-6333 - Fax (201) 934-6333 www.indexingtechnologies.com
www.ititooling.com

ITI - Radial (90°) Drilling and Milling Head

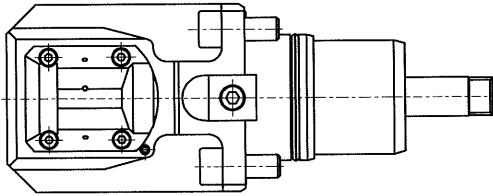
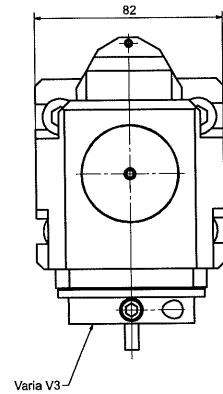
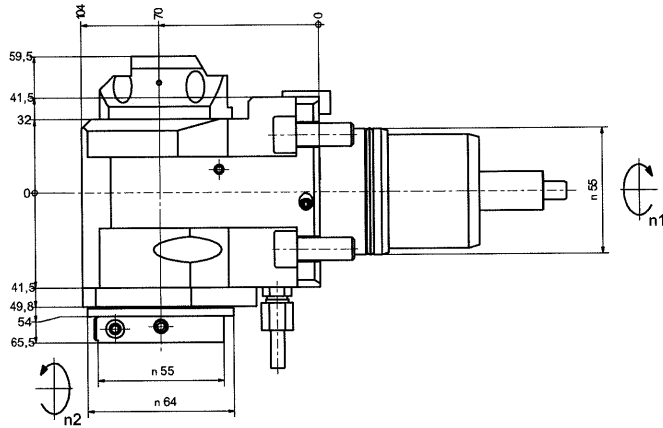

Part No.
60.55V3TW10-IKi1

Subject to technical modifications

Coolant	i	M1	M2	n1	n2	Tooling System
Int. / Ext.	1:1	24 Nm	12 Nm	6000 1/min	12000 1/min	Varia - V3

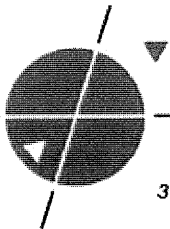
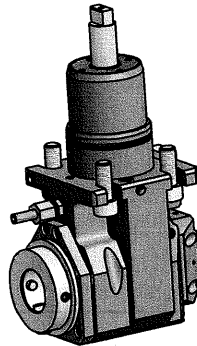

ITI TOOLING COMPANY

A Division of **INDEXING TECHNOLOGIES INC.**

37 Orchard Street., Ramsey, NJ. 07446 - Phone (201) 934-6333 - Fax (201) 934-6333 www.indexingtechnologies.com
www.ititooling.com

ITI - Axial (straight) Drilling and Milling Head

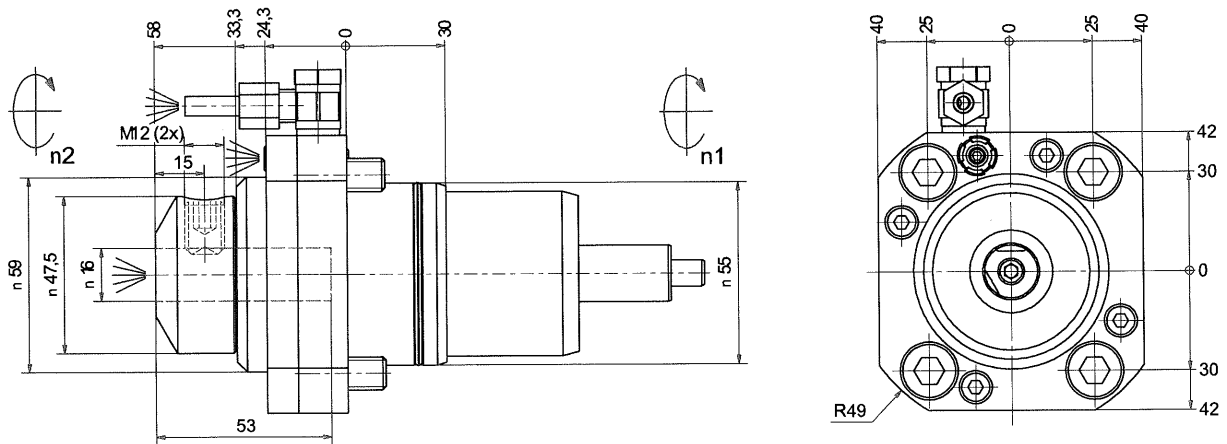

Part No.
40.5516WNKRTW10-IK

Subject to technical modifications

Coolant	i	M1	M2	n1	n2	Tooling System
Int. / Ext.	1:1	25 Nm	25 Nm	6000 1/min	6000 1/min	Whistle Notch

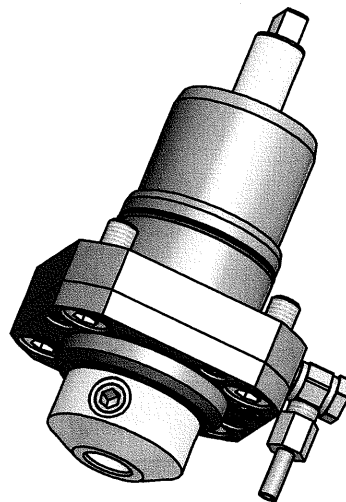

ITI TOOLING COMPANY

A Division of **INDEXING TECHNOLOGIES INC.**

37 Orchard Street., Ramsey, NJ. 07446 - Phone (201) 934-6333 - Fax (201) 934-6333 www.indexingtechnologies.com
www.ititooling.com

ITI - Axial (straight) Drilling and Milling Head

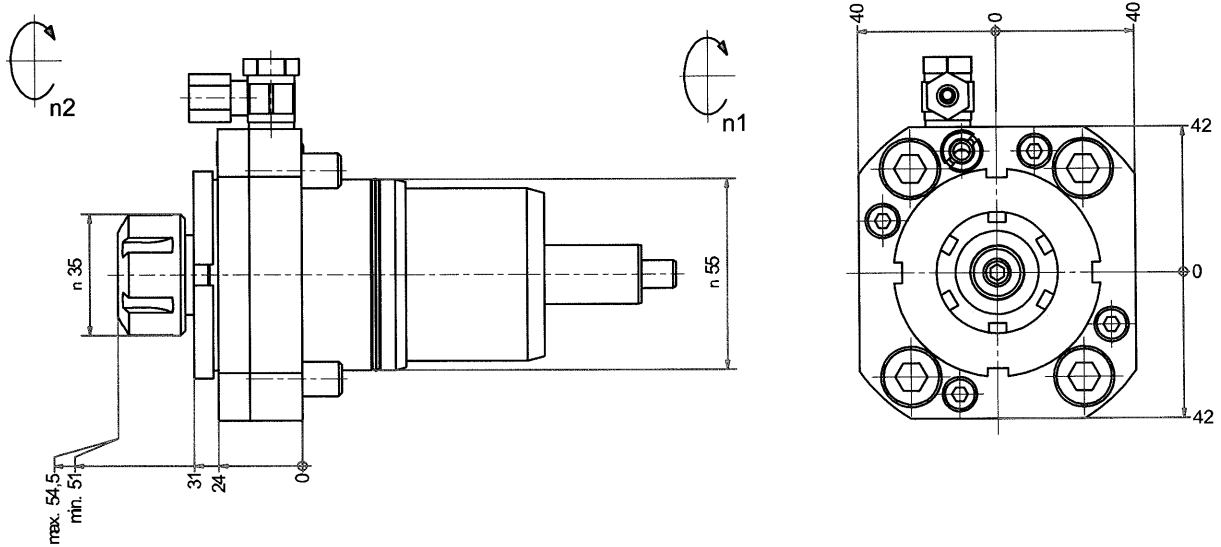

Part No.
40.5520TW10

Subject to technical modifications

Coolant	i	M1	M2	n1	n2	Collet	Clamping Range	Tapping Collet
Ext.	1:1	25 Nm	25 Nm	6000 1/min	6000 1/min	ER20	1.0-13.0	ET 1-20 M2-M6

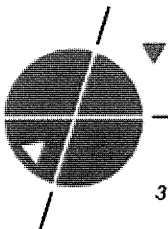
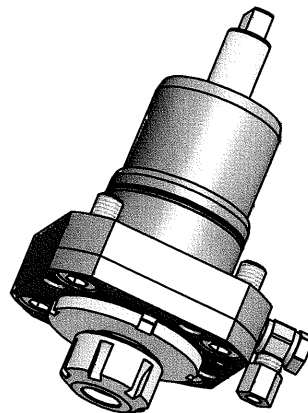

ITI TOOLING COMPANY

A Division of **INDEXING TECHNOLOGIES INC.**

37 Orchard Street., Ramsey, NJ, 07446 - Phone (201) 934-6333 - Fax (201) 934-6333 www.indexingtechnologies.com
www.ititooling.com

ITI - Radial (90°) Drilling and Milling Head

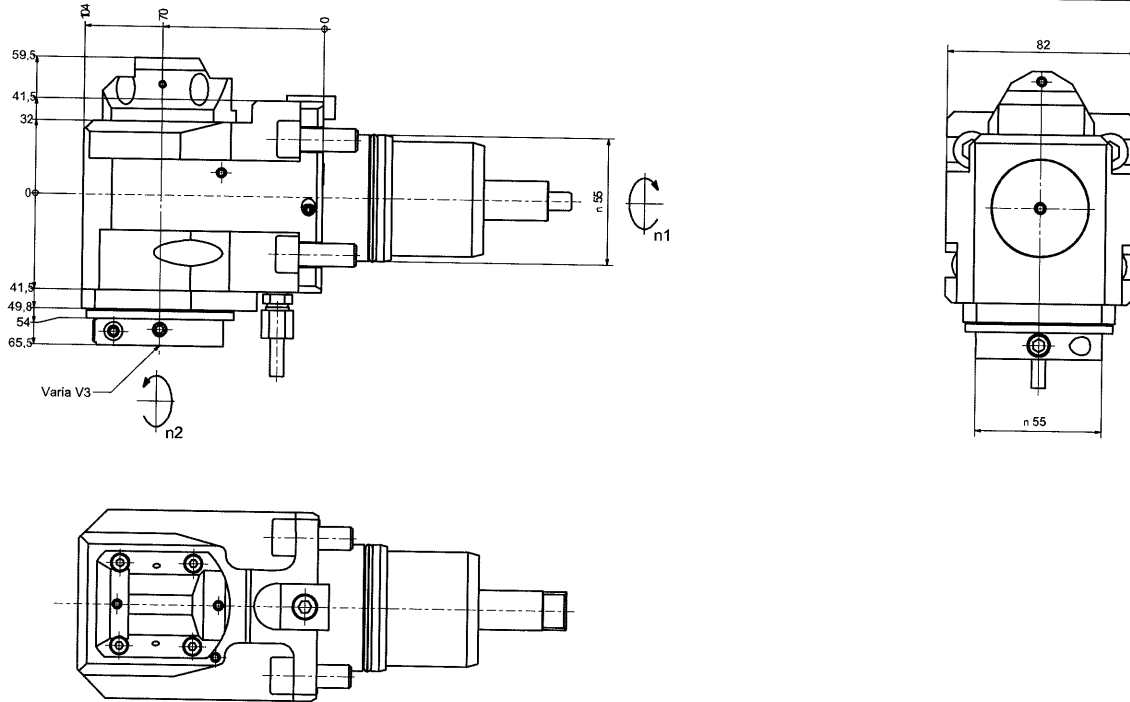

Part No.
60.55V3TW10-IKi2

Subject to technical modifications

Coolant	i	M1	M2	n1	n2	Tooling System
Int. / Ext.	2:1	25 Nm	50 Nm	6000 1/min	3000 1/min	Varia - V3

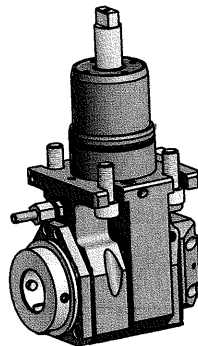

ITI TOOLING COMPANY

A Division of **INDEXING TECHNOLOGIES INC.**

37 Orchard Street., Ramsey, NJ. 07446 - Phone (201) 934-6333 - Fax (201) 934-6333 www.indexingtechnologies.com
www.ititooling.com

ITI - Axial (straight) Drilling and Milling Head

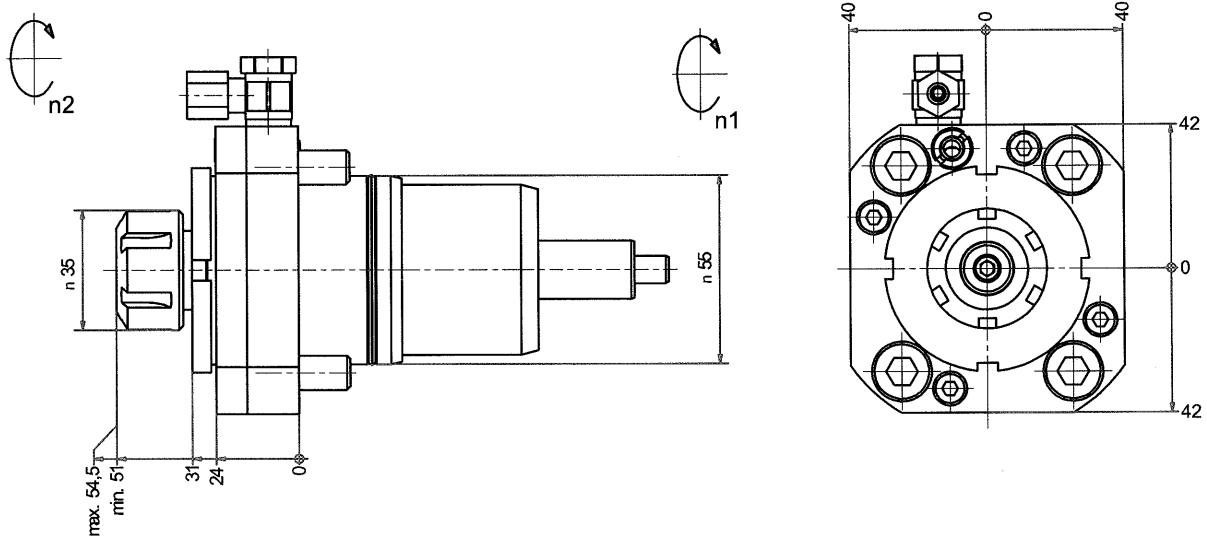

Part No.
40.5520TW10-IK

Subject to technical modifications

Coolant	i	M1	M2	n1	n2	Collet	Clamping Range
Int. / Ext.	1:1	25 Nm	25 Nm	6000 1/min	6000 1/min	ER20	1.0-13.0

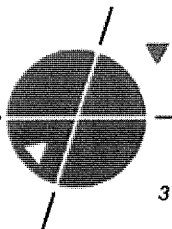
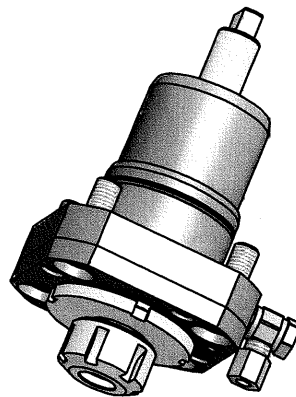

ITI TOOLING COMPANY

A Division of **INDEXING TECHNOLOGIES INC.**

37 Orchard Street., Ramsey, NJ, 07446 - Phone (201) 934-6333 - Fax (201) 934-6333 www.indexingtechnologies.com
www.ititooling.com

ITI - Axial (straight) Drilling and Milling Head

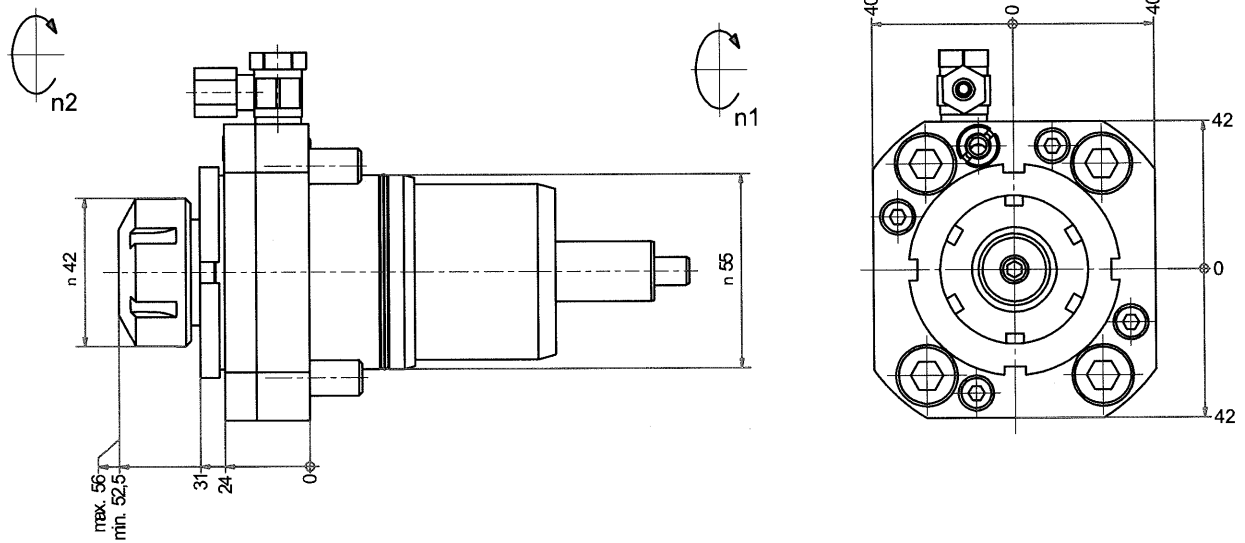

Part No.
40.5525TW10

Subject to technical modifications

Coolant	i	M1	M2	n1	n2	Collet	Clamping Range	Tapping Collet
Ext.	1:1	25 Nm	25 Nm	6000 1/min	6000 1/min	ER25	1.0-16.0	ET 1-25 M3-M10

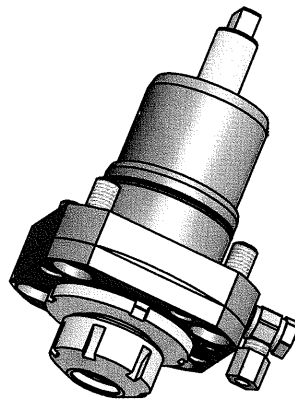

ITI TOOLING COMPANY

A Division of **INDEXING TECHNOLOGIES INC.**

37 Orchard Street., Ramsey, NJ. 07446 - Phone (201) 934-6333 - Fax (201) 934-6333 www.indexingtechnologies.com
www.ititooling.com

ITI - Radial (90°) Drilling and Milling Head

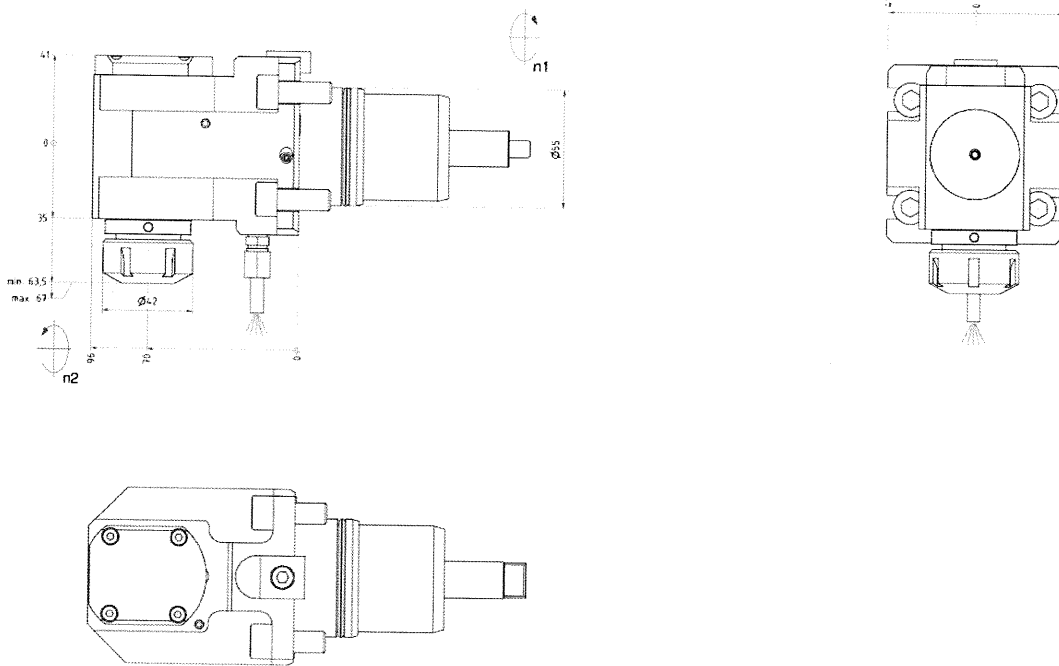

Part No.
60.5525 TW10

Subject to technical modifications

Coolant	i	M1	M2	n1	n2	Collet	Clamping Range	Tapping Collet
Ext.	1:1	25 Nm	25 Nm	6000 1/min	6000 1/min	ER25	1.0-16.0	ET 1-25 M3-M10

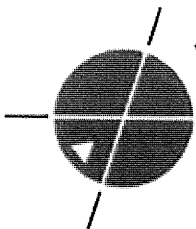
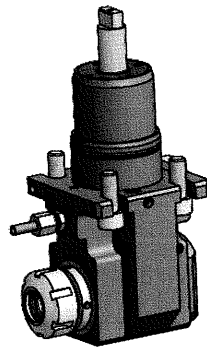

ITI TOOLING COMPANY

A Division of **INDEXING TECHNOLOGIES INC.**

37 Orchard Street., Ramsey, NJ. 07446 - Phone (201) 934-6333 - Fax (201) 934-6333 www.indexingtechnologies.com
www.ititooling.com

ITI - Radial (90°) Drilling and Milling Head

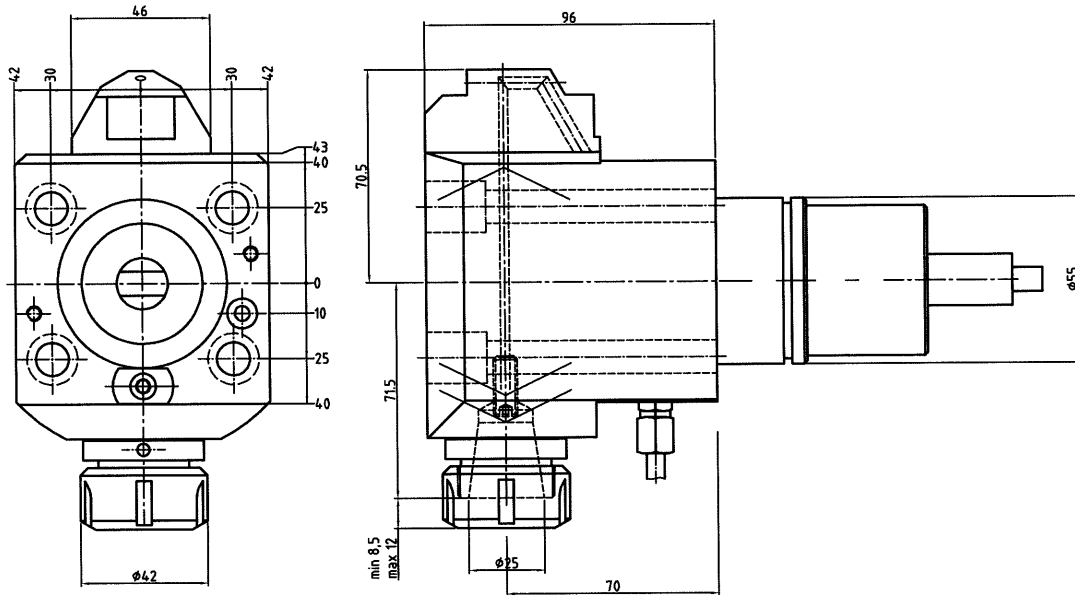

Part No.
60.5525STW10-IK

Subject to technical modifications

Coolant	i	M1	M2	n1	n2	Collet	Clamping Range
Int. / Ext.	1:1	25 Nm	25 Nm	6000 1/min	6000 1/min	ER25	1.0-16.0

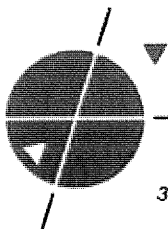

ITI TOOLING COMPANY

A Division of **INDEXING TECHNOLOGIES INC.**

37 Orchard Street., Ramsey, NJ. 07446 - Phone (201) 934-6333 - Fax (201) 934-6333 www.indexingtechnologies.com
www.ititooling.com

ITI - Axial (straight) Drilling and Milling Head

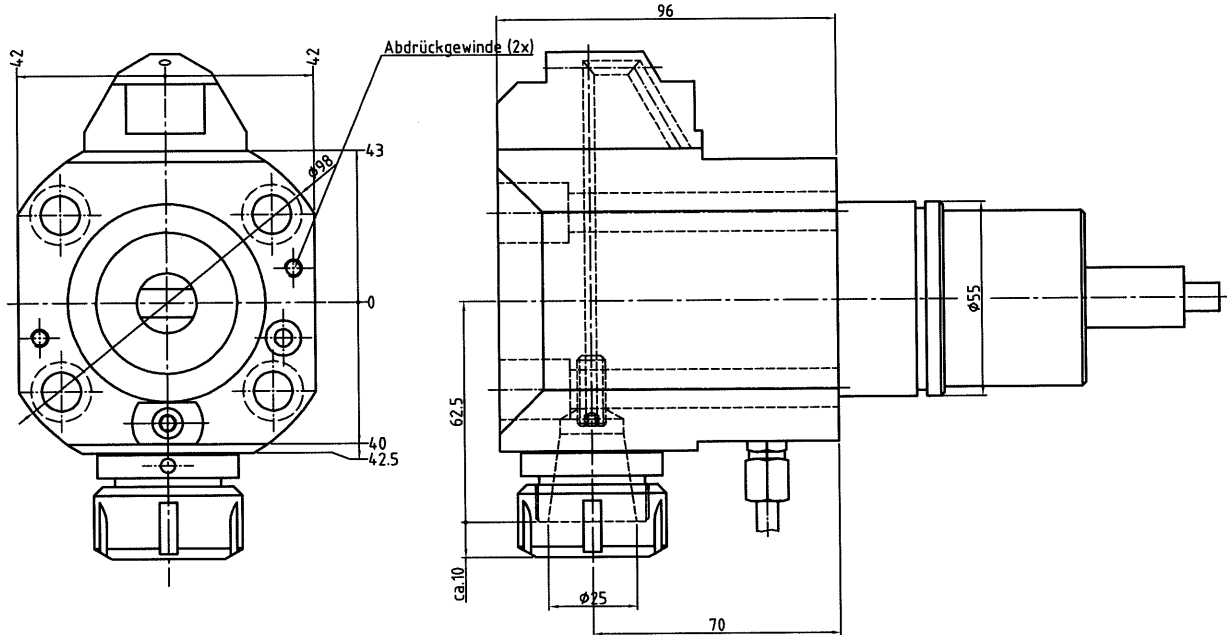

Part No.
60.5525TW10-IK

Subject to technical modifications

Coolant	i	M1	M2	n1	n2	Collet	Clamping Range
Int. / Ext.	1:1	25 Nm	25 Nm	6000 1/min	6000 1/min	ER25	1.0-16.0



ITI TOOLING COMPANY

A Division of **INDEXING TECHNOLOGIES INC.**

37 Orchard Street., Ramsey, NJ. 07446 - Phone (201) 934-6333 - Fax (201) 934-6333 www.indexingtechnologies.com
 www.ititooling.com

ITI - Swivel Head

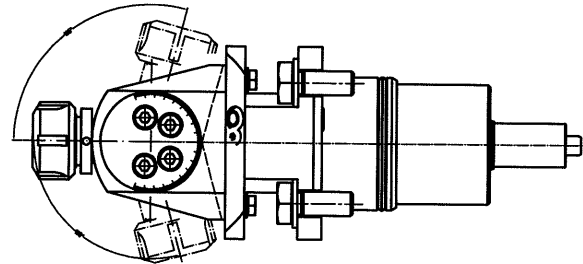
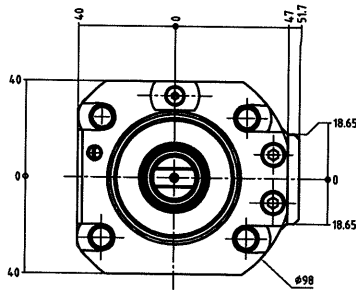

Direction of rotation: Non-drive output

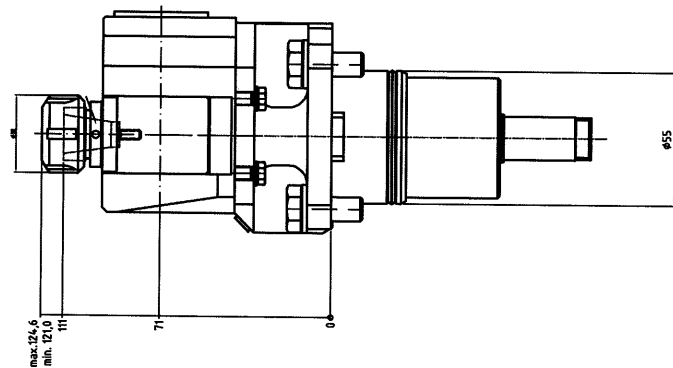

Part No.
63.5516LTW10i1

Subject to technical modifications

Coolant	i	M1	M2	n1	n2	Collet	Clamping Range
Ext.	1:2	16 Nm	16 Nm	8000 1/min	8000 1/min	ER16	0.5-10.0

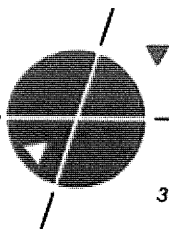

ITI TOOLING COMPANY

A Division of **INDEXING TECHNOLOGIES INC.**

37 Orchard Street., Ramsey, NJ. 07446 - Phone (201) 934-6333 - Fax (201) 934-6333 www.indexingtechnologies.com
www.ititooling.com

ITI - Swivel Head

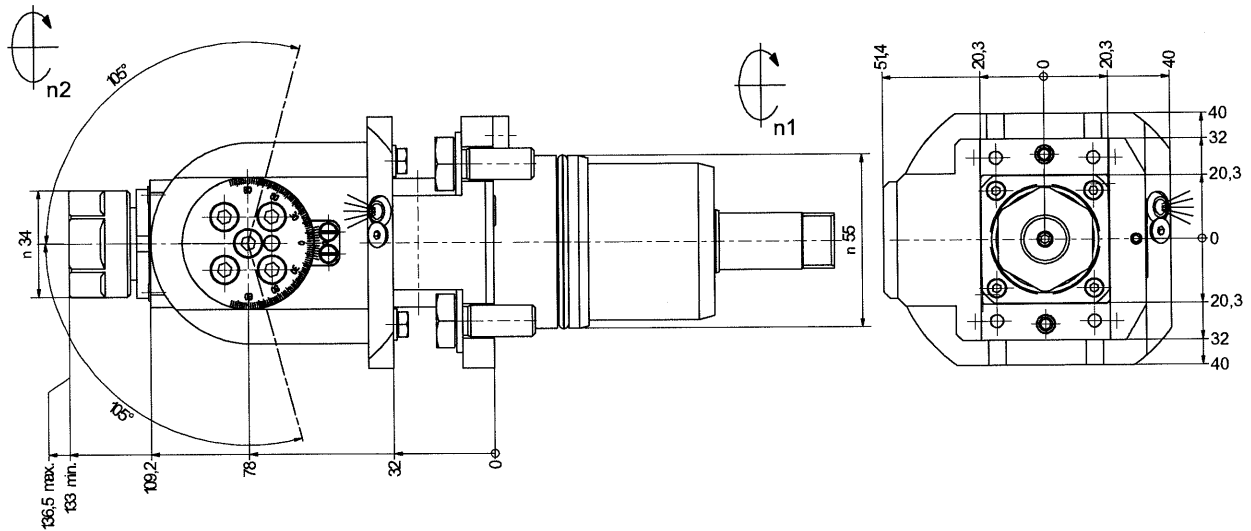

Part No.
63.5520TW10

Subject to technical modifications

Coolant	i	M1	M2	n1	n2	Collet	Clamping Range	Tapping Collet
Ext.	1:1	16 Nm	16 Nm	6000 1/min	6000 1/min	ER20	1.0-13.0	ET 1-20 M2-M6

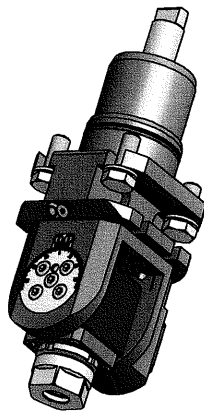

ITI TOOLING COMPANY

A Division of **INDEXING TECHNOLOGIES INC.**

37 Orchard Street., Ramsey, NJ. 07446 - Phone (201) 934-6333 - Fax (201) 934-6333 www.indexingtechnologies.com
www.ititooling.com

ITI QC VARIA® *Universal Modular Tool Holding System*



GIVE US YOUR CNC LATHE AND JUST 7 SECONDS TO PROVE A POINT ...

Because with just one single-point clamp in the patented ITI QC-Varia tool holding system, all it takes is about 7 seconds to exchange tools on most CNC lathes.

A simple half turn to the left releases used tools, a half turn to the right secures new ones.

And on many lathes, when the tool spindle stops, a spring-loaded detent automatically orients the clamp screw towards the operator. There's no wasted time searching for the clamp and, more importantly, no need to grab sharp or broken tools to rotate the spindle manually.



There's more. Varia's compact design provides a greater working envelope than other modular systems. And with dedication to engineering excellence, you're assured years of trouble-free performance.



ITI TOOLING COMPANY INC.

*Your Single Source for High-Quality
CNC Lathe Tool Holders and Spindle Units*

www.ititooling.com

HUNTER DOVER • HITACHI SEIKI
 DMN TURN • BARUFFALDI •
 HURCO • PROFBA • BENZINGER
 SCHWABEON • REPUBBLICA CUN
 SIERINGER • HYUNDAI KIA
 FOMI • BIRSA • IREGAI •
 ANDRÉSTA • CINCINNATI •
 IDEY • DAI • CITIZEN • JINN
 FZ • TENNWA • CLAUSING
 HIRAI • TONGIL •
 SAIMCO • JAMES LAMSON •
 JINHO • JUSKAI • KIA •
 JORDAN • DEXTER INTERCORE
 KINGSBURY • TRUB •
 KNOX • LEWELL • TSUGAMI
 EMCO MARR • LODGE &
 SHIPLEY • VICTOR • ESCO •
 KINGSTON • MATR • SOUTH
 BEND • WASING • EUROTECH
 MAZAK • WELER • FARMAR
 MIGHTY SPINNER • FAMEI
 MILTECNICS • FORTUNE •
 MIYAN • GGS & C
 M • DEMEL
 M • TRAT
 M • TRAT
 NAKAMURA • MAZAK •
 ORTAIN • HANONET • ORIMA
 BARBONS & OLIVER • HITACHI
 SEIKI • HURCO • PROENA
 • BENZINGER • CLAUSING
 JOHN FORD • TONGIL •



ITI TOOLING COMPANY INC.

*Your Single Source For Top Quality Tool Holders
 And Spindle Units For Most CNC Lathes.*

1-888-88-INDEX