

# MINITURN™

TURNING PRODUCTS

# AHB

TOOLING & MACHINERY

COMPLETE METALWORKING SOLUTIONS

(800) 991-4225

[www.ahbinc.com](http://www.ahbinc.com)

ISO Certified

[customerservice@ahbinc.com](mailto:customerservice@ahbinc.com)



## Series

- TMY

## Holder Styles

- Y-Axis Square Shank Holder
- With or without thru coolant
- All holders are right hand

## Square Shank Size

- 12mm
- 16mm

## Insert Options

- DC...T32.5...
- VB...T22...

## Series TMY

### Y-Axis Holders for Swiss Automatic Machines

New MINI-TURN Y-Axis holders are designed to be mounted on the tool post so the upper side of the insert faces downwards for more effective chip evacuation. The chips naturally fall downward, avoiding interference during machining. They are ideal for stringy materials such as aluminum, low carbon steel and stainless steel.

Y-Axis holders are very rigid since they are mounted in the same direction of the workpiece's rotation, resulting in higher precision and more stable machining.

Standard Y-Axis holders are right-handed, metric-based, accommodate DCMT and VBMT inserts and are available with the thru-coolant CoolBurst technology.



**MINITURN™** TMY Y-AXIS HOLDER FOR EXTERNAL TURNING

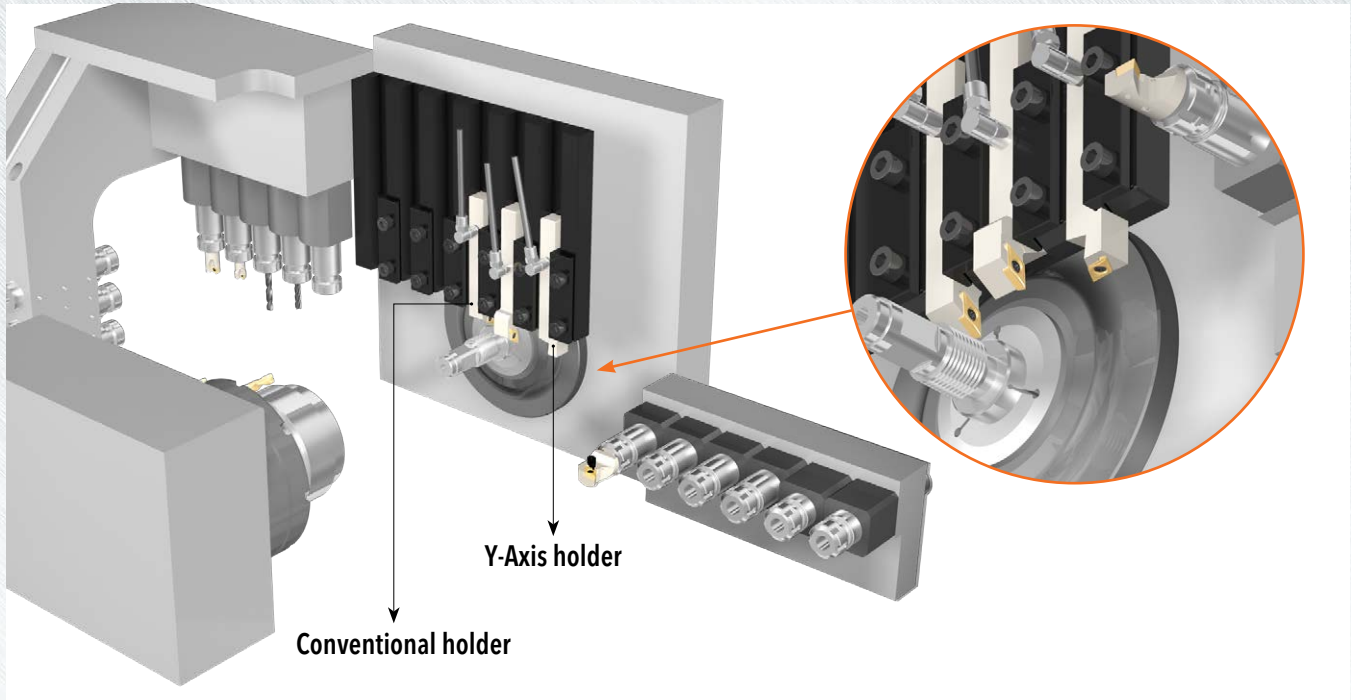

- Smooth chip evacuation as chips fall downward during machining
- Improved holder rigidity for better dimensional accuracy and stable machining
- Ideal for stringy materials such as aluminum, low carbon steel and stainless steel
- Increases tool life and improves chip control when used with **COOLBURST™** 

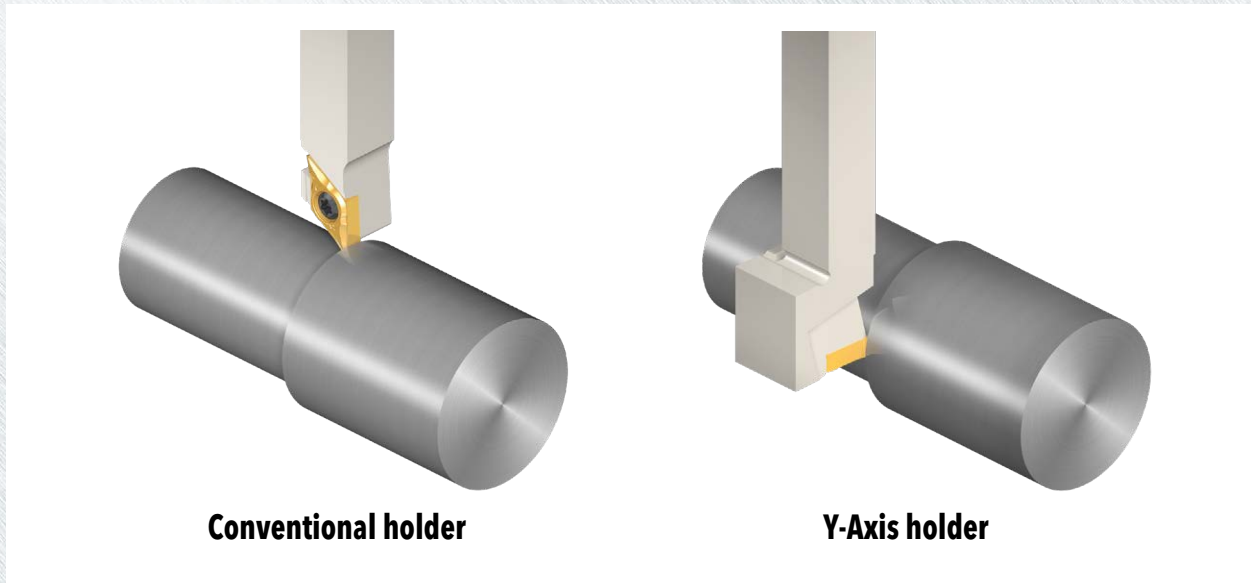



**MINITURN™ TMY-SDJCR Y-AXIS HOLDER FOR EXTERNAL TURNING (DC\_T32.5\_)**

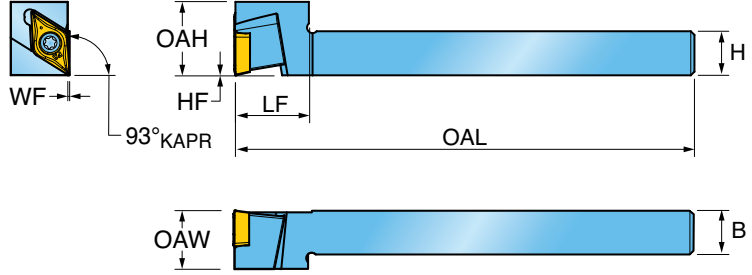

**METRIC**

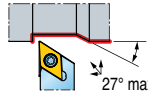
Approach angle	Part Number	Dimension (mm)								Insert
		H Shank Height	HF Functional Height	B Shank Width	LF Functional Length	OAL Overall Length	OAH Overall Height	OAW Overall Width	WF Functional Width	
93° 	TMY-SDJCR 1212 K11	12	0	12	21	125	20	16	0	DC...T32.5... (11T3...)
	TMY-SDJCR 1616 K11	16	0	16	21	125	20	16	0	

**Spare Parts**

Part Number	Screw	Wrench	
TMY-SDJCR	 SO 350801	 T15	



**MINITURN™ TMY-SDJCR-TB Y-AXIS HOLDER FOR EXTERNAL TURNING (DC\_T32.5\_)**

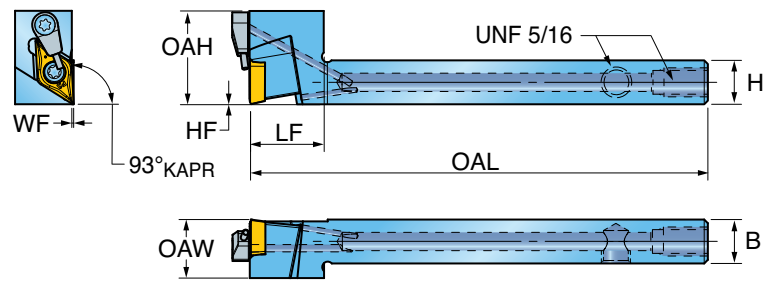

**METRIC**

Approach angle	Part Number	Dimension (mm)								Insert
		H Shank Height	HF Functional Height	B Shank Width	LF Functional Length	OAL Overall Length	OAH Overall Height	OAW Overall Width	WF Functional Width	
93° 	TMY-SDJCR 1212 K11-TB	12	0	12	21	125	25.5	16	0	DC...T32.5... (11T3...)
	TMY-SDJCR 1616 K11-TB	16	0	16	21	125	25.5	16	0	

**Spare Parts**

Part Number	Screw	Oil Supply Unit	Plug	Wrench	
TMY-SDJCR-TB	SO 350801	S-CU-TB	PLG 5/16 UNF	T 15	L-W 5/32



**MINITURN™ TMY-SVJBR Y-AXIS HOLDER FOR EXTERNAL TURNING (VB\_T22\_)**

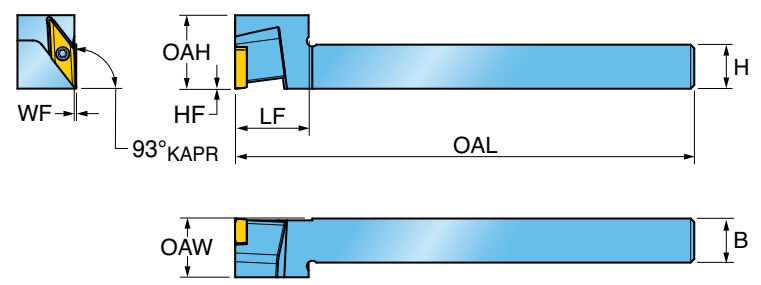

**METRIC**

Approach angle	Part Number	Dimension (mm)								Insert
		H Shank Height	HF Functional Height	B Shank Width	LF Functional Length	OAL Overall Length	OAH Overall Height	OAW Overall Width	WF Functional Width	
93° 	TMY-SVJBR 1212 K11	12	0	12	21	125	20	16	0	VB...T22 (1103...)
	TMY-SVJBR 1616 K11	16	0	16	21	125	20	16	0	

**Spare Parts**

Part Number	Screw	Wrench
TMY-SVJBR	 SO 250651	 T 7(T-7/5)



**MINITURN™ TMY-SVJBR-TB Y-AXIS HOLDER FOR EXTERNAL TURNING (VB\_T22\_)**

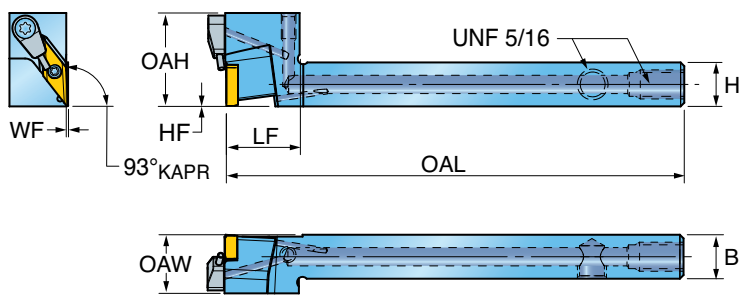

**METRIC**

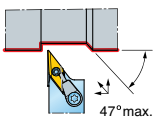
Approach angle	Part Number	Dimension (mm)								Insert
		H Shank Height	HF Functional Height	B Shank Width	LF Functional Length	OAL Overall Length	OAH Overall Height	OAW Overall Width	WF Functional Width	
<p>93°</p> 	TMY-SVJBR 1212 K11-TB	12	0	12	21	125	25.5	16	0	VB...T22 (1103...)
	TMY-SVJBR 1616 K11-TB	16	0	16	21	125	25.5	16	0	

**Spare Parts**

Part Number	Screw	Oil Supply Unit	Plug	Wrench	
TMY-SVJBR-TB	SO 25065I	S-CU-TB	PLG 5/16 UNF	T 7(T-7/5)	L-W 5/32



**MINITURN™ TMY-SVJCR-TB Y-AXIS HOLDER FOR EXTERNAL TURNING (VC\_T22\_)**

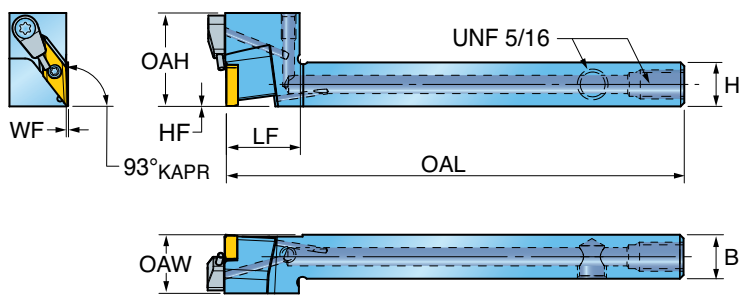

**METRIC**

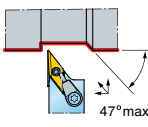
Approach angle	Part Number	Dimension (mm)								Insert
		H Shank Height	HF Functional Height	B Shank Width	LF Functional Length	OAL Overall Length	OAH Overall Height	OAW Overall Width	WF Functional Width	
<p>93°</p> 	TMY-SVJCR 1212 K11-TB	12	0	12	21	125	25.5	16	0	VC...T22 (1103...)
	TMY-SVJCR 1616 K11-TB	16	0	16	21	125	25.5	16	0	



**COMPLETE  
METALWORKING  
SOLUTIONS**

(800) 991-4225  
www.ahbinc.com  
ISO Certified  
customerservice@ahbinc.com

**Spare Parts**

Part Number	Screw	Oil Supply Unit	Plug	Wrench	
TMY-SVJCR-TB	SO 250651	S-CU-TB	PLG 5/16 UNF	T 7(T-7/5)	L-W 5/32