

Never slip a tool again!

What is ShrinkLOCKED?

ShrinkLOCKED is a revolutionary advancement in the holding power of shrink-fit tool holders that eliminates tool slippage.



Works on all standard shank tooling
NO SHANK MODIFICATIONS NECESSARY!

How does ShrinkLOCKED work?

Patented TTG-594 compound is embedded in the I.D. bore of the holder, creating millions of microscopic teeth adding bite to the cutting tool/tool holder connection.

Grip force so strong that 3/4" carbide test rods break before spinning!

Unleash the full power of your CNC machine and cutting tool with the strongest shrink-fit connection!



TTG-594 compound



Parlec is a proud member of Techniks Tool Group.

CNC TOOLING SOLUTIONS
FROM SPINDLE TO WORKPIECE

Connect with Techniks Tool Group





YOU'RE **UPGRADED!**

Now through the end of the year, Parlec is upgrading all 1/2" and larger shrink fit holders to **ShrinkLOCKED** at no additional charge!

Why **ShrinkLOCKED?**

- Traditional shrink-fit gripping power is highly dependent on the cutting tool's shank tolerance
- During aggressive machining, the forces on the cutting tool can over-power the gripping power of traditional shrink-fit causing the tool to slip or pullout of the holder
- Until recently, the only alternative to eliminate the risk of tool slippage was to buy expensive cutting tools with a modified shank and expensive shrink-fit holders designed to accept the modified shank

The **ShrinkLOCKED** difference!

- **ShrinkLOCKED** eliminates the risk of tool slippage by adding additional "bite" to the cutting tool connection
- No modification to the tool shank required!
- Enjoy the peace of mind knowing your tool will never slip!
- Still holds our industry-leading tolerances for accuracy (<.0001") and balance (25,000 RPM @ G 2.5)

Start enjoying the benefits of **ShrinkLOCKED** today!



Parlec is a proud member of Techniks Tool Group.

CNC TOOLING SOLUTIONS
FROM SPINDLE TO WORKPIECE

Connect with Techniks Tool Group



ShrinkFit Holders

Extreme Precision Shrinkfit Tools

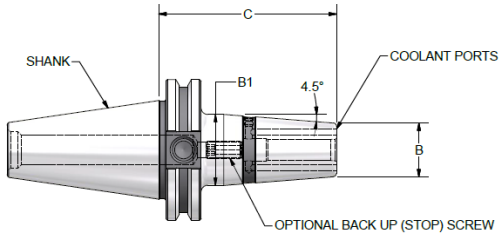

Style 1

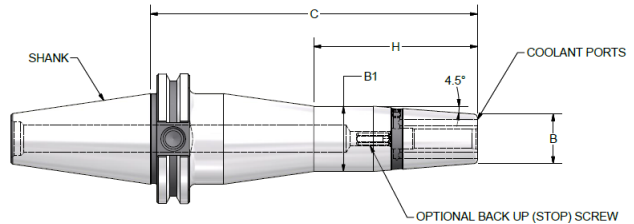

Style 2

CAT 40

ITEM NUMBER	Size	C	B	B1	H	THREAD	Style
C40A-01SF315-9	1/8"	3.15"	.39"	.62"	3.15"	-	3*
C40A-18SF315-9	3/16"	3.15"	.39"	.72"	3.15"	-	3*
C40A-25SF315-9C	1/4"	3.15"	.83"	1.06"	3.15"	M5X.8	1
C40A-25SF512-9C	1/4"	5.12"	.83"	1.06"	3.15"	M5X.9	1
C40A-25SF630-9C	1/4"	6.30"	.83"	1.06"	3.15"	M5X.10	2
C40A-31SF315-9C	5/16"	3.15"	.83"	1.06"	3.15"	M6X1	1
C40A-38SF315-9C	3/8"	3.15"	.94"	1.26"	3.15"	M8X1	1
C40A-38SF512-9C	3/8"	5.12"	.94"	1.26"	3.15"	M8X1	1
C40A-38SF630-9C	3/8"	6.30"	.94"	1.26"	3.15"	M8X1	2
C40A-50SF315-9C	1/2"	3.15"	.94"	1.26"	3.15"	M10X1	1
C40A-50SF512-9C	1/2"	5.12"	.94"	1.26"	3.15"	M10X1	1
C40A-50SF630-9C	1/2"	6.30"	.94"	1.26"	3.15"	M10X1	2
C40A-62SF315-9C	5/8"	3.15"	1.06"	1.34"	3.15"	M12X1	1
C40A-62SF512-9C	5/8"	5.12"	1.06"	1.34"	3.15"	M12X1	1
C40A-62SF630-9C	5/8"	6.30"	1.06"	1.34"	3.15"	M12X1	2
C40A-75SF315-9C	3/4"	3.15"	1.30"	1.65"	3.15"	M16X1	1
C40A-75SF512-9C	3/4"	5.12"	1.30"	1.65"	3.15"	M16X1	1
C40A-75SF630-9C	3/4"	6.30"	1.30"	1.65"	3.15"	M16X1	2
C40A-10SF394-9C	1"	3.94"	1.73"	2.09"	3.15"	M16X1	1
C40A-10SF512-9C	1"	5.12"	1.73"	2.09"	3.15"	M16X1	1
C40A-10SF630-9C	1"	6.30"	1.73"	2.09"	3.15"	M16X1	2
C40A-12SF394-9C	1 1/4"	3.94"	1.73"	2.09"	3.15"	M16X1	1



Blue highlighted = ShrinkLOCKED

*Style 3
No Coolant Ports

ShrinkFit Holders

Extreme Precision Shrinkfit Tools

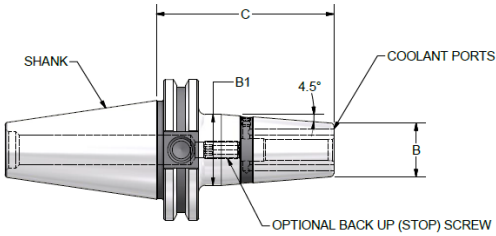

Style 1

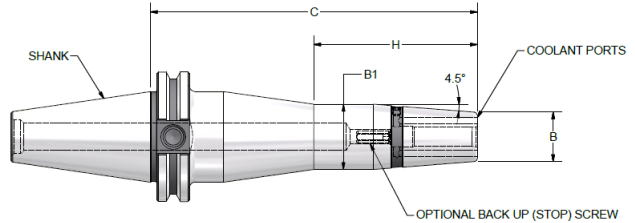

Style 2

CAT 50

ITEM NUMBER	Size	C	B	B1	H	THREAD	Style
C50A-25SF315-9C	1/8"	3.15"	.83"	1.06"	3.15"	M5X.8	1
C50A-25SF512-9C	3/16"	5.12"	.83"	1.06"	3.15"	M5X.8	1
C50A-25SF630-9C	1/4"	6.30"	.83"	1.06"	3.15"	M5X.8	2
C50A-31SF315-9C	1/4"	3.15"	.83"	1.06"	3.15"	M6X1	1
C50A-31SF512-9C	1/4"	5.12"	.83"	1.06"	3.15"	M6X1	1
C50A-31SF630-9C	5/16"	6.30"	.83"	1.06"	3.15"	M6X1	2
C50A-38SF315-9C	3/8"	3.15"	.94"	1.26"	3.15"	M8X1	1
C50A-38SF512-9C	3/8"	5.12"	.94"	1.26"	3.15"	M8X1	1
C50A-38SF630-9C	3/8"	6.30"	.94"	1.26"	3.15"	M8X1	2
C50A-50SF315-9C	1/2"	3.15"	.94"	1.26"	3.15"	M10X1	1
C50A-50SF512-9C	1/2"	5.12"	.94"	1.26"	3.15"	M10X1	1
C50A-50SF630-9C	1/2"	6.30"	.94"	1.26"	3.15"	M10X1	2
C50A-62SF315-9C	5/8"	3.15"	1.06"	1.34"	3.15"	M12X1	1
C50A-62SF512-9C	5/8"	5.12"	1.06"	1.34"	3.15"	M12X1	1
C50A-62SF630-9C	5/8"	6.30"	1.06"	1.34"	3.15"	M12X1	2
C50A-75SF315-9C	3/4"	3.15"	1.30"	1.65"	3.15"	M16X1	1
C50A-75SF512-9C	3/4"	5.12"	1.30"	1.65"	3.15"	M16X1	1
C50A-75SF630-9C	3/4"	6.30"	1.30"	1.65"	3.15"	M16X1	2
C50A-10SF394-9C	1"	3.15"	1.73"	2.09"	3.15"	M16X1	1
C50A-10SF512-9C	1"	5.12"	1.73"	2.09"	3.15"	M16X1	1
C50A-10SF630-9C	1"	6.30"	1.73"	2.09"	3.15"	M16X1	2
C50A-12SF394-9C	1 1/4"	3.15"	1.73"	2.09"	3.15"	M16X1	1
C50A-12SF512-9C	1 1/4"	5.12"	1.73"	2.09"	3.15"	M16X1	1
C50A-12SF630-9C	1 1/4"	6.30"	1.73"	2.09"	3.15"	M16X1	2



Blue highlighted = ShrinkLOCKED



Parlec is a proud member of Techniks Tool Group.

CNC TOOLING SOLUTIONS
FROM SPINDLE TO WORKPIECE

Connect with Techniks Tool Group





ShrinkFit Holders

Extreme Precision Shrinkfit Tools

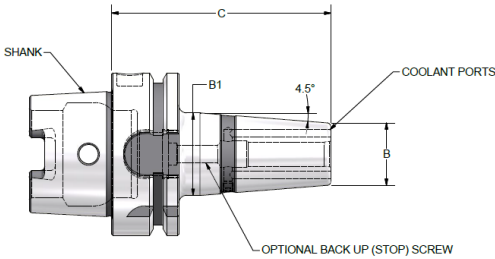

Style 1

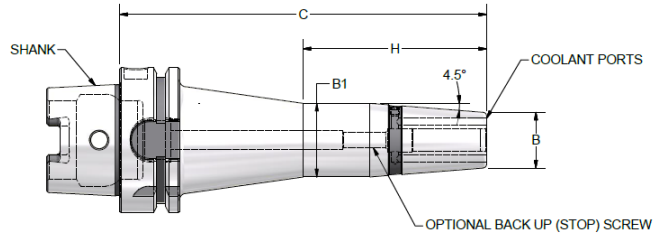

Style 2

HSK 63A - INCH

ITEM NUMBER	Size	C	B	B1	H	THREAD	Style
H63A-01SF315-9	1/8"	3.15"	.62"	.62"	3.15"		3*
H63A-18SF315-9	3/16"	3.15"	.72"	.72"	3.15"		3*
H63A-25SF315-9C	1/4"	3.15"	.83"	1.06"	3.15"	M5X.8	1
H63A-25SF512-9C	1/4"	5.12"	.83"	1.06"	3.15"	M5X.8	1
H63A-25SF630-9C	1/4"	6.30"	.83"	1.06"	3.15"	M5X.8	2
H63A-31SF315-9C	5/16"	3.15"	.83"	1.06"	3.15"	M6X1	1
H63A-31SF512-9C	5/16"	5.12"	.83"	1.06"	3.15"	M6X1	1
H63A-31SF630-9C	5/16"	6.30"	.83"	1.06"	3.15"	M6X1	1
H63A-38SF335-9C	3/8"	3.54"	.94"	1.26"	3.15"	M8X1	1
H63A-38SF512-9C	3/8"	5.12"	.94"	1.26"	3.15"	M8X1	1
H63A-38SF630-9C	3/8"	6.30"	.94"	1.26"	3.15"	M8X1	2
H63A-50SF354-9C	1/2"	3.54"	.94"	1.26"	3.15"	M10X1	1
H63A-50SF512-9C	1/2"	5.12"	.94"	1.26"	3.15"	M10X1	1
H63A-50SF630-9C	1/2"	6.30"	.94"	1.26"	3.15"	M10X1	2
H63A-62SF374-9C	5/8"	3.74"	1.06"	1.34"	3.15"	M12x1	1
H63A-62SF512-9C	5/8"	5.12"	1.06"	1.34"	3.15"	M12x1	1
H63A-62SF630-9C	5/8"	6.30"	1.06"	1.34"	3.15"	M12x1	2
H63A-75SF394-9C	3/4"	3.94"	1.30"	1.65"	3.15"	M16x1	1
H63A-75SF512-9C	3/4"	5.12"	1.30"	1.65"	3.15"	M16x1	1
H63A-75SF630-9C	3/4"	6.30"	1.30"	1.65"	3.15"	M16x1	2
H63A-10SF453-9C	1"	4.53"	1.73"	2.09"	3.15"	M16x1	1
H63A-10SF630-9C	1"	5.12"	1.73"	2.09"	3.15"	M16x1	1
H63A-12SF472-9C	1 1/4"	4.72"	1.73"	2.09"	3.15"	M16x1	1
H63A-12SF630-9C	1 1/4"	6.30"	1.73"	2.09"	3.15"	M16x1	1



Blue highlighted = ShrinkLOCKED

*Style 3

No Coolant Ports

Parlec is a proud member of Techniks Tool Group.

CNC TOOLING SOLUTIONS
FROM SPINDLE TO WORKPIECE

Connect with Techniks Tool Group





ShrinkFit Holders

Extreme Precision Shrinkfit Tools

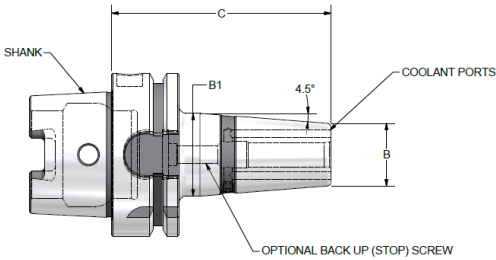

Style 1

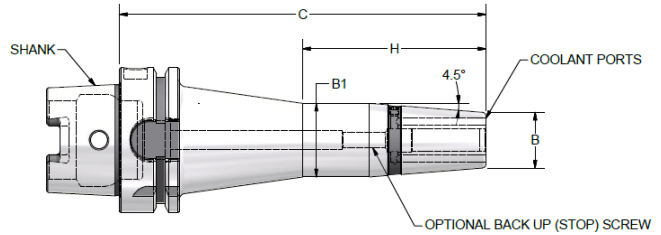

Style 2

HSK 63A - METRIC

ITEM NUMBER	Size	C	B	B1	H	THREAD	Style
H63A-M04SF80-9	4 MM	3.15"	.39"				3*
H63A-M06SF80-9C	6 MM	3.15"	.83"	1.06"	3.15"	M5X.8	1
H63A-M06SF130-9C	6MM	5.12"	.83"	1.06"	3.15"	M5X.8	1
H63A-M06SF160-9C	6 MM	6.30"	.83"	1.06"	3.15"	M5X.8	2
H63A-M08SF80-9C	8 MM	3.15"	.83"	1.06"	3.15"	M6X1	1
H63A-M08SF130-9C	8 MM	5.12"	.83"	1.06"	3.15"	M6X1	1
H63A-M08SF160-9C	8 MM	6.30"	.83"	1.06"	3.15"	M6X1	2
H63A-M10SF85-9C	10 MM	3.35"	.83"	1.26"	3.15"	M8X1	1
H63A-M10SF130-9C	10 MM	5.12"	.94"	1.26"	3.15"	M8X1	1
H63A-M10SF160-9C	10MM	6.30"	.94"	1.26"	3.15"	M8X1	2
H63A-M12SF90-9C	12 MM	3.54"	.94"	1.26"	3.15"	M10X1	1
H63A-M12SF130-9C	12 MM	5.12"	.94"	1.26"	3.15"	M10X1	1
H63A-M12SF160-9C	12 MM	6.30"	.94"	1.26"	3.15"	M10X1	2
H63A-M16SF95-9C	16 MM	3.74"	1.06"	1.34"	3.15"	M12x1	1
H63A-M16SF130-9C	16 MM	5.12"	1.06"	1.34"	3.15"	M12x1	1
H63A-M16SF160-9C	16 MM	6.30"	1.06"	1.34"	3.15"	M12x1	2
H63A-M20SF100-9C	20 MM	3.94"	1.30"	1.65"	3.15"	M16x1	1
H63A-M20SF130-9C	20 MM	5.12"	1.30"	1.65"	3.15"	M16x1	1
H63A-M20SF160-9C	20 MM	6.30"	1.30"	1.65"	3.15"	M16x1	2
H63A-M25SF115-9C	25 MM	4.53"	1.73"	2.09"	3.15"	M16x1	1
H63A-M25SF130-9C	25MM	5.12"	1.73"	2.09"	3.15"	M16x1	1
H63A-M32SF120-9C	32 MM	4.72"	1.73"	2.09"	3.15"	M16x1	2
H63A-M32SF160-9C	32 MM	6.30"	1.73"	2.09"	3.15"	M16x1	1



Blue highlighted = ShrinkLOCKED

*Style 3

No Coolant Ports



Parlec is a proud member of Techniks Tool Group.

CNC TOOLING SOLUTIONS
FROM SPINDLE TO WORKPIECE

Connect with Techniks Tool Group

