





ER Collets PG Collets Hydraulic Sleeves

2

ER *SYSTEM*

- 2.01 Features and Benefits
- 2.02 Information
- 2.03 Concentricity and Assembly Instructions
- 2.05 ER 8 / ER 8-UP
- 2.06 ER 11 / ER 11-UP
- 2.07 ER 16 / ER 16-UP
- 2.08 ER 20 / ER 20-UP
- 2.09 ER 25 / ER 25-UP
- 2.10 ER 32 / ER 32-UP
- 2.11 ER 40 / ER 40-UP
- 2.13 ER 50 / ER 50-UP
- 2.14 ER 8 – ER 16 Microbore
- 2.15 Metallic Sealed ER Collet Information
- 2.16 ER 16 Metallic Sealed
- 2.17 ER 20 Metallic Sealed
- 2.18 ER 25 Metallic Sealed
- 2.19 ER 32 Metallic Sealed
- 2.20 ER 40 Metallic Sealed

powRgrip *SYSTEM*

- 2.21 Features, Benefits and Information
- 2.23 PG 10 / PG 10-CF / PG 10-MB
- 2.24 PG 15 / PG15-CF
- 2.25 PG 25 / PG25-CF
- 2.26 PG 32 / PG32-CF

Hydraulic Reduction Sleeves HS

- 2.27 Features, Benefits and Information
- 2.30 HS 12 / HS 20 / HS 25 / HS 32



Swiss Precision Tools

ER Collets

Features | Benefits

2



Swiss Quality

Made in Switzerland to ISO 9001/ISO 14001.

1

Marking

Type and size (reduces collet selection errors).

2

Traceability

Lot number is marked on all products for traceability throughout the entire manufacturing process.

3

Original REGO-FIX®

REGO-FIX® is the inventor of the worldwide standardized ER collet system. Our extensive experience results in a well-engineered system. When buying ER collets, please note the REGO-FIX® quality symbol \triangle on the front of the collet.

Wide Clamping Range

The 16-slot design allows a wide clamping range while maintaining best T.I.R.

Broad Range of Products

Sizes from ER 8 up to ER 50 for diameters from 0.0079" (0.2 mm) up to 1.334" (34 mm).

Worldwide Availability

With the global REGO-FIX® distribution network.

Up to 20% more Clamping Length

For small diameters, up to 20% more clamping length than the competition, which results in better run-out.

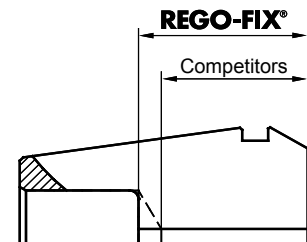

Matched Tooling System

All REGO-FIX® components such as collets, toolholders, clamping nuts and spanners are all manufactured by REGO-FIX®. The compatibility of the whole system results in maximum precision, balance and tool life.

ER Standard Collets

REGO-FIX® collets made to DIN 6499 are used for drilling, milling, reaming, tapping and grinding.

Special Advantages

T.I.R. $\leq 0.0004"$ (10 μm) over the entire clamping range

Clamping range from diameter 0.0079" (0.2 mm) up to 1.334" (34 mm)

Vibration dampening

Combining the smallest design (ER 8) with the highest precision (ER-UP)

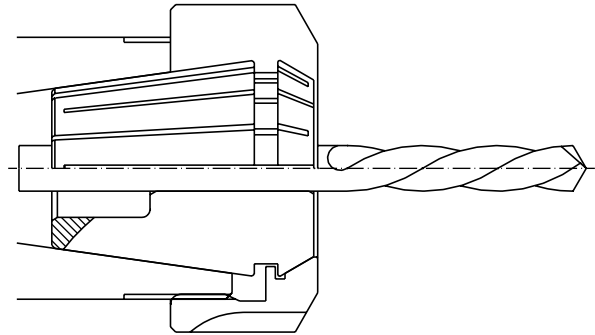

ER-UP High Precision Collets

Special Advantages

T.I.R. $\leq 0.0002"$ (5 μm) over the entire clamping range

Clamping range equal to the standard collets

Provides the lowest T.I.R. equal to or better than nominal diameter (on size) collets

ER collets are primarily used for high-speed cutting applications, where the lowest T.I.R. (Total Indicated Runout) is required. Low T.I.R. improves tool life, part finish and reduces spindle wear.

For the influence of T.I.R. on tool life see graph on page 2.03



When buying ER collets, please note the REGO-FIX® quality symbol \triangle on the front of the collet!

Concentricity T.I.R. DIN 6499/ISO15488

ER (Standard) and ER-UP (Ultra-Precision)

2

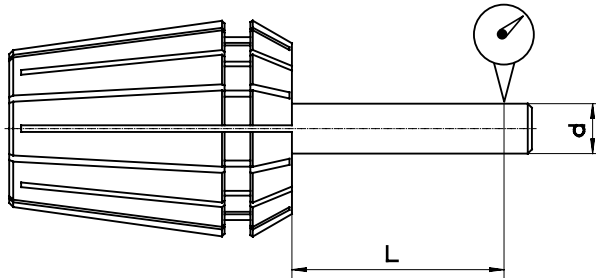

| Clamping Range [mm] | | | T.I.R. max. | | |
|---------------------|------|------|----------------------------------|----------------------|----------------------|
| From d | To d | L | DIN 6499/ ISO 15488 Form B | △ ER | △ ER-UP |
| 1.0 | 1.6 | 6.0 | | | |
| 1.6 | 3.0 | 10.0 | 0.0006" (0.015mm) | 0.0004" (0.010mm) | 0.0002" (0.005mm) |
| 3.0 | 6.0 | 16.0 | | | |
| 6.0 | 10.0 | 25.0 | | | |
| 10.0 | 18.0 | 40.0 | 0.0008" (0.020mm) | 0.0004" (0.010mm) | 0.0002" (0.005mm) |
| 18.0 | 26.0 | 50.0 | | | |
| 26.0 | 34.0 | 60.0 | 0.001" (0.025mm) | 0.0006" (0.015mm) | 0.0004" (0.010mm) |

Influence of Tool Run-out (T.I.R.) on Tool Life

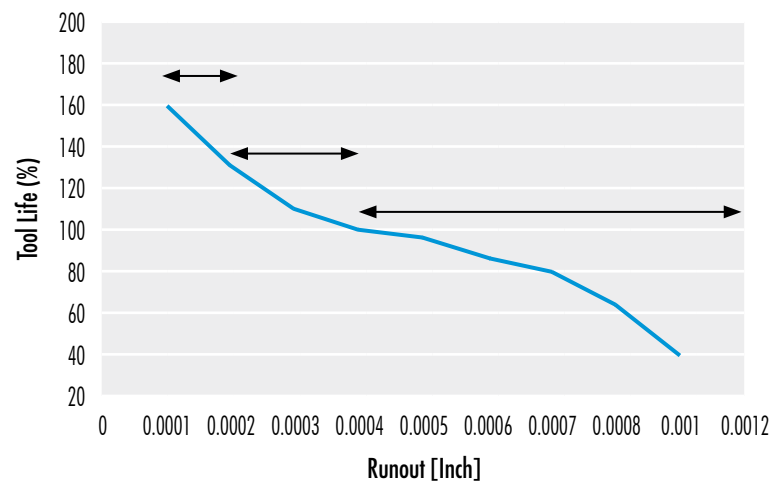

Precision is a function of the whole system including toolholder, collet and clamping nut. For best results, we recommend that you use REGO-FIX® toolholders, REGO-FIX® collets and REGO-FIX® clamping nuts.

Collets ER and ER-UP

Assembling Instructions

Insert groove of collet into eccentric ring of the clamping nut at the mark on the bottom of the nut. Push collet in the direction of the arrow until it clicks in place. Screw nut with collet onto toolholder. We recommend tightening the nut with a torque wrench.

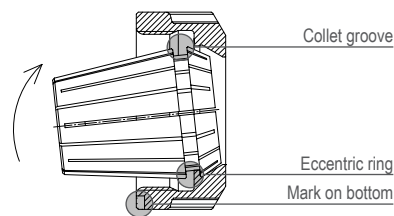

For recommended tightening torque please refer to list on page 14.03

Disassembly Instructions

After the nut is unscrewed from the toolholder, press on the face of the collet while simultaneously pushing sideways on the back of the collet opposite the mark until it disengages from the clamping nut.

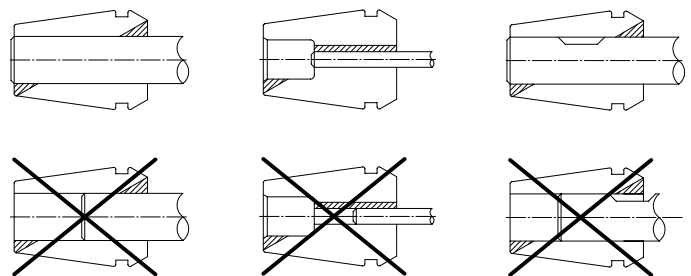
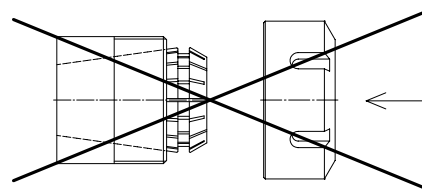
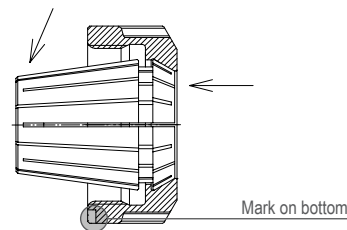

Improper assembly can permanently damage the concentricity of the collet and may result in damage to the clamping nut.

Only assemble the clamping nuts with correctly assembled collets!

Never clamp oversized tool shanks!
E.G. never use a \varnothing 12–11 mm collet to clamp a \varnothing 12.2 mm shank. Rather, use the next bigger collet (\varnothing 12.5–11.5 mm or 13–12 mm collet).

Insert tool to the full length of the collet for best results if possible. However, never insert the tool less than $\frac{2}{3}$ of the collet bore length. Improper tool insertion can permanently deform the collet and will result in poor run-out.



Swiss
Precision
Tools

ER Collets

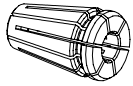

ER 8 | ER 8-UP (Ultra Precision) DIN 6499/ISO 15488

Metric

Inch

2

| Clamping Capacity | | ER 8 | ER 8-UP |
|--|-----------------|----------------------|------------|
| [mm] | [Inch] | Part No. | Part No. |
| 1.00 – 0.70* | 0.0394 – 0.0276 | 1108.01000 | 1108.01001 |
| 1.50 – 1.00* | 0.0591 – 0.0394 | 1108.01500 | 1108.01501 |
| 2.00 – 1.50* | 0.0787 – 0.0591 | 1108.02000 | 1108.02001 |
| 2.50 – 2.00* | 0.0984 – 0.0787 | 1108.02500 | 1108.02501 |
| 3.00 – 2.50* | 0.1181 – 0.0984 | 1108.03000 | 1108.03001 |
| 3.50 – 3.00* | 0.1378 – 0.1181 | 1108.03500 | 1108.03501 |
| 4.00 – 3.50* | 0.1575 – 0.1378 | 1108.04000 | 1108.04001 |
| 4.50 – 4.00* | 0.1772 – 0.1575 | 1108.04500 | 1108.04501 |
| 5.00 – 4.50* | 0.1969 – 0.1772 | 1108.05000 | 1108.05001 |
| Collet Sets come in Standard and UP *Sizes are included in Sets | | 1108.00000 | 1108.00001 |
| | | 9 Collets and 1 Tray | |

| Ø [inch] | Clamping Capacity | | ER 8 Part No. | ER 8-UP Part No. |
|--|-------------------|-------------|----------------------|---------------------|
| | [inch] | [mm] | | |
| 1/16* | 0.0625 – 0.0425 | 1.59 – 1.09 | 1108.01592 | 1108.01593 |
| 1/8* | 0.1250 – 0.1055 | 3.18 – 2.68 | 1108.03182 | 1108.03183 |
| 3/16* | 0.1875 – 0.1675 | 4.76 – 4.26 | 1108.04762 | 1108.04763 |
| Collet Sets come in Standard and UP All Sizes listed above are included in Sets | | | 1108.00002 | 1108.00003 |
| | | | 3 Collets and 1 Tray | |

Additional technical information on page 14.02

Related Items

| | |
|----------|------------------|
| Wrenches | See page 13.01 |
| Nuts | See Section 4.00 |

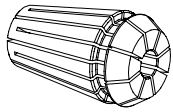

ER 11 | ER 11-UP (Ultra Precision)

DIN 6499/ISO 15488

Metric

| Clamping Capacity | | ER 11 | ER 11-UP |
|-------------------------------------|-----------------|-----------------------|------------|
| [mm] | [Inch] | Part No. | Part No. |
| 1.00 – 0.50* | 0.0394 – 0.0197 | 1111.01000 | 1111.01001 |
| 1.50 – 1.00* | 0.0591 – 0.0394 | 1111.01500 | 1111.01501 |
| 2.00 – 1.50* | 0.0787 – 0.0591 | 1111.02000 | 1111.02001 |
| 2.50 – 2.00* | 0.0984 – 0.0787 | 1111.02500 | 1111.02501 |
| 3.00 – 2.50* | 0.1181 – 0.0984 | 1111.03000 | 1111.03001 |
| 3.50 – 3.00* | 0.1378 – 0.1181 | 1111.03500 | 1111.03501 |
| 4.00 – 3.50* | 0.1575 – 0.1378 | 1111.04000 | 1111.04001 |
| 4.50 – 4.00* | 0.1772 – 0.1575 | 1111.04500 | 1111.04501 |
| 5.00 – 4.50* | 0.1969 – 0.1772 | 1111.05000 | 1111.05001 |
| 5.50 – 5.00* | 0.2165 – 0.1969 | 1111.05500 | 1111.05501 |
| 6.00 – 5.50* | 0.2362 – 0.2165 | 1111.06000 | 1111.06001 |
| 6.50 – 6.00* | 0.2559 – 0.2362 | 1111.06500 | 1111.06501 |
| 7.00 – 6.50* | 0.2756 – 0.2559 | 1111.07000 | 1111.07001 |
| Collet Sets come in Standard and UP | | 1111.00000 | 1111.00001 |
| *Sizes are included in Sets | | 13 Collets and 1 Tray | |

Additional technical information on page 14.02

Inch

| Ø | Clamping Capacity | | ER 11 | ER 11-UP |
|-------------------------------------|-------------------|-------------|----------------------|------------|
| [Inch] | [inch] | [mm] | Part No. | Part No. |
| 1/16* | 0.0625 – 0.0425 | 1.59 – 1.09 | 1111.01592 | 1111.01593 |
| 3/32* | 0.0938 – 0.0738 | 2.38 – 1.88 | 1111.02382 | 1111.02383 |
| 1/8* | 0.1250 – 0.1050 | 3.18 – 2.68 | 1111.03182 | 1111.03183 |
| 5/32* | 0.1563 – 0.1363 | 3.97 – 3.47 | 1111.03972 | 1111.03973 |
| 3/16* | 0.1875 – 0.1675 | 4.76 – 4.26 | 1111.04762 | 1111.04763 |
| 7/32* | 0.2188 – 0.1988 | 5.56 – 5.06 | 1111.05562 | 1111.05563 |
| 1/4* | 0.2500 – 0.2300 | 6.35 – 5.85 | 1111.06352 | 1111.06353 |
| Collet Sets come in Standard and UP | | | 1111.00002 | 1111.00003 |
| *Sizes are included in Sets | | | 7 Collets and 1 Tray | |

2

ER 11-ND (Nominal Diameter)

DIN 6499/ISO 15488

| Clamping Capacity | | ER 11ND |
|-------------------|--------|------------|
| [mm] | [Inch] | Part No. |
| 3.00 | 0.1181 | 1111.03005 |
| 4.00 | 0.1575 | 1111.04005 |
| 6.00 | 0.2362 | 1111.06005 |

Additional technical information on page 14.02

For use with the HSK -F Micro Milling holders to achieve the best TIR for high speed machining. See page 8.07 for matching holders.

| Related Items | |
|---------------|------------------|
| Wrenches | See page 13.01 |
| Nuts | See Section 4.00 |



Swiss
Precision
Tools

ER Collets

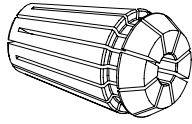

ER 16 | ER 16-UP (Ultra Precision) DIN 6499/ISO 15488

2

Metric

| Clamping Capacity | | ER 16 | ER 16-UP |
|--|-----------------|-----------------------|------------|
| [mm] | [Inch] | Part No. | Part No. |
| 1.00 – 0.50* | 0.0394 – 0.0197 | 1116.01000 | 1116.01001 |
| 1.50 – 1.00 | 0.0591 – 0.0394 | 1116.01500 | 1116.01501 |
| 2.00 – 1.00* | 0.0787 – 0.0394 | 1116.02000 | 1116.02001 |
| 2.50 – 1.50 | 0.0984 – 0.0591 | 1116.02500 | 1116.02501 |
| 3.00 – 2.00* | 0.1181 – 0.0787 | 1116.03000 | 1116.03001 |
| 3.50 – 2.50 | 0.1378 – 0.0984 | 1116.03500 | 1116.03501 |
| 4.00 – 3.00* | 0.1575 – 0.1181 | 1116.04000 | 1116.04001 |
| 4.50 – 3.50 | 0.1772 – 0.1378 | 1116.04500 | 1116.04501 |
| 5.00 – 4.00* | 0.1969 – 0.1575 | 1116.05000 | 1116.05001 |
| 5.50 – 4.50 | 0.2165 – 0.1772 | 1116.05500 | 1116.05501 |
| 6.00 – 5.00* | 0.2362 – 0.1969 | 1116.06000 | 1116.06001 |
| 6.50 – 5.50 | 0.2559 – 0.2165 | 1116.06500 | 1116.06501 |
| 7.00 – 6.00* | 0.2756 – 0.2362 | 1116.07000 | 1116.07001 |
| 7.50 – 6.50 | 0.2953 – 0.2559 | 1116.07500 | 1116.07501 |
| 8.00 – 7.00* | 0.3150 – 0.2756 | 1116.08000 | 1116.08001 |
| 8.50 – 7.50 | 0.3347 – 0.2953 | 1116.08500 | 1116.08501 |
| 9.00 – 8.00* | 0.3543 – 0.3150 | 1116.09000 | 1116.09001 |
| 9.50 – 8.50 | 0.3740 – 0.3347 | 1116.09500 | 1116.09501 |
| 10.00 – 9.00* | 0.3937 – 0.3543 | 1116.10000 | 1116.10001 |
| Collet Sets come in Standard and UP *Sizes are included in Sets | | 1116.00000 | 1116.00001 |
| | | 10 Collets and 1 Tray | |

Additional technical information on page 14.02

Inch

| Ø [Inch] | Clamping Capacity | | ER 16 | ER 16-UP |
|--|-------------------|--------------|---------------------|------------|
| | [inch] | [mm] | Part No. | Part No. |
| 1/16* | 0.0625 – 0.0425 | 1.59 – 1.09 | 1116.01592 | 1116.01593 |
| 3/32* | 0.0938 – 0.0738 | 2.38 – 1.88 | 1116.02382 | 1116.02383 |
| 1/8* | 0.1250 – 0.0850 | 3.18 – 2.18 | 1116.03182 | 1116.03183 |
| 5/32* | 0.1563 – 0.1163 | 3.97 – 2.97 | 1116.03972 | 1116.03973 |
| 3/16* | 0.1875 – 0.1475 | 4.76 – 3.76 | 1116.04762 | 1116.04763 |
| 7/32* | 0.2188 – 0.1788 | 5.56 – 4.56 | 1116.05562 | 1116.05563 |
| 1/4* | 0.2500 – 0.2100 | 6.35 – 5.35 | 1116.06352 | 1116.06353 |
| 9/32* | 0.2813 – 0.2413 | 7.14 – 6.14 | 1116.07142 | 1116.07143 |
| 5/16* | 0.3125 – 0.2725 | 7.94 – 6.94 | 1116.07942 | 1116.07943 |
| 11/32* | 0.3438 – 0.3038 | 8.73 – 7.73 | 1116.08732 | 1116.08733 |
| 3/8* | 0.3750 – 0.3350 | 9.53 – 8.53 | 1116.09532 | 1116.09533 |
| 13/32* | 0.4063 – 0.3663 | 10.32 – 9.32 | 1116.10322 | 1116.10323 |
| Collet Sets come in Standard and UP *Sizes are included in Sets | | | 1116.00002 | 1116.00003 |
| | | | 12 Collets and Tray | |

Related Items

| | |
|----------|------------------|
| Wrenches | See page 13.01 |
| Nuts | See Section 4.00 |

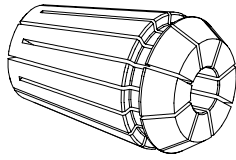

ER 20 | ER 20-UP (Ultra Precision)

DIN 6499/ISO 15488

Metric

| Clamping Capacity | | ER 20 | ER 20-UP |
|-------------------------------------|-----------------|-----------------------|------------|
| [mm] | [Inch] | Part No. | Part No. |
| 1.00 – 0.50 | 0.0394 – 0.0197 | 1120.01000 | 1120.01001 |
| 1.50 – 1.00 | 0.0591 – 0.0394 | 1120.01500 | 1120.01501 |
| 2.00 – 1.00* | 0.0787 – 0.0394 | 1120.02000 | 1120.02001 |
| 2.50 – 1.50 | 0.0984 – 0.0591 | 1120.02500 | 1120.02501 |
| 3.00 – 2.00* | 0.1181 – 0.0787 | 1120.03000 | 1120.03001 |
| 3.50 – 2.50 | 0.1378 – 0.0984 | 1120.03500 | 1120.03501 |
| 4.00 – 3.00* | 0.1575 – 0.1181 | 1120.04000 | 1120.04001 |
| 4.50 – 3.50 | 0.1772 – 0.1378 | 1120.04500 | 1120.04501 |
| 5.00 – 4.00* | 0.1969 – 0.1575 | 1120.05000 | 1120.05001 |
| 5.50 – 4.50 | 0.2165 – 0.1772 | 1120.05500 | 1120.05501 |
| 6.00 – 5.00* | 0.2362 – 0.1969 | 1120.06000 | 1120.06001 |
| 6.50 – 5.50 | 0.2559 – 0.2165 | 1120.06500 | 1120.06501 |
| 7.00 – 6.00* | 0.2756 – 0.2362 | 1120.07000 | 1120.07001 |
| 7.50 – 6.50 | 0.2953 – 0.2559 | 1120.07500 | 1120.07501 |
| 8.00 – 7.00* | 0.3150 – 0.2756 | 1120.08000 | 1120.08001 |
| 8.50 – 7.50 | 0.3347 – 0.2953 | 1120.08500 | 1120.08501 |
| 9.00 – 8.00* | 0.3543 – 0.3150 | 1120.09000 | 1120.09001 |
| 9.50 – 8.50 | 0.3740 – 0.3347 | 1120.09500 | 1120.09501 |
| 10.00 – 9.00* | 0.3937 – 0.3543 | 1120.10000 | 1120.10001 |
| 10.50 – 9.50 | 0.4134 – 0.3740 | 1120.10500 | 1120.10501 |
| 11.00 – 10.00* | 0.4330 – 0.3937 | 1120.11000 | 1120.11001 |
| 11.50 – 10.50 | 0.4528 – 0.4134 | 1120.11500 | 1120.11501 |
| 12.00 – 11.00* | 0.4724 – 0.4330 | 1120.12000 | 1120.12001 |
| 12.50 – 11.50 | 0.4921 – 0.4528 | 1120.12500 | 1120.12501 |
| 13.00 – 12.00* | 0.5118 – 0.4724 | 1120.13000 | 1120.13001 |
| Collet Sets come in Standard and UP | | 1120.00000 | 1120.00001 |
| *Sizes are included in Sets | | 12 Collets and 1 Tray | |

Additional technical information on page 14.02

Inch

| Ø [Inch] | Clamping Capacity | | ER 20 Part No. | ER 20-UP Part No. |
|-------------------------------------|-------------------|---------------|----------------------|----------------------|
| | [inch] | [mm] | | |
| 1/8* | 0.1250 – 0.0850 | 3.18 – 2.18 | 1120.03182 | 1120.03183 |
| 3/16* | 0.1875 – 0.1475 | 4.76 – 3.76 | 1120.04762 | 1120.04763 |
| 1/4* | 0.2500 – 0.2100 | 6.35 – 5.35 | 1120.06352 | 1120.06353 |
| 5/16* | 0.3125 – 0.2725 | 7.94 – 6.94 | 1120.07942 | 1120.07943 |
| 3/8* | 0.3750 – 0.3350 | 9.53 – 8.53 | 1120.09532 | 1120.09533 |
| 7/16* | 0.4375 – 0.3975 | 11.11 – 10.11 | 1120.11112 | 1120.11113 |
| 1/2* | 0.5000 – 0.4600 | 12.70 – 11.70 | 1120.12702 | 1120.12703 |
| Collet Sets come in Standard and UP | | | 1120.00002 | 1120.00003 |
| *Sizes are included in Sets | | | 7 Collets and 1 Tray | |

2

| Related Items | |
|---------------|------------------|
| Wrenches | See page 13.01 |
| Nuts | See Section 4.00 |

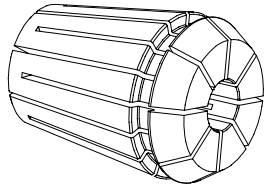

ER 25 | ER 25-UP^(Ultra Precision)

DIN 6499/ISO 15488

Metric

2

| Clamping Capacity | | ER 25 | ER 25-UP |
|-------------------|-----------------|------------|------------|
| [mm] | [Inch] | Part No. | Part No. |
| 1.00 – 0.50 | 0.0394 – 0.0197 | 1125.01000 | 1125.01001 |
| 1.50 – 1.00 | 0.0591 – 0.0394 | 1125.01500 | 1125.01501 |
| 2.00 – 1.00* | 0.0787 – 0.0394 | 1125.02000 | 1125.02001 |
| 2.50 – 1.50 | 0.0984 – 0.0591 | 1125.02500 | 1125.02501 |
| 3.00 – 2.00* | 0.1181 – 0.0787 | 1125.03000 | 1125.03001 |
| 3.50 – 2.50 | 0.1378 – 0.0984 | 1125.03500 | 1125.03501 |
| 4.00 – 3.00* | 0.1575 – 0.1181 | 1125.04000 | 1125.04001 |
| 4.50 – 3.50 | 0.1772 – 0.1378 | 1125.04500 | 1125.04501 |
| 5.00 – 4.00* | 0.1969 – 0.1575 | 1125.05000 | 1125.05001 |
| 5.50 – 4.50 | 0.2165 – 0.1772 | 1125.05500 | 1125.05501 |
| 6.00 – 5.00* | 0.2362 – 0.1969 | 1125.06000 | 1125.06001 |
| 6.50 – 5.50 | 0.2559 – 0.2165 | 1125.06500 | 1125.06501 |
| 7.00 – 6.00* | 0.2756 – 0.2362 | 1125.07000 | 1125.07001 |
| 7.50 – 6.50 | 0.2953 – 0.2559 | 1125.07500 | 1125.07501 |
| 8.00 – 7.00* | 0.3150 – 0.2756 | 1125.08000 | 1125.08001 |
| 8.50 – 7.50 | 0.3347 – 0.2953 | 1125.08500 | 1125.08501 |
| 9.00 – 8.00* | 0.3543 – 0.3150 | 1125.09000 | 1125.09001 |
| 9.50 – 8.50 | 0.3740 – 0.3347 | 1125.09500 | 1125.09501 |
| 10.00 – 9.00* | 0.3937 – 0.3543 | 1125.10000 | 1125.10001 |
| 10.50 – 9.50 | 0.4134 – 0.3740 | 1125.10500 | 1125.10501 |
| 11.00 – 10.00* | 0.4330 – 0.3937 | 1125.11000 | 1125.11001 |
| 11.50 – 10.50 | 0.4528 – 0.4134 | 1125.11500 | 1125.11501 |
| 12.00 – 11.00* | 0.4724 – 0.4330 | 1125.12000 | 1125.12001 |
| 12.50 – 11.50 | 0.4921 – 0.4528 | 1125.12500 | 1125.12501 |
| 13.00 – 12.00* | 0.5118 – 0.4724 | 1125.13000 | 1125.13001 |
| 13.50 – 12.50 | 0.5315 – 0.4921 | 1125.13500 | 1125.13501 |

Metric (cont.)

| Clamping Capacity | | ER 25 | ER 25-UP |
|-------------------------------------|-----------------|-----------------------|------------|
| [mm] | [Inch] | Part No. | Part No. |
| 14.00 – 13.00* | 0.5512 – 0.5118 | 1125.14000 | 1125.14001 |
| 14.50 – 13.50 | 0.5709 – 0.5315 | 1125.14500 | 1125.14501 |
| 15.00 – 14.00* | 0.5905 – 0.5512 | 1125.15000 | 1125.15001 |
| 15.50 – 14.50 | 0.6102 – 0.5315 | 1125.15500 | 1125.15501 |
| 16.00 – 15.00* | 0.6300 – 0.5905 | 1125.16000 | 1125.16001 |
| Collet Sets come in Standard and UP | | 1125.00000 | 1125.00001 |
| *Sizes are included in Sets | | 15 Collets and 1 Tray | |

Additional technical information on page 14.02

Inch

| Ø [Inch] | Clamping Capacity | | ER 25 Part No. | ER 25-UP Part No. |
|-------------------------------------|-------------------|---------------|----------------------|----------------------|
| | [inch] | [mm] | | |
| 1/8* | 0.1250 – 0.0850 | 3.18 – 2.18 | 1125.03182 | 1125.03183 |
| 3/16* | 0.1875 – 0.1475 | 4.76 – 3.76 | 1125.04762 | 1125.04763 |
| 1/4* | 0.2500 – 0.2100 | 6.35 – 5.35 | 1125.06352 | 1125.06353 |
| 5/16* | 0.3125 – 0.2725 | 7.94 – 6.94 | 1125.07942 | 1125.07943 |
| 3/8* | 0.3750 – 0.3350 | 9.53 – 8.53 | 1125.09532 | 1125.09533 |
| 7/16* | 0.4375 – 0.3975 | 11.11 – 10.11 | 1125.11112 | 1125.11113 |
| 1/2* | 0.5000 – 0.4600 | 12.70 – 11.70 | 1125.12702 | 1125.12703 |
| 9/16* | 0.5625 – 0.5225 | 14.29 – 13.29 | 1125.14292 | 1125.14293 |
| 5/8* | 0.6250 – 0.5820 | 15.88 – 14.88 | 1125.15882 | 1125.15883 |
| Collet Sets come in Standard and UP | | | 1125.00002 | 1125.00003 |
| *Sizes are included in Sets | | | 9 Collets and 1 Tray | |

Related Items

| | |
|----------|------------------|
| Wrenches | See page 13.01 |
| Nuts | See Section 4.00 |

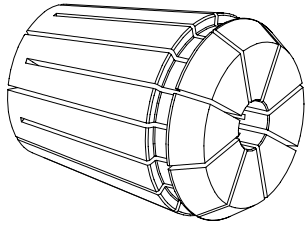

ER 32 | ER 32-UP (Ultra Precision)

DIN 6499/ISO 15488

Metric

| Clamping Capacity | | ER 32 | ER 32-UP |
|-------------------|-----------------|------------|------------|
| [mm] | [Inch] | Part No. | Part No. |
| 2.00 – 1.00 | 0.0787 – 0.0394 | 1132.02000 | 1132.02001 |
| 2.50 – 1.50 | 0.0984 – 0.0591 | 1132.02500 | 1132.02501 |
| 3.00 – 2.00* | 0.1181 – 0.0787 | 1132.03000 | 1132.03001 |
| 3.50 – 2.50 | 0.1378 – 0.0984 | 1132.03500 | 1132.03501 |
| 4.00 – 3.00* | 0.1575 – 0.1181 | 1132.04000 | 1132.04001 |
| 4.50 – 3.50 | 0.1772 – 0.1378 | 1132.04500 | 1132.04501 |
| 5.00 – 4.00* | 0.1969 – 0.1575 | 1132.05000 | 1132.05001 |
| 5.50 – 4.50 | 0.2165 – 0.1772 | 1132.05500 | 1132.05501 |
| 6.00 – 5.00* | 0.2362 – 0.1969 | 1132.06000 | 1132.06001 |
| 6.50 – 5.50 | 0.2559 – 0.2165 | 1132.06500 | 1132.06501 |
| 7.00 – 6.00* | 0.2756 – 0.2362 | 1132.07000 | 1132.07001 |
| 7.50 – 6.50 | 0.2953 – 0.2559 | 1132.07500 | 1132.07501 |
| 8.00 – 7.00* | 0.3150 – 0.2756 | 1132.08000 | 1132.08001 |
| 8.50 – 7.50 | 0.3347 – 0.2953 | 1132.08500 | 1132.08501 |
| 9.00 – 8.00* | 0.3543 – 0.3150 | 1132.09000 | 1132.09001 |
| 9.50 – 8.50 | 0.3740 – 0.3347 | 1132.09500 | 1132.09501 |
| 10.00 – 9.00* | 0.3937 – 0.3543 | 1132.10000 | 1132.10001 |
| 10.50 – 9.50 | 0.4134 – 0.3740 | 1132.10500 | 1132.10501 |
| 11.00 – 10.00* | 0.4330 – 0.3937 | 1132.11000 | 1132.11001 |
| 11.50 – 10.50 | 0.4528 – 0.4134 | 1132.11500 | 1132.11501 |
| 12.00 – 11.00* | 0.4724 – 0.4330 | 1132.12000 | 1132.12001 |
| 12.50 – 11.50 | 0.4921 – 0.4528 | 1132.12500 | 1132.12501 |
| 13.00 – 12.00* | 0.5118 – 0.4724 | 1132.13000 | 1132.13001 |
| 13.50 – 12.50 | 0.5315 – 0.4921 | 1132.13500 | 1132.13501 |
| 14.00 – 13.00* | 0.5512 – 0.5118 | 1132.14000 | 1132.14001 |
| 14.50 – 13.50 | 0.5709 – 0.5315 | 1132.14500 | 1132.14501 |
| 15.00 – 14.00* | 0.5905 – 0.5512 | 1132.15000 | 1132.15001 |
| 15.50 – 14.50 | 0.6102 – 0.5315 | 1132.15500 | 1132.15501 |
| 16.00 – 15.00* | 0.6300 – 0.5905 | 1132.16000 | 1132.16001 |
| 16.50 – 15.50 | 0.6496 – 0.6102 | 1132.16500 | 1132.16501 |
| 17.00 – 16.00* | 0.6693 – 0.6300 | 1132.17000 | 1132.17001 |

Metric (cont.)

| Clamping Capacity | | ER 32 | ER 32-UP |
|-------------------------------------|-----------------|-----------------------|------------|
| [mm] | [Inch] | Part No. | Part No. |
| 17.50 – 16.50 | 0.6890 – 0.6496 | 1132.17500 | 1132.17501 |
| 18.00 – 17.00* | 0.7087 – 0.6693 | 1132.18000 | 1132.18001 |
| 18.50 – 17.50 | 0.7284 – 0.6890 | 1132.18500 | 1132.18501 |
| 19.00 – 18.00* | 0.7480 – 0.7078 | 1132.19000 | 1132.19001 |
| 19.50 – 18.50 | 0.7677 – 0.7284 | 1132.19500 | 1132.19501 |
| 20.00 – 19.00* | 0.7874 – 0.7480 | 1132.20000 | 1132.20001 |
| Collet Sets come in Standard and UP | | 1132.00000 | 1132.00001 |
| *Sizes are included in Sets | | 18 Collets and 1 Tray | |

Additional technical information on page 14.02

Inch

| Ø [inch] | Clamping Capacity | | ER 32 Part No. | ER 32-UP Part No. |
|-------------------------------------|-------------------|---------------|-----------------------|----------------------|
| | [inch] | [mm] | | |
| 1/8* | 0.1250 – 0.0850 | 3.18 – 2.18 | 1132.03182 | 1132.03183 |
| 3/16* | 0.1875 – 0.1475 | 4.76 – 3.76 | 1132.04762 | 1132.04763 |
| 1/4* | 0.2500 – 0.2100 | 6.35 – 5.35 | 1132.06352 | 1132.06353 |
| 5/16* | 0.3125 – 0.2725 | 7.94 – 6.94 | 1132.07942 | 1132.07943 |
| 3/8* | 0.3750 – 0.3350 | 9.53 – 8.53 | 1132.09532 | 1132.09533 |
| 7/16* | 0.4375 – 0.3975 | 11.11 – 10.11 | 1132.11112 | 1132.11113 |
| 1/2* | 0.5000 – 0.4600 | 12.70 – 11.70 | 1132.12702 | 1132.12703 |
| 9/16* | 0.5625 – 0.5225 | 14.29 – 13.29 | 1132.14292 | 1132.14293 |
| 5/8* | 0.6250 – 0.5850 | 15.88 – 14.88 | 1132.15882 | 1132.15883 |
| 11/16* | 0.6875 – 0.6475 | 17.46 – 16.46 | 1132.17462 | 1132.17463 |
| 3/4* | 0.7500 – 0.7100 | 19.05 – 18.05 | 1132.19052 | 1132.19053 |
| 13/16* | 0.8125 – 0.7725 | 20.64 – 19.64 | 1132.20642 | 1132.20643 |
| Collet Sets come in Standard and UP | | | 1132.00002 | 1132.00003 |
| *Sizes are included in Set | | | 12 Collets and 1 Tray | |

Related Items

| | |
|----------|------------------|
| Wrenches | See page 13.01 |
| Nuts | See Section 4.00 |



Swiss
Precision
Tools

ER

Collets

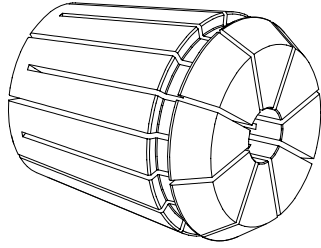

ER 40 | ER 40-UP^(Ultra Precision)

DIN 6499/ISO 15488

Metric

Metric (cont.)

2

| Clamping Capacity | | ER 40 | ER 40-UP |
|-------------------|-----------------|------------|------------|
| [mm] | [Inch] | Part No. | Part No. |
| 3.00 – 2.00 | 0.1181 – 0.0787 | 1140.03000 | 1140.03001 |
| 3.50 – 2.50 | 0.1378 – 0.0984 | 1140.03500 | 1140.03501 |
| 4.00 – 3.00* | 0.1575 – 0.1181 | 1140.04000 | 1140.04001 |
| 4.50 – 3.50 | 0.1772 – 0.1378 | 1140.04500 | 1140.04501 |
| 5.00 – 4.00* | 0.1969 – 0.1575 | 1140.05000 | 1140.05001 |
| 5.50 – 4.50 | 0.2165 – 0.1772 | 1140.05500 | 1140.05501 |
| 6.00 – 5.00* | 0.2362 – 0.1969 | 1140.06000 | 1140.06001 |
| 6.50 – 5.50 | 0.2559 – 0.2165 | 1140.06500 | 1140.06501 |
| 7.00 – 6.00* | 0.2756 – 0.2362 | 1140.07000 | 1140.07001 |
| 7.50 – 6.50 | 0.2953 – 0.2559 | 1140.07500 | 1140.07501 |
| 8.00 – 7.00* | 0.3150 – 0.2756 | 1140.08000 | 1140.08001 |
| 8.50 – 7.50 | 0.3347 – 0.2953 | 1140.08500 | 1140.08501 |
| 9.00 – 8.00* | 0.3543 – 0.3150 | 1140.09000 | 1140.09001 |
| 9.50 – 8.50 | 0.3740 – 0.3347 | 1140.09500 | 1140.09501 |
| 10.00 – 9.00* | 0.3937 – 0.3543 | 1140.10000 | 1140.10001 |
| 10.50 – 9.50 | 0.4134 – 0.3740 | 1140.10500 | 1140.10501 |
| 11.00 – 10.00* | 0.4330 – 0.3937 | 1140.11000 | 1140.11001 |
| 11.50 – 10.50 | 0.4528 – 0.4134 | 1140.11500 | 1140.11501 |
| 12.00 – 11.00* | 0.4724 – 0.4375 | 1140.12000 | 1140.12001 |
| 12.50 – 11.50 | 0.4921 – 0.4528 | 1140.12500 | 1140.12501 |
| 13.00 – 12.00* | 0.5118 – 0.4724 | 1140.13000 | 1140.13001 |
| 13.50 – 12.50 | 0.5315 – 0.4921 | 1140.13500 | 1140.13501 |
| 14.00 – 13.00* | 0.5512 – 0.5118 | 1140.14000 | 1140.14001 |
| 14.50 – 13.50 | 0.5709 – 0.5315 | 1140.14500 | 1140.14501 |
| 15.00 – 14.00* | 0.5905 – 0.5512 | 1140.15000 | 1140.15001 |
| 15.50 – 14.50 | 0.6102 – 0.5315 | 1140.15500 | 1140.15501 |
| 16.00 – 15.00* | 0.6300 – 0.5905 | 1140.16000 | 1140.16001 |
| 16.50 – 15.50 | 0.6496 – 0.6102 | 1140.16500 | 1140.16501 |

| Clamping Capacity | | ER 40 | ER 40-UP |
|-------------------------------------|-----------------|-----------------------|------------|
| [mm] | [Inch] | Part No. | Part No. |
| 17.00 – 16.00* | 0.6693 – 0.6300 | 1140.17000 | 1140.17001 |
| 17.50 – 16.50 | 0.6890 – 0.6496 | 1140.17500 | 1140.17501 |
| 18.00 – 17.00* | 0.7087 – 0.6693 | 1140.18000 | 1140.18001 |
| 18.50 – 17.50 | 0.7284 – 0.6890 | 1140.18500 | 1140.18501 |
| 19.00 – 18.00* | 0.7480 – 0.7078 | 1140.19000 | 1140.19001 |
| 19.50 – 18.50 | 0.7677 – 0.7284 | 1140.19500 | 1140.19501 |
| 20.00 – 19.00* | 0.7874 – 0.7480 | 1140.20000 | 1140.20001 |
| 20.50 – 19.50 | 0.8071 – 0.7677 | 1140.20500 | 1140.20501 |
| 21.00 – 20.00* | 0.8268 – 0.7874 | 1140.21000 | 1140.21001 |
| 21.50 – 20.50 | 0.8465 – 0.8071 | 1140.21500 | 1140.21501 |
| 22.00 – 21.00* | 0.8661 – 0.8268 | 1140.22000 | 1140.22001 |
| 22.50 – 21.50 | 0.8858 – 0.8465 | 1140.22500 | 1140.22501 |
| 23.00 – 22.00* | 0.9055 – 0.8661 | 1140.23000 | 1140.23001 |
| 23.50 – 22.50 | 0.9252 – 0.8858 | 1140.23500 | 1140.23501 |
| 24.00 – 23.00* | 0.9449 – 0.9055 | 1140.24000 | 1140.24001 |
| 24.50 – 23.50 | 0.9646 – 0.9252 | 1140.24500 | 1140.24501 |
| 25.00 – 24.00* | 0.9843 – 0.9449 | 1140.25000 | 1140.25001 |
| 25.50 – 24.50 | 1.0039 – 0.9646 | 1140.25500 | 1140.25501 |
| 26.00 – 25.00* | 1.0236 – 0.9843 | 1140.26000 | 1140.26001 |
| 27.00 – 26.00 | 1.0630 – 1.0236 | 1140.27000 | 1140.27001 |
| 28.00 – 27.00 | 1.1024 – 1.0630 | 1140.28000 | 1140.28001 |
| 29.00 – 28.00 | 1.1417 – 1.1024 | 1140.29000 | 1140.29001 |
| 30.00 – 29.00 | 1.1811 – 1.1417 | 1140.30000 | 1140.30001 |
| Collet Sets come in Standard and UP | | 1140.00000 | 1140.00001 |
| *Sizes are included in Set | | 23 Collets and 1 Tray | |

Additional technical information on page 14.02

Related Items

| | |
|----------|------------------|
| Wrenches | See page 13.01 |
| Nuts | See Section 4.00 |

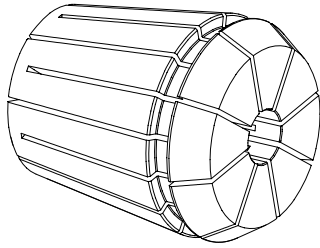

ER 40 | ER 40-UP^(Ultra Precision)

DIN 6499/ISO 15488

Inch

2

| Ø [Inch] | Clamping Capacity | | ER 40 Part No. | ER 40-UP Part No. |
|---|-------------------|---------------|-----------------------|----------------------|
| | [inch] | [mm] | | |
| 1/8* | 0.1250 – 0.0850 | 3.18 – 2.18 | 1140.03182 | 1140.03183 |
| 3/16* | 0.1875 – 0.1475 | 4.76 – 3.76 | 1140.04762 | 1140.04763 |
| 1/4* | 0.2500 – 0.2100 | 6.35 – 5.35 | 1140.06352 | 1140.06353 |
| 5/16* | 0.3125 – 0.2725 | 7.94 – 6.94 | 1140.07942 | 1140.07943 |
| 3/8* | 0.3750 – 0.3350 | 9.53 – 8.53 | 1140.09532 | 1140.09533 |
| 7/16* | 0.4375 – 0.3975 | 11.11 – 10.11 | 1140.11112 | 1140.11113 |
| 1/2* | 0.5000 – 0.4600 | 12.70 – 11.70 | 1140.12702 | 1140.12703 |
| 9/16* | 0.5625 – 0.5225 | 14.29 – 13.29 | 1140.14292 | 1140.14293 |
| 5/8* | 0.6250 – 0.5850 | 15.88 – 14.88 | 1140.15882 | 1140.15883 |
| 11/16* | 0.6875 – 0.6475 | 17.46 – 16.46 | 1140.17462 | 1140.17463 |
| 3/4* | 0.7500 – 0.7100 | 19.05 – 18.05 | 1140.19052 | 1140.19053 |
| 13/16* | 0.8125 – 0.7725 | 20.64 – 19.64 | 1140.20642 | 1140.20643 |
| 7/8* | 0.8750 – 0.8350 | 22.23 – 21.23 | 1140.22232 | 1140.22233 |
| 1* | 1.0000 – 0.9600 | 25.40 – 24.40 | 1140.25402 | 1140.25403 |
| Collet Sets come in Standard and UP *Sizes are included in Set | | | 1140.00002 | 1140.00003 |
| | | | 14 Collets and 1 Tray | |

| Related Items | |
|---------------|------------------|
| Wrenches | See page 13.01 |
| Nuts | See Section 4.00 |



Swiss
Precision
Tools

ER

Collets

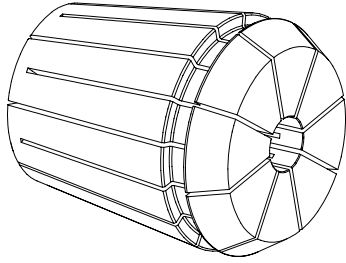

ER 50 | ER 50-UP^(Ultra Precision)

DIN 6499/ISO 15488

Metric

2

| Clamping Capacity | | Ø [Inch] | ER 50 Part No. | ER 50-UP Part No. |
|-------------------------------------|-----------------|-------------|-----------------------|----------------------|
| [mm] | [Inch] | | | |
| 6.00 – 4.00 | 0.2362 – 0.1575 | 3/16" | 1150.06000 | 1150.06001 |
| 8.00 – 6.00 | 0.3150 – 0.2362 | 1/4" | 1150.08000 | 1150.08001 |
| 10.00 – 8.00 | 0.3937 – 0.3150 | 3/8" | 1150.10000 | 1150.10001 |
| 12.00 – 10.00* | 0.4724 – 0.3937 | 7/16" | 1150.12000 | 1150.12001 |
| 14.00 – 12.00* | 0.5512 – 0.4724 | 1/2" | 1150.14000 | 1150.14001 |
| 16.00 – 14.00* | 0.6300 – 0.5512 | 5/8" | 1150.16000 | 1150.16001 |
| 18.00 – 16.00* | 0.7087 – 0.6300 | 11/16" | 1150.18000 | 1150.18001 |
| 20.00 – 18.00* | 0.7874 – 0.7087 | 3/4" | 1150.20000 | 1150.20001 |
| 22.00 – 20.00* | 0.8661 – 0.7874 | 13/16" | 1150.22000 | 1150.22001 |
| 24.00 – 22.00* | 0.9449 – 0.8661 | 7/8" | 1150.24000 | 1150.24001 |
| 25.00 – 23.00 | 0.9843 – 0.9055 | 31/32" | 1150.25000 | 1150.25001 |
| 26.00 – 24.00* | 1.0236 – 0.9449 | 1" | 1150.26000 | 1150.26001 |
| 28.00 – 26.00* | 1.1024 – 1.0236 | 1-1/16" | 1150.28000 | 1150.28001 |
| 30.00 – 28.00* | 1.1811 – 1.1024 | 1-1/8" | 1150.30000 | 1150.30001 |
| 32.00 – 30.00* | 1.2598 – 1.1811 | 1-1/4" | 1150.32000 | 1150.32001 |
| 34.00 – 32.00* | 1.3386 – 1.2598 | 1-5/16" | 1150.34000 | 1150.34001 |
| Collet Sets come in Standard and UP | | | 1150.00000 | 1150.00001 |
| *Sizes are included in Set | | | 12 Collets and 1 Tray | |

Additional technical information on page 14.02

Related Items

| | |
|----------|------------------|
| Wrenches | See page 13.01 |
| Nuts | See Section 4.00 |

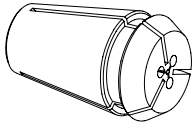

ER 8 – ER 16 Microbore

DIN 6499/ISO15488

2

ER 8 Microbore

| Clamping Diameter h7 | | ER 8-MB Part No. |
|----------------------|--------|---------------------|
| [mm] | [Inch] | |
| 0.2 | 0.0079 | 1308.00200 |
| 0.3 | 0.0118 | 1308.00300 |
| 0.4 | 0.0157 | 1308.00400 |
| 0.5 | 0.0197 | 1308.00500 |
| 0.6 | 0.0236 | 1308.00600 |
| 0.7 | 0.0276 | 1308.00700 |
| 0.8 | 0.0315 | 1308.00800 |
| 0.9 | 0.0354 | 1308.00900 |

Additional technical information on page 14.06

ER 11 Microbore

| Clamping Diameter h7 | | ER 11-MB Part No. |
|----------------------|--------|----------------------|
| [mm] | [Inch] | |
| 0.2 | 0.0079 | 1311.00200 |
| 0.3 | 0.0118 | 1311.00300 |
| 0.4 | 0.0157 | 1311.00400 |
| 0.5 | 0.0197 | 1311.00500 |
| 0.6 | 0.0236 | 1311.00600 |
| 0.7 | 0.0276 | 1311.00700 |
| 0.8 | 0.0315 | 1311.00800 |
| 0.9 | 0.0354 | 1311.00900 |

Additional technical information on page 14.06

ER 16 Microbore

| Clamping Diameter h7 | | ER 16-MB Part No. |
|----------------------|--------|----------------------|
| [mm] | [Inch] | |
| 0.2 | 0.0079 | 1316.00200 |
| 0.3 | 0.0118 | 1316.00300 |
| 0.4 | 0.0157 | 1316.00400 |
| 0.5 | 0.0197 | 1316.00500 |
| 0.6 | 0.0236 | 1316.00600 |
| 0.7 | 0.0276 | 1316.00700 |
| 0.8 | 0.0315 | 1316.00800 |
| 0.9 | 0.0354 | 1316.00900 |

Additional technical information on page 14.06

Microbore Collets have a run-out of 0.0002" (6µm). They have been developed by REGO-FIX® especially for small tool shank diameters.

Special diameters in inch and metric sizes can be quoted upon request

| Related Items | |
|---------------|------------------|
| Wrenches | See page 13.01 |
| Nuts | See Section 4.00 |



Swiss Precision Tools

ER Metallic Sealed Collets

ER DM | Metallic Sealed For Coolant Through Tooling

Designed and patented by REGO-FIX®, our metallic sealed collets will seal the tool to the collet and the collet to the toolholder.

Universal Fit

Will work with any standard or friction bearing nut, no need to purchase any special coolant nuts or disks for coolant sealing.

Swiss Quality

1 Made in Switzerland to ISO 9001/ISO 14001.

Marking

2 Type and size (reduces collet selection errors).

Traceability

3 Lot numbers are marked on all products for traceability throughout the entire manufacturing process.

High Pressure

For applications up to 2000psi (150 bar).

Original REGO-FIX®

REGO-FIX® is the inventor of the worldwide standardized ER collet system. Our extensive experience results in a well-engineered system. When buying ER collets, please note the REGO-FIX® quality symbol \triangle on the front of the collet.

Worldwide Availability

With the global REGO-FIX® distribution network.

Matched Tooling System

All REGO-FIX® components such as collets, toolholders, clamping nuts and spanners are all manufactured by REGO-FIX®. The compatibility of the whole system results in maximum precision, balance and tool life.

2

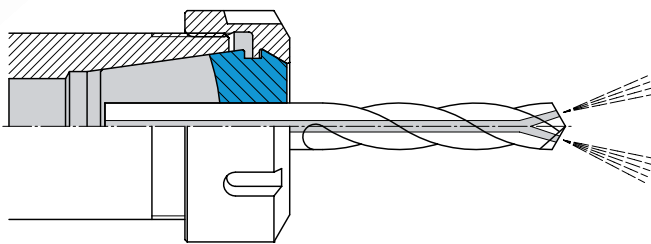

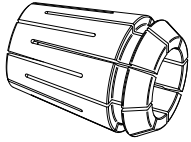

ER 16 DM | Metallic Sealed

For Coolant Through Tooling

Metric

| Clamping Capacity | | ER 16 DM Part No. |
|---|-----------------|-------------------|
| [mm] | [Inch] | |
| 3.00 | 0.1181 | 1216.03000 |
| 4.00 | 0.1575 | 1216.04000 |
| 5.00 – 4.50 | 0.1969 – 0.1772 | 1216.05000 |
| 6.00 – 5.50 | 0.2362 – 0.2165 | 1216.06000 |
| 7.00 – 6.50 | 0.2756 – 0.2559 | 1216.07000 |
| 8.00 – 7.50 | 0.3150 – 0.2953 | 1216.08000 |
| 9.00 – 8.50 | 0.3543 – 0.3347 | 1216.09000 |
| 10.00 – 9.50 | 0.3937 – 0.3740 | 1216.10000 |
| ER 16 Metric Metallic Sealed Collet Set | | 1216.00000 |

Inch

| Ø [Inch] | Clamping Capacity | | ER 16 DM Part No. |
|---------------------------------------|-------------------|-------------|-------------------|
| | [Inch] | [mm] | |
| 1/8 | 0.1250 | 3.18 | 1216.03182 |
| 3/16 | 0.1875 | 4.76 | 1216.04762 |
| 1/4 | 0.2500 – 0.2303 | 6.35 – 5.85 | 1216.06352 |
| 5/16 | 0.3125 – 0.2929 | 7.94 – 7.44 | 1216.07942 |
| 3/8 | 0.3750 – 0.3556 | 9.53 – 9.03 | 1216.09532 |
| ER 16 Inch Metallic Sealed Collet Set | | | 1216.00002 |

2

Sizes listed with no clamping range are produced to maintain the lowest T.I.R. possible. Larger diameter collets have a 0.020" (0.5 mm) range.

Related Items

| | |
|----------|------------------|
| Wrenches | See page 13.01 |
| Nuts | See Section 4.00 |



Swiss
Precision
Tools

ER

Metallic Sealed Collets

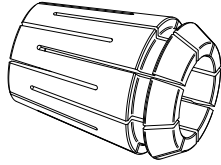

ER 20 DM | Metallic Sealed

For Coolant Through Tooling

Metric

Inch

2

| Clamping Capacity | | ER 20 DM Part No. |
|---|-----------------|----------------------|
| [mm] | [Inch] | |
| 3.00 | 0.1181 | 1220.03000 |
| 4.00 | 0.1575 | 1220.04000 |
| 5.00 | 0.1969 | 1220.05000 |
| 6.00 | 0.2362 | 1220.06000 |
| 7.00 – 6.50 | 0.2756 – 0.2559 | 1220.07000 |
| 8.00 – 7.50 | 0.3150 – 0.2953 | 1220.08000 |
| 9.00 – 8.50 | 0.3543 – 0.3347 | 1220.09000 |
| 10.00 – 9.50 | 0.3937 – 0.3740 | 1220.10000 |
| 11.00 – 10.50 | 0.4330 – 0.4134 | 1220.11000 |
| 12.00 – 11.50 | 0.4724 – 0.4528 | 1220.12000 |
| 13.00 – 12.50 | 0.5118 – 0.4921 | 1220.13000 |
| ER 20 Metric Metallic Sealed Collet Set | | 1220.00000 |

| Ø [Inch] | Clamping Capacity | | ER 20 DM Part No. |
|---------------------------------------|-------------------|---------------|----------------------|
| | [Inch] | [mm] | |
| 1/8 | 0.1250 | 3.18 | 1220.03182 |
| 3/16 | 0.1875 | 4.76 | 1220.04762 |
| 1/4 | 0.2500 | 6.35 | 1220.06352 |
| 5/16 | 0.3125 – 0.2929 | 7.94 – 7.44 | 1220.07942 |
| 3/8 | 0.3750 – 0.3556 | 9.53 – 9.03 | 1220.09532 |
| 7/16 | 0.4375 – 0.4177 | 11.11 – 10.61 | 1220.11112 |
| 1/2 | 0.5000 – 0.4803 | 12.70 – 12.20 | 1220.12702 |
| ER 20 Inch Metallic Sealed Collet Set | | | 1220.00002 |

Sizes listed with no clamping range are produced to maintain the lowest T.I.R. possible. Larger diameter collets have a 0.020" (0.5 mm) range.

Related Items

| | |
|----------|------------------|
| Wrenches | See page 13.01 |
| Nuts | See Section 4.00 |

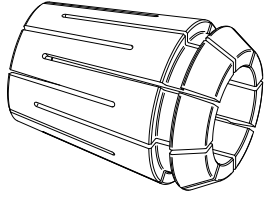

ER 25 DM | Metallic Sealed

For Coolant Through Tooling

Metric

| Clamping Capacity | | ER 25 DM Part No. |
|---|-----------------|-------------------|
| [mm] | [Inch] | |
| 6.00 | 0.2362 | 1225.06000 |
| 8.00 – 7.50 | 0.3150 – 0.2953 | 1225.08000 |
| 10.00 – 9.50 | 0.3937 – 0.3740 | 1225.10000 |
| 12.00 – 11.50 | 0.4724 – 0.4528 | 1225.12000 |
| 14.00 – 13.50 | 0.5512 – 0.5315 | 1225.14000 |
| 16.00 – 15.50 | 0.6300 – 0.6102 | 1225.16000 |
| ER 25 Metric Metallic Sealed Collet Set | | 1225.00000 |

Inch

| Ø [Inch] | Clamping Capacity | | ER 25 DM Part No. |
|---------------------------------------|-------------------|---------------|-------------------|
| | [Inch] | [mm] | |
| 1/4 | 0.2500 | 6.35 | 1225.06352 |
| 5/16 | 0.3125 – 0.2929 | 7.94 – 7.44 | 1225.07942 |
| 3/8 | 0.3750 – 0.3556 | 9.53 – 9.03 | 1225.09532 |
| 7/16 | 0.4375 – 0.4177 | 11.11 – 10.61 | 1225.11112 |
| 1/2 | 0.5000 – 0.4803 | 12.70 – 12.20 | 1225.12702 |
| 9/16 | 0.5625 – 0.5425 | 14.29 – 13.79 | 1225.14292 |
| 5/8 | 0.6250 – 0.6055 | 15.88 – 15.38 | 1225.15882 |
| ER 25 Inch Metallic Sealed Collet Set | | | 1225.00002 |

2

Sizes listed with no clamping range are produced to maintain the lowest T.I.R. possible. Larger diameter collets have a 0.020" (0.5 mm) range.

Related Items

| | |
|----------|------------------|
| Wrenches | See page 13.01 |
| Nuts | See Section 4.00 |



Swiss
Precision
Tools

ER

Metallic Sealed Collets

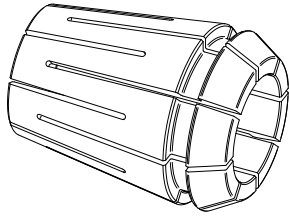

ER 32 DM | Metallic Sealed

For Coolant Through Tooling

Metric

Inch

2

| Clamping Capacity | | ER 32 DM Part No. |
|---|-----------------|----------------------|
| [mm] | [Inch] | |
| 6.00 | 0.2362 | 1232.06000 |
| 8.00 – 7.50 | 0.3150 – 0.2953 | 1232.08000 |
| 10.00 – 9.50 | 0.3937 – 0.3740 | 1232.10000 |
| 12.00 – 11.50 | 0.4724 – 0.4528 | 1232.12000 |
| 14.00 – 13.50 | 0.5512 – 0.5315 | 1232.14000 |
| 16.00 – 15.50 | 0.6300 – 0.6102 | 1232.16000 |
| 18.00 – 17.50 | 0.7087 – 0.6890 | 1232.18000 |
| 20.00 – 19.50 | 0.7874 – 0.7677 | 1232.20000 |
| ER 32 Metric Metallic Sealed Collet Set | | 1232.00000 |

| Ø [Inch] | Clamping Capacity | | ER 32 DM Part No. |
|---------------------------------------|-------------------|---------------|----------------------|
| | [Inch] | [mm] | |
| 1/4 | 0.2500 | 6.35 | 1232.06352 |
| 5/16 | 0.3125 – 0.2929 | 7.94 – 7.44 | 1232.07942 |
| 3/8 | 0.3750 – 0.3556 | 9.53 – 9.03 | 1232.09532 |
| 7/16 | 0.4375 – 0.4177 | 11.11 – 10.61 | 1232.11112 |
| 1/2 | 0.5000 – 0.4803 | 12.70 – 12.20 | 1232.12702 |
| 9/16 | 0.5625 – 0.5425 | 14.29 – 13.79 | 1232.14292 |
| 5/8 | 0.6250 – 0.6055 | 15.88 – 15.38 | 1232.15882 |
| 11/16 | 0.6875 – 0.6677 | 17.46 – 16.96 | 1232.17462 |
| 3/4 | 0.7500 – 0.7303 | 19.05 – 18.55 | 1232.19052 |
| ER 32 Inch Metallic Sealed Collet Set | | | 1232.00002 |

Sizes listed with no clamping range are produced to maintain the lowest T.I.R. possible. Larger diameter collets have a 0.020" (0.5 mm) range.

Related Items

| | |
|----------|------------------|
| Wrenches | See page 13.01 |
| Nuts | See Section 4.00 |

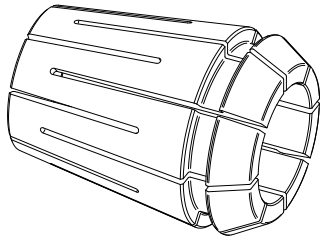

ER 40 DM | Metallic Sealed

For Coolant Through Tooling

Metric

| Clamping Capacity | | ER 40 DM Part No. |
|---|-----------------|-------------------|
| [mm] | [Inch] | |
| 6.00 | 0.2362 | 1240.06000 |
| 8.00 | 0.3150 | 1240.08000 |
| 10.00 – 9.50 | 0.3937 – 0.3740 | 1240.10000 |
| 12.00 – 11.50 | 0.4724 – 0.4528 | 1240.12000 |
| 14.00 – 13.50 | 0.5512 – 0.5315 | 1240.14000 |
| 16.00 – 15.50 | 0.6300 – 0.6102 | 1240.16000 |
| 18.00 – 17.50 | 0.7087 – 0.6890 | 1240.18000 |
| 20.00 – 19.50 | 0.7874 – 0.7677 | 1240.20000 |
| 22.00 – 21.50 | 0.8661 – 0.8465 | 1240.22000 |
| 24.00 – 23.50 | 0.9449 – 0.9252 | 1240.24000 |
| 25.00 – 24.50 | 0.9843 – 0.9646 | 1240.25000 |
| 26.00 – 25.50 | 1.0236 – 1.0039 | 1240.26000 |
| ER 40 Metric Metallic Sealed Collet Set | | 1240.00000 |

Select availability, please call for stock status

Inch

| Ø [Inch] | Clamping Capacity | | ER 40 DM Part No. |
|---------------------------------------|-------------------|---------------|-------------------|
| | [Inch] | [mm] | |
| 3/8 | 0.3750 – 0.3556 | 9.53 – 9.03 | 1240.09532 |
| 7/16 | 0.4375 – 0.4177 | 11.11 – 10.61 | 1240.11112 |
| 1/2 | 0.5000 – 0.4803 | 12.70 – 12.20 | 1240.12702 |
| 9/16 | 0.5625 – 0.5425 | 14.29 – 13.79 | 1240.14292 |
| 5/8 | 0.6250 – 0.6055 | 15.88 – 15.38 | 1240.15882 |
| 11/16 | 0.6875 – 0.6677 | 17.46 – 16.96 | 1240.17462 |
| 3/4 | 0.7500 – 0.7303 | 19.05 – 18.55 | 1240.19052 |
| 13/16 | 0.8125 – 0.7929 | 20.64 – 20.14 | 1240.20642 |
| 7/8 | 0.8750 – 0.8555 | 22.23 – 21.73 | 1240.22232 |
| 1 | 1.0000 – 0.9803 | 25.40 – 24.90 | 1240.25402 |
| ER 40 Inch Metallic Sealed Collet Set | | | 1240.00002 |

Sizes listed with no clamping range are produced to maintain the lowest T.I.R. possible. Larger diameter collets have a 0.020" (0.5 mm) range.

Related Items

| | |
|----------|------------------|
| Wrenches | See page 13.01 |
| Nuts | See Section 4.00 |



Swiss Precision Tools

PG Collets

Features | Benefits

2

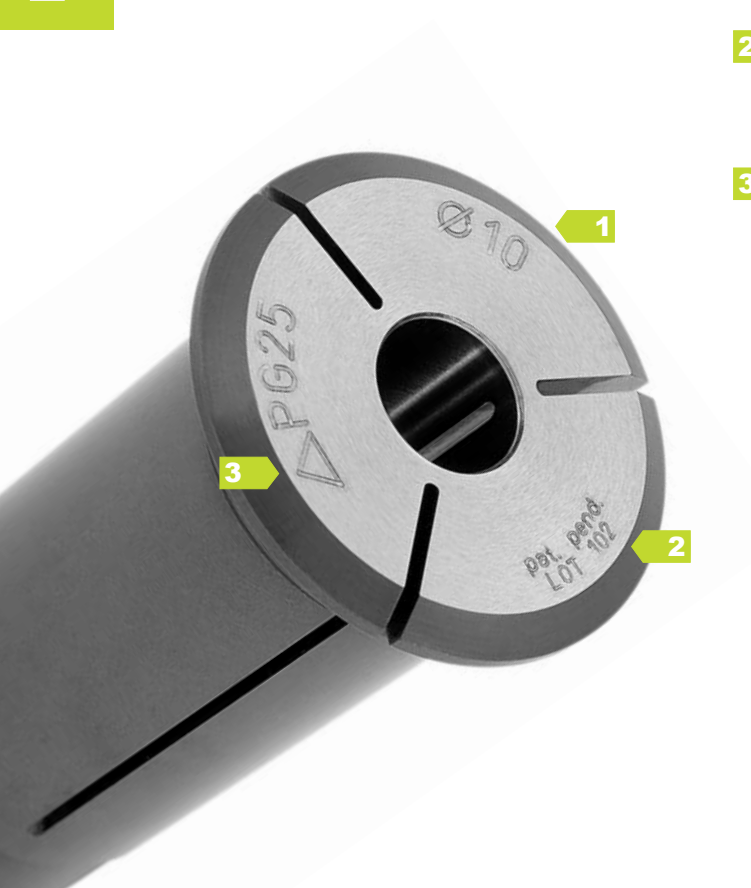

Swiss Quality

Made in Switzerland to ISO9001/ISO14001.

1

Marking

With type and size (reduces collet selection error).

2

Product Traceability

Lot numbers are marked on all products for traceability throughout the entire manufacturing process.

3

Original REGO-FIX®

When buying PG collets, please note the REGO-FIX® quality symbol Δ on the front of the collet.

Precision

Highest run-out accuracy 0.0001" (<3 μ m).

Accurate Length Adjustment <0.0004" (10 μ m)

With integrated adjustment screw.

Clamping of all h6 Tool Shanks

Cylindrical, WELDON and Whistle-Notch. (WELDON and Whistle-Notch shank tools will lessen clamping force.)

Clamping of all Shank Materials

Solid carbide and HSS tool shanks.

Clamping Diameters

0.0079"– 1.0" (0.2 to 25.4 mm)

Fast

Clamping in less than 10 seconds.

High Vibration Dampening

High vibration dampening due to the interrupted surfaces between the toolholder to collet and the collet to tool shank.

Highest Transferable Torque

The powRgrip® system yields the highest transferable torque of all comparable systems.

5 Year
WARRANTY
20,000
CYCLES

PG Standard Collets

Modern machining techniques like High Speed Cutting (HSC) and High Performance Cutting (HPC) require better toolholding systems. The powRgrip® system offers a unique combination of the best run-out, high clamping force and optimal vibration dampening. This system meets all requirements for the most efficient manufacturing process.

The REGO-FIX® powRgrip® system clamps cutting tools safely and with high precision. The tool and collet are pressed into the toolholder with forces as high as 9 tons by the powRgrip® hydraulic press. For unclamping the compression cycle is simply reversed.

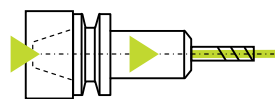
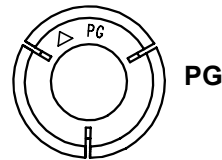

Metallically sealed for coolant through tools

PG-CF Coolant Flush Collets

Coolant flush collets direct coolant along the shank when working with tools without internal cooling channels.

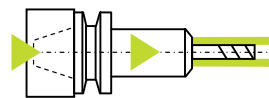
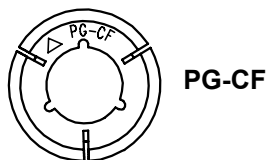

With coolant channels for peripheral cooling

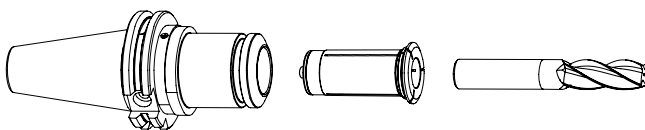

powRgrip® toolholder
different types available

exchangeable
powRgrip® collet

h6 cutting tool

Please note: PG-CF collets will have a decreased clamping force versus standard collets due to the reduced surface area contacting the tool shank.

For min/max clamping dimensions please see table on page 14.07



Clamp h6-tolerance tool shanks only!

Never clamp collet without tool.



Collet will be damaged!

MQL (Minimum Quantity Lubrication) compatible collets upon request.

Always use proper tool insertion depth of the cutting tool into the collet.

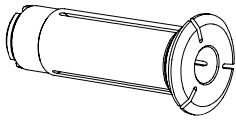

PG 10 | PG 10-CF | PG 10-MB

PG 10 Standard PG 10-CF Coolant Flush

2

Metric

| Ø [mm] | Ø [Inch] | PG 10 Part No. | PG 10-CF Part No. |
|--------|----------|----------------|-------------------|
| 2.000 | 0.0787 | 1710.02000 | – |
| 2.500 | 0.0984 | 1710.02500 | – |
| 3.000 | 0.1181 | 1710.03000 | 1710.03002 |
| 4.000 | 0.1575 | 1710.04000 | 1710.04002 |
| 5.000 | 0.1969 | 1710.05000 | 1710.05002 |
| 6.000 | 0.2362 | 1710.06000 | 1710.06002 |

Additional technical information on page 14.07

Inch

| Ø [Inch] | Ø [Inch] | Ø [mm] | PG 10 Part No. | PG 10-CF Part No. |
|----------|----------|--------|----------------|-------------------|
| 1/8 | 0.1250 | 3.175 | 1710.03181 | 1710.03183 |
| 3/16 | 0.1875 | 4.763 | 1710.04761 | 1710.04763 |
| 1/4 | 0.2500 | 6.350 | 1710.06351 | 1710.06353 |

Additional technical information on page 14.07

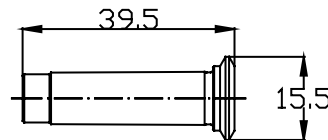
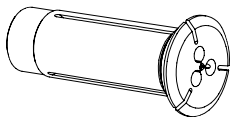

PG 10-MB Microbore (pat. pend.)

| Ø [mm] | Ø [Inch] | Ø [Inch] | PG 10-MB Part No. |
|--------|----------|----------|-------------------|
| 0.200 | 0.0079 | | 1710.00209 |
| 0.300 | 0.0118 | | 1710.00309 |
| 0.400 | 0.0157 | | 1710.00409 |
| 0.500 | 0.0197 | | 1710.00509 |
| 0.600 | 0.0236 | | 1710.00609 |
| 0.700 | 0.0276 | | 1710.00709 |
| 0.800 | 0.0315 | | 1710.00809 |
| 0.900 | 0.0354 | | 1710.00909 |
| 1.000 | 0.0394 | | 1710.01009 |
| 1.500 | 0.0591 | | 1710.01509 |
| 1.5875 | 0.0625 | 1/16" | 1710.01589 |

Additional technical information on page 14.07

PG collets do not have a clamping range. Nominal diameter only.

For special diameters please contact REGO-FIX® Customer Service.

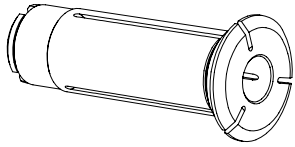

PG 15 | PG 15-CF

PG 15 Standard PG 15-CF Coolant Flush

Metric

| Ø [mm] | Ø [Inch] | PG 15 Part No. | PG 15-CF Part No. |
|-----------|-------------|-------------------|----------------------|
| 3.000 | 0.1181 | 1715.03000 | 1715.03002 |
| 4.000 | 0.1575 | 1715.04000 | 1715.04002 |
| 5.000 | 0.1969 | 1715.05000 | 1715.05002 |
| 6.000 | 0.2362 | 1715.06000 | 1715.06002 |
| 7.000 | 0.2756 | 1715.07000 | 1715.07002 |
| 8.000 | 0.3150 | 1715.08000 | 1715.08002 |
| 9.000 | 0.3543 | 1715.09000 | 1715.09002 |
| 10.000 | 0.3937 | 1715.10000 | 1715.10002 |

Additional technical information on page 14.07

Inch

| Ø [Inch] | Ø [Inch] | Ø [mm] | PG 15 Part No. | PG 15-CF Part No. |
|-------------|-------------|-----------|-------------------|----------------------|
| 1/8 | 0.1250 | 3.175 | 1715.03181 | 1715.03183 |
| 3/16 | 0.1875 | 4.763 | 1715.04761 | 1715.04763 |
| 1/4 | 0.2500 | 6.350 | 1715.06351 | 1715.06353 |
| 5/16 | 0.3125 | 7.938 | 1715.07941 | 1715.07943 |
| 3/8 | 0.3750 | 9.525 | 1715.09521 | 1715.09523 |

Additional technical information on page 14.07

2

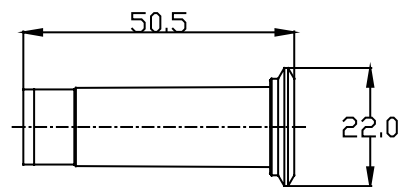

! PG collets do not have a clamping range.
Nominal diameter only.

■ For special diameters please contact
REGO-FIX® Customer Service.



Swiss Precision Tools

PG Collets

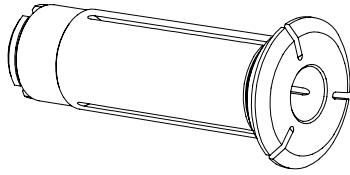

PG 25 | PG 25-CF

PG 25 Standard PG 25-CF Coolant Flush

2

Metric

| Ø [mm] | Ø [Inch] | PG 25 Part No. | PG 25-CF Part No. |
|--------|----------|----------------|-------------------|
| 3.000 | 0.1181 | 1725.03000 | 1725.03002 |
| 4.000 | 0.1575 | 1725.04000 | 1725.04002 |
| 5.000 | 0.1969 | 1725.05000 | 1725.05002 |
| 6.000 | 0.2362 | 1725.06000 | 1725.06002 |
| 7.000 | 0.2756 | 1725.07000 | 1725.07002 |
| 8.000 | 0.3150 | 1725.08000 | 1725.08002 |
| 9.000 | 0.3543 | 1725.09000 | 1725.09002 |
| 10.000 | 0.3937 | 1725.10000 | 1725.10002 |
| 11.000 | 0.4331 | 1725.11000 | 1725.11002 |
| 12.000 | 0.4724 | 1725.12000 | 1725.12002 |
| 14.000 | 0.5512 | 1725.14000 | 1725.14002 |
| 16.000 | 0.6300 | 1725.16000 | 1725.16002 |
| 18.000 | 0.7087 | 1725.18000 | 1725.18002 |
| 20.000 | 0.7874 | 1725.20000 | 1725.20002 |

Additional technical information on page 14.07

Inch

| Ø [Inch] | Ø [Inch] | Ø [mm] | PG 25 Part No. | PG 25-CF Part No. |
|----------|----------|--------|----------------|-------------------|
| 1/8 | 0.1250 | 3.175 | 1725.03181 | 1725.03183 |
| 3/16 | 0.1875 | 4.763 | 1725.04761 | 1725.04763 |
| 1/4 | 0.2500 | 6.350 | 1725.06351 | 1725.06353 |
| 5/16 | 0.3125 | 7.938 | 1725.07941 | 1725.07943 |
| 3/8 | 0.3750 | 9.525 | 1725.09521 | 1725.09523 |
| 7/16 | 0.4375 | 11.113 | 1725.11111 | 1725.11113 |
| 1/2 | 0.5000 | 12.700 | 1725.12701 | 1725.12703 |
| 9/16 | 0.5625 | 14.288 | 1725.14291 | 1725.14293 |
| 5/8 | 0.6250 | 15.875 | 1725.15881 | 1725.15883 |
| 3/4 | 0.7500 | 19.050 | 1725.19051 | 1725.19053 |

Additional technical information on page 14.07

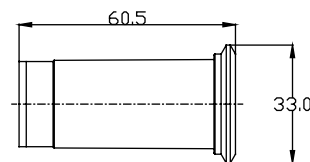

PG collets do not have a clamping range. Nominal diameter only.



For special diameters please contact REGO-FIX® Customer Service.

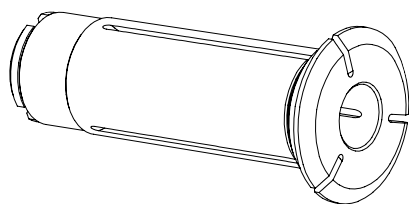

PG 32 | PG 32-CF

PG 32 Standard PG 32-CF Coolant Flush

Metric

| Ø [mm] | Ø [Inch] | PG 32 Part No. | PG 32-CF Part No. |
|-----------|-------------|-------------------|----------------------|
| 6.000 | 0.2362 | 1732.06000 | 1732.06002 |
| 7.000 | 0.2756 | 1732.07000 | 1732.07002 |
| 8.000 | 0.3150 | 1732.08000 | 1732.08002 |
| 9.000 | 0.3543 | 1732.09000 | 1732.09002 |
| 10.000 | 0.3937 | 1732.10000 | 1732.10002 |
| 11.000 | 0.4331 | 1732.11000 | 1732.11002 |
| 12.000 | 0.4724 | 1732.12000 | 1732.12002 |
| 14.000 | 0.5512 | 1732.14000 | 1732.14002 |
| 16.000 | 0.6300 | 1732.16000 | 1732.16002 |
| 18.000 | 0.7087 | 1732.18000 | 1732.18002 |
| 20.000 | 0.7874 | 1732.20000 | 1732.20002 |
| 22.000 | 0.8661 | 1732.22000 | 1732.22002 |
| 25.000 | 0.9843 | 1732.25000 | 1732.25002 |

Additional technical information on page 14.07

Inch

| Ø [Inch] | Ø [Inch] | Ø [mm] | PG 32 Part No. | PG 32-CF Part No. |
|-------------|-------------|-----------|-------------------|----------------------|
| 1/4 | 0.2500 | 6.350 | 1732.06351 | 1732.06353 |
| 5/16 | 0.3125 | 7.938 | 1732.07941 | 1732.07943 |
| 3/8 | 0.3750 | 9.525 | 1732.09521 | 1732.09523 |
| 7/16 | 0.4375 | 11.113 | 1732.11111 | 1732.11113 |
| 1/2 | 0.5000 | 12.700 | 1732.12701 | 1732.12703 |
| 9/16 | 0.5625 | 14.288 | 1732.14291 | 1732.14293 |
| 5/8 | 0.6250 | 15.875 | 1732.15881 | 1732.15883 |
| 3/4 | 0.7500 | 19.050 | 1732.19051 | 1732.19053 |
| 7/8 | 0.8750 | 22.225 | 1732.22231 | 1732.22233 |
| 1 | 1.0000 | 25.400 | 1732.25401 | 1732.25403 |

Additional technical information on page 14.07

2

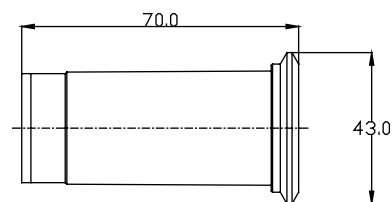

PG collets do not have a clamping range.
Nominal diameter only.

For special diameters please contact
REGO-FIX® Customer Service.



Swiss
Precision
Tools

HS

Reduction Sleeves

Features | Benefits

2

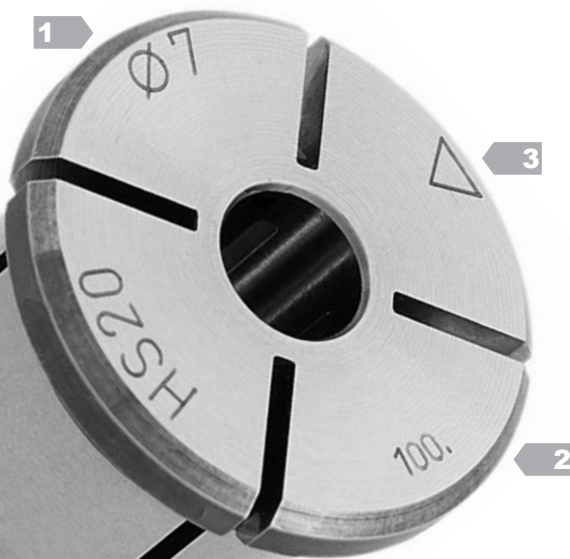

Swiss Quality

Made in Switzerland to ISO9001/ISO14001.

1

Marking

With type and size (reduces collet selection error).

2

Product Traceability

Lot numbers are marked on all products for traceability throughout the entire manufacturing process.

3

Original REGO-FIX®

When buying PG collets, please note the REGO-FIX® quality symbol \triangle on the front of the collet.

Precision

Highest run-out accuracy 0.0001" ($<3\ \mu\text{m}$).

Increased Clamping Force

Using REGO-FIX® reduction sleeves.

See graph on page 2.29

Flexibility

Clamping of different tool shank diameters in hydro-chucks. 4 standard sizes: 12, 20, 25, and 32 mm

Coolant Through Tools

Metal-to-metal seal for cutting tools with internal coolant channels.

Reduction Sleeves for Hydro-Chucks

REGO-FIX® reduction sleeves are designed to fit hydraulic toolholders of different manufacturers. They are specially suited for high precision clamping of cylindrical tool shanks.

For concentricity (T.I.R.) of REGO-FIX® high precision reduction sleeves, see graph on next page.

The special design of REGO-FIX® reduction sleeves allows the use of coolant through cutting tools. This self sealing system works with most common hydraulic toolholders.

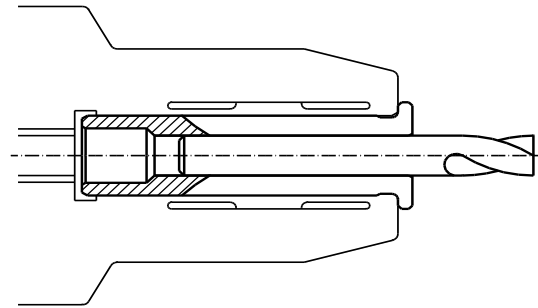

2



Improper assembly will damage the concentricity of the reduction sleeve.

■ Insert tools the full length of the reduction sleeve.

Only clamp h6 tool shanks.

Do not clamp reduction sleeve without a tool.

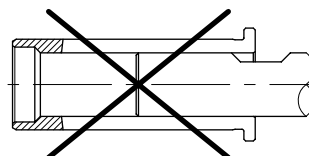
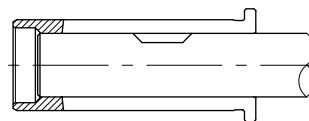
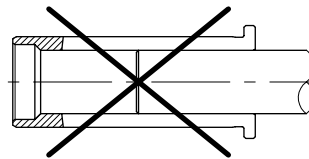
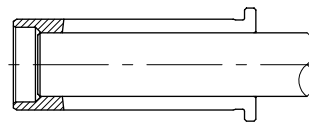

Concentricity T.I.R.

2

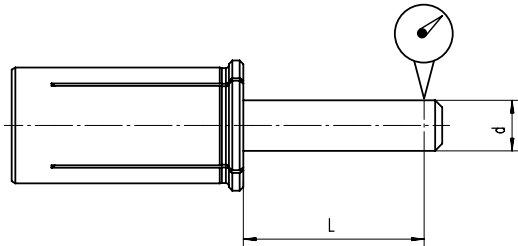

Concentricity (T.I.R.) of HS Type Reduction Sleeves

| Clamping Diameter | | | T.I.R. max. |
|-------------------|--------------|--------|--------------------|
| Above d [mm] | Up to d [mm] | L [mm] | |
| 3.0 | 6.0 | 16.0 | 0.0001" (0.003 mm) |
| 6.0 | 10.0 | 25.0 | 0.0001" (0.003 mm) |
| 10.0 | 18.0 | 40.0 | 0.0001" (0.003 mm) |
| 18.0 | 26.0 | 50.0 | 0.0001" (0.003 mm) |

Comparison of Transferable Torque at Ø 20 mm

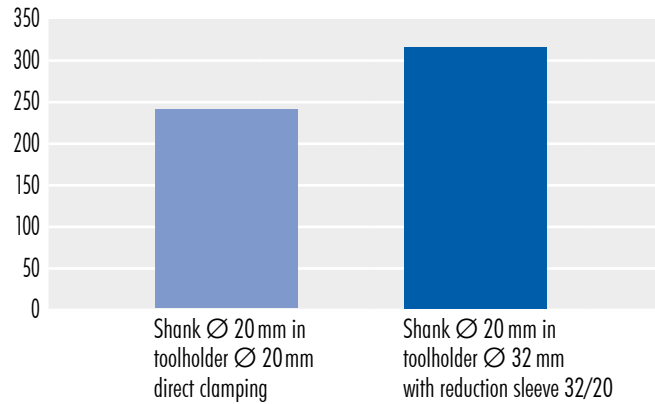

When using reduction sleeves the transferable torque is increased.

Matching Products

Extractor

The extractor helps to remove the reduction sleeve from the hydro-chuck.

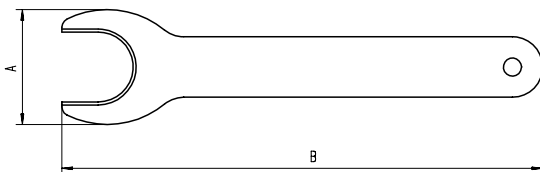

| Extractor | Part No. | For Sizes | A [mm] | B [mm] |
|-----------|------------|-----------|--------|--------|
| EHS 12 | 7321.12000 | HS 12 | 24.6 | 100 |
| EHS 20 | 7321.20000 | HS 20 | 38.0 | 160 |
| EHS 25 | 7321.25000 | HS 25 | 51.0 | 180 |
| EHS 32 | 7321.32000 | HS 32 | 63.0 | 200 |

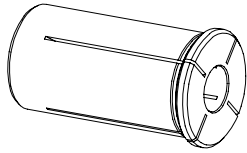

HS 12 | 20 | 25 | 32

Reduction Sleeves

Metric

| Ø Bore [mm] | HS 12 (12mm O.D.) Part No. | HS 20 (20mm O.D.) Part No. | HS 25 (25mm O.D.) Part No. | HS 32 (32mm O.D.) Part No. |
|-------------|----------------------------|----------------------------|----------------------------|----------------------------|
| 3.000 | 1912.03000 | 1920.03000 | 1925.03000 | – |
| 4.000 | 1912.04000 | 1920.04000 | 1925.04000 | – |
| 5.000 | 1912.05000 | 1920.05000 | 1925.05000 | 1932.05000 |
| 6.000 | 1912.06000 | 1920.06000 | 1925.06000 | 1932.06000 |
| 7.000 | 1912.07000 | 1920.07000 | 1925.07000 | 1932.07000 |
| 8.000 | 1912.08000 | 1920.08000 | 1925.08000 | 1932.08000 |
| 9.000 | 1912.09000 | 1920.09000 | 1925.09000 | 1932.09000 |
| 10.000 | 1912.10000 | 1920.10000 | 1925.10000 | 1932.10000 |
| 11.000 | – | 1920.11000 | – | 1932.11000 |
| 12.000 | – | 1920.12000 | 1925.12000 | 1932.12000 |
| 13.000 | – | 1920.13000 | – | 1932.13000 |
| 14.000 | – | 1920.14000 | 1925.14000 | 1932.14000 |
| 15.000 | – | 1920.15000 | – | 1932.15000 |
| 16.000 | – | 1920.16000 | 1925.16000 | 1932.16000 |
| 17.000 | – | – | – | 1932.17000 |
| 18.000 | – | 1920.18000 | 1925.18000 | 1932.18000 |
| 19.000 | – | – | – | 1932.19000 |
| 20.000 | – | – | 1925.20000 | 1932.20000 |
| 22.000 | – | – | – | 1932.22000 |
| 25.000 | – | – | – | 1932.25000 |

Inch

| Ø Bore [Inch] | HS 12 (12mm O.D.) Part No. | HS 20 (20mm O.D.) Part No. | HS 25 (25mm O.D.) Part No. | HS 32 (32mm O.D.) Part No. |
|---------------|----------------------------|----------------------------|----------------------------|----------------------------|
| 1/8" | 1912.03181 | 1920.03181 | 1925.03181 | – |
| 3/16" | 1912.04761 | 1920.04761 | 1925.04761 | 1932.04761 |
| 1/4" | 1912.06351 | 1920.06351 | 1925.06351 | 1932.06351 |
| 5/16" | 1912.07941 | 1920.07941 | 1925.07941 | 1932.07941 |
| 3/8" | 1912.09521 | 1920.09521 | 1925.09521 | 1932.09521 |
| 7/16" | – | 1920.11111 | 1925.11111 | 1932.11111 |
| 1/2" | – | 1920.12701 | 1925.12701 | 1932.12701 |
| 9/16" | – | 1920.14291 | 1925.14291 | 1932.14291 |
| 5/8" | – | 1920.15881 | 1925.15881 | 1932.15881 |
| 11/16" | – | – | 1925.17461 | 1932.17461 |
| 3/4" | – | – | 1925.19051 | 1932.19051 |
| 13/16" | – | – | 1925.20631 | 1932.20631 |
| 7/8" | – | – | – | 1932.22221 |
| 15/16" | – | – | – | 1932.23811 |
| 1" | – | – | – | 1932.25401 |

Additional technical information on page
14.09/14.10