

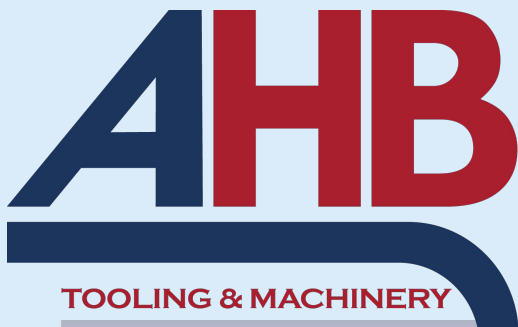

WELER CHUCK

High Clamping Force
plus Low to No Runout

Made for Heavy Milling (Axial and Radial)
or Precision Drilling, Reaming, Threading.



**COMPLETE
METALWORKING
SOLUTIONS**

(800) 991-4225

www.ahbinc.com

ISO Certified

customerservice@ahbinc.com



scm-america.com

WELER CHUCK

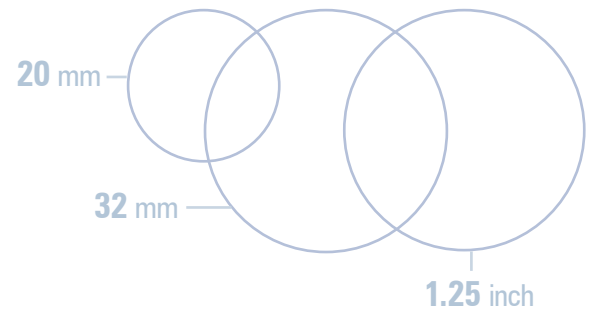

**Balanced to G2.5
at 20,000 RPM's**

**Over 380 FT/LB
of Clamping Force**

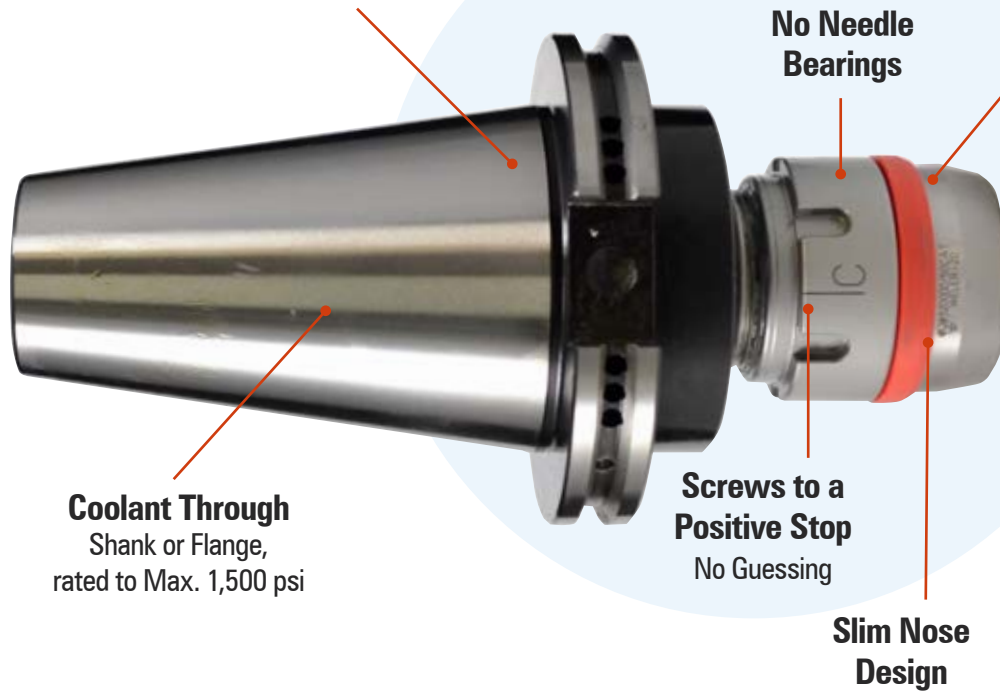

**0.0001" Runout
(TIR) at 2.5x Diameter**

Weler Chuck Size	Runout (TIR) at 2.5x Diam.		Clamping Force	
	mm	inch	Nm	ft/lbs
20mm	0.003	0.0001"	520	384
32mm	0.004	0.0002"	600	443
1-1/4	0.004	0.0002"	600	443

Clamping Force is achieved through a unique taper on taper design that utilizes mechanical deformation.

Comparing Toolholders

	End Mill Holder	ER Collet Chuck	Weler Chuck	Hydraulic Chuck	Milling Chuck
Accuracy Toolholder precision based on runout and repeatability at the tool tip	★★★★★	★★★★★	★★★★★	★★★★★	★★★★★
Versatility The ability to clamp multiple tool shank sizes	★★★★★	★★★★★	★★★★★	★★★★★	★★★★★
Reliability Achieves maximum results consistently with little maintenance	★★★★★	★★★★★	★★★★★	★★★★★	★★★★★
Speed Ability to run at high RPM out of the box	★★★★★	★★★★★	★★★★★	★★★★★	★★★★★
Assembly Ease of use to assemble and disassemble the cutting tool	★★★★★	★★★★★	★★★★★	★★★★★	★★★★★
Clamping Force Maximum clamping torque to secure the tool	★★★★★	★★★★★	★★★★★	N/A Not designed for radial applications	★★★★★
Milling Requires low runout & enough clamping force to safely hold the tool	★★★★★	★★★★★	★★★★★	N/A Not designed for radial applications	★★★★★
Thread Milling Requires low runout & enough clamping force to safely hold tool	★★★★★	★★★★★	★★★★★	N/A Not designed for radial applications	★★★★★
Drilling Requires low runout for maximum tool life and part finish	★★★★★	★★★★★	★★★★★	★★★★★	★★★★★
Indexable Tools Requires low runout & enough clamping force to safely hold tool	★★★★★	★★★★★	★★★★★	N/A Not designed for radial applications	★★★★★
Reaming Requires low runout for maximum tool life and part finish	★★★★★	★★★★★	★★★★★	★★★★★	★★★★★
Overall Rating Average of scores in each category	2.5 ★★★★★	3.4 ★★★★★	4.7 ★★★★★	2.9 ★★★★★	2.4 ★★★★★

**CERTIFIED
ACCURACY**

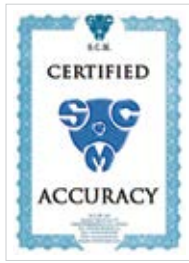

All Weler Chucks are
100% Inspected,
assigned a serial number
and values are recorded
on each Certificate.



CAT 40/50 Form AD Coolant through Shank

EDP	Part Number	Taper	d	D	D1	L	L1	Price
15021B	520000/40CAT	40	20mm	1.81	1.929	3.54	0.906	\$425.85
15023B	532000/40CAT	40	32mm	2.64	2.677	4.13	1.299	\$434.97
51001B	531700/40CAT	40	1-1/4"	2.64	2.677	4.13	1.299	\$504.45
15029B	520000/50CAT	50	20mm	1.81	1.929	3.54	0.906	\$475.19
15031B	532000/50CAT	50	32mm	2.64	2.677	4.05	1.299	\$489.80

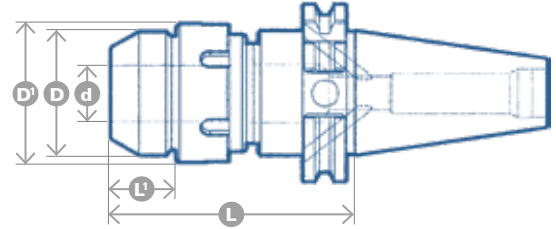

CAT 40/50 Form B Coolant through Flange

EDP	Part Number	Taper	d	D	D1	L	L1	Price
51002B	520000/40CAT-B	40	20mm	1.81	1.929	3.54	0.906	\$480.68
51003B	532000/40CAT-B	40	32mm	2.64	2.677	4.13	1.299	\$489.80
51004B	520000/50CAT-B	50	20mm	1.81	1.929	3.54	0.906	\$560.28
51005B	532000/50CAT-B	50	32mm	2.64	2.677	4.05	1.299	\$575.74

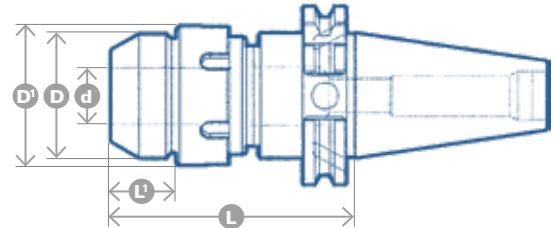

MAS 403 BT

EDP	Part Number	Taper	d	D	D1	L	L1	Price
15067B	520000/30BT	30	20mm	1.81	1.947	3.54	0.306	\$510.05
15037B	520000/40BT	40	20mm	2.64	1.929	3.54	0.906	\$442.31
15039B	532000/40BT	40	32mm	2.64	2.677	3.74	1.299	\$447.80
15045B	520000/50BT	50	20mm	1.81	1.929	3.94	0.306	\$517.78
15047B	532000/50BT	50	32mm	2.64	2.677	4.33	1.299	\$488.80

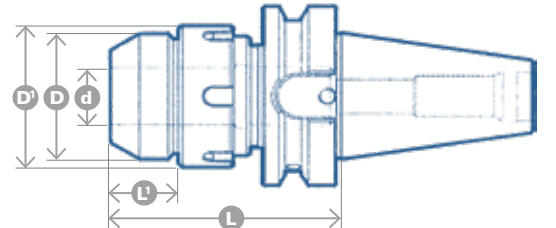

HSK

EDP	Part Number	Taper	d	D	D1	L	L1	Price
15137B	520000/H40E	40E	20mm	1.81	1.929	3.66	0.906	\$637.56
15068B	520000/H50A	50A	20mm	1.81	1.929	3.94	0.906	\$603.13
15138B	520000/H50E	50E	20mm	1.81	1.929	4.00	0.906	\$637.56
15005B	520000/H63A	63A	20mm	1.81	1.929	3.98	0.906	\$480.68
15007B	532000/H63A	63A	32mm	2.64	2.677	4.45	1.299	\$608.95
15012B	520000/H63E	63E	20mm	1.81	1.929	3.82	0.906	\$508.12
15014B	532000/H63E	63E	32mm	2.64	2.677	4.45	1.299	\$517.78
15105B	520000/H100A	100A	20mm	1.81	1.929	4.33	1.299	\$685.40
15164B	532000/H100A	100A	32mm	2.64	2.677	4.33	1.299	\$763.14

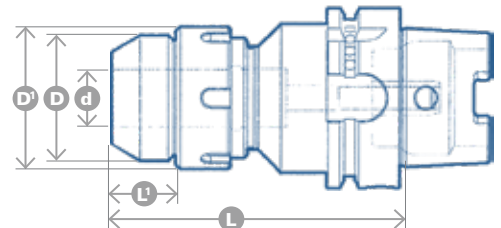

SIMPLE MAINTENANCE

To ensure the proper performance and maximum life of the Weler Chuck, **grease must be applied as needed to the threads and taper** that the tapered locking nut is fastened to. This will prevent the occurrence of any galling from the metal on metal contact. This is the only maintenance required as there are no wear parts during the normal recommended use of the Weler Chuck. One tube of grease is included with every chuck.

Reduction Sleeve



INCH TOOL SIZES

1-1/4" Diameter Reduction Sleeve

EDP	Part Number	SHANK (d)
15300A	9020.1-1/4.1/4	1/4
15301A	9020.1-1/4.5/16	5/16
15302A	9020.1-1/4.3/8	3/8
15303A	9020.1-1/4.1/2	1/2
15304A	9020.1-1/4.5/8	5/8
15305A	9020.1-1/4.3/4	3/4
15306A	9020.1-1/4.7/8	7/8
15307A	9020.1-1/4.1	1

20mm Diameter Reduction Sleeve

EDP	Part Number	SHANK (d)
15050A	9020.20.1/8	1/8
15051A	9020.20.3/16	3/16
15052A	9020.20.1/4	1/4
15053A	9020.20.5/16	5/16
15049A	9020.20.3/8	3/8
15054A	9020.20.7/16	7/16
15055A	9020.20.1/2	1/2
15056A	9020.20.5/8	5/8

32mm Diameter Reduction Sleeve

EDP	Part Number	SHANK (d)
15057A	9020.32.1/4	1/4
15058A	9020.32.5/16	5/16
15065A	9020.32.3/8	3/8
15059A	9020.32.7/16	7/16
15060A	9020.32.1/2	1/2
15061A	9020.32.5/8	5/8
15062A	9020.32.3/4	3/4
15063A	9020.32.7/8	7/8
15064A	9020.32.1	1

Quality Tool Imports LLC
 www.qtimports.com
 sales@qtimports.com
 (220) 666-0911
 601 Pittsburgh Avenue D
 Mount Vernon, OH 43050

METRIC TOOL SIZES

20mm Diameter Reduction Sleeve

EDP	Part Number	SHANK (d)	L	Price
15070A	9020.20.03	3mm	1.96"	\$82.26
15071A	9020.20.04	4mm	1.96"	\$82.26
15072A	9020.20.05	5mm	1.96"	\$82.26
15073A	9020.20.06	6mm	1.96"	\$82.26
15074A	9020.20.08	8mm	1.96"	\$82.26
15075A	9020.20.10	10mm	1.96"	\$82.26
15095A	9020.20.11	11mm	1.96"	\$86.94
15076A	9020.20.12	12mm	1.96"	\$82.26
15077A	9020.20.14	14mm	1.96"	\$82.26
15089A	9020.20.15	15mm	1.96"	\$112.06
15078A	9020.20.16	16mm	1.96"	\$82.26
15090A	9020.20.18	18mm	1.96"	\$81.14

32mm Diameter Reduction Sleeve

EDP	Part Number	SHANK (d)	L	Price
15079A	9020.32.06	6mm	2.48"	\$95.05
15080A	9020.32.08	8mm	2.48"	\$95.05
15081A	9020.32.10	10mm	2.48"	\$95.05
15082A	9020.32.12	12mm	2.48"	\$95.05
15083A	9020.32.14	14mm	2.48"	\$95.05
15084A	9020.32.16	16mm	2.48"	\$95.05
15085A	9020.32.18	18mm	2.48"	\$95.05
15086A	9020.32.20	20mm	2.48"	\$95.05
15092A	9020.32.22	22mm	2.48"	\$92.74
15087A	9020.32.24	24mm	2.48"	\$95.05
15088A	9020.32.25	25mm	2.48"	\$95.05

Reduction Sleeve Extractor
 for 20mm & 32mm
EDP: 15178A
\$31.88



20mm Sleeve
 Extractor
EDP: 15179A
\$21.95



Weler Grease
EDP: 15069A
\$6.95



Wrench

EDP	Size	Price
15048A	20mm	\$31.88
15904A	32mm	\$39.95



Leverage Wrench

P15048A	Extended 20mm	\$31.88
P15904A	Extended 32mm	\$39.95

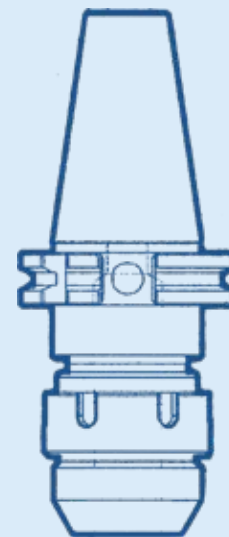

Weler
Chuck



Reduction
Sleeve



Tool