

SOWA

TOOLING
YOUR
WORLD.

AHB

TOOLING & MACHINERY

COMPLETE METALWORKING SOLUTIONS

(800) 991-4225

www.ahbinc.com

ISO Certified

customerservice@ahbinc.com



Collet Chucks & Collets



CAT40/50 ER Collet Chucks	4-5
BT/HSK/NMTB Collet Chucks	6-7
ER Collets	8-18
SA Collet Chucks & Collets	19-20
TG Collet Chucks & Collets	20-24
Milling Chucks & Collets	24-25
DA Collet Chucks & Collets	25-28
Retention Knobs	30

Sowa Tool has been serving the metalworking industry since 1960.

Your world is full of challenges and worrying about having the right tools for the job should not be one of them. With a three-generation legacy of family-style customer service, Sowa Tool & Machine has been trusted by manufacturers and distributors throughout North America to supply some of the industry's best metalworking solutions since 1960.

Our mission has been and continues to be to provide the broadest range of metalworking solutions in the industry. We accomplish this through the continuous development of our family of brands that include items within the Tool Holding, Workholding, Measuring & Inspecting, and Cutting Tool categories. This allows you to secure all these solutions from one place, reducing your total number of purchase orders and consolidating your freight charges in this increasingly expensive market.

Our wide array of metalworking products come in stock with same-day shipping if ordered before 3:00 pm EST. Our customer service team is just a call or click away, available to offer technical help or source hard-to-find products. Over the decades we've fine-tuned the balance between inventory, pricing and customer service, and can help you select precisely what you need to get the job done right. Our manufactured products are designed to meet the highest quality standards or provide the best price on the market, sometimes both!

26,000+

INDUSTRIAL PRODUCTS

6

INDUSTRY BRANDS

1960

YEAR FOUNDED

5

WAREHOUSES

90+

ASSOCIATES

23,000+

STOCKED SKU'S IN THE USA



**Depend on us to tool your world and deliver
the competitive edge your business needs to stay ahead!**

SOWA NOW HAS TWO HOLDER OPTIONS:



Which one works best for your application?

NEW

STM PREMIUM

The perfect economic tooling solution for general purpose machining applications.

VS

GS TOOLING

Superior tooling performance when speed and accuracy matter most.

42CrMo	Material Grade	16NiCr4 (Premium European Alloy Steel)
AT3 or better (0.00024-0.00036in/ft)	Taper Accuracy	AT2 or better (0.00012-0.00024in/ft)
0.0002"	Runout Accuracy	0.0001"
CAT40 End Mill Holders: Balanced to G2.5 / 8,000rpm CAT50 End Mill Holders: Balanced to G2.5 / 6,000rpm	Balance	CAT40 End Mill Holders: Balanced to G6.3 / 30,000rpm CAT50 End Mill Holders: Balanced to G6.3 / 25,000rpm
CAT40 Collet Chucks: Balanced to G2.5 / 20,000rpm CAT50 Collet Chucks: Balanced to G2.5 / 15,000rpm	Coolant Features	CAT40 Collet Chucks: Balanced to G2.5 / 30,000rpm CAT50 Collet Chucks: Balanced to G2.5 / 25,000rpm
AD/B DIN coolant through flange	Thread Tolerance	H4 = basic plus 0.0015-0.0020" (premium class of fit)
H6 = basic plus 0.0025-0.0030" (standard class of fit)	SKU Offering	Wide selection
Limited to the most popular items		

Collet Chucks & Collets

CAT40 ER Collet Chucks



- DIN coolant option - standard
- All ground body
- Factory balanced to save spindle life, tool life and increased productivity
- Threaded through holes for a back-up screw (tool stop) or coolant through when removed
- TIR, 0.0003" at 4xDia.
- Wrench not included
- RFID Chip Hole
- AT2 Taper Accuracy

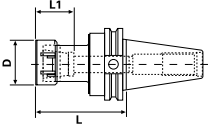

PREMIUM BALANCE
G2.5 at 30,000rpm
CERTIFICATE INCLUDED

Taper	Collet Series	Collet Range	L	L1	D	Tightening Torque (Nm)	Code No.
CT40	ER11**	0.019-0.275	2.50	0.65	0.75	29.8	531400
CT40	ER11**	0.019-0.275	4.00	0.65	0.75	29.8	531402
CT40	ER11**	0.019-0.275	6.00	0.65	0.75	29.8	531404
CT40	ER16**	0.019-0.406	2.50	0.87	1.26	56.9	531406
CT40	ER16**	0.019-0.406	3.50	0.87	1.26	56.9	531408
CT40	ER16**	0.019-0.406	4.00	0.87	1.26	56.9	531405
CT40	ER16**	0.019-0.406	6.00	0.87	1.26	56.9	531410
CT40	ER16**	0.019-0.406	9.00	0.87	1.26	56.9	531411
CT40	ER20**	0.039-0.511	2.50	1.06	1.38	81.3	531412
CT40	ER20**	0.039-0.511	4.00	1.06	1.38	81.3	531414
CT40	ER20**	0.039-0.511	6.00	1.06	1.38	81.3	531416
CT40	ER20**	0.039-0.511	9.00	1.06	1.38	81.3	531417
CT40	ER25	0.039-0.629	2.50	1.18	1.65	128.8	531418
CT40	ER25	0.039-0.629	4.00	1.18	1.65	128.8	531420
CT40	ER25	0.039-0.629	6.00	1.18	1.65	128.8	531422
CT40	ER32	0.078-0.787	0.750				531401*
CT40	ER32	0.078-0.787	2.50	1.34	1.97	169.5	531421
CT40	ER32	0.078-0.787	3.13	1.34	1.97	169.5	531424
CT40	ER32	0.078-0.787	4.00	1.34	1.97	169.5	531423
CT40	ER32	0.078-0.787	5.00	1.34	1.97	169.5	531426
CT40	ER32	0.078-0.787	6.00	1.34	1.97	169.5	531425
CT40	ER32	0.078-0.787	9.00	1.34	1.97	169.5	531419
CT40	ER40	0.118-1.023	2.50	1.50	2.48	219.6	531427
CT40	ER40	0.118-1.023	3.13	1.50	2.48	219.6	531428
CT40	ER40	0.118-1.023	4.00	1.50	2.48	219.6	531429
CT40	ER40	0.118-1.023	5.00	1.50	2.48	219.6	531430
CT40	ER40	0.118-1.023	6.00	1.50	2.48	219.6	531431

* ER Shorty collet chuck, Not DIN coolant ** Hex Nut

STM CAT40 ER Collet Chucks



- DIN coolant option - standard
- Factory balanced to save spindle life, tool life and increased productivity
- TIR, 0.0002" at 4xDia.
- Wrench not included
- AT2 Taper Accuracy
- RFID Chip Hole

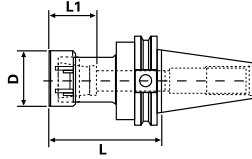

BALANCE CERTIFICATE
G2.5 at 20,000rpm
INCLUDED

Taper	Collet Series	Collet Range	L	L1	D	Code No.
CT40	ER11*	0.019-0.275"	2.50"	0.65"	0.75"	525400
CT40	ER11*	0.019-0.275"	4.00"	0.65"	0.75"	525402
CT40	ER11*	0.019-0.275"	6.00"	0.65"	0.75"	525404
CT40	ER16*	0.019-0.413"	2.50"	0.87"	1.26"	525406
CT40	ER16*	0.019-0.413"	3.50"	0.87"	1.26"	525408
CT40	ER16*	0.019-0.413"	4.00"	0.87"	1.26"	525405
CT40	ER16*	0.019-0.413"	6.00"	0.87"	1.26"	525410
CT40	ER20*	0.019-0.551"	2.50"	1.06"	1.38"	525412
CT40	ER20*	0.019-0.551"	4.00"	1.06"	1.38"	525414
CT40	ER20*	0.019-0.551"	6.00"	1.06"	1.38"	525416
CT40	ER25	0.059-0.675"	2.50"	1.18"	1.65"	525418
CT40	ER25	0.059-0.675"	4.00"	1.18"	1.65"	525420
CT40	ER32	0.078-0.787"	2.50"	1.34"	1.97"	525421
CT40	ER32	0.078-0.787"	3.13"	1.34"	1.97"	525424
CT40	ER32	0.078-0.787"	4.00"	1.34"	1.97"	525423
CT40	ER32	0.078-0.787"	6.00"	1.34"	1.97"	525425

* Hex Nut

CAT40 DUAL CONTACT ER Collet Chucks



- Improves rigidity and reduces vibration allowing for increased feed rates and increased tool life
- DIN coolant option - standard
- All ground body
- TIR, 0.0003" at 4xDia.
- AT2 Taper Accuracy
- RFID Chip Hole



FOR DUAL CONTACT SPINDLES

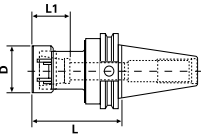

PREMIUM BALANCE
G2.5 at 30,000rpm
CERTIFICATE INCLUDED

Taper	Collet Series	Collet Range	L	L1	D	Tightening Torque (Nm)	Code No.
CT40	ER11**	0.019-0.275	2.50	0.65	0.75	29.8	521630
CT40	ER11**	0.019-0.275	4.00	0.65	0.75	29.8	521632
CT40	ER11**	0.019-0.275	6.00	0.65	0.75	29.8	521634
CT40	ER16**	0.019-0.406	2.50	0.87	1.26	56.9	521406
CT40	ER16**	0.019-0.406	4.00	0.87	1.26	56.9	521405
CT40	ER16**	0.019-0.406	6.00	0.87	1.26	56.9	521410
CT40	ER20**	0.039-0.511	4.00	1.06	1.38	81.3	521646
CT40	ER32	0.078-0.787	2.50	1.34	1.97	169.5	521656
CT40	ER32	0.078-0.787	3.13	1.34	1.97	169.5	521424
CT40	ER32	0.078-0.787	4.00	1.34	1.97	169.5	521423
CT40	ER32	0.078-0.787	6.00	1.34	1.97	169.5	521425
CT40	ER40	0.118-1.023	2.50	1.50	2.48	219.6	521666

** Hex Nut



From simple to deluxe, we have a Tool Setting Stand to suit your needs.

See www.SowaTool.com

CAT50 ER Collet Chucks



- DIN coolant option - standard
- All ground body
- Factory balanced to save spindle life, tool life and increased productivity
- Threaded through holes for a back-up screw (tool stop) or coolant through when removed
- TIR, 0.0003" at 4xDia.
- Wrench not included
- AT2 Taper Accuracy
- RFID Chip Hole

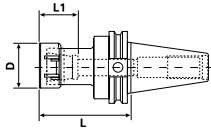

PREMIUM BALANCE
G2.5 at 25,000rpm
CERTIFICATE INCLUDED

Taper	Collet Series	Collet Range	L	L1	D	Tightening Torque (Nm)	Code No.
CT50	ER16**	0.019-0.406	4.12	0.87	1.26	56.9	531432
CT50	ER16**	0.019-0.406	6.00	0.87	1.26	56.9	531434
CT50	ER16**	0.019-0.406	8.00	0.87	1.26	56.9	531436
CT50	ER16**	0.019-0.406	12.00	0.87	1.26	56.9	531437
CT50	ER20**	0.039-0.511	2.50	1.06	1.38	81.3	531438
CT50	ER20**	0.039-0.511	4.00	1.06	1.38	81.3	531440
CT50	ER20**	0.039-0.511	6.00	1.06	1.38	81.3	531442
CT50	ER20**	0.039-0.511	8.00	1.06	1.38	81.3	531444
CT50	ER20**	0.039-0.511	12.00	1.06	1.38	81.3	531445
CT50	ER25	0.039-0.629	2.50	1.18	1.65	128.8	531446
CT50	ER25	0.039-0.629	4.00	1.18	1.65	128.8	531448
CT50	ER25	0.039-0.629	6.00	1.18	1.65	128.8	531450
CT50	ER25	0.039-0.629	8.00	1.18	1.65	128.8	531452
CT50	ER32	0.078-0.787	0.750				531403*
CT50	ER32	0.078-0.787	4.00	1.34	1.97	169.5	531454
CT50	ER32	0.078-0.787	6.00	1.34	1.97	169.5	531456
CT50	ER32	0.078-0.787	8.00	1.34	1.97	169.5	531458
CT50	ER32	0.078-0.787	12.00	1.34	1.97	169.5	531459
CT50	ER40	0.118-1.023	4.00	1.50	2.48	219.6	531460
CT50	ER40	0.118-1.023	6.00	1.50	2.48	219.6	531462
CT50	ER40	0.118-1.023	8.00	1.50	2.48	219.6	531464

* ER Shorty collet chuck, Not DIN coolant ** Hex Nut

CAT50 DUAL CONTACT ER Collet Chucks



- Improves rigidity and reduces vibration allowing for increased feed rates and increased tool life
- DIN coolant option - standard
- All ground body
- TIR, 0.0003" at 4xDia.
- AT2 Taper Accuracy
- RFID Chip Hole

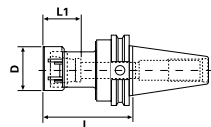
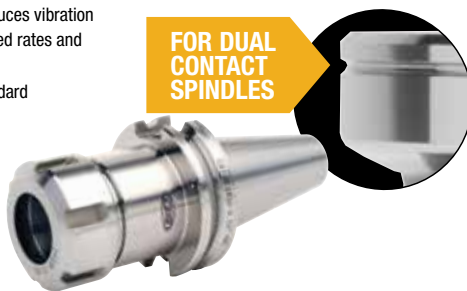

PREMIUM BALANCE
G2.5 at 25,000rpm
CERTIFICATE INCLUDED

Taper	Collet Series	Collet Range	L	L1	D	Tightening Torque (Nm)	Code No.
CT50	ER16**	0.019-0.406	4.12	0.87	1.26	56.9	521432
CT50	ER16**	0.019-0.406	6.00	0.87	1.26	56.9	521434
CT50	ER16**	0.019-0.406	8.00	0.87	1.26	56.9	521436
CT50	ER32	0.078-0.787	4.00	1.34	1.97	169.5	521454
CT50	ER32	0.078-0.787	6.00	1.34	1.97	169.5	521456
CT50	ER32	0.078-0.787	8.00	1.34	1.97	169.5	521458

** Hex Nut

STM CAT50 ER Collet Chucks



- DIN coolant option - standard
- Factory balanced to save spindle life, tool life and increased productivity
- TIR, 0.0002" at 4xDia.
- Wrench not included
- AT2 Taper Accuracy
- RFID Chip Hole

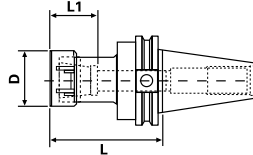

BALANCE CERTIFICATE
G2.5 at 15,000rpm
INCLUDED

Taper	Collet Series	Collet Range	L	L1	D	Code No.
CT50	ER16*	0.019-0.413"	4.12"	0.87"	1.26"	525432
CT50	ER16*	0.019-0.413"	6.00"	0.87"	1.26"	525434
CT50	ER20*	0.019-0.551"	4.00"	1.06"	1.38"	525440
CT50	ER20*	0.019-0.551"	6.00"	1.06"	1.38"	525442
CT50	ER32	0.078-0.787"	4.00"	1.34"	1.97"	525454
CT50	ER32	0.078-0.787"	6.00"	1.34"	1.97"	525456

* Hex Nut



Grab a Tool Trolley with 4 Tool Trays and Inserts for all your Holders.

See www.SowaTool.com

BT Taper ER Collet Chucks



- DIN coolant option - standard
- All ground body
- Factory balanced to save spindle life, tool life and increased productivity
- Threaded through holes for a back-up screw (tool stop) or coolant through when removed
- Wrench not included
- AT2 Taper Accuracy
- RFID Chip Hole

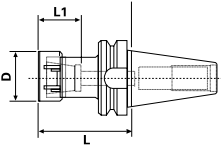

PREMIUM BALANCE
G2.5 at 30,000rpm
CERTIFICATE INCLUDED

PREMIUM BALANCE
G2.5 at 25,000rpm
CERTIFICATE INCLUDED

Taper	Collet Series	Collet Range	L	L1	D	Tightening Torque (Nm)	Code No.
BT30 & BT40							
BT30	ER11**	0.019-0.275	2.00	0.65	0.75	29.8	532150*
BT30	ER11**	0.019-0.275	4.00	0.65	0.75	29.8	532152*
BT30	ER16**	0.019-0.406	2.36	0.87	1.26	56.9	532154*
BT30	ER16**	0.019-0.406	4.00	0.87	1.26	56.9	532156*
BT30	ER16**	0.019-0.406	5.00	0.87	1.26	56.9	532158*
BT30	ER16**	0.019-0.406	6.00	0.87	1.26	56.9	532160*
BT30	ER20**	0.039-0.511	2.50	1.06	1.38	81.3	532162*
BT30	ER20**	0.039-0.511	4.00	1.06	1.38	81.3	532164*
BT30	ER25	0.039-0.629	2.00	1.18	1.65	128.8	532166*
BT30	ER25	0.039-0.629	4.00	1.18	1.65	128.8	532168*
BT30	ER32	0.078-0.787	3.00	1.34	1.97	169.5	532170*
BT30	ER32	0.078-0.787	5.00	1.34	1.97	169.5	532172*
BT40							
BT40	ER11**	0.019-0.275	4.00	0.65	0.75	29.8	532176
BT40	ER11**	0.019-0.275	6.00	0.65	0.75	29.8	532178
BT40	ER16**	0.019-0.406	3.50	0.87	1.26	56.9	532180
BT40	ER16**	0.019-0.406	5.00	0.87	1.26	56.9	532182
BT40	ER20**	0.039-0.511	2.50	1.06	1.38	81.3	532184
BT40	ER20**	0.039-0.511	4.00	1.06	1.38	81.3	532186
BT40	ER20**	0.039-0.511	6.00	1.06	1.38	81.3	532188
BT40	ER25	0.039-0.629	2.25	1.18	1.65	128.8	532190
BT40	ER25	0.039-0.629	4.00	1.18	1.65	128.8	532192
BT40	ER25	0.039-0.629	6.00	1.18	1.65	128.8	532194
BT40	ER32	0.078-0.787	1.06				‡532191*
BT40	ER32	0.078-0.787	3.13	1.34	1.97	169.5	532196
BT40	ER32	0.078-0.787	5.00	1.34	1.97	169.5	532198
BT40	ER40	0.118-1.023	3.13	1.50	2.50	219.6	532200
BT40	ER40	0.118-1.023	5.00	1.50	2.50	219.6	532202
BT50							
BT50	ER16**	0.019-0.406	2.50	0.87	1.26	56.9	532203
BT50	ER25	0.039-0.629	4.00	1.18	1.65	128.8	532206

* Not DIN Coolant

** Hex Nut

‡ ER Shorty Collet Chuck

HSK63A ER Collet Chucks



- All ground body
- High rigidity and torque transmission
- Wrench not included
- AT2 Taper Accuracy
- RFID chip hole

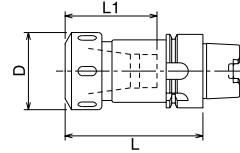

PREMIUM BALANCE
G2.5 at 30,000rpm
CERTIFICATE INCLUDED

Taper	Collet Series	Collet Range	L	L1	D	Tightening Torque (Nm)	Code No.
HSK63A	ER16**	0.019-0.393	3.00	0.866	1.260	56.9	536114
HSK63A	ER16**	0.019-0.393	5.00	0.866	1.260	56.9	536116
HSK63A	ER20**	0.039-0.511	3.00	1.062	1.378	81.3	536118
HSK63A	ER20**	0.039-0.511	5.00	1.062	1.378	81.3	536120
HSK63A	ER25	0.039-0.629	3.00	1.181	1.654	128.8	536122
HSK63A	ER25	0.039-0.629	5.00	1.181	1.654	128.8	536124
HSK63A	ER32	0.078-0.787	4.00	1.260	1.969	169.5	536126
HSK63A	ER32	0.078-0.787	6.00	1.260	1.969	169.5	536128
HSK63A	ER40	0.118-1.023	4.00	1.496	2.480	219.6	536130

** Hex Nut

HSK100A ER Collet Chucks



- All ground body
- High rigidity and torque transmission
- Wrench not included
- AT2 Taper Accuracy
- RFID chip hole

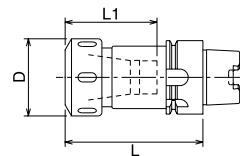

PREMIUM BALANCE
G2.5 at 25,000rpm
CERTIFICATE INCLUDED

Taper	Collet Series	Collet Range	L	L1	D	Tightening Torque (Nm)	Code No.
HSK100A	ER16**	0.019-0.393	4.00	0.866	1.260	56.9	536134
HSK100A	ER16**	0.019-0.393	6.00	0.866	1.260	56.9	536136
HSK100A	ER20**	0.039-0.511	4.00	1.062	1.378	81.3	536138
HSK100A	ER20**	0.039-0.511	6.00	1.062	1.378	81.3	536140
HSK100A	ER25	0.039-0.629	6.00	1.181	1.654	128.8	536144
HSK100A	ER32	0.078-0.787	4.00	1.260	1.969	169.5	536146
HSK100A	ER32	0.078-0.787	6.00	1.260	1.969	169.5	536148
HSK100A	ER40	0.118-1.023	6.00	1.496	2.480	219.6	536152

** Hex Nut

R8 Taper ER Collet Chucks

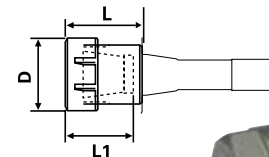

Taper	Collet Series	Collet Range	L	L1	D	Tightening Torque (Nm)	Code No.
R8	ER16	0.019-0.406	1.25	2.83	1.25	56.9	534360
R8	ER20	0.039-0.511	2.00	1.50	1.38	81.3	534362
R8	ER25	0.039-0.629	2.50	1.64	1.66	128.8	534364

NMTB Taper ER Collet Chucks



- Wrench not included

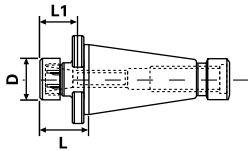

Taper	Collet Series	Collet Range	L	L1	D	Tightening Torque (Nm)	Code No.
NMTB40							
NMTB40	ER16	0.019-0.406	1.77	0.87	1.26	56.9	534352
NMTB40	ER25	0.039-0.629	2.00	1.18	1.65	128.8	534354
NMTB40	ER32	0.078-0.787	2.00	-	-	-	534260
NMTB50							
NMTB50	ER16	0.019-0.406	2.00	0.87	1.26	56.6	534356

ER Collet Chuck Extensions



- Wrench not included

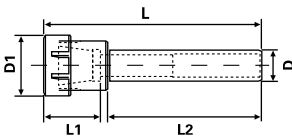

Collet Series	Collet Range	Shank Dia. (D)	D1	L	L1	L2	Tightening Torque (Nm)	Code No.
ER11	0.019-0.275	1/2	0.740	6.11	0.091	5.00	29.8	534368
ER11	0.019-0.275	5/8	0.740	6.11	0.091	5.00	29.8	534370
ER11	0.019-0.275	3/4	0.740	5.65	0.091	5.00	29.8	534372
ER16	0.019-0.406	5/8	1.26	6.48	1.28	5.00	56.9	534374
ER16	0.019-0.406	3/4	1.26	6.48	1.28	5.00	56.9	534376
ER16	0.019-0.406	1	1.26	5.89	1.28	5.00	56.9	534378
ER20	0.039-0.511	3/4	1.38	6.67	1.48	5.00	81.3	534380
ER20	0.039-0.511	1	1.38	6.40	1.48	5.00	81.3	534382
ER20	0.039-0.511	1-1/4	1.38	6.40	1.48	5.00	81.3	534384
ER25	0.039-0.629	3/4	1.65	6.85	1.65	5.00	128.8	534386
ER25	0.039-0.629	1	1.65	6.85	1.65	5.00	128.8	534388
ER25	0.039-0.629	1-1/4	1.65	6.00	1.65	5.00	128.8	534390
ER32	0.078-0.787	1	1.97	7.09	1.85	5.00	169.5	534392
ER32	0.078-0.787	1-1/4	1.97	6.30	2.13	4.00	169.5	337805
ER32	0.078-0.787	1-1/4	1.97	7.09	1.85	5.00	169.5	534394

R8 Taper ER Collet Chucks



- Wrench not included



Collet Series	Gauge Length	Nose Dia.	Draw Bar	Code No.
ER32	40mm	50mm	7/16-20 UNF-3	337815
ER40	70mm	63mm	7/16-20 UNF-3B	337820

NMTB Taper ER Collet Chucks



- Wrench not included



Taper	Collet Series	Gauge Length	Nose Dia.	Draw Bar	Code No.
NMTB30	ER32	55	50	1/2-13	337825
NMTB30	ER40	85	63	1/2-13	337830
NMTB40	ER40	55	63	5/8-11	337835
NMTB50	ER40	58	63	1-8	337840

ER Spring Collet Dimensional Data



ER collet system is made of special elastic steel material under excellent heat treatment and precise grinding process, so it has precise accuracy, powerful clamping ability, and is durable. This collet can clamp for a specific standard size and its next size. It can be widely used for boring, milling, drilling and tapping as well as for grinding operation, and is available for all sizes.

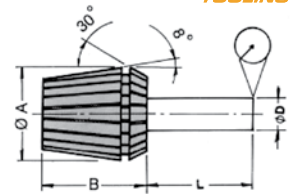

Type	A (mm)	B (mm)	L (mm)	ØD (mm)	DIN 6343 Precision	GS Precision
ER11	11.5	18	-	-	0.02	0.010
ER16	17	27	6	1.0-1.4	0.02	0.010
ER20	21	31	10	1.5-2.9	0.02	0.010
ER25	26	35	16	3.0-5.9	0.02	0.010
ER32	33	40	25	6.0-9.9	0.02	0.010
ER40	41	46	40	10.0-17.9	0.03	0.010
ER50	52	60	50	18.0-26.9	0.03	0.010

Mounting Instructions for ER Collets

- Place collet inside nut and rotate the nut to engage with the extractor spiral in collet groove
 - Only then mount nut and collet together into the collet holder or machine spindle
- Note: Never use a 12-11mm collet to clamp a 12mm diameter, but rather use a 13-12mm collet

5 Micron AA ER Collet Tolerance Values

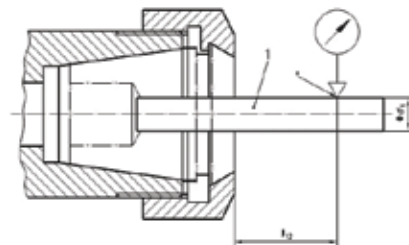

Collet Run-Out Tolerance Values

d1 H7 Nominal Diameter		112	Run-Out Tolerance A	
Above	Up To (included)		Class 1	Class 2
1 (included)	1.6	6	0.005	0.015
1.6	3	10		
3	6	16		
6	10	25	0.005	0.020
10	18	40		
18	26	50		

Introducing...



EXTREME PRECISION 5 MICRON COLLETS

Nothing else compares.

DIN 6343 Precision Collets have a runout of 20-30 microns (0.02 - 0.03mm)

GS High Precision Collets have a runout of 10-20 microns (0.01 - 0.02mm)

The new **GS Extreme Precision AA Collets** have a runout of only 5 microns (0.005mm)

Features & Benefits:

- 16 slots allows sufficient collapse while increasing the area of contact with less tendency to distort
- All edges are deburred and rounded to promote good interface with the taper of the chuck without the tendency to damage it. This results in more consistent repeatability
- Collets are polished to eliminate blemishes that promote corrosion. Better corrosion resistance will result in longer product life of both the collet and the holder between the collet and the cutting tool shank
- Minimized variation of cutting edges
- Maximized Concentricity
- Evenly distributed cutting edges for high performance machining
- Highly polished OD surfaces reduce the amount of force absorbed by friction between the collet and the collet chuck seat, increasing the grip force on the cutting tool. The inside bore of the collet is intentionally left unpolished to increase the friction
- Improve system performance and lower cost per piece when used with quality GS chucks
- Consistent cutting profiles ensure the job stays within desired tolerances

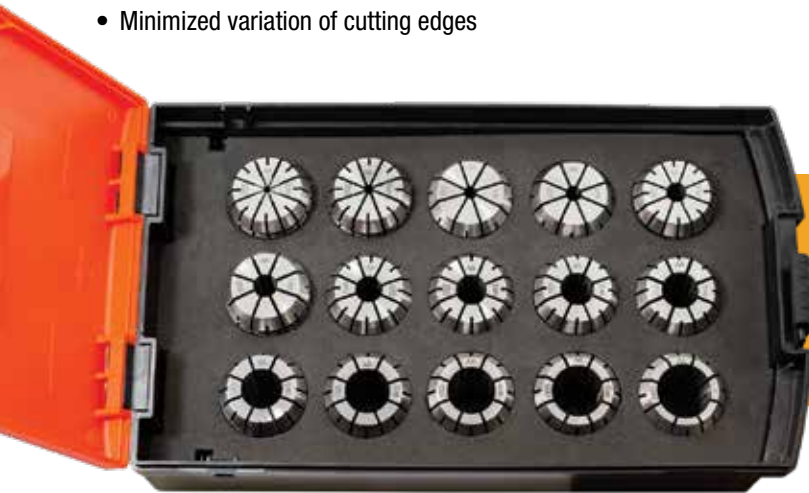

The result of an improved AA collet in a quality GS chuck is increased gripping force, improved rigidity, decreased runout, and a renewed confidence in your collet chuck system.

5 Micron AA ER Collet Sets



Series	No. Pcs.	Range	Code No.
Metric			
ER11	Metric 13pc Set	1-7mm x 0.5mm	336986
ER16	Metric 10pc Set	1-10mm x 1.0mm	336987
ER20	Metric 12pc Set	2-13mm x 1.0mm	336988
ER25	Metric 15pc Set	2-16mm x 1.0mm	336989
ER32	Metric 18pc Set	3-20mm x 1.0mm	336990
ER40	Metric 23pc Set	4-26mm x 1.0mm	336991
Inch			
ER11	Inch 7pc Set	1/16-1/4 x 1/32	336992
ER16	Inch 11pc Set	1/16-3/8 x 1/32	336993
ER20	Inch 15pc Set	1/16-1/2 x 1/32	336994
ER25	Inch 18pc Set	3/32-5/8 x 1/32	336995
ER32	Inch 21pc Set	1/8-3/4 x 1/32	336996
ER40	Inch 15pc Set	1/8-1" x 1/16	336997



ER Collet Chuck Sets

Our ER collet system is made of special alloy steel material under excellent heat treatment and precise grinding process, so it has precise accuracy, powerful clamping ability, and is durable. This collet can clamp for a specific standard size and its next size. It can be widely used for boring, milling, drilling and tapping as well as for grinding operation, and is available for all sizes.

- Wrench included



Shank	Collet Set	Code No.
ER16		
3/4 x 4	10 collets in set (range 0.019 - 0.393)	337700
3/4 x 6	10 collets in set (range 0.019 - 0.393)	337705
R8	10 collets in set (range 0.019- 0.393)	337710
ER20		
3/4 x 4	12 collets in set (range 0.039 - 0.511)	337715
3/4 x 6	12 collets in set (range 0.039 - 0.511)	337720
ER32		
1-1/4 x 4	11 collets in set (range 0.080 - 0.787)	337730
ISO-30	11 collets in set (range 0.080 - 0.787)	337735
R8	11 collets in set (range 0.080 - 0.787)	337740
ER40		
R8	15 collets in set (range 0.120 - 1.020)	337745
ISO-30	15 collets in set (range 0.120 - 1.020)	337750
ISO-40	15 collets in set (range 0.120 - 1.020)	337755
ISO-50	23 collets in set (range 0.120 - 1.020)	337760

ER11 Collets

Our ER collet system is made of special alloy steel material under excellent heat treatment and precise grinding process, so it has precise accuracy, powerful clamping ability, and is durable. This collet can clamp for a specific standard size and its next size. It can be widely used for boring, milling, drilling and tapping as well as for grinding operation, and is available for all sizes.

- Size range: 0.5mm - 7mm (0.019" - 0.275")
- ER11 collets collapse approximately 1/64" with full accuracy

AA Collets have a runout of only 5 microns (0.005mm)



REGULAR

Size (mm)	Size (in.)	Code No.	AA Code No.
Metric			
0.5-1	0.019-0.039	337650*	336700*
1-1.5	0.039-0.059	337652*	336702*
1.5-2	0.059-0.078	337654*	336705*
2-2.5	0.078-0.098	337656*	336707*
2.5-3	0.098-0.118	337658*	336709*
3-3.5	0.118-0.137	337660*	336711*
3.5-4	0.137-0.157	337662*	336714*
4-4.5	0.157-0.177	337664*	336716*
4.5-5	0.177-0.196	337666*	336718*
5-5.5	0.196-0.216	337668*	336720*
5.5-6	0.216-0.236	337670*	336723*
6-6.5	0.236-0.255	337672*	336725*
6.5-7	0.255-0.275	337674*	336727*
13pc Set	1-7mm	337379	336986
Inch			
	3/64	337609	336701
	1/16	337610*	336703*
	5/64	337611	336704
	3/32	337613*	336706*
	7/64	337614	336708
	1/8	337615*	336710*
	9/64	337617	336712
	5/32	337618*	336713*
	11/64	337619	336715
	3/16	337651*	336717*
	13/64	337653	336719
	7/32	337655*	336721*
	15/64	337657	336722
	1/4	337659*	336724*
	17/64	337661	336726
	9/32	337627	336728
7pc Set	1/16-1/4	337401	336992

* Part of Set

ER8 Collets

Our ER collet system is made of special alloy steel material under excellent heat treatment and precise grinding process, so it has precise accuracy, powerful clamping ability, and is durable. This collet can clamp for a specific standard size and its next size. It can be widely used for boring, milling, drilling and tapping as well as for grinding operation, and is available for all sizes.

- Size range: 0.5mm - 5mm (0.019" - 0.196")
- ER8 collets collapse approximately 0.3mm with full accuracy



Size (mm)	Size (in.)	Code No.
Metric		
0.5-1.0	0.019-0.039	337635
1.0-1.5	0.039-0.059	337637
2.0-2.5	0.078-0.098	337641
2.5-3.0	0.098-0.118	337643
3.0-3.5	0.118-0.137	337645
3.5-4.0	0.137-0.157	337647
4.0-4.5	0.157-0.177	337648
4.5-5.0	0.177-0.196	337649
Inch		
	1/16	337629
	1/8	337631
	3/16	337625

ER11 Sealed Collets

- Sealed for coolant through applications
- Pressure resistance tested to 500 psi
- Size range: 3/6 - 17/64", 4.0 - 7.0mm



Size (in/mm)	Code No.
Metric	
4.5	337636
5.5	337640
6.0	337642
6.5	337644
7.0	337646
Inch	
3/16	337622
13/64	337624
7/32	337626
15/64	337628
1/4	337630
17/64	337632

ER11 Tap Collets

- For synchronous, rigid tapping operations using ER collet chuck
- Collet bore is exact tool diameter with square drive for accuracy and rigidity



Tap	Shank Dia.	Size of Square	Code No.
Metric			
M1.4 - M1.8	2.5mm	2.1mm	337911
M2 - M2.6	2.8mm	2.1mm	337913
M2 - M2.6	3.0mm	2.5mm	337915
Inch			
#0-#6	0.141"	0.110"	337966
#8	0.168"	0.131"	337967
#10	0.194"	0.152"	337968
#12	0.220"	0.165"	337969

ER16 Collets



Our ER collet system is made of special alloy steel material under excellent heat treatment and precise grinding process, so it has precise accuracy, powerful clamping ability, and is durable. This collet can clamp for a specific standard size and its next size. It can be widely used for boring, milling, drilling and tapping as well as for grinding operation, and is available for all sizes.

- Size range: 0.5mm-10mm (0.019" - 0.393")
- ER16 collets collapse approximately 1/32" with full accuracy



REGULAR

AA Collets have a runout of only 5 microns (0.005mm)

Size (mm)	Size (in.)	Code No.	AA Code No.
Metric			
0.5-1	0.019-0.039	337302*	336729*
1-1.5	0.039-0.059		336730
1-2	0.039-0.078	337304*	
1.5-2	0.059-0.078		336732*
2-2.5	0.078-0.098		336734
2-3	0.078-0.118	337306*	
2.5-3	0.098-0.118		336735*
3-3.5	0.118-0.137		336737
3-4	0.118-0.157	337308*	
3.5-4	0.137-0.157		336740*
4-4.5	0.157-0.177		336741
4-5	0.157-0.196	337310*	
4.5-5	0.177-0.196		336743*
5-5.5	0.196-0.217		336744
5-6	0.196-0.236	337312*	
5.5-6	0.217-0.236		336746*
6-6.5	0.236-0.256		336748
6-7	0.236-0.275	337314*	
6.5-7	0.256-0.275		336749*
7-7.5	0.275-0.295		336751
7-8	0.275-0.314	337316*	
7.5-8	0.295-0.314		336753*
8-8.5	0.314-0.335		336754
8-9	0.314-0.354	337318*	
8.5-9	0.335-0.354		336756*
9-9.5	0.354-0.374		336757
9-10	0.354-0.393	337320*	
9.5-10	0.374-0.393		336759*
10pc Set	1-10mm	337380	336987
Inch			
	1/16	337531*	336731*
	3/32	337532*	336733*
	1/8	337533*	336736*
	9/64	337529	336738
	5/32	337534*	336739*
	3/16	337535*	336742*
	7/32	337536*	336745*
	1/4	337537*	336747*
	9/32	337538*	336750*
	5/16	337540*	336752*
	11/32	337541*	336755*
	3/8	337542*	336758*
	13/32	337543	336760
11pc Set	1/16-3/8	337403	336993

* Part of Set

ER16 Sealed Collets



- Sealed for coolant through applications
- Pressure resistance tested to 2000 psi

Metric Size	Metric Code No.	Inch Size	Inch Code No.
3.0	338290	1/8	337841*
3.5	338291	5/32	337842*
4.0	338292*	3/16	337843*
4.5	338294*	13/64	337826
5.0	338296*	7/32	337844*
5.5	338298*	15/64	337827
6.0	338300*	1/4	337845*
6.5	338302*	17/64	337828
7.0	338304*	9/32	337846*
7.5	338305*	19/64	337829
8.0	338306*	5/16	337847*
8.5	338307*	21/64	337831
9.0	338308*	11/32	337848*
9.5	338309*	23/64	337832
10.0	338310*	3/8	337849*
		25/64	337833
		13/32	337834*
13pc Set	337932	10pc Set	337931

* Part of Set

ER16 Tap Collets



- Alloy steel
- For synchronous, rigid tapping operations using ER collet chuck
- Collet bore is exact tool diameter with square drive for accuracy and rigidity
- See page G63-64 for rigid tapping holders

Tap	Shank Dia.	Size of Square	Code No.
Metric			
M1.4-M1.8	2.5mm	2.1mm	338095
M2	2.8mm	2.1mm	338111
M2-M2.6	3.0mm	2.5mm	338096
M3	2.25mm	1.8mm	338097
M3	3.5mm	2.7mm	338113
M3	4mm	3.0mm	338099
M3.5	2.5mm	2.0mm	338098
M4-M5	5mm	4.0mm	338101
M4-M6	4.5mm	3.4mm	338115
M4-M6	5.5mm	4.3mm	338116
M5-M5.5	4.5mm	4.5mm	338103
M5-M5.5	5.5mm	4.5mm	338105
M5-M8	6mm	4.9mm	338117
M6	6mm	4.5mm	338118
M8	6.2mm	5.0mm	338119
M8	8mm	6.2mm	338121
M8-M11	8mm	6.0mm	338107
M10	7mm	5.5mm	338123
M10	10mm	8.0mm	338125
M12	8.5mm	6.5mm	338127
M12	9mm	7.0mm	338129
Inch			
0-6	0.141	0.110	‡ 337850*
8	0.168	0.131	‡ 337851*
10	0.194	0.152	‡ 337852*
12	0.220	0.165	‡ 337853*
1/4	0.255	0.191	‡ 337854*
5/16	0.318	0.238	‡ 337855
3/8	0.381	0.286	‡ 337824
7/16	0.323	0.242	‡ 337839
1/2	0.367	0.275	‡ 337838
5pc Set			337986
9pc Set			337343

* Part of 5pc Set ‡ Part of 9pc Set

ER20 Collets



Our ER collet system is made of special alloy steel material under excellent heat treatment and precise grinding process, so it has precise accuracy, powerful clamping ability, and is durable. This collet can clamp for a specific standard size and its next size. It can be widely used for boring, milling, drilling and tapping as well as for grinding operation, and is available for all sizes.

- Size range: 1mm - 13mm (0.039" - 0.511")
- ER20 collets collapse approximately 1/32" with full accuracy



REGULAR

AA Collets have a runout of only 5 microns (0.005mm)

Size (mm)	Size (in.)	Code No.	AA Code No.
Metric			
1-1.5	0.039-0.059	337446	
1.5-2	0.059-0.078		336763*
1-2	0.039-0.078	337473*	
2-2.5	0.078-0.098	337447	336765
2-3	0.078-0.118	337474*	
2.5-3	0.098-0.118		336766*
2.5-3.5	0.098-0.137	337471	
3-3.5	0.118-0.137		336768
3-4	0.118-0.157	337475*	
3.5-4	0.137-0.157		336770*
4-4.5	0.157-0.177	337448	336771
4-5	0.157-0.196	337476*	
4.5-5	0.177-0.196		336773*
5-5.5	0.196-0.217	337449	336774
5-6	0.196-0.236	337477*	
5.5-6	0.217-0.236		336776*
6-6.5	0.236-0.256	337451	336778
6-7	0.236-0.275	337478*	
6.5-7	0.256-0.275		336779*
7-7.5	0.275-0.295	337453	336781
7-8	0.275-0.314	337479*	
7.5-8	0.295-0.314		336783*
8-8.5	0.314-0.335	337455	336784
8-9	0.314-0.354	337480*	
8.5-9	0.335-0.354		336786*
9-9.5	0.354-0.374	337457	336787
9-10	0.354-0.393	337481*	
9.5-10	0.374-0.393		336789*
10-10.5	0.393-0.413	337459	336791
10-11	0.393-0.433	337482*	
10.5-11	0.413-0.433		336792*
11-11.5	0.433-0.452	337469	336794
11-12	0.433-0.472	337483*	
11.5-12	0.452-0.472		336796*
12-12.5	0.472-0.492	337463	336797
12-13	0.472-0.511	337484*	
12.5-13	0.492-0.511		336799*
13-13.5	0.511-0.531		336800
13.5-14	0.531-0.551		336801
12pc Set	2-13mm	337382	336988
Inch			
	1/16	337621*	336762*
	3/32	337623*	336764*
	1/8	337663*	336767*
	5/32	337665*	336769*
	3/16	337667*	336772*
	7/32	337669*	336775*
	1/4	337671*	336777*
	9/32	337673*	336780*
	5/16	337675*	336782*
	11/32	337676*	336785*
	3/8	337677*	336788*
	13/32	337678*	336790*
	7/16	337679*	336793*
	15/32	337681*	336795*
	1/2	337682*	336798*
15pc Set	1/16-1/2	337404	336994

* Part of set

ER20 Sealed Collets



- Sealed for coolant through applications
- Pressure resistance tested to 2000 psi

Size (in/mm)	Code No.
Metric	
4.0	338325**
4.5	338299**
5.0	338330
5.5	338334
6.0	338336
6.5	338337
7.0	338338
7.5	338339
8.0	338340
8.5	338341
9.0	338342
9.5	338343
10.0	338344
10.5	338345
11.0	338346
11.5	338347
12.0	338348
12.5	338349
13.0	338350
17pc Set	337935
Inch	
1/8	337856**
5/32	337857
3/16	337858
7/32	337859
1/4	337860
9/32	337861
5/16	337862
11/32	337863
3/8	337864
13/32	337865
7/16	337866
15/32	337867
1/2	337868
12pc Set	337933

** Not Part of Set

ER20 Tap Collets



- For synchronous, rigid tapping operations using ER collet chuck
- Collet bore is exact tool diameter with square drive for accuracy and rigidity

Tap	Shank Dia.	Size of Square	Code No.
Metric			
M4 -M6	4.5mm	3.4mm	338131
M4-M6	5.5mm	4.3mm	338133
M5-M8	6mm	4.9mm	338135
M8	8mm	6.2mm	338137
M10	7mm	5.5mm	338139
M10	10mm	8.0mm	338141
M12	9mm	7.0mm	338143
M14	11mm	9.0mm	338145
M16	12mm	9.0mm	338147
Inch			
0-6	0.141	0.110	337869*
8	0.168	0.131	337870*
10	0.194	0.152	337871*
12	0.220	0.165	337872*
1/4	0.255	0.191	337873*
5/16	0.318	0.238	337874*
3/8	0.381	0.286	337875*
7/16	0.323	0.242	337876*
1/2	0.367	0.275	337877*
9pc Set			337345

* Part of Set

Collet Chucks & Collets

ER25 Collets

Our ER collet system is made of special alloy steel material under excellent heat treatment and precise grinding process, so it has precise accuracy, powerful clamping ability, and is durable. This collet can clamp for a specific standard size and its next size. It can be widely used for boring, milling, drilling and tapping as well as for grinding operation, and is available for all sizes.

AA Collets have a runout of only 5 microns (0.005mm)



REGULAR

Size (mm)	Size (in.)	Code No.	AA Code No.
Metric			
1-2	0.039-0.078	337330*	
1.5-2	0.059-0.078		336802*
2-2.5	0.078-0.098	337274	336804
2-3	0.078-0.118	337332*	
2.5-3	0.098-0.118		336805*
2.5-3.5	0.098-0.137	337333	
3-3.5	0.118-0.137		336807
3-4	0.118-0.157	337334*	
3.5-4	0.137-0.157		336809*
4-4.5	0.157-0.177	337486	336810
4-5	0.157-0.196	337336*	
4.5-5	0.177-0.196		336812*
5-5.5	0.196-0.217	337487	336813
5-6	0.196-0.236	337338*	
5.5-6	0.217-0.236		336815*
6-6.5	0.236-0.256	337488	336816
6-7	0.236-0.275	337340*	
6.5-7	0.256-0.275		336818*
7-7.5	0.275-0.295	337489	336820
7-8	0.275-0.314	337342*	
7.5-8	0.295-0.314		336822*
8-8.5	0.314-0.335	337490	336823
8-9	0.314-0.354	337344*	
8.5-9	0.335-0.354		336825*
9-9.5	0.354-0.374	337491	336826
9-10	0.354-0.393	337346*	
9.5-10	0.374-0.393		336828*
10-10.5	0.393-0.413	337492	336830
10-11	0.393-0.433	337348*	
10.5-11	0.413-0.433		336831*
11-11.5	0.433-0.452	337349	336833
11-12	0.433-0.472	337350*	
11.5-12	0.452-0.472		336835*
12-12.5	0.472-0.492	337493	336836
12-13	0.472-0.511	337352*	
12.5-13	0.492-0.511		336838*
13-13.5	0.511-0.531	337494	336840
13-14	0.511-0.551	337354*	
13.5-14	0.531-0.551		336841*
14-14.5	0.551-0.571	337495	
14-15	0.551-0.590	337356*	
14.5-15	0.571-0.590		336844*
15-15.5	0.590-0.610	337497	336846
15-16	0.590-0.629	337358*	
15.5-16	0.610-0.629		336848*
16-16.5	0.629-0.650	337499	
16.5-17	0.650-0.669	337301	
15pc Set	2-16mm	337383	336989
Inch			
	3/32	337602**	336803**
	1/8	337683	336806
	5/32	337684	336808
	3/16	337685	336811
	7/32	337686	336814
	1/4	337687	336817
	9/32	337688	336819
	5/16	337689	336821
	11/32	337691	336824
	3/8	337692	336827
	13/32	337693	336829
	7/16	337694	336832
	15/32	337696	336834
	1/2	337697	336837
	17/32	337698	336839
	9/16	337699	336842
	19/32	337701	336845
	5/8	337702	336847
17pc Set	1/8-5/8	337405	336995

** Not Part of Set

* Part of Set

ER25 Sealed Collets

- Steel sealed for coolant through applications
- Pressure resistance tested to 2000 psi



Metric Size	Metric Code No.	Inch Size	Inch Code No.
3.0	338297	1/8	337878
3.5	338326	5/32	337879
4.0	338327	3/16	337880
4.5	338373	7/32	337881
5.0	338329	1/4	337882*
5.5	338331	17/64	338352
6.0	338360*	9/32	337883*
6.5	338362*	19/64	338354
7.0	338364*	5/16	337884*
7.5	338366*	21/64	338356
8.0	338368*	11/32	337885*
8.5	338370*	23/64	338358
9.0	338372*	3/8	337886*
9.5	338374*	25/64	337916
10.0	338376*	13/32	337887*
10.5	338378*	27/64	337917
11.0	338380*	7/16	337888*
11.5	338382*	29/64	337918
12.0	338384*	15/32	337889*
12.5	338386*	31/64	337919
13.0	338388*	1/2	337890*
13.5	338390*	33/64	337920
14.0	338392*	17/32	337891*
14.5	338394*	35/64	337921
15.0	338396*	9/16	337892*
15.5	338398*	37/64	337922
16.0	338400*	19/32	337893*
		39/64	337923
		5/8	337894*
21pc Set	337939	13pc Set	337938

* Part of Set

ER25 Tap Collets

- For synchronous, rigid tapping operations using ER collet chuck
- Collet bore is exact tool diameter with square drive for accuracy and rigidity



Tap	Shank Dia.	Size of Square	Code No.
Metric			
M4-M6	4.5mm	3.4mm	338149
M4-M6	5.5mm	4.3mm	338151
M4-M8	6mm	4.9mm	338153
M10	7mm	5.5mm	338155
M8	8mm	6.2mm	338157
M10	10mm	8.0mm	338159
M12	9mm	7.0mm	338161
M14	11mm	9.0mm	338162
M16	12mm	9.0mm	338163
M16	12.5mm	10.0mm	338164
M18	14mm	11.0mm	338165
M20	15mm	12.0mm	338166
M20	16mm	12.0mm	338167
Inch			
0-6	0.141	0.110	337895*
8	0.168	0.131	337896*
10	0.194	0.152	337897*
12	0.220	0.165	337898*
1/4	0.255	0.191	337899*
5/16	0.318	0.238	337900*
3/8	0.381	0.286	337901*
7/16	0.323	0.242	337902*
1/2	0.367	0.275	337903*
9/16	0.429	0.322	337904*
5/8	0.480	0.360	337905*
11/16	0.542	0.406	337983
11pc Set			337347
NPT			
1/16, 1/8-SS (small shank)	0.3125	0.234	337909
1/8-LS (large shank)	0.4375	0.328	337910

* Part of Set

ER32 Collets

Our ER collet system is made of special alloy steel material under excellent heat treatment and precise grinding process, so it has precise accuracy, powerful clamping ability, and is durable. This collet can clamp for a specific standard size and its next size. It can be widely used for boring, milling, drilling and tapping as well as for grinding operation, and is available for all sizes.

AA Collets have a runout of only 5 microns (0.005mm)



REGULAR

Size (mm)	Size (in.)	Code No.	AA Code No.
Metric			
2-2.5	0.078-0.098	337415	336852
2-3	0.078-0.118	337361*	
2.5-3	0.098-0.118		336853*
2.5-3.5	0.098-0.137	337359	
3-3.5	0.118-0.137		336855
3-4	0.118-0.157	337362*	
3.5-4	0.137-0.157		336857*
4-4.5	0.157-0.177	337217	336858
4-5	0.157-0.196	337363*	
4.5-5	0.177-0.196		336860*
5-5.5	0.196-0.217	337218	336861
5-6	0.196-0.236	337364*	
5.5-6	0.217-0.236		336863*
6-6.5	0.236-0.256	337219	336864
6-7	0.236-0.275	337365*	
6.5-7	0.256-0.275		336866*
7-7.5	0.275-0.295	337289	336868
7-8	0.275-0.314	337366*	
7.5-8	0.295-0.314		336870*
8-8.5	0.314-0.335	337221	336871
8-9	0.314-0.354	337367*	
8.5-9	0.335-0.354		336873*
9-9.5	0.354-0.374	337222	336874
9-10	0.354-0.393	337368*	
9.5-10	0.374-0.393		336876*
10-10.5	0.393-0.413	337223	336878
10-11	0.393-0.433	337369*	
10.5-11	0.413-0.433		336879*
10.5-11.5	0.413-0.452	337357	
11-11.5	0.433-0.452		336881
11-12	0.433-0.472	337370*	
11.5-12	0.452-0.472		336883*
12-12.5	0.472-0.492	337227	336884
12-13	0.472-0.511	337371*	
12.5-13	0.492-0.511		336886*
13-13.5	0.511-0.531	337229	336888
13-14	0.511-0.551	337372*	
13.5-14	0.531-0.551		336889*
14-14.5	0.551-0.571	337249	336891
14-15	0.551-0.590	337373*	
14.5-15	0.571-0.590		336892*

Size (mm)	Size (in.)	Code No.	AA Code No.
15-15.5	0.590-0.610	337255	336894
15-16	0.590-0.629	337374*	
15.5-16	0.610-0.629		336896*
16-16.5	0.629-0.650	337256	336897
16-17	0.629-0.669	337375*	
16.5-17	0.650-0.669		336899*
17-17.5	0.669-0.689	337272	336901
17-18	0.669-0.708	337376*	
17.5-18	0.689-0.708		336902*
18-18.5	0.708-0.728	337215	336904
18-19	0.708-0.748	337377*	
18.5-19	0.728-0.748		336905*
18.5-19.5	0.728-0.767	337355	
19-19.5	0.748-0.767		336907
19-20	0.748-0.787	337378*	
19.5-20	0.767-0.787		336909*
18pc Set	3-20mm	337384	336990
Inch			
	3/32		336851
	1/8	337703*	336854*
	5/32	337704*	336856*
	3/16	337706*	336859*
	7/32	337707*	336862*
	1/4	337708*	336865*
	9/32	337709*	336867*
	5/16	337711*	336869*
	11/32	337712*	336872*
	3/8	337713*	336875*
	13/32	337714*	336877*
	7/16	337716*	336880*
	15/32	337717*	336882*
	1/2	337718*	336885*
	17/32	337719*	336887*
	9/16	337721*	336890*
	19/32	337722*	336893*
	5/8	337723*	336895*
	21/32	337724*	336898*
	11/16	337725*	336900*
	23/32	337726*	336903*
	3/4	337727*	336906*
	25/32	337605	336908
21pc Set	1/8-3/4	337407	336996

* Part of Set

ER32 Sealed Collets

- Sealed for coolant through applications
- Pressure resistance tested to 2000 psi



Metric Size	Code No.	Inch Size	Code No.
3.0	338335	1/8	338200
3.5	338351	5/32	338201
4.0	338353	3/16	338202
4.5	338333	7/32	338203
5.0	338355	1/4	338204*
5.5	338363	17/64	338301
6.0	338320	9/32	338205*
6.5	338365	19/64	338303
7.0	338357	5/16	338206*
7.5	338367	21/64	338311
8.0	338324	11/32	338207*
8.5	338369	23/64	338312
9.0	338359	3/8	338208*
9.5	338361	25/64	338313
10.0	338328	13/32	338209*
10.5	338404*	27/64	338314
11.0	338406*	7/16	338210*
11.5	338371*	29/64	338315
12.0	338332*	15/32	338211*
12.5	338408*	31/64	338316
13.0	338410*	1/2	338212*
13.5	338412*	33/64	338317
14.0	338414*	17/32	338213*
14.5	338416*	35/64	338318
15.0	338418*	9/16	338214*
15.5	338420*	37/64	338319
16.0	338422*	19/32	338215*
16.5	338424*	39/64	338321
17.0	338426*	5/8	338216*
17.5	338428*	41/64	337924
18.0	338430*	21/32	338217*
18.5	338432*	43/64	337925
19.0	338434*	11/16	338218*
19.5	338436*	45/64	337926
20.0	338438*	23/32	338219*
		47/64	337927
		3/4	338220*
		49/64	337928
		25/32	338322
20pc Set	337942	17pc Set	337940

* Part of set

ER32 Tap Collets

- For synchronous, rigid tapping operations using ER collet chuck
- Collet bore is exact tool diameter with square drive for accuracy and rigidity



Tap	Shank Dia.	Size of Square	Code No.
Metric			
M3	2.5mm	1.8mm	338168
M3.5	2.5mm	2.0mm	338169
M4	2.8mm	2.1mm	338170
M3-M5	3.5mm	2.7mm	338171
M3-M5	4mm	3.0mm	338172
M4-M5	5mm	4.0mm	338197
M4-M6	4.5mm	3.4mm	338173*
M4-M6	5.5mm	4.3mm	338174
M5-M5.5	4.5mm	4.5mm	338198
M5-M5.5	5.5mm	4.5mm	338175
M4-M8	6mm	4.9mm	338176
M5-M8	6mm	4.5mm	338177*
M7-M8	6.2mm	5.0mm	338178
M8	8mm	6.2mm	338179
M9-M10	7mm	5.5mm	338180*
M8-M11	8mm	6.0mm	338181*
M10	10mm	8.0mm	338182*
M12	8.5mm	6.5mm	338199
M12	9mm	7.0mm	338183*
M14	11mm	9.0mm	338184*
M14	10.5mm	8.0mm	338185
M16	12mm	9.0mm	338186*
M16	12.5mm	10.0mm	338187
M18	14mm	11.0mm	338188*
M20	15mm	12.0mm	338189
M20	16mm	12.0mm	338190*
M22	17mm	13.0mm	338191
M22-M24	18mm	14.5mm	338192
M24-M25	19mm	15.0mm	338193
M26-M27	20mm	15.0mm	338194*
M27-M30	20mm	16.0mm	338195
M30	22mm	18.0mm	338196
11pc Set			337992
Inch			
0-6	0.141	0.110	338221*
8	0.168	0.131	338222*
10	0.194	0.152	338223*
12	0.220	0.165	338224*
1/4	0.255	0.191	338225*
5/16	0.318	0.238	338226*
3/8	0.381	0.286	338227*
7/16	0.323	0.242	338228*
1/2	0.367	0.275	338229*
9/16	0.429	0.322	338230*
5/8	0.480	0.360	338231*
11/16	0.542	0.406	338232*
3/4	0.590	0.442	338233*
13/16	0.652	0.489	338234*
NPT			
1/16, 1/8-SS (small shank)	0.3125	0.234	338235*
1/8-LS (large shank)	0.4375	0.328	338236
1/4	0.5625	0.421	338237*
16pc Set			337351

* Part of Set

ER40 Collets

Our ER collet system is made of special alloy steel material under excellent heat treatment and precise grinding process, so it has precise accuracy, powerful clamping ability, and is durable. This collet can clamp for a specific standard size and its next size. It can be widely used for boring, milling, drilling and tapping as well as for grinding operation, and is available for all sizes.

AA Collets have a runout of only 5 microns (0.005mm)



REGULAR

Size (mm)	Size (in.)	Code No.	AA Code No.
Metric			
3.0	0.1181		336985
3-3.5	0.118-0.137	337545	336911
3-4	0.118-0.157	337501*	
3.5-4	0.137-0.157		336913*
4-4.5	0.157-0.177	337546	336914
4-5	0.157-0.196	337502*	
4.5-5	0.177-0.196		336916*
5-5.5	0.196-0.216	337547	336917
5-6	0.196-0.236	337503*	
5.5-6	0.216-0.236		336919*
6-6.5	0.236-0.256	337548	336920
6-7	0.236-0.275	337505*	
6.5-7	0.256-0.275		336922*
7-7.5	0.275-0.295	337549	336924
7-8	0.275-0.314	337506*	
7.5-8	0.295-0.314		336926*
8-8.5	0.314-0.335	337554	336927
8-9	0.314-0.354	337507*	
8.5-9	0.335-0.354		336929*
9-9.5	0.354-0.374	337557	336930
9-10	0.354-0.393	337509*	
9.5-10	0.374-0.393		336932*
10-10.5	0.393-0.413	337558	336934
10-11	0.393-0.433	337510*	
10.5-11	0.413-0.433		336935*
10.5-11.5	0.413-0.452	337498	
11-11.5	0.433-0.452		336937
11-12	0.433-0.472	337511*	
11.5-12	0.452-0.472		336939*
12-12.5	0.472-0.492	337559	336940
12-13	0.472-0.511	337513*	
12.5-13	0.492-0.511		336942*
13-13.5	0.511-0.531	336562	336944
13-14	0.511-0.551	337514*	
13.5-14	0.531-0.551		336945*
14-14.5	0.551-0.571	337563	336947
14-15	0.551-0.590	337515*	
14.5-15	0.571-0.590		336948*
15-15.5	0.590-0.610	337564	336950
15-16	0.590-0.629	337517*	
15.5-16	0.610-0.629		336952*
16-16.5	0.629-0.650	337567	336953
16-17	0.629-0.669	337518*	
16.5-17	0.650-0.669		336955*
17-17.5	0.669-0.689	337568	336957
17-18	0.669-0.708	337519*	
17.5-18	0.689-0.708		336958*
18-18.5	0.708-0.728	337569	336960
18-19	0.708-0.748	337521*	
18.5-19	0.728-0.748		336961*
18.5-19.5	0.728-0.767	337496	
19-19.5	0.748-0.767		336963

Size (mm)	Size (in.)	Code No.	AA Code No.
19-20	0.748-0.787	337522*	
19.5-20	0.767-0.787		336965*
20-20.5	0.787-0.807	337572	336966
20-21	0.787-0.826	337523*	
20.5-21	0.807-0.826		336968*
21-21.5	0.826-0.846	337573	336970
21-22	0.826-0.866	337524*	
21.5-22	0.846-0.866		336971*
22-22.5	0.866-0.886	337574	336973
22-23	0.866-0.905	337525*	
22.5-23	0.886-0.905		336974*
23-23.5	0.905-0.925	337577	336976
23-24	0.905-0.944	337526*	
23.5-24	0.925-0.944		336978*
24-24.5	0.944-0.965	337578	336979
24-25	0.944-0.984	337527*	
24.5-25	0.965-0.984		336981*
25-25.5	0.984-1.004	337579	336983
25-26	0.984-1.023	337528*	
25.5-26	1.004-1.023		336984*
23pc Set	3.5-26mm	337386	336991

Inch			
	1/8	337728*	336910*
	5/32	337729*	336912
	3/16	337731*	336915*
	7/32	337732*	336918
	1/4	337733*	336921*
	9/32	337734*	336923
	5/16	337736*	336925*
	11/32	337737*	336928
	3/8	337738*	336931*
	13/32	337739*	336933
	7/16	337741*	336936*
	15/32	337742*	336938
	1/2	337743*	336941*
	17/32	337744*	336943
	9/16	337746*	336946*
	19/32	337747*	336949
	5/8	337748*	336951*
	21/32	337749*	336954
	11/16	337751*	336956*
	23/32	337752*	336959
	3/4	337753*	336962*
	25/32	337754*	336964
	13/16	337756*	336967*
	27/32	337757*	336969
	7/8	337758*	336972*
	29/32	337759*	336975
	15/16	337761*	336977*
	31/32	337762*	336980
	1	337763*	336982*
15pc Set	1/8-1		336997
29pc Set	1/8-1	337409	

* Part of Set

Collet Chucks & Collets

ER40 Sealed Collets

- Sealed for coolant through applications
- Pressure resistance tested to 2000 psi



Metric Size	Code No.	Inch Size	Code No.
6.0	338441	1/8	338238
6.5	338435	5/32	338239
7.0	338443	3/16	338240
7.5	338437	7/32	338241
8.0	338445	1/4	338242
8.5	338439	9/32	338243
9.0	338447	5/16	338244
9.5	338449	11/32	338245
10.0	338440*	3/8	338246
10.5	338442*	13/32	338247
11.0	338444*	7/16	338248
11.5	338446*	15/32	338249
12.0	338448*	1/2	338250
12.5	338450*	17/32	338251
13.0	338452*	9/16	338252
13.5	338454*	19/32	338253
14.0	338456*	5/8	338254
14.5	338458*	21/32	338255
15.0	338460*	11/16	338256
15.5	338462*	23/32	338257
16.0	338464*	3/4	338258
16.5	338468*	25/32	338259
17.0	338470*	13/16	338260
17.5	338472*	27/32	338261
18.0	338474*	7/8	338262
18.5	338476*	29/32	338263
19.0	338478*	15/16	338264
19.5	338480*	31/32	338265
20.0	338482*	1	338266
20.5	338484*		
21.0	338486*		
21.5	338488*		
22.0	338490*		
22.5	338492*		
23.0	338494*		
23.5	338496*		
24.0	338498*		
24.5	338500*		
25.0	338502*		
25.5	338504*		
26.0	338506*		

* Part of set

ER50 Collets

Our ER collet system is made of special alloy steel material under excellent heat treatment and precise grinding process, so it has precise accuracy, powerful clamping ability, and is durable. This collet can clamp for a specific standard size and its next size. It can be widely used for boring, milling, drilling and tapping as well as for grinding operation, and is available for all sizes.

- ER50 collets collapse approximately 5/64" with full accuracy



Size (mm)	Size (in.)	Code No.
10-12	0.394-0.472	337450*
12-14	0.472-0.551	337452*
14-16	0.551-0.630	337454*
16-18	0.630-0.709	337456*
18-20	0.709-0.789	337458*
20-22	0.789-0.866	337460*
22-24	0.866-0.945	337461*
24-26	0.945-1.024	337462*
26-28	1.024-1.102	337464*
28-30	1.102-1.181	337466*
30-32	1.181-1.260	337468*
11pc Set	0.394-1.260	337387

ER40 Tap Collets

- For synchronous, rigid tapping operations using ER collet chuck
- Collet bore is exact tool diameter with square drive for accuracy and rigidity



Tap Inch	Shank Dia.	Size of Square	Code No.
Metric			
M4	2.8mm	2.1mm	338387
M3-M5	3.5mm	2.7mm	338389
M3-M5	4mm	3.0mm	338391
M4-M6	4.5mm	3.4mm	338393
M4-M6	5.5mm	4.3mm	338383
M4-M5	5mm	4.0mm	338395
M5-M5.5	4.5mm	4.5mm	338397
M4-M8	6mm	4.9mm	338385
M5-M8	6mm	4.5mm	338399
M7-M8	6.2mm	5.0mm	338401
M8-M11	8mm	6.0mm	338405
M8	8mm	6.2mm	338409
M10	7mm	5.5mm	338403
M10	10mm	8.0mm	338413
M12	8.5mm	6.5mm	338407
M12	9mm	7.0mm	338411
M14	10.5mm	8.0mm	338415
M14	11mm	9.0mm	338417
M16	12mm	9.0mm	338419
M16	12.5mm	10.0mm	338421
M18	14mm	11.0mm	338423
M20	15mm	12.0mm	338425
M20	16mm	12.0mm	338427
M22	17mm	13.0mm	338429
M22-M24	18mm	14.5mm	338431
M27-M30	20mm	16.0mm	338433
Inch			
0-6	0.141	0.110	338267*
8	0.168	0.131	338268*
10	0.194	0.152	338269*
12	0.220	0.165	338270*
1/4	0.255	0.191	338271*
5/16	0.318	0.238	338272*
3/8	0.381	0.286	338273*
7/16	0.323	0.242	338274*
1/2	0.367	0.275	338275*
9/16	0.429	0.322	338276*
5/8	0.480	0.360	338277*
11/16	0.542	0.406	338278*
3/4	0.590	0.442	338279*
13/16	0.652	0.489	338280*
7/8	0.697	0.523	338281*
15/16	0.760	0.570	338282*
1	0.800	0.600	338283*
NPT			
1/16, 1/8-SS (small shank)	0.3125	0.234	338284*
1/8-LS (large shank)	0.4375	0.328	338285
1/4	0.5625	0.421	338286*
3/8	0.7000	0.531	338287*
1/2	0.6875	0.515	338288*
21pc Set			337353

* Part of set

ER Collet Sets



* Case may not be as shown



ER11 / 13 Pieces		ER16 / 10 Pieces		ER20 / 12 Pieces		ER25 / 15 Pieces	
Code No. 337379		Code No. 337380		Code No. 337382		Code No. 337383	
Code No.	Size	Code No.	Size	Code No.	Size	Code No.	Size
337650	0.019-0.039	337302	0.019-0.039	337473	0.059-0.078	337330	0.059-0.078
337652	0.039-0.059	337304	0.059-0.078	337474	0.098-0.118	337332	0.098-0.118
337654	0.059-0.078	337306	0.098-0.118	337475	0.137-0.157	337334	0.137-0.157
337656	0.078-0.098	337308	0.137-0.157	337476	0.177-0.196	337336	0.177-0.196
337658	0.098-0.118	337310	0.177-0.196	337477	0.217-0.236	337338	0.217-0.236
337660	0.118-0.137	337312	0.217-0.236	337478	0.256-0.275	337340	0.256-0.275
337662	0.137-0.157	337314	0.256-0.275	337479	0.295-0.314	337342	0.295-0.314
337664	0.157-0.177	337316	0.295-0.314	337480	0.335-0.354	337344	0.335-0.354
337666	0.177-0.196	337318	0.335-0.354	337481	0.374-0.393	337346	0.374-0.393
337668	0.196-0.216	337320	0.374-0.393	337482	0.413-0.433	337348	0.413-0.433
337670	0.216-0.236			337483	0.452-0.472	337350	0.452-0.472
337672	0.236-0.255			337484	0.492-0.511	337352	0.492-0.511
337674	0.255-0.275					337354	0.531-0.551
						337356	0.571-0.590
						337358	0.610-0.629

ER32 / 18 Pieces		ER40 / 23 Pieces		ER50 / 11 Pieces	
Code No. 337384		Code No. 337386		Code No. 337387	
Code No.	Size	Code No.	Size	Code No.	Size
337361	0.098-0.118	337501	0.137-0.157	337450	0.394-0.472
337362	0.137-0.157	337502	0.177-0.196	337452	0.472-0.551
337363	0.177-0.196	337503	0.216-0.236	337454	0.551-0.630
337364	0.217-0.236	337505	0.256-0.275	337456	0.630-0.709
337365	0.256-0.275	337506	0.295-0.314	337458	0.709-0.789
337366	0.295-0.314	337507	0.335-0.354	337460	0.789-0.866
337367	0.335-0.354	337509	0.374-0.393	337461	0.866-0.945
337368	0.374-0.393	337510	0.413-0.433	337462	0.945-1.024
337369	0.413-0.433	337511	0.452-0.472	337464	1.024-1.102
337370	0.452-0.472	337513	0.492-0.511	337466	1.102-1.181
337371	0.492-0.511	337514	0.531-0.551	337468	1.181-1.260
337372	0.531-0.551	337515	0.571-0.590		
337373	0.571-0.590	337517	0.610-0.629		
337374	0.610-0.629	337518	0.650-0.669		
337375	0.650-0.669	337519	0.689-0.708		
337376	0.689-0.708	337521	0.728-0.748		
337377	0.728-0.748	337522	0.767-0.787		
337378	0.767-0.787	337523	0.807-0.826		
		337524	0.846-0.866		
		337525	0.886-0.905		
		337526	0.925-0.944		
		337527	0.965-0.984		
		337528	1.004-1.023		

ER Sealed Collet Sets



Collet	Description	Range	Code No.
ER11	Inch 6pc Sealed Collet Set	3/16-17/64 x 64ths	337929
ER16	Inch 10pc Sealed Collet Set	1/8-13/32 x 32nds	337931
ER16	Metric 13pc Sealed Collet Set	4.0-10.0mm x 0.5mm	337932
ER20	Inch 12pc Sealed Collet Set	5/32-1/2 x 32nds	337933
ER20	Metric 17pc Sealed Collet Set	5.0-13.0mm x 0.5mm	337935
ER25	Inch 13pc Sealed Collet Set	1/4-5/8 x 32nds	337938
ER25	Metric 21pc Sealed Collet Set	6.0-16.0mm x 0.5mm	337939
ER32	Inch 17pc Sealed Collet Set	1/4-3/4 x 32nds	337940
ER32	Metric 20pc Sealed Collet Set	10.5-20.0mm x 0.5mm	337942
ER40	Metric 33pc Sealed Collet Set	10.0-26.0mm x 0.5mm	337944

ER Tap Collet Sets



- For synchronous, rigid tapping operations using ER collet chucks
- Collet bore is exact tool diameter with square drive for accuracy and rigidity
- See page G63-67 for rigid tapping holders

Collet	Description	Range	Code No.
Metric			
ER32	11pc Tap Collet Set	M4 - M26	337992
Inch			
ER16	5pc Tap Collet Set	#6 - 1/4"	337986
ER16	9pc Tap Collet Set	#6 - 1/2"	337343
ER20	9pc Tap Collet Set	#6 - 1/2"	337345
ER32	16pc Tap Collet Set	#6 - 13/16"	337351
ER40	21pc Tap Collet Set	#6 - 1"	337353

ER Inch Collet Sets



ER11 / 7 Pieces		ER16 / 11 Pieces		ER20 / 15 Piece		ER25 / 17 Pieces		ER32 / 21 Pieces		ER40 / 29 Pieces	
Code No. 337401		Code No. 337403		Code No. 337404		Code No. 337405		Code No. 337407		Code No. 337409	
Code No.	Size	Code No.	Size	Code No.	Size	Code No.	Size	Code No.	Size	Code No.	Size
337610	1/16	337531	1/16	337621	1/16	337683	1/8	337703	1/8	337728	1/8
337613	3/32	337532	3/32	337623	3/32	337684	5/32	337704	5/32	337729	5/32
337615	1/8	337533	1/8	337663	1/8	337685	3/16	337706	3/16	337731	3/16
337618	5/32	337534	5/32	337665	5/32	337686	7/32	337707	7/32	337732	7/32
337651	3/16	337535	3/16	337667	3/16	337687	1/4	337708	1/4	337733	1/4
337655	7/32	337536	7/32	337669	7/32	337688	9/32	337709	9/32	337734	9/32
337659	1/4	337537	1/4	337671	1/4	337689	5/16	337711	5/16	337736	5/16
		337538	9/32	337673	9/32	337691	11/32	337712	11/32	337737	11/32
		337540	5/16	337675	5/16	337692	3/8	337713	3/8	337738	3/8
		337541	11/32	337676	11/32	337693	13/32	337714	13/32	337739	13/32
		337542	3/8	337677	3/8	337694	7/16	337716	7/16	337741	7/16
				337678	13/32	337696	15/32	337717	15/32	337742	15/32
				337679	7/16	337697	1/2	337718	1/2	337743	1/2
				337681	15/32	337698	17/32	337719	17/32	337744	17/32
				337682	1/2	337699	9/16	337721	9/16	337746	9/16
						337701	19/32	337722	19/32	337747	19/32
						337702	5/8	337723	5/8	337748	5/8
								337724	21/32	337749	21/32
								337725	11/16	337751	11/16
								337726	23/32	337752	23/32
								337727	3/4	337753	3/4
										337754	25/32
										337756	13/16
										337757	27/32
										337758	7/8
										337759	29/32
										337761	15/16
										337762	31/32
										337763	1

Replacement ER Chuck Nuts



Collet Nut for ER32 Shorty Collet Chuck

Description	Steam Oxide		Balanced & Bright	
	Code No.	Code No.	Code No.	Code No.
ER11 Nut (Hex)	337680	534790		
ER16 Nut (Hex)	337389	534792		
ER20 Nut (Hex)	337391	534794		
ER25 Nut (Notched)	337390	534796		
ER32 Nut (Notched)	337392	534798		
ER40 Nut (Notched)	337393	534800		
ER50 Nut (Notched)	337385			
ER32 Shorty Collet Nut				
Fits ER32 Shorty Chucks (M40 x 1.5 Thread)		337411		

ER Chuck Nut Wrenches



Wrench for ER32 Shorty Collet Chuck

Description	Code No.
Fits ER11 Chucks (Hex)	337388
Fits ER16 Chucks (Hex)	337395
Fits ER20 Chucks (Hex)	337397
Fits ER25 Chucks (Notched)	337396
Fits ER32 Chucks (Notched)	337398
Fits ER40 Chucks (Notched)	337399
ER32 Shorty Chuck Wrench	
Fits ER32 Shorty Chucks	337381

Replacement Backup Screws



Description	Code No.
ER11 Backup Screws	534814
ER16 Backup Screws	534816
ER20 Backup Screws	534818
ER25 Backup Screws	534820
ER32 Backup Screws	534822
ER40 Backup Screws	534824

CAT Taper SA High Precision Collet Chucks



- DIN coolant through the flange at no extra charge
- Run out accuracy is > 5µm at 4xD of the cutting tool shank
- 8° tapered collet seats deeper in the body of the holder providing increased rigidity. This results in concentricity and stronger gripping power
- Wrench not included
- AT2 Taper Accuracy
- RFID chip hole



Taper	Collet Series	Collet Range	Gauge Length	Code No.
CAT40				
CT40	SA10	0.069-0.394	3.54	531756
CT40	SA10	0.069-0.394	4.72	531758
CT40	SA16	0.108-0.630	3.54	531762
CT40	SA16	0.108-0.630	5.91	531766
CT40	SA25	0.630-1.00	3.54	531768
CAT50				
CT50	SA10	0.069-0.394	4.13	531776
CT50	SA16	0.108-0.630	4.13	531782
CT50	SA25	0.630-1.00	4.13	531788

Replacement SA Collet Nuts



Description	Code No.
SA10 Nut (Hex)	536588
SA16 Nut (Notched)	536590
SA25 Nut (Notched)	536592

SA Collet Chuck Wrenches



Description	Code No.
Fits SA10	536580
Fits SA16	536582
Fits SA25	536584

SA Collet Extractors



Description	Code No.
SA10	536572
SA16	536574
SA25	536576

SA10 Collets



Size	Collapse Range (mm)	Collapse Range (in.)	Code No.
Metric			
2.0mm	1.75-2.0	0.068-0.078	338564
2.25mm	2.0-2.25	0.078-0.088	338566
2.5mm	2.25-2.5	0.088-0.098	338568
3.0mm	2.75-3.0	0.108-0.118	338572
3.5mm	3.0-3.5	0.118-0.137	338574
4.0mm	3.5-4.0	0.137-0.157	338576
4.5mm	4.0-4.5	0.157-0.177	338578
5.0mm	4.5-5.0	0.177-0.196	338580
5.5mm	5.0-5.5	0.196-0.216	338582
6.0mm	5.5-6.0	0.216-0.236	338583
6.5mm	6.0-6.5	0.236-0.255	338584
7.0mm	6.5-7.0	0.255-0.275	338586
7.5mm	7.0-7.5	0.275-0.295	338588
8.0mm	7.5-8.0	0.295-0.314	338590
8.5mm	8.0-8.5	0.314-0.334	338592
9.0mm	8.5-9.0	0.334-0.354	338594
9.5mm	9.0-9.5	0.354-0.374	338596
10.0mm	9.5-10.0	0.374-0.393	338598
Inch			
1/8	-	-	338602
3/16	-	-	338604
1/4	-	-	338606
5/16	-	-	338608
3/8	-	-	338610

SA25 Collets



Size	Collapse Range (mm)	Collapse Range (in.)	Code No.
Metric			
16.5mm	16.0-16.5	0.629-0.649	338694
17.0mm	16.5-17.0	0.649-0.669	338696
17.5mm	17.0-17.5	0.669-0.688	338698
18.0mm	17.5-18.0	0.688-0.708	338700
18.5mm	18.0-18.5	0.708-0.728	338702
19.0mm	18.5-19.0	0.728-0.748	338704
20.0mm	19.5-20.0	0.767-0.787	338708
20.5mm	20.0-20.5	0.787-0.807	338710
21.0mm	20.5-21.0	0.807-0.826	338712
21.5mm	21.0-21.5	0.826-0.846	338714
22.0mm	21.5-22.0	0.846-0.866	338716
23.0mm	22.5-23.0	0.885-0.905	338720
24.0mm	23.5-24.0	0.925-0.944	338724
24.5mm	24.0-24.5	0.944-0.964	338726
25.0mm	24.5-25.0	0.964-0.984	338728
25.4mm	25.0-25.4	0.984-1.000	338730
Inch			
1/4	-	-	338736
5/16	-	-	338738
3/8	-	-	338740
7/16	-	-	338742
1/2	-	-	338744
5/8	-	-	338746
3/4	-	-	338748

SA16 Collets



Size	Collapse Range (mm)	Collapse Range (in.)	Code No.
Metric			
2.0mm			338614
2.5mm			338616
3.0mm	2.75-3.0	0.108-0.118	338618
3.5mm	3.0-3.5	0.118-0.137	338620
4.0mm	3.5-4.0	0.137-0.157	338622
4.5mm	4.0-4.5	0.157-0.177	338624
5.0mm	4.5-5.0	0.177-0.196	338626
5.5mm	5.0-5.5	0.196-0.216	338628
6.0mm	5.5-6.0	0.216-0.236	338630
6.5mm	6.0-6.5	0.236-0.255	338632
7.0mm	6.5-7.0	0.255-0.275	338634
7.5mm	7.0-7.5	0.275-0.295	338636
8.0mm	7.5-8.0	0.295-0.314	338638
8.5mm	8.0-8.5	0.314-0.334	338640
9.0mm	8.5-9.0	0.334-0.354	338642
9.5mm	9.0-9.5	0.354-0.374	338644
10.0mm	9.5-10.0	0.374-0.393	338646
10.5mm	10.0-10.5	0.393-0.413	338648
11.0mm	10.5-11.0	0.413-0.433	338650
11.5mm	11.0-11.5	0.433-0.452	338652
12.0mm	11.5-12.0	0.452-0.472	338654
12.5mm	12.0-12.5	0.472-0.492	338656
13.0mm	12.5-13.0	0.492-0.511	338658
13.5mm	13.0-13.5	0.511-0.531	338660
14.0mm	13.5-14.0	0.531-0.551	338662
14.5mm	14.0-14.5	0.551-0.570	338664
15.0mm	14.5-15.0	0.570-0.590	338666
15.5mm	15.0-15.5	0.590-0.610	338668
16.0mm	15.5-16.0	0.610-0.629	338670
Inch			
1/8	-	-	338674
3/16	-	-	338676
1/4	-	-	338678
5/16	-	-	338680
3/8	-	-	338682
7/16	-	-	338684
1/2	-	-	338686
9/16	-	-	338688
5/8	-	-	338690

CAT Taper TG Collet Chucks



- DIN coolant through the flange
- Shank traverse ground to obtain optimum accuracy
- Meets or exceeds ANSI specifications
- Wrench not included
- Factory balanced to save spindle life, tool life and increased productivity
- Threaded through holes for a back-up screw (tool stop) or coolant through when removed
- TIR, 0.0006"
- AT2 Taper Accuracy
- RFID chip hole

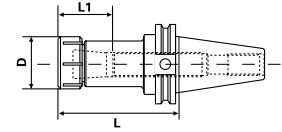

PREMIUM BALANCE
G6.3 at 25,000rpm
CERTIFICATE INCLUDED

PREMIUM BALANCE
G6.3 at 30,000rpm
CERTIFICATE INCLUDED

CAT50 CAT40

Taper	Collet Series	Collet Range	L	L1	D	Tightening Torque (Nm)	Code No.
CAT40							
CT40	TG75	3/64-3/4	3.00	1.61	1.89	81.3	531284
CT40	TG75	3/64-3/4	5.00	1.61	1.89	81.3	531286
CT40	TG100	3/64-1	3.00	2.13	2.50	81.3	531288
CT40	TG100	3/64-1	3.50	2.13	2.50	81.3	531290
CT40	TG100	3/64-1	5.50	2.13	2.50	81.3	531292
CT40	TG150	1/2-1-1/2	6.00	2.88	3.50	94.9	531294
CAT50							
CT50	TG75	3/64-3/4	3.50	1.61	1.89	81.3	531296
CT50	TG100	3/64-1	3.50	2.13	2.50	81.3	531300
CT50	TG100	3/64-1	5.50	2.13	2.50	81.3	531302
CT50	TG100	3/64-1	7.50	2.13	2.50	81.3	531304
CT50	TG100	3/64-1	10.00	2.13	3.50	81.3	531306
CT50	TG150	1/2-1-1/2	3.50	2.88	3.50	94.9	531308
CT50	TG150	1/2-1-1/2	6.00	2.88	3.50	94.9	531310

BT Taper TG Collet Chucks



- DIN coolant through the flange
- Shank traverse ground to obtain optimum accuracy
- Meets or exceeds ANSI specifications
- Wrench not included
- Factory balanced to save spindle life, tool life and increased productivity
- Threaded through holes for a back-up screw (tool stop) or coolant through when removed
- TIR, 0.0006"
- AT2 Taper Accuracy
- RFID chip hole

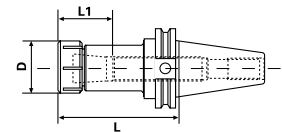

PREMIUM BALANCE
G6.3 at 25,000rpm
CERTIFICATE INCLUDED

PREMIUM BALANCE
G6.3 at 30,000rpm
CERTIFICATE INCLUDED

BT50 BT30/40

Taper	Collet Series	Collet Range	L	L1	D	Tightening Torque (Nm)	Code No.
BT30							
BT30	TG75	3/64-3/4	2.50	1.61	1.89	81.3	532128‡
BT30	TG100	3/64-1	3.94	2.24	2.50	81.3	532130‡
BT40							
BT40	TG75	3/64-3/4	3.00	1.61	1.89	81.3	532132
BT40	TG100	3/64-1	3.50	2.13	2.50	81.3	532134
BT40	TG100	3/64-1	5.50	2.13	2.50	81.3	532136
BT50							
BT50	TG100	3/64-1	4.00	2.13	2.50	81.3	532139
BT50	TG100	3/64-1	6.00	2.13	2.50	81.3	532140

‡ Not DIN Coolant

NMTB Taper TG Collet Chucks

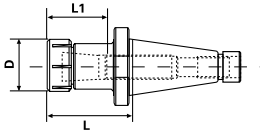

Taper	Collet Series	Collet Range	L	L1	D	Tightening Torque (Nm)	Code No.
NMTB40	TG100	3/64-1	3.00	2.12	2.50	81.3	534304
NMTB50	TG75	3/64-3/4	3.00	1.61	1.89	81.3	534308
NMTB50	TG100	3/64-1	3.50	2.12	2.50	81.3	534310

R8 Taper TG Collet Chuck

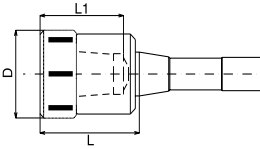

Taper	Collet Series	Collet Range	L	L1	D	Tightening Torque (Nm)	Code No.
R8	TG100	3/64-1	3.25	2.17	2.50	81.3	534314

Morse Taper TG Collet Chucks

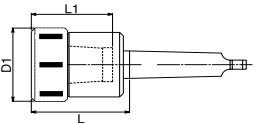

Taper	Collet Series	Collet Range	L	L1	D	Tightening Torque (Nm)	Code No.
MT3	TG100	3/64-1	3.25	2.73	2.50	81.3	534322
MT4	TG100	3/64-1	3.25	2.73	2.50	81.3	534324

Straight Shank TG Collet Chucks

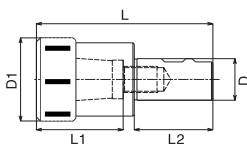

Shank Dia.	Collet Series	Collet Range	L	L1	L2	D1	Tightening Torque (Nm)	Code No.
1-1/2	TG100	3/64-1	9.00	2.73	6.00	2.50	81.3	534320

TG75 Standard & Sealed Collets



- 1/64" collapse per collet
- 0.0005" in TIR precision per DIN 6341
- 80 ft/lbs maximum tightening torque

Sealed Collets

- Sealed for coolant-through applications
- Pressure resistance tested to 1000 psi
- Sealed with rubber



REGULAR



SEALED

Size (in.)	Regular Code No.	Sealed Code No.
3/64	334790	-
1/16	334791	-
5/64	334792	-
3/32	334800	-
7/64	334801	-
1/8	334802	334843
9/64	334803	334844
5/32	334804	334845
11/64	334805	334846
3/16	334806	334847
13/64	334807	334848
7/32	334808	334849
15/64	334809	334850
1/4	334810	334851
17/64	334811	334852
9/32	334812	334853
19/64	334813	334854
5/16	334814	334855
21/64	334815	334856
11/32	334816	334857
23/64	334817	334858
3/8	334818	334859
25/64	334819	334860
13/32	334820	334861
27/64	334821	334862
7/16	334822	334863
29/64	334823	334864
15/32	334824	334865
31/64	334825	334866
1/2	334826	334867
33/64	334827	334868
17/32	334828	334869
35/64	334829	334870
9/16	334830	334871
37/64	334831	334872
19/32	334832	334873
39/64	334833	334874
5/8	334834	334875
41/64	334835	334876
21/32	334836	334877
43/64	334837	334878
11/16	334838	334879
45/64	334839	334880
23/32	334840	334881
47/64	334841	334882
3/4	334842	334883

TG75 Tap Collets

- For synchronous, rigid tapping operations using TG collet chuck
- Collet bore is exact tool diameter with square drive for accuracy and rigidity



Tap Inch	Shank Dia. (in.)	Size of Square (in.)	Code No.
0-6	0.141	0.110	334884
8	0.168	0.131	334885
10	0.194	0.152	334886
12	0.220	0.165	334887
1/4	0.255	0.191	334888
5/16	0.318	0.238	334889
3/8	0.381	0.286	334890
7/16	0.323	0.242	334891
1/2	0.367	0.275	334892
9/16	0.429	0.322	334893
5/8	0.480	0.360	334894
11/16	0.542	0.406	334895
3/4	0.590	0.442	334896
NPT			
1/16, 1/8 NPT-ss*	0.3125	0.234	334897
1/8 NPT-LS*	0.4375	0.328	334898
1/4 NPT	0.5625	0.421	334899

*ss = small shank
*LS = large shank

Standard TG75 Collet Sets

- 1/64" collapse per collet
- 0.0005" in TIR precision per DIN 6341
- 80 ft/lbs maximum tightening torque



No. of Pieces	Range (in.)	Increment (in.)	Code No.
43	3/32-3/4	1/64	334900
41	1/8-3/4	1/64	334901
33	1/4-3/4	1/64	334902
25	3/8-3/4	1/64	334903
22	3/32-3/4	1/32	334904
13	3/8-3/4	1/32	334905
11	1/8-3/4	1/16	334906

TG100 Standard & Sealed Collets

- 1/64" collapse per collet
- 0.0005" in TIR precision per DIN 6341
- 90 ft/lbs maximum tightening torque

Sealed Collets

- Sealed for coolant-through applications
- Pressure resistance tested between 650 - 750 psi
- Sealed with rubber



REGULAR

SEALED



Size (in.)	Regular Code No.	Sealed Code No.
3/64	334418	-
5/64	334423	-
3/32	334425N	-
7/64	334426	-
1/8	334427N	-
9/64	334428	-
5/32	334429N	334907
11/64	334430	334908
3/16	334431N	334909
13/64	334432	334910
7/32	334433N	334911
15/64	334434	334912
1/4	334435N	334913
17/64	334436	334914
9/32	334437N	334915
19/64	334438	334916
5/16	334439N	334917
21/64	334440	334918
11/32	334441N	334919
23/64	334442	334920
3/8	334443N	334921
25/64	334444	334922
13/32	334445N	334923
27/64	334446	334924
7/16	334447N	334925
29/64	334448	334926
15/32	334449N	334927
31/64	334450	334928
1/2	334451N	334929
33/64	334452	334930
17/32	334453N	334931
35/64	334454	334932
9/16	334455N	334933
37/64	334456	334934
19/32	334457N	334935
39/64	334458	334936
5/8	334459N	334937
41/64	334460	334938
21/32	334461N	334939
43/64	334462	334940
11/16	334463N	334941
45/64	334464	334942
23/32	334465N	334943
47/64	334466	334944
3/4	334467N	334945
49/64	334468	334946
25/32	334469N	334947
51/64	334470	334948
13/16	334471N	334949
53/64	334472	334950
27/32	334473N	334951
55/64	334474	334952
7/8	334475N	334953
57/64	334476	334954
29/32	334477N	334955
59/64	334478	334956
15/16	334479N	334957
61/64	334480	334958
31/32	334481N	334959
63/64	334482	334960
1	334483N	334961

TG100 Tap Collets

- For synchronous, rigid tapping operations using TG collet chuck
- Collet bore is exact tool diameter with square drive for accuracy and rigidity



Tap Inch	Shank Dia.	Size of Square	Code No.
0-6	0.141	0.110	334963
8	0.168	0.131	334964
10	0.194	0.152	334965
12	0.220	0.165	334966
1/4	0.255	0.191	334967
5/16	0.318	0.238	334968
3/8	0.381	0.286	334969
7/16	0.323	0.242	334970
1/2	0.367	0.275	334971
9/16	0.429	0.322	334972
5/8	0.480	0.360	334973
11/16	0.542	0.406	334974
3/4	0.590	0.442	334975
13/16	0.652	0.489	334976
7/8	0.697	0.523	334977
15/16	0.760	0.570	334978
1	0.800	0.600	334979
NPT			
1/16, 1/8 NPT-ss*	0.3125	0.234	334980
1/8 NPT-LS*	0.4375	0.328	334981
1/4 NPT	0.5625	0.421	334982
3/8 NPT	0.7000	0.531	334983
1/2 NPT	0.6875	0.515	334984

*ss = small shank
*LS = large shank

Standard TG100 Collet Sets

- 1/64" collapse per collet
- 0.0005" in TIR precision per DIN 6341
- 90 ft/lbs maximum tightening torque



No. of Pieces	Range (in.)	Increment (in.)	Code No.
59	3/32-1	1/64	334575
41	3/8-1	1/64	334570
30	3/32-1	1/32	334565
21	3/8-1	1/32	334560
15	1/8-1	1/16	334561

TG150 Standard Collets

- Unique 8" taper design affords highest gripping power
- True double angle, for extreme concentricity
- 16 jaws giving powerful gripping and parallel clamping
- A unique self releasing system is built into the collet and clamping nut to eliminate cutting tools sticking in collets
- 1/64" collapse per collet
- 0.0005" in TIR precision per DIN 6341



Size (in.)	Code No.	Size (in.)	Code No.
1/2	334485N	1-1/64	334518
33/64	334486	1-1/32	334519N
17/32	334487N	1-3/64	334520
35/64	334488	1-1/16	334521N
9/16	334489N	1-5/64	334522
37/64	334490	1-3/32	334523N
19/32	334491N	1-7/64	334524
39/64	334492	1-1/8	334525N
5/8	334493N	1-9/64	334526
41/64	334494	1-5/32	334527N
21/32	334495N	1-11/64	334528
43/64	334496	1-3/16	334529N
11/16	334497N	1-13/64	334530
45/64	334498	1-7/32	334531N
23/32	334499N	1-15/64	334532
47/64	334500	1-1/4	334533N
3/4	334501N	1-17/64	334534
49/64	334502	1-9/32	334535N
25/32	334503N	1-19/64	334536
51/64	334504	1-5/16	334537N
13/16	334505N	1-21/64	334538
53/64	334506	1-11/32	334539N
27/32	334507N	1-23/64	334540
55/64	334508	1-3/8	334541N
7/8	334509N	1-25/64	334542
57/64	334510	1-13/32	334543N
29/32	334511N	1-27/64	334544
59/64	334512	1-7/16	334545N
15/16	334513N	1-29/64	334546
61/64	334514	1-15/32	334547N
31/32	334515N	1-31/64	334548
63/64	334516	1-1/2	334549N
1	334517N		

Standard TG150 Collet Sets

- Unique 8" taper design affords highest gripping power
- True double angle, for extreme concentricity
- 16 jaws giving powerful gripping and parallel clamping
- A unique self releasing system is built into the collet and clamping nut to eliminate cutting tools sticking in collets
- 1/64" collapse per collet
- 0.0005" in TIR precision per DIN 6341



No. of Pieces	Range (in.)	Increment (in.)	Code No.
33	1/2-1-1/2	1/32	334585

Collet Chucks & Collets

Replacement TG Chuck Nuts



Description	Tightening Torque (Nm)	Code No.
*TG75 Nut	81.3	534760
*TG100 Nut	81.3	534762
*TG150 Nut	94.9	534764
TG75 Nut, Solid	81.3	534830
TG100 Nut, Solid	81.3	534832

* Photo Shown / This style is supplied with chuck

TG Chuck Wrenches



Description	Code No.
Fits TG75 Chuck	534772
Fits TG100 Chuck	534774
Fits TG150 Chuck	534776

Replacement TG Backup Screws



Description	Code No.
TG75	534778
TG100	534782
TG150	534786
TG150 Coolant	534788

TG Collet Dimensional Data

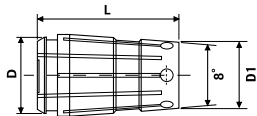

Style	D	D1	L	Collet Range
TG25	0.425	0.325	0.709	3/64-1/4
TG50	0.760	0.594	1.437	1/8-1/2
TG75	1.063	0.871	1.844	3/64-3/4
TG100	1.278	1.121	2.386	3/64-1
TG150	1.875	1.678	3.000	1/2-1-1/2

CAT40 Milling Chucks

- DIN coolant through the flange at no extra charge
- Rough milling or 'hogging' operations
- Improved tool life over regular end mill holders
- '360°' gripping contact
- Extreme rigidity over taper collets
- TIR, 0.0002"
- AT2 Taper Accuracy
- RFID chip hole

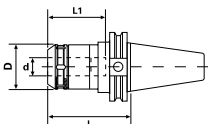

Taper	Collet Series	Collet Range	d	L	L1	D	Tightening Torque (Nm)	Code No.
CT40	GS 3/4	0.125-0.750	0.750	3.54	3.15	2.05	50-70	531253
CT40	GS 3/4	0.125-0.750	0.750	4.14	3.15	2.05	50-70	531250
CT40	GS 1	0.125-1.00	1.00	3.54	3.15	2.41	50-70	531255‡
CT40	GS 1	0.125-1.00	1.00	4.14	3.15	2.41	50-70	531254
CT40	GS 1-1/4	0.187-1.25	1.25	3.54	3.34	2.88	60-80	531257‡
CT40	GS 1-1/4	0.187-1.25	1.25	4.14	3.34	2.88	60-80	531256
CT40	GS 1-1/4	0.187-1.25	1.25	5.32	4.73	2.88	60-80	531258

‡ Not DIN Coolant

CAT40 DUAL CONTACT Milling Chucks

- Improves rigidity and reduces vibration allowing for increased feed rates and increased tool life
- DIN coolant through the flange at no extra charge
- Rough milling or 'hogging' operations
- '360°' gripping contact
- Improved tool life over regular end mill holders
- Extreme rigidity over taper collets
- TIR, 0.0002"
- RFID chip hole
- AT2 Taper Accuracy

FOR DUAL CONTACT SPINDLES

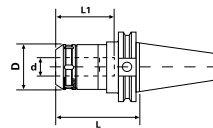

Taper	Collet Series	Collet Range	d	L	L1	D	Tightening Torque (Nm)	Code No.
CT40	GS 3/4	0.125-0.750	0.750	3.54	3.15	2.05	50-70	521253
CT40	GS 1	0.125-1.00	1.00	3.54	3.15	2.41	50-70	521255‡
CT40	GS 1-1/4	0.187-1.25	1.25	3.54	3.34	2.88	60-80	521257‡

‡ Not DIN Coolant

BT Taper Milling Chucks

- TIR 0.0004"
- AT2 Taper Accuracy
- RFID chip hole

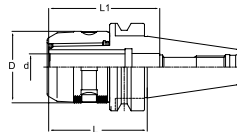

Taper	Collet Series	Collet Range	d	L	L1	D	Code No.
BT30							
BT30	GS 3/4	0.125-0.750	0.750	3.55	3.15	2.05	532096‡
BT40							
BT40	GS 3/4	0.125-0.750	0.750	4.14	3.15	2.05	532098
BT40	GS 3/4	0.125-0.750	0.750	4.73	3.15	2.05	532100
BT40	GS 1	0.125-1.00	1.00	4.14	3.15	2.41	532102
BT40	GS 1-1/4	0.187-1.25	1.25	4.14	3.34	2.88	532104
BT50							
BT50	GS 1-1/4	0.187-1.25	1.25	4.20	3.34	2.88	532113

‡ Not DIN Coolant

CAT50 Milling Chucks

- DIN coolant through the flange at no extra charge
- Rough milling or 'hogging' operations
- Improved tool life over regular end mill holders
- '360°' gripping contact
- Extreme rigidity over taper collets
- TIR, 0.0002"
- AT2 Taper Accuracy
- RFID chip hole

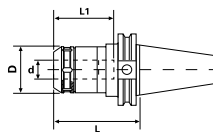

Taper	Collet Series	Collet Range	d	L	L1	D	Tightening Torque (Nm)	Code No.
CT50	GS 3/4	0.125-0.750	0.750	4.14	3.15	2.05	50-70	531260
CT50	GS 3/4	0.125-0.750	0.750	5.32	3.15	2.05	50-70	531262
CT50	GS 3/4	0.125-0.750	0.750	6.49	3.15	2.05	50-70	531263
CT50	GS 1	0.125-1.00	1.00	4.14	3.15	2.41	50-70	531264
CT50	GS 1-1/4	0.187-1.25	1.25	3.54	4.73	2.88	60-80	531265
CT50	GS 1-1/4	0.187-1.25	1.25	4.14	4.73	2.88	60-80	531266
CT50	GS 1-1/4	0.187-1.25	1.25	5.32	4.73	2.88	60-80	531268
CT50	GS 1-1/4	0.187-1.25	1.25	6.49	4.73	2.88	60-80	531269

CAT50 DUAL CONTACT Milling Chucks



- Improves rigidity and reduces vibration allowing for increased feed rates and increased tool life
- DIN coolant through the flange at no extra charge
- Rough milling or 'hogging' operations
- Improved tool life over regular end mill holders
- '360°' gripping contact
- Extreme rigidity over taper collets
- TIR, 0.0002"
- RFID chip hole
- AT2 Taper Accuracy

FOR DUAL CONTACT SPINDLES

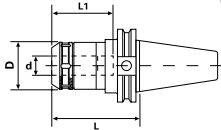
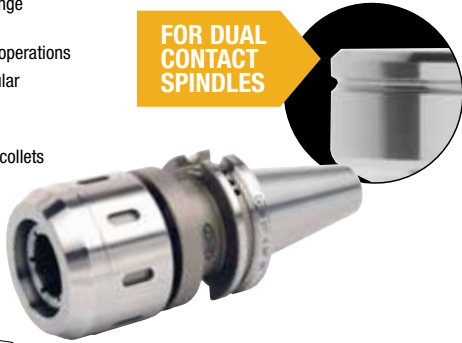

Taper	Collet Series	Collet Range	d	L	L1	D	Tightening Torque (Nm)	Code No.
CT50	GS 1-1/4	0.187-1.25	1.25	4.14	4.73	2.88	50-70	521266

HSK Milling Chucks



HSK Advantages:

- High rigidity and torque transmission (almost double the rigidity of V-flange holders)
- Extreme concentricity enhance tool life performance
- Coolant through capabilities
- TIR 0.0004"
- RFID chip hole
- AT2 Taper Accuracy

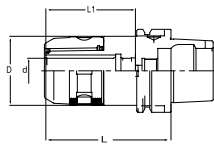

Taper	Collet Series	Collet Range	d	L	L1	D	Code No.
HSK63A							
HSK63A	GS3/4	0.125-0.750	0.750	3.740	2.480	2.047	536154
HSK63A	GS1	0.125-1.000	1.000	5.118	3.150	2.362	536160
HSK63A	GS1-1/4	0.187-1.250	1.250	4.331	3.268	2.717	536162
HSK100A							
HSK100A	GS3/4	0.125-0.750	0.750	5.315	3.150	2.047	536170
HSK100A	GS32	3mm - 32mm	32mm	5.315	4.055	2.717	536180
HSK100A	GS2	1.000-2.000	2.000	4.921	3.543	4.134	536182

Milling Chuck Wrenches



Chuck Cap.	Code No.
3/4	534208
1	534210
1-1/4	534212

GS Milling Collets



I.D.	GS 3/4" Code No.	GS 1" Code No.	GS 1 1/4" Code No.
Metric			
6mm	534668	534702	534740
7mm	534670	-	-
8mm	534672	534704	534742
10mm	534674	534706	534744
12mm	534676	534708	534746
14mm	534678	534710	534748
16mm	534680	534712	534750
18mm	-	534714	-
20mm	-	534716	534752
25mm	-	-	534754
Inch			
1/8	534650	534682	-
3/16	331469N	534684	331481N
1/4	331470N	534686	331482N
5/16	331472N	534688	331484N
3/8	331474N	534690	331486N
7/16	534660	534692	534726
1/2	331476N	534694	331488N
9/16	331477N	-	331489N
5/8	331478N	534696	331490N
3/4	-	534698	331492N
7/8	-	-	331494N
1	-	-	331496N

Replacement DA Chuck Nuts



Description	Code No.
DA100, Complete Replacement	534264
DA180 Nut, Complete Replacement	534270
DA200 Nut, Complete Replacement	534276
DA300 Nut, Complete Replacement	534277

CAT40 DA Collet Chucks



- DIN coolant through the flange
- All ground body
- TIR 0.0010"
- AT2 Taper Accuracy
- RFID chip hole

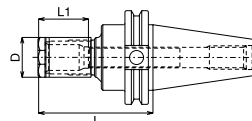

PREMIUM BALANCE
G6.3 at 30,000rpm
CERTIFICATE INCLUDED

Taper	Collet Series	Collet Range	L	L1	D	Nut Tightening Torque (ft. lbs.)	Code No.
CT40	DA100	3/64-9/16	3.50	1.15	1.06	35	531270
CT40	DA100	3/64-9/16	6.00	1.15	1.06	35	531272
CT40	DA180	3/64-3/4	4.00	1.50	1.44	40	531273
CT40	DA180	3/64-3/4	6.00	1.50	1.44	40	531274
CT40	DA200	3/64-3/8	3.00	1.03	0.86	30	531275
CT40	DA300	3/64-1/4	3.00	0.84	0.55	25	531276

Collet Chucks & Collets

CAT50 DA Collet Chucks

- DIN coolant through the flange
- All ground body
- TIR 0.0010"
- AT2 Taper Accuracy
- RFID chip hole

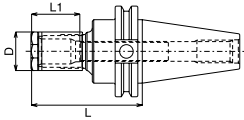

PREMIUM BALANCE
G6.3 at 25,000rpm
CERTIFICATE INCLUDED

Taper	Collet Series	Collet Range	L	L1	D	Nut Tightening Torque (ft. lbs.)	Code No.
CT50	DA180	3/64-3/4	4.00	1.50	1.44	40	531278
CT50	DA180	3/64-3/4	6.00	1.50	1.44	40	531280

BT30 DA Collet Chucks

- All ground body
- TIR 0.0010"
- AT2 Taper Accuracy
- RFID chip hole

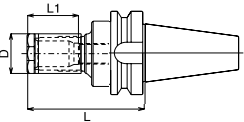

PREMIUM BALANCE
G6.3 at 30,000rpm
CERTIFICATE INCLUDED

Taper	Collet Series	Collet Range	L	L1	D	Nut Tightening Torque (ft. lbs.)	Code No.
BT30	DA100	3/64-9/16	3.00	1.15	1.06	35	532108
BT30	DA180	3/64-3/4	3.00	1.51	1.44	40	532110
BT30	DA200	3/64-3/8	3.00	1.03	0.86	30	532112
BT30	DA300	3/64-1/4	3.00	1.04	0.55	25	532125

BT40 DA Collet Chucks

- DIN coolant through the flange
- All ground body
- TIR 0.0010"
- AT2 Taper Accuracy
- RFID chip hole

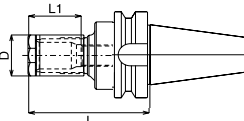

PREMIUM BALANCE
G6.3 at 30,000rpm
CERTIFICATE INCLUDED

Taper	Collet Series	Collet Range	L	L1	D	Nut Tightening Torque (ft. lbs.)	Code No.
BT40	DA100	3/64-9/16	6.00	1.15	1.06	35	532118
BT40	DA180	3/64-3/4	4.00	1.51	1.44	40	532120
BT40	DA180	3/64-3/4	6.00	1.51	1.44	40	532122
BT40	DA200	3/64-3/8	3.00	1.03	0.86	30	532124

DA Collet Chuck Extensions

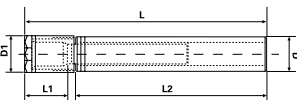
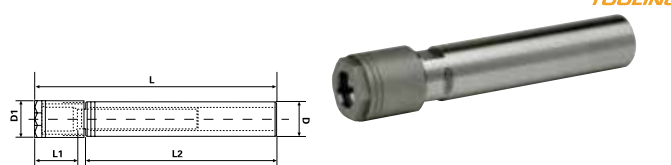

Collet Series	Collet Range	Shank Dia. (D)	O.A.L. L	L1	L2	D1	Code No.
DA100	3/64-9/16	1	5.00	1.66	3.00	1.06	534220
DA100	3/64-9/16	1	7.50	1.66	5.50	1.06	534222
DA180	3/64-3/4	1-1/4	5.00	1.83	3.00	1.44	534224
DA180	3/64-3/4	1-1/4	7.50	1.83	5.50	1.44	534226
DA200	3/64-3/8	3/4	4.50	1.34	3.00	0.86	534228
DA200	3/64-3/8	3/4	7.00	1.34	5.50	0.86	534230
DA300	3/64-1/4	1/2	6.80	1.30	5.50	0.51	534232

Backup Screws For DA Collet Chucks

Description	Code No.
DA180 Replacement Backup Screws	534288



DA100 Collets

- Collapse - 1/32"
- 0.001" TIR collet accuracy
- Made from 4140 alloy steel for improved strength, hardness, wear resistance, and corrosion resistance
- For most drilling, reaming and tapping applications



Fractional Inch	Decimal (in.)	Code No.
3/64	0.047	331323
1/16	0.062	331325
5/64	0.078	331327
3/32	0.094	331329
7/64	0.109	331333
1/8	0.125	331335
9/64	0.141	331337
5/32	0.156	331339
11/64	0.172	331341
3/16	0.188	331343
13/64	0.203	331345
7/32	0.219	331347
15/64	0.234	331349
1/4	0.250	331351
17/64	0.266	331353
9/32	0.281	331355
19/64	0.297	331357
5/16	0.312	331359
21/64	0.328	331503
11/32	0.344	331505
23/64	0.359	331507
3/8	0.375	331322
25/64	0.391	331509
13/32	0.406	331324
27/64	0.422	331511
7/16	0.438	331326
29/64	0.453	331513
15/32	0.469	331328
31/64	0.484	331515
1/2	0.500	331330
33/64	0.516	331517
17/32	0.531	331332
35/64	0.547	331519
9/16	0.562	331521

DA100 Collet Sets

Collet	Pieces	Range	Code No.
DA100	8pc	1/8-9/16 x 16ths	331356
DA100	11pc	1/4-9/16 x 32nds	331358
DA100	15pc	1/8-9/16 x 32nds	331362
DA100	17pc	1/16-9/16 x 32nds	331384
DA100	21pc	1/4-9/16 x 64ths	331385
DA100	29pc	1/8-9/16 x 64ths	331386
DA100	33pc	1/16-9/16 x 64ths	331387



DA180 Collets



- Collapse - 1/32"
- 0.001" TIR collet accuracy
- Made from 4140 alloy steel for improved strength, hardness, wear resistance, and corrosion resistance
- For most drilling, reaming and tapping applications

Fractional Inch	Decimal (in.)	Code No.
3/64	0.046	331523
1/16	0.062	331525
5/64	0.078	331527
3/32	0.094	331529
7/64	0.109	331533
1/8	0.125	331535
9/64	0.141	331537
5/32	0.156	331539
11/64	0.172	331541
3/16	0.188	331543
13/64	0.203	331545
7/32	0.219	331547
15/64	0.234	331549
1/4	0.250	331551
17/64	0.266	331553
9/32	0.281	331555
19/64	0.297	331557
5/16	0.312	331559
21/64	0.328	331561
11/32	0.344	331563
23/64	0.359	331565
3/8	0.375	331567
25/64	0.391	331569
13/32	0.406	331571
27/64	0.422	331573
7/16	0.438	331575
29/64	0.453	331577
15/32	0.469	331579
31/64	0.484	331581
1/2	0.500	331583
33/64	0.516	331585
17/32	0.531	331587
35/64	0.547	331589
9/16	0.562	331334
37/64	0.578	331595
19/32	0.594	331336
39/64	0.609	331597
5/8	0.625	331338
41/64	0.641	331601
21/32	0.656	331340
43/64	0.672	331603
11/16	0.688	331342
45/64	0.703	331605
23/32	0.719	331344
47/64	0.734	331607
3/4	0.750	331346

DA180 Collet Sets



Collet	Pieces	Range	Code No.
DA180	9pc	1/4-3/4 x 16ths	331388
DA180	17pc	1/4-3/4 x 32nds	331389
DA180	21pc	1/8-3/4 x 32nds	331390
DA180	33pc	1/4-3/4 x 64ths	331391
DA180	41pc	1/8-3/4 x 64ths	331392

DA200 Collets



- Collapse - 1/32"
- 0.001" TIR collet accuracy
- Made from 4140 alloy steel for improved strength, hardness, wear resistance, and corrosion resistance
- For most drilling, reaming and tapping applications

Fractional Inch	Decimal (in.)	Code No.
3/64	0.047	331297
1/16	0.062	331299
5/64	0.078	331301
3/32	0.094	331303
7/64	0.109	331305
1/8	0.125	331307
9/64	0.141	331309
5/32	0.156	331311
11/64	0.172	331313
3/16	0.188	331315
13/64	0.203	331302
7/32	0.219	331304
15/64	0.234	331306
1/4	0.250	331308
17/64	0.266	331310
9/32	0.281	331312
19/64	0.297	331314
5/16	0.312	331316
21/64	0.328	331318
11/32	0.344	331320
23/64	0.359	331317
3/8	0.375	331319
25/64	0.391	331321

DA200 Collet Sets



Collet	Pieces	Range	Code No.
DA200	9pc	1/8-3/8 x 32nds	331393
DA200	11pc	1/16-3/8 x 32nds	331394
DA200	17pc	1/8-3/8 x 64ths	331395
DA200	21pc	1/16-3/8 x 64ths	331396

DA300 Collets



- Collapse - 1/32"
- 0.001" TIR collet accuracy
- Made from 4140 alloy steel for improved strength, hardness, wear resistance, and corrosion resistance
- For most drilling, reaming and tapping applications

Fractional Inch	Decimal (in.)	Code No.
3/64	0.047	331277
1/16	0.062	331283
5/64	0.078	331285
3/32	0.094	331287
7/64	0.109	331290
1/8	0.125	331292
9/64	0.141	331294
5/32	0.156	331296
11/64	0.172	331298
3/16	0.188	331300
13/64	0.203	331289
7/32	0.219	331291
15/64	0.234	331293
1/4	0.250	331295

DA300 Collet Sets



Collet	Pieces	Range	Code No.
DA300	7pc	1/16-1/4 x 32nds	331397
DA300	13pc	1/16-1/4 x 64ths	331399
DA300	14pc	3/64-1/4 x 64ths	331400

DA Collet Dimensional Data

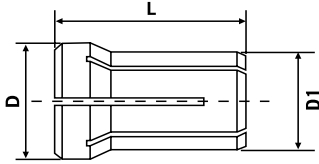

Collet	D	D1	L	Collet Range
100DA	0.769	0.635	1.441	3/64-9/16
180DA	1.035	0.873	1.637	3/64-3/4
200DA	0.539	0.453	1.193	3/64-3/8
300DA	0.375	0.300	1.000	3/64-1/4

Type 25 & Type 32 Collet Chuck Sets



Set includes:

1 chuck, 1 wrench, 1 each collet and fitted case

Type 25

- 1/8", 3/16", 1/4", 5/16", 3/8", 1/2", 5/8", 3/4", 7/8", 1"

Type 32

- 1/4", 5/16", 3/8", 7/16", 1/2", 9/16", 5/8", 11/16", 3/4", 13/16", 7/8", 15/16", 1", 1-1/8", 1-1/4"



Chuck	Code No.
COLLET SETS CONSIST OF 10 COLLETS 1/8" - 1" (TYPE 25)	
ISA-30	334600
ISA-40	334605
ISA-50	334608
M.T.3	334610
M.T.4	334615
R-8	334620
COLLET SETS CONSIST OF 15 COLLETS 1/4" - 1-1/4" (TYPE 32)	
ISA-40	334625
ISA-50	334630
M.T.5	334635

Component Parts For 1" Type 25 Sets



Description	Type 25	Code No.
Wrench	1 (Type 25)	334650
Nuts	1 (Type 25)	334645
Fitted Case	1 (Type 25)	334640
Chuck ISA-30	1 (Type 25)	334655
Chuck ISA-40	1 (Type 25)	334660
Chuck ISA-50	1 (Type 25)	334663
Chuck MT 3	1 (Type 25)	334665
Chuck MT 4	1 (Type 25)	334670
Chuck R-8	1 (Type 25)	334675

Component Parts For 1-1/4" Type 32 Sets



Description	Type 25	Code No.
Wrench	1-1/4 (Type 32)	334690
Nuts	1-1/4 (Type 32)	334685
Fitted Case	1-1/4 (Type 32)	334680
Chuck ISA-40	1-1/4 (Type 32)	334695
Chuck ISA-50	1-1/4 (Type 32)	334700
Chuck MT 5	1-1/4 (Type 32)	334705

Type 25 & Type 32 Collets



- Type 25 have a collapsability of 0.2mm
- Type 32 have a collapsability of 0.3mm

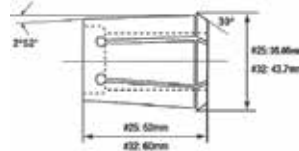

Metric	Size (in.)	Type 25 Code No.	Type 32 Code No.
	3 mm	336504	-
	4 mm	336506	-
	5 mm	336508	336549
	6 mm	336510	336550
	7 mm	336512	336552
	8 mm	336514	336554
	9 mm	336516	336556
	10 mm	336518	336560
	11 mm	336520	336562
	12 mm	336522	336564
	13 mm	336524	336566
	14 mm	336526	336568
	15 mm	336528	336570
	16 mm	336530	336572
	17 mm	336532	336574
	18 mm	336534	336576
	19 mm	336536	336578
	20 mm	336538	336580
	21 mm	336540	336582
	22 mm	336542	336584
	23 mm	336544	336586
	24 mm	336546	336588
	25 mm	336548	336590
	26 mm	-	336592
	28 mm	-	336596
	29 mm	-	336597
	30 mm	-	336598
	32 mm	-	336600
Inch			
	1/8	336400	-
	3/16	336402	-
	1/4	336404	336430
	5/16	336406	336432
	3/8	336408	336434
	7/16	336409	336436
	1/2	336410	336438
	9/16	336411	336440
	5/8	336412	336442
	11/16	-	336444
	3/4	336414	336446
	13/16	-	336448
	7/8	336416	336450
	15/16	-	336452
	1	336418	336454
	1-1/8	-	336456
	1-1/4	-	336458

Collet Rack



- Holds 5C, C32, or Type 25 collets
- 220x110x6mm
- Plastic



* Collets not included

Model	Code No.
VMS-5	325305

5C Collets

Made of tool steel, hardened and ground to maintain original accuracy

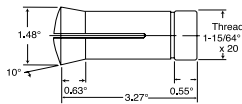

Size (in.)	Code No.
1/8	325317
3/16	325322
1/4	325327
5/16	325332
3/8	325337
7/16	325342
1/2	325347
9/16	325354
5/8	325357
11/16	325362
3/4	325367
13/16	325372
7/8	325377
15/16	325382
1	325387

Emergency Type Collet

- Nylon
- Can be bored to custom internal diameters to hold unusual sized workpieces

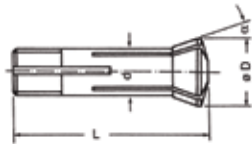

Model	Length (mm)	D (mm)	d (mm)	Head Angle α	Code No.
VE-5CN	87	37.5	31.75	10°	325312

R8 Collets & Set

Manufactured of hardened and ground tool steel, these collets can be recommended for their accuracy and fine finish.

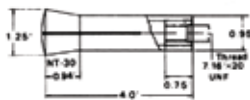

Size (in.)	Code No.
1/8	325167
5/32	325172
3/16	325177
7/32	325182
1/4	325187
9/32	325192
5/16	325197
11/32	325202
3/8	325207
13/32	325212
7/16	325217
15/32	325222
1/2	325227
9/16	325232
19/32	325237
5/8	325242
21/32	325247
11/16	325252
23/32	325257
3/4	325262



GS Tooling
Shrink Fit Holders
Focusing on the cutting edge, coolant ports come standard!

See www.SowaTool.com

Retention Knobs

- Ground Pilot
- O-Ring on Pilot to prevent coolant penetration into the spindle

Can't find your retention knob?

We invite your inquiries.

Please have ready the following information when calling:

- Taper of Machine
- Make and Model No. of the Machine
- Draw Bar Thread Diameter and Pitch
- Taper Angle required underneath head of stud

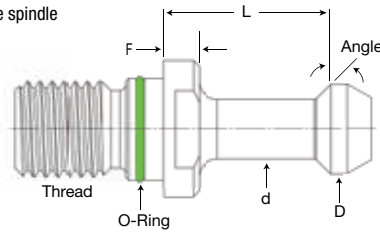

Taper	Model	Coolant Through	D	d	L	F	Angle	Thread	Code No.
BT30	GS585X45	N	0.433	0.276	0.709	0.197	45	M12x1.75	366000
BT30	GS585X60	N	0.433	0.276	0.709	0.197	60	M12x1.75	366002
BT40	PS444X15	N	0.748	0.551	0.905	0.275	15	M16x2	366003
BT40	GSC444X15	Y	0.748	0.551	0.905	0.275	15	M16x2	366004
BT40	GS444X45	N	0.590	0.390	1.102	0.236	45	M16x2	366006
BT40	GS444X60	N	0.590	0.390	1.102	0.236	60	M16x2	366008
BT40	PS444X90	N	0.590	0.390	1.102	0.236	90	M16x2	366010
BT40	GSC444X45	Y	0.590	0.390	1.102	0.236	45	M16x2	366012
BT40	GSC444X60	Y	0.590	0.390	1.102	0.236	60	M16x2	366014
BT40	PSC444X90	Y	0.590	0.390	1.102	0.236	90	M16x2	366016
BT40	PS477	N	0.740	0.490	0.552	0.236	45	M16x2	366018
BT40	PSC478	Y	0.740	0.490	0.440	0.120	45	M16x2	366020
BT40	PSC479	Y	0.740	0.490	0.552	0.120	45	M16x2	366022
BT40	GSC477	Y	0.740	0.490	0.552	0.236	45	M16x2	366024
BT40	PSC480X15	Y	0.748	0.551	0.900	0.157	15	M16x2	366026
BT40	PS534X45	N	0.590	0.390	0.990	0.236	45	M16x2	366028
BT40	PS554	N	0.594	0.406	1.250	0.187	45	M16x2	366030
BT40	PSC554	Y	0.594	0.406	1.250	0.187	45	M16x2	366032
CT40	GSC470X15	Y	0.748	0.551	0.787	0.157	15	5/8x11	366034
CT40	GS474	N	0.740	0.490	0.440	0.118	45	5/8x11	366036
CT40	GSC474	Y	0.740	0.490	0.440	0.118	45	5/8x11	366038
CT40	GSC475	Y	0.740	0.490	0.440	0.120	45	5/8x11	366040
CT40	GS475	N	0.740	0.490	0.440	0.120	45	5/8x11	366042
CT40	PS498	N	0.590	0.390	0.777	0.200	90	5/8x11	366044
CT40	PS531X45	N	0.590	0.390	1.000	0.236	45	5/8x11	366046
CT40	GS532X15	N	0.748	0.551	0.792	0.275	15	5/8x11	366048
CT40	GS532X45	N	0.590	0.390	0.990	0.236	45	5/8x11	366050
CT40	GS532X60	N	0.590	0.390	0.990	0.236	60	5/8x11	366052
CT40	GS532X90	N	0.590	0.390	0.990	0.236	90	5/8x11	366054
CT40	GSC532X15	Y	0.748	0.551	0.792	0.275	15	5/8x11	366056
CT40	GSC532X45	Y	0.590	0.390	0.990	0.236	45	5/8x11	366058
CT40	GSC532X60	Y	0.590	0.390	0.990	0.236	60	5/8x11	366060
CT40	GSC532X90	Y	0.590	0.390	0.990	0.236	90	5/8x11	366062
CT40	PS552	N	0.594	0.406	1.139	0.187	45	5/8x11	366064
CT40	PSC552	Y	0.594	0.406	1.139	0.187	45	5/8x11	366066
CT40	GS572X45	N	0.590	0.390	0.990	0.120	45	5/8x11	366068
CT40	PS572X60	N	0.590	0.390	0.990	0.120	60	5/8x11	366070
CT40	PS572X90	N	0.590	0.390	0.990	0.120	90	5/8x11	366072
CT40	PSC572X45	Y	0.590	0.390	0.990	0.120	45	5/8x11	366074
CT40	PSC572X60	Y	0.590	0.390	0.990	0.120	60	5/8x11	366076
CT40	PSC572X90	Y	0.590	0.390	0.990	0.120	90	5/8x11	366078
CT45	PSC375	Y	0.940	0.605	0.580	0.160	45	3/4x10	366080
BT50	PSC278	Y	1.140	0.820	0.700	0.200	45	M24x3	366082
BT50	GS446X45	N	0.906	0.669	1.378	0.394	45	M24x3	366084
BT50	PS446X60	N	0.906	0.669	1.378	0.394	60	M24x3	366086
BT50	PS446X90	N	0.906	0.669	1.378	0.394	90	M24x3	366088
BT50	GSC446X45	Y	0.906	0.669	1.378	0.394	45	M24x3	366090
CT50	GS275	N	1.140	0.820	0.700	0.200	45	1x8	366092
CT50	PSC274	Y	1.140	0.820	0.700	0.200	45	1x8	366094
CT50	GSC275	Y	1.140	0.820	0.700	0.200	45	1x8	366096
CT50	GS536X45	N	0.906	0.669	1.386	0.394	45	1x8	366098
CT50	GS536X60	N	0.906	0.669	1.386	0.394	60	1x8	366100
CT50	GS536X90	N	0.906	0.669	1.386	0.394	90	1x8	366102
CT50	GSC536X45	Y	0.906	0.669	1.386	0.394	45	1x8	366104
CT50	GSC536X60	Y	0.906	0.669	1.386	0.394	60	1x8	366106
CT50	GSC536X90	Y	0.906	0.669	1.386	0.394	90	1x8	366108



Superior performance tool holding and workholding solutions when speed and accuracy matter most.

GS Tooling is an industry leader in precision tooling where high-performance and stringent quality standards are paramount. Tool your World with GS Tooling End Mill Holders, Collet Chucks & Collets, Retention Knobs, Vises & Workholding, Live Centers, Angle Heads, Carbide End Mills and more!



Tool Holding



Angle Heads & Driven Tooling



Cutting Tools



Vises & Workholding



Welcome to the **Sowa** family!



Superior performance tool holding and workholding solutions when speed and accuracy matter most.

ASIMETO

High-performance precision measuring and inspecting solutions.



High-performance cutting tools including end mills, drills, taps and indexables.

SKODA

High Value production grade live centers.

narex

Exclusive line of value boring heads.



A wide product range of economic tooling for general purpose applications.



With this line-up, Sowa Tool is uniquely qualified to serve all your needs under one roof. Ask us how Sowa can tool your world and provide the competitive edge for your business.

Distributed by:



COMPLETE METALWORKING SOLUTIONS

(800) 991-4225

www.ahbinc.com

ISO Certified

customerservice@ahbinc.com

Sowa
TOOLING YOUR WORLD.

Sowa Tool & Machine Co. Ltd.

Canadian Head Office
500 Manitou Drive, Kitchener, ON, N2C 1L3

North Carolina Office
101-137 Overhill Drive, Mooresville, NC 28117