

SOWA

TOOLING
YOUR
WORLD.

AHB

TOOLING & MACHINERY

COMPLETE METALWORKING SOLUTIONS

(800) 991-4225

www.ahbinc.com

ISO Certified

customerservice@ahbinc.com



Drill Chucks & Adapters



| | |
|-----------------------------------|---|
| Keyless Drill Chucks | 3 |
| Bearing Drill Chucks | 4 |
| Chuck Keys and Wrenches | 4 |
| Taper Adapters | 5 |
| Boring Head Holders | 5 |
| Retention Knobs | 6 |

Sowa Tool has been serving the metalworking industry since 1960.

Your world is full of challenges and worrying about having the right tools for the job should not be one of them. With a three-generation legacy of family-style customer service, Sowa Tool & Machine has been trusted by manufacturers and distributors throughout North America to supply some of the industry's best metalworking solutions since 1960.

Our mission has been and continues to be to provide the broadest range of metalworking solutions in the industry. We accomplish this through the continuous development of our family of brands that include items within the Tool Holding, Workholding, Measuring & Inspecting, and Cutting Tool categories. This allows you to secure all these solutions from one place, reducing your total number of purchase orders and consolidating your freight charges in this increasingly expensive market.

Our wide array of metalworking products come in stock with same-day shipping if ordered before 3:00 pm EST. Our customer service team is just a call or click away, available to offer technical help or source hard-to-find products. Over the decades we've fine-tuned the balance between inventory, pricing and customer service, and can help you select precisely what you need to get the job done right. Our manufactured products are designed to meet the highest quality standards or provide the best price on the market, sometimes both!

26,000+

INDUSTRIAL PRODUCTS

6

INDUSTRY BRANDS

1960

YEAR FOUNDED

5

WAREHOUSES

90+

ASSOCIATES

23,000+

STOCKED SKU'S IN THE USA



**Depend on us to tool your world and deliver
the competitive edge your business needs to stay ahead!**

CAT Taper Integral Keyless Drill Chucks



These chucks provide exceptionally high torque - up to three times the gripping strength of conventional drill chuck / taper holder combinations. The design eliminates any possibility of chuck / holder misalignment, and it assures separation safety.

- High precision, premium tolerance
- The jaws feature a TiN coated surface treatment to assure durability
- AT2 Taper Accuracy
- RFID Chip Hole

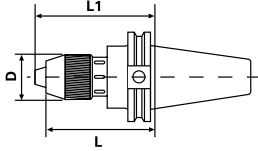

| Taper | Cap. | L | L1 | D | Code No. |
|-------|------|-------|-------|------|----------|
| CT40 | 1/4 | 2.559 | 2.795 | 1.3 | 531480 |
| CT40 | 1/2 | 4.527 | 4.992 | 1.97 | 531482 |
| CT40 | 5/8 | 4.724 | 5.236 | 2.24 | 531483 |
| CT50 | 1/2 | 3.54 | 3.996 | 1.97 | 531484 |
| CT50 | 5/8 | 3.7 | 4.134 | 2.24 | 531485 |

NMTB Taper Integral Keyless Drill Chucks



These chucks provide exceptionally high torque - up to three times the gripping strength of conventional drill chuck / taper holder combinations. The design eliminates any possibility of chuck / holder misalignment, and it assures separation safety.

- High precision, premium tolerance
- The jaws feature a TiN coated surface treatment to assure durability



| Taper | Cap. | Gauge Length (Open) | Gauge Length (Closed) | Chuck Dia. | Code No. |
|--------|------|---------------------|-----------------------|------------|----------|
| NMTB40 | 1/2 | 3.75 | 4.20 | 1.97 | 534406 |
| NMTB50 | 1/2 | 3.35 | 3.74 | 1.97 | 534408 |

BT Taper Integral Keyless Drill Chucks



These chucks provide exceptionally high torque - up to three times the gripping strength of conventional drill chuck / taper holder combinations. The design eliminates any possibility of chuck / holder misalignment, and it assures separation safety.

- High precision, premium tolerance
- The jaws feature a TiN coated surface treatment to assure durability
- AT2 Taper Accuracy
- RFID Chip Hole

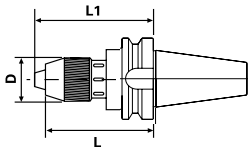

| Taper | Cap. | L | L1 | D | Code No. |
|-------|------|------|------|------|----------|
| BT30 | 1/4 | 3.15 | 3.38 | 1.3 | 532210 |
| BT30 | 1/2 | 3.55 | 4.02 | 1.97 | 532212 |
| BT40 | 1/4 | 2.95 | 3.19 | 1.3 | 532214 |
| BT40 | 1/2 | 3.74 | 4.18 | 1.97 | 532216 |
| BT50 | 5/8 | 5.12 | 5.59 | 2.24 | 532219 |

Morse Taper Integral Keyless Drill Chucks



These chucks provide exceptionally high torque - up to three times the gripping strength of conventional drill chuck / taper holder combinations. The design eliminates any possibility of chuck / holder misalignment, and it assures separation safety.

- High precision, premium tolerance
- The jaws feature a TiN coated surface treatment to assure durability



| Shank | Gripping Dia. (mm) | Chuck Dia. | Gauge Length | Code No. |
|--------|--------------------|------------|--------------|----------|
| M.T. 4 | 0-13 | 51 | 100 | 337426 |
| M.T. 4 | 3-16 | 57 | 120 | 337428 |

R8 Integral Keyless Drill Chucks



These chucks provide exceptionally high torque - up to three times the gripping strength of conventional drill chuck / taper holder combinations. The design eliminates any possibility of chuck / holder misalignment, and it assures separation safety.

- High precision, premium tolerance
- The jaws feature a TiN coated surface treatment to assure durability



| Shank | Gripping Dia. (mm) | Chuck Dia. | Gauge Length | Draw Bar | Code No. |
|-------|--------------------|------------|--------------|----------|----------|
| R-8 | 0-13 | 51 | 100 | 7/16-20 | 337430 |
| R-8 | 3-16 | 57 | 120 | 7/16-20 | 337432 |

Straight Shank Integral Keyless Drill Chucks



These chucks provide exceptionally high torque - up to three times the gripping strength of conventional drill chuck / taper holder combinations. The design eliminates any possibility of chuck / holder misalignment, and it assures separation safety.

- High precision, premium tolerance
- The jaws feature a TiN coated surface treatment to assure durability

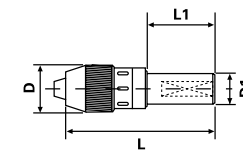

| Capacity | D1 | L | L1 | D | Code No. |
|----------|-------|------|------|------|----------|
| 1/4 | 3/4 | 5.87 | 2.56 | 1.34 | 534410 |
| 1/2 | 1-1/4 | 6.06 | 2.56 | 1.97 | 534414 |

Replacement Drill Chucks



These chucks provide exceptionally high torque - up to three times the gripping strength of conventional drill chuck / taper holder combinations. The design eliminates any possibility of chuck / holder misalignment, and it assures separation safety.



| Description | Code No. |
|-------------------------------|----------|
| 1/4" chuck | 534422 |
| 1/2" chuck for BT40 / CAT50 | 534424 |
| 1/2" chuck for CAT40 / NMTB40 | 534425 |
| 5/8" chuck for CAT40/50, BT40 | 534427 |

Drill Chucks & Adapters

Super Heavy Duty Ball Bearing Drill Chucks

GS Ball Bearing Chucks are specially designed for HEAVY DUTY drilling applications on production drilling machines, jig borers, milling machines, lathes and radials. The ideal choice for those jobs that require close tolerance drilling. The ball thrust bearing reduces friction in the chuck's closing mechanism, so the operator can apply more gripping power on the twist drill shank.

- High precision, premium tolerance



| Chuck Model | Capacity (in.) | Mount | Code No. |
|-------------|----------------|-------|----------|
| 13BXH | 3/64-1/2 | JT6 | 536500 |
| 16BXH | 3/64-5/8 | JT3 | 536502 |
| 19BXH | 3/64-3/4 | JT4 | 536504 |

Drill Chuck Keys

- Nickel thumb grip
- The potential for fracturing under excessive load is limited due to soft steel handles



| Chuck Model | Key No. | Code No. |
|---------------|---------|----------|
| 13GH 1/2 JT33 | P6 | 536548 |
| 13GH 1/2 JT6 | P6 | 536548 |
| 16GH 5/8 | P7 | 536550 |
| 19GH 3/4 | P7 | 536550 |
| 13BXH | P6 | 536548 |
| 16BXH | P7 | 536550 |
| 19BXH | P7 | 536550 |

Plain Bearing Drill Chucks

GS Plain Bearing Chucks are specially designed for stationary drilling, turning, milling, and woodworking machines.

- Sleeve design eliminates the possibility of tooth breakage
- Hardened jaws and body help to avoid wear and lengthen the life of the chuck
- Each chuck supplied with a key



| Chuck Model | Capacity (in.) | Mount | Code No. |
|-------------|----------------|-------|----------|
| 13GH | 3/64-1/2 | JT6 | 536516 |
| 16GH | 3/64-5/8 | JT3 | 536520 |

Replacement Chuck Wrenches



| Description | Code No. |
|------------------|----------|
| Fits 1/4" chucks | 534418 |
| Fits 1/2" chucks | 534420 |
| Fits 5/8" chucks | 534431 |

CAT Taper Jacobs Taper Adapter

- Shank traverse ground to obtain optimum accuracy
- Meets or exceeds ANSI specifications
- 0.0002" or better ensures the best possible cutting tool life

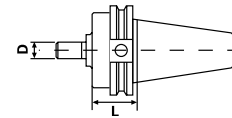

| Taper | JT Size | L | D | Code No. |
|-------|---------|------|-------|----------|
| CT40 | JT#2 | 1.61 | 0.560 | 531490 |
| CT40 | JT#3 | 1.58 | 0.812 | 531492 |
| CT40 | JT#4 | 1.49 | 1.13 | 531494 |
| CT40 | JT#6 | 1.61 | 0.677 | 531496 |
| CT40 | JT#33 | 1.61 | 0.625 | 531498 |
| CT50 | JT#2 | 1.61 | 0.560 | 531500 |
| CT50 | JT#3 | 1.58 | 0.812 | 531502 |
| CT50 | JT#4 | 1.49 | 1.13 | 531504 |
| CT50 | JT#6 | 1.61 | 0.677 | 531506 |
| CT50 | JT#33 | 1.61 | 0.625 | 531508 |

Super Precision Keyless Drill Chucks

Keyless chucks are engineered to quickly loosen and tighten a tool on the chuck collar of the drill, either by manual operation or when torque is applied. Rotating the chuck collar in a counterclockwise direction will loosen the tool.

- High precision, premium tolerance
- The jaws feature a TiN coated surface treatment to assure durability



| Chuck Model | Capacity (in.) | Mount | Code No. |
|-------------|----------------|---------|----------|
| 6XH | 1/64-1/4 | JT1 | 536524 |
| 6XH | 1/64-1/4 | 3/8 -24 | 536526 |
| 10XH | 1/64-3/8 | JT2 | 536528 |
| 10XH | 1/64-3/8 | JT33 | 536530 |
| 13XH | 1/64-1/2 | JT6 | 536534 |
| 13XH | 1/64-1/2 | JT33 | 536536 |
| 13XH | 1/64-1/2 | 1/2 -20 | 536538 |
| 16XH | 1/8-5/8 | JT6 | 536540 |
| 16XH | 1/8-5/8 | JT33 | 536542 |

BT Taper Jacobs Taper Adapter

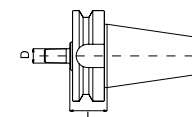

| Taper | JT Size | L | D | Code No. |
|-------|---------|------|-------|----------|
| BT30 | JT#6 | 1.02 | 0.677 | 532224 |
| BT40 | JT#2 | 1.61 | 0.560 | 532230 |
| BT40 | JT#3 | 1.57 | 0.812 | 532232 |
| BT40 | JT#6 | 1.61 | 0.677 | 532234 |
| BT40 | JT#33 | 1.61 | 0.625 | 532236 |
| BT50 | JT#6 | 1.77 | 0.677 | 532237 |

NMTB Taper Jacobs Taper Adapter

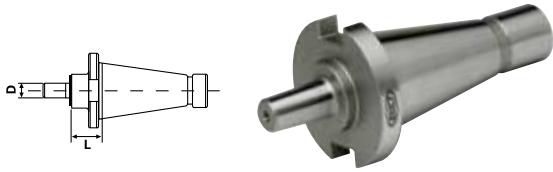

| Taper | JT Size | L | D | Code No. |
|--------|---------|------|-------|----------|
| NMTB40 | JT#2 | 0.65 | 0.560 | 534442 |
| NMTB40 | JT#3 | 0.61 | 0.812 | 534444 |
| NMTB40 | JT#6 | 0.65 | 0.677 | 534446 |
| NMTB40 | JT#33 | 0.65 | 0.625 | 534448 |
| NMTB50 | JT#3 | 1.30 | 0.812 | 534452 |
| NMTB50 | JT#4 | 1.22 | 0.113 | 534454 |

R8 Jacobs Taper Adapter

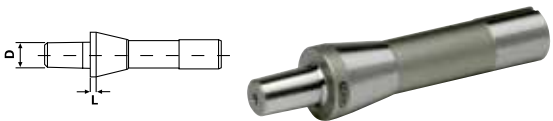

| Taper | JT Size | L | D | Code No. |
|-------|---------|------|-------|----------|
| R8 | JT#2 | 0.13 | 0.560 | 534462 |
| R8 | JT#3 | 0.13 | 0.812 | 534464 |
| R8 | JT#6 | 0.13 | 0.677 | 534466 |
| R8 | JT#33 | 0.13 | 0.625 | 534468 |

CAT Morse Taper Adapters



- Shank traverse ground to obtain optimum accuracy
- Meets or exceeds ANSI specifications
- 0.0002" or better ensures the best possible cutting tool life



| Taper | Size | L | D | D1 | Code No. |
|-------|------|------|-------|------|----------|
| CT40 | MT#1 | 1.75 | 0.475 | 1.00 | 531510 |
| CT40 | MT#2 | 2.36 | 0.700 | 1.25 | 531512 |
| CT40 | MT#3 | 3.00 | 0.938 | 1.57 | 531514 |
| CT40 | MT#4 | 3.54 | 1.23 | 1.97 | 531516 |
| CT50 | MT#2 | 1.75 | 0.700 | 1.25 | 531518 |
| CT50 | MT#3 | 1.75 | 0.938 | 1.57 | 531520 |
| CT50 | MT#4 | 3.00 | 1.23 | 1.97 | 531522 |
| CT50 | MT#5 | 4.13 | 1.75 | 2.75 | 531524 |

BT Morse Taper Adapters



- Shank traverse ground to obtain optimum accuracy
- Meets or exceeds ANSI specifications
- 0.0002" or better ensures the best possible cutting tool life



| Taper | Size | L | D | D1 | Code No. |
|-------|------|------|-------|------|----------|
| BT30 | MT#1 | 1.75 | 0.475 | 1.00 | 532238 |
| BT40 | MT#1 | 1.75 | 0.475 | 1.00 | 532242 |
| BT40 | MT#2 | 2.36 | 0.700 | 1.25 | 532244 |
| BT40 | MT#3 | 3.00 | 0.938 | 1.57 | 532246 |
| BT40 | MT#4 | 3.54 | 1.23 | 1.97 | 532248 |
| BT50 | MT#2 | 1.75 | 0.700 | 1.25 | 532241 |
| BT50 | MT#3 | 1.75 | 0.928 | 1.57 | 532243 |
| BT50 | MT#4 | 3.00 | 1.231 | 1.89 | 532245 |
| BT50 | MT#5 | 4.00 | 1.748 | 2.48 | 532247 |

NMTB Morse Taper Adapters

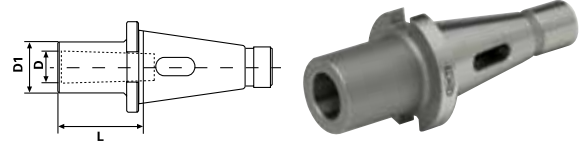

| Taper | Size | L | D | D1 | Code No. |
|--------|------|------|------|------|----------|
| NMTB40 | MT#2 | 1.75 | 0.70 | 1.25 | 534472 |
| NMTB40 | MT#3 | 2.25 | 0.94 | 1.57 | 534474 |
| NMTB40 | MT#4 | 3.00 | 1.23 | 1.97 | 534476 |
| NMTB50 | MT#2 | 1.88 | 0.70 | 1.25 | 534478 |
| NMTB50 | MT#3 | 2.38 | 0.94 | 1.57 | 534480 |
| NMTB50 | MT#4 | 3.25 | 1.23 | 1.97 | 534482 |
| NMTB50 | MT#5 | 4.63 | 1.75 | 2.75 | 534484 |

R8 Morse Taper Adapters

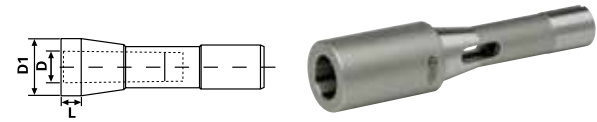

| Taper | Size | L | D | D1 | Code No. |
|-------|------|------|------|------|----------|
| R8 | MT#1 | 0.44 | 0.48 | 1.00 | 534486 |
| R8 | MT#2 | 0.44 | 0.70 | 1.25 | 534488 |
| R8 | MT#3 | 2.56 | 0.94 | 1.57 | 534490 |

CT Taper Boring Head Holders

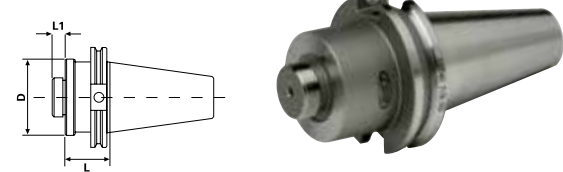

| Taper | Thread | L | L1 | D | Code No. |
|-------|------------|------|------|------|----------|
| CT40 | 7/8 - 20 | 1.75 | 0.44 | 1.75 | 531526 |
| CT40 | 1-1/2 - 18 | 1.75 | 0.50 | 2.96 | 531528 |
| CT50 | 1-1/2 - 18 | 1.75 | 0.50 | 2.96 | 531532 |

BT Taper Boring Head Holders

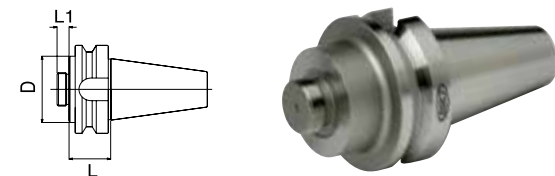

| Taper | Thread | L | L1 | D | Code No. |
|-------|----------|------|------|------|----------|
| BT30 | 1-1/2-18 | 1.75 | 0.50 | 2.96 | 532252 |

NMTB Taper Boring Head Holders



| Taper | Thread | L | L1 | D | Code No. |
|--------|----------|------|------|------|----------|
| NMTB40 | 7/8-20 | 1.75 | 0.44 | 1.75 | 534492 |
| NMTB50 | 7/8-20 | 1.75 | 0.44 | 1.75 | 534496 |
| NMTB50 | 1-1/2-18 | 1.75 | 0.50 | 2.94 | 534498 |

Retention Knobs

- Ground Pilot
- O-Ring on Pilot to prevent coolant penetration into the spindle

Can't find your retention knob?

We invite your inquiries.

Please have ready the following information when calling:

- Taper of Machine
- Make and Model No. of the Machine
- Draw Bar Thread Diameter and Pitch
- Taper Angle required underneath head of stud

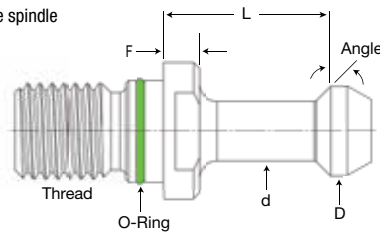

| Taper | Model | Coolant Through | D | d | L | F | Angle | Thread | Code No. |
|-------|-----------|-----------------|-------|-------|-------|-------|-------|----------|----------|
| BT30 | GS585X45 | N | 0.433 | 0.276 | 0.709 | 0.197 | 45 | M12x1.75 | 366000 |
| BT30 | GS585X60 | N | 0.433 | 0.276 | 0.709 | 0.197 | 60 | M12x1.75 | 366002 |
| BT40 | PS444X15 | N | 0.748 | 0.551 | 0.905 | 0.275 | 15 | M16x2 | 366003 |
| BT40 | GSC444X15 | Y | 0.748 | 0.551 | 0.905 | 0.275 | 15 | M16x2 | 366004 |
| BT40 | GS444X45 | N | 0.590 | 0.390 | 1.102 | 0.236 | 45 | M16x2 | 366006 |
| BT40 | GS444X60 | N | 0.590 | 0.390 | 1.102 | 0.236 | 60 | M16x2 | 366008 |
| BT40 | PS444X90 | N | 0.590 | 0.390 | 1.102 | 0.236 | 90 | M16x2 | 366010 |
| BT40 | GSC444X45 | Y | 0.590 | 0.390 | 1.102 | 0.236 | 45 | M16x2 | 366012 |
| BT40 | GSC444X60 | Y | 0.590 | 0.390 | 1.102 | 0.236 | 60 | M16x2 | 366014 |
| BT40 | PSC444X90 | Y | 0.590 | 0.390 | 1.102 | 0.236 | 90 | M16x2 | 366016 |
| BT40 | PS477 | N | 0.740 | 0.490 | 0.552 | 0.236 | 45 | M16x2 | 366018 |
| BT40 | PSC478 | Y | 0.740 | 0.490 | 0.440 | 0.120 | 45 | M16x2 | 366020 |
| BT40 | PSC479 | Y | 0.740 | 0.490 | 0.552 | 0.120 | 45 | M16x2 | 366022 |
| BT40 | GSC477 | Y | 0.740 | 0.490 | 0.552 | 0.236 | 45 | M16x2 | 366024 |
| BT40 | PSC480X15 | Y | 0.748 | 0.551 | 0.900 | 0.157 | 15 | M16x2 | 366026 |
| BT40 | PS534X45 | N | 0.590 | 0.390 | 0.990 | 0.236 | 45 | M16x2 | 366028 |
| BT40 | PS554 | N | 0.594 | 0.406 | 1.250 | 0.187 | 45 | M16x2 | 366030 |
| BT40 | PSC554 | Y | 0.594 | 0.406 | 1.250 | 0.187 | 45 | M16x2 | 366032 |
| CT40 | GSC470X15 | Y | 0.748 | 0.551 | 0.787 | 0.157 | 15 | 5/8x11 | 366034 |
| CT40 | GS474 | N | 0.740 | 0.490 | 0.440 | 0.118 | 45 | 5/8x11 | 366036 |
| CT40 | GSC474 | Y | 0.740 | 0.490 | 0.440 | 0.118 | 45 | 5/8x11 | 366038 |
| CT40 | GSC475 | Y | 0.740 | 0.490 | 0.440 | 0.120 | 45 | 5/8x11 | 366040 |
| CT40 | GS475 | N | 0.740 | 0.490 | 0.440 | 0.120 | 45 | 5/8x11 | 366042 |
| CT40 | PS498 | N | 0.590 | 0.390 | 0.777 | 0.200 | 90 | 5/8x11 | 366044 |
| CT40 | PS531X45 | N | 0.590 | 0.390 | 1.000 | 0.236 | 45 | 5/8x11 | 366046 |
| CT40 | GS532X15 | N | 0.748 | 0.551 | 0.792 | 0.275 | 15 | 5/8x11 | 366048 |
| CT40 | GS532X45 | N | 0.590 | 0.390 | 0.990 | 0.236 | 45 | 5/8x11 | 366050 |
| CT40 | GS532X60 | N | 0.590 | 0.390 | 0.990 | 0.236 | 60 | 5/8x11 | 366052 |
| CT40 | GS532X90 | N | 0.590 | 0.390 | 0.990 | 0.236 | 90 | 5/8x11 | 366054 |
| CT40 | GSC532X15 | Y | 0.748 | 0.551 | 0.792 | 0.275 | 15 | 5/8x11 | 366056 |
| CT40 | GSC532X45 | Y | 0.590 | 0.390 | 0.990 | 0.236 | 45 | 5/8x11 | 366058 |
| CT40 | GSC532X60 | Y | 0.590 | 0.390 | 0.990 | 0.236 | 60 | 5/8x11 | 366060 |
| CT40 | GSC532X90 | Y | 0.590 | 0.390 | 0.990 | 0.236 | 90 | 5/8x11 | 366062 |
| CT40 | PS552 | N | 0.594 | 0.406 | 1.139 | 0.187 | 45 | 5/8x11 | 366064 |
| CT40 | PSC552 | Y | 0.594 | 0.406 | 1.139 | 0.187 | 45 | 5/8x11 | 366066 |
| CT40 | GS572X45 | N | 0.590 | 0.390 | 0.990 | 0.120 | 45 | 5/8x11 | 366068 |
| CT40 | PS572X60 | N | 0.590 | 0.390 | 0.990 | 0.120 | 60 | 5/8x11 | 366070 |
| CT40 | PS572X90 | N | 0.590 | 0.390 | 0.990 | 0.120 | 90 | 5/8x11 | 366072 |
| CT40 | PSC572X45 | Y | 0.590 | 0.390 | 0.990 | 0.120 | 45 | 5/8x11 | 366074 |
| CT40 | PSC572X60 | Y | 0.590 | 0.390 | 0.990 | 0.120 | 60 | 5/8x11 | 366076 |
| CT40 | PSC572X90 | Y | 0.590 | 0.390 | 0.990 | 0.120 | 90 | 5/8x11 | 366078 |
| CT45 | PSC375 | Y | 0.940 | 0.605 | 0.580 | 0.160 | 45 | 3/4x10 | 366080 |
| BT50 | PSC278 | Y | 1.140 | 0.820 | 0.700 | 0.200 | 45 | M24x3 | 366082 |
| BT50 | GS446X45 | N | 0.906 | 0.669 | 1.378 | 0.394 | 45 | M24x3 | 366084 |
| BT50 | PS446X60 | N | 0.906 | 0.669 | 1.378 | 0.394 | 60 | M24x3 | 366086 |
| BT50 | PS446X90 | N | 0.906 | 0.669 | 1.378 | 0.394 | 90 | M24x3 | 366088 |
| BT50 | GSC446X45 | Y | 0.906 | 0.669 | 1.378 | 0.394 | 45 | M24x3 | 366090 |
| CT50 | GS275 | N | 1.140 | 0.820 | 0.700 | 0.200 | 45 | 1x8 | 366092 |
| CT50 | PSC274 | Y | 1.140 | 0.820 | 0.700 | 0.200 | 45 | 1x8 | 366094 |
| CT50 | GSC275 | Y | 1.140 | 0.820 | 0.700 | 0.200 | 45 | 1x8 | 366096 |
| CT50 | GS536X45 | N | 0.906 | 0.669 | 1.386 | 0.394 | 45 | 1x8 | 366098 |
| CT50 | GS536X60 | N | 0.906 | 0.669 | 1.386 | 0.394 | 60 | 1x8 | 366100 |
| CT50 | GS536X90 | N | 0.906 | 0.669 | 1.386 | 0.394 | 90 | 1x8 | 366102 |
| CT50 | GSC536X45 | Y | 0.906 | 0.669 | 1.386 | 0.394 | 45 | 1x8 | 366104 |
| CT50 | GSC536X60 | Y | 0.906 | 0.669 | 1.386 | 0.394 | 60 | 1x8 | 366106 |
| CT50 | GSC536X90 | Y | 0.906 | 0.669 | 1.386 | 0.394 | 90 | 1x8 | 366108 |



Superior performance tool holding and workholding solutions when speed and accuracy matter most.

GS Tooling is an industry leader in precision tooling where high-performance and stringent quality standards are paramount. Tool your World with GS Tooling End Mill Holders, Collet Chucks & Collets, Retention Knobs, Vises & Workholding, Live Centers, Angle Heads, Carbide End Mills and more!



Tool Holding



Angle Heads & Driven Tooling



Cutting Tools



Vises & Workholding

Welcome to the **Sowa** family!



Superior performance tool holding and workholding solutions when speed and accuracy matter most.

ASIMETO

High-performance precision measuring and inspecting solutions.



High-performance cutting tools including end mills, drills, taps and indexables.

SKODA

High Value production grade live centers.

narex

Exclusive line of value boring heads.



A wide product range of economic tooling for general purpose applications.



With this line-up, Sowa Tool is uniquely qualified to serve all your needs under one roof. Ask us how Sowa can tool your world and provide the competitive edge for your business.

Distributed by:



COMPLETE METALWORKING SOLUTIONS

(800) 991-4225

www.ahbinc.com

ISO Certified

customerservice@ahbinc.com

Sowa
TOOLING YOUR WORLD.

Sowa Tool & Machine Co. Ltd.

Canadian Head Office
500 Manitou Drive, Kitchener, ON, N2C 1L3

North Carolina Office
101-137 Overhill Drive, Mooresville, NC 28117