

CONTROLLO
ALLINEAMENTO
ALIGNMENT
CONTROL

ER 32-F
($\phi 3-20$)

USCITA
ROTAZIONE ORARIA
WAY-OUT
CLOCKWISE ROTATION

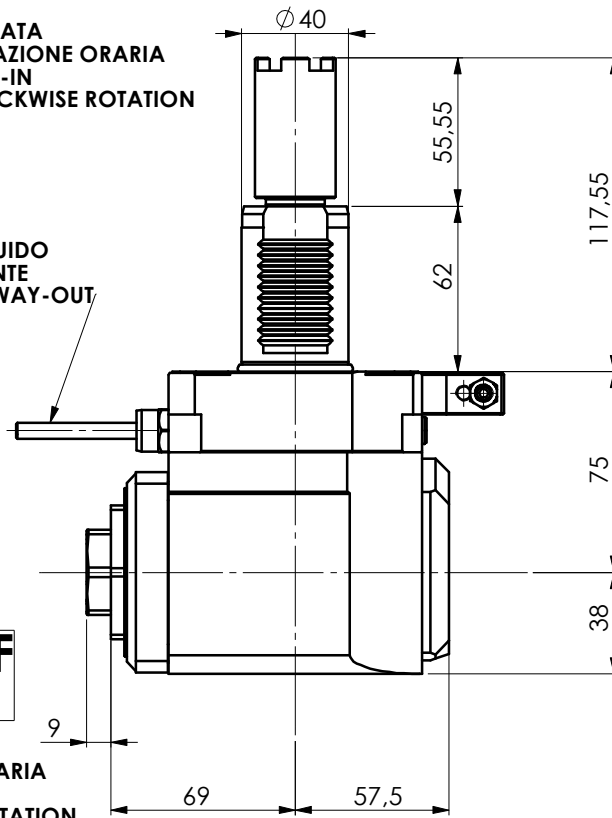

HAAS
STANDARD VDI TURRET SL 40
ST 20 SSS / DS 30 Y
VB (HYBRID TURRET) SL 20
SL 30 / SL 40 / TL 15 / TL 25

ATTACCO VDI-40
DIN 69880-1
VDI-40 MTG.

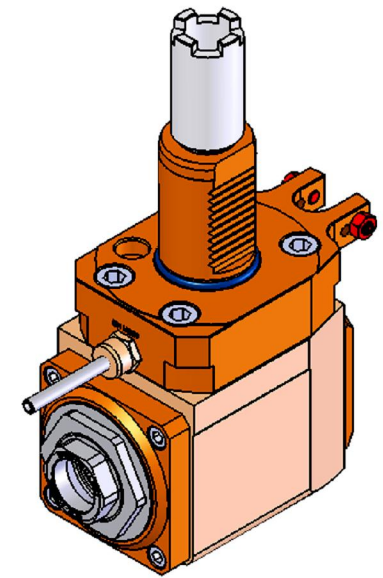
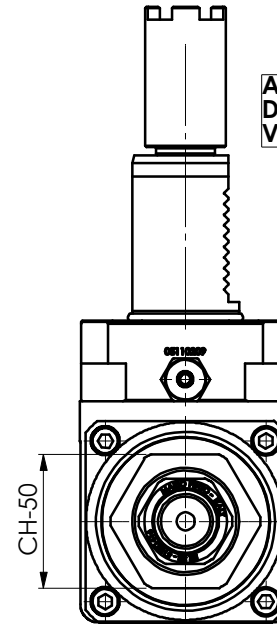

TECHNICAL FEATURES:
Max speed 6000 min⁻¹ for 3 min
Max torque 63 N.m for 4 min
Ratio 1:1
Model ANGULAR H75
Mounting VDI-40
Collet ER32-F (internal nut)

CARATTERISTICHE TECNICHE:
Velocità max 6000 min⁻¹ per 3 min
Coppia max 63 N.m per 4 min
Rapporto 1:1
Modello ANGOLARE H75
Attacco VDI-40
Pinza ER32-F (ghiera interna)

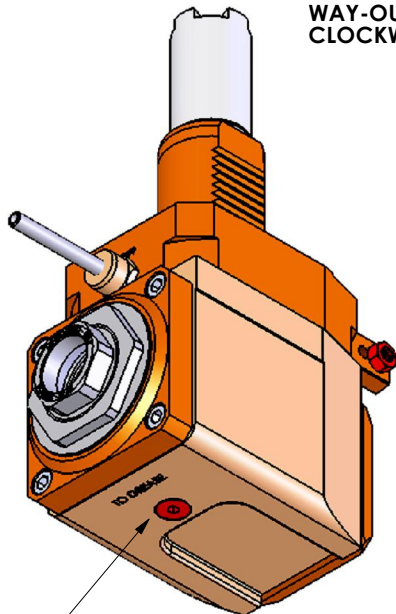

TAPPO PER INTRODUZIONE
GRASSO
PLUG FOR INTRODUCING
GREASE

ENTRATA LIQUIDO
REFRIGERANTE
COOLANT ENTRY

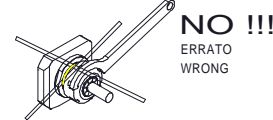
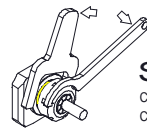
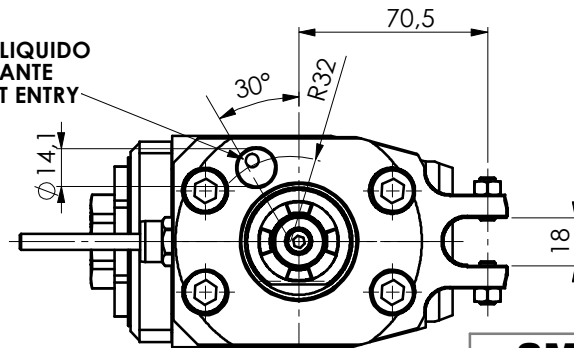

MARIO PINTO
TORINO
SMW
AUTOBLOK
GROUP
LT-A VDI40
ER32F
H75/117 HA
05112300 R..
N..

Designazione/Description : **LT-A VDI40 ER32F H75/117 HA**

SMW AUTOBLOK GROUP

PROPRIETA' RISERVATA - Il presente disegno e' di proprieta' della MARIO PINTO SpA e non potra' essere comunicato a terzi o riprodotto in tutto o in parte senza il consenso scritto della stessa.

NOTICE - This drawing is property of MARIO PINTO SpA ITALY and shall not be reproduced, duplicated or copied in whole or in part, nor shall it be released to others without the written permission of the owner.

Diese Zeichnung darf ohne schriftliche Genehmigung von MARIO PINTO SpA ITALIEN weder kopiert noch dritten Personen mitgeteilt werden

		PORTAUTENSILI PER TORRETTE ANGOLARE H75 VDI-40 ER32F GHIERA INTERNA INNESTO HAAS MACCHINA HAAS		<h1>HAAS</h1>			
SCALE/SCALA	DATE/DATE	DRAWN BY/DISEGN.	CHECKED/VISTO	N.	REVISED/MODIFICA	DATA	FIRMA
	23-02-2012	TORAZZA P.					
		WEIGHT/PESO		ASSEMBLY/COMPLESS.			
		Raw Greggio		Machined Emilp		DRAWING/DISEGNO	
		6.610 Kg		05112300		05112300-R011	
				THE COMPANY GUARDS ITS DRAWINGS ACCORDING TO THE LAW			