



**COMPLETE
METALWORKING
SOLUTIONS**

(800) 991-4225

www.ahbinc.com

ISO Certified

customerservice@ahbinc.com

ENGINEERING REFERENCE			
PART NUMBER	DESCRIPTION	COMPATIBLE MACHINE	SHEET NUMBER
060068-1	CUTTING HEAD KIT; CWJ	M500, M300	2
060068-12	CUTTING HEAD KIT; M200 CWJ	M200	2
060068-2	CUTTING HEAD KIT; DWJ	M500, M300	3
060068-22	CUTTING HEAD KIT; M200 DWJ	M200	3
060068-3	CUTTING HEAD KIT; XD	M500	4
060068-4	CUTTING HEAD KIT; XD W/COMPASS	M500	5
060068-5	CUTTING HEAD KIT; XD /LASER HEIGHT SETTER	M500	6
060068-6	CUTTING HEAD KIT;CWJ MANUAL TILT	M500	7
060068-62	CUTTING HEAD KIT;M200 CWJ MANUAL TILT	M200	7
060068-7	CUTTING HEAD KIT; M200 PIVOT PLUS	M200	8

THIRD ANGLE PROJECTION 				THIS DRAWING IS THE PROPERTY OF FLOW INTERNATIONAL CORPORATION AND IS NOT TO BE COPIED OR REPRODUCED WITHOUT THE WRITTEN CONSENT OF FLOW INTERNATIONAL CORPORATION.	
MATERIAL SEE BOM					
DRAWN BY R. MANN	STARTED 2016-06-24	ENG M.CERAMI	EST WEIGHT x	MODELED IN SOLIDWORKS	
TITLE CUTTING HEAD KIT					
REVISION D	SCALE 1:5	BASE PART NUMBER	060068		1 OF 8

NOTES:

201 ITEM NOT SHOWN.

202 BAG FASTENERS AND INCLUDE WITH ASSEMBLY.

203 PLUG UNUSED I/O PORTS ON A-31275-1 (LOCATED ON 058680 - VERTICAL AXIS ASSY) WITH ITEM 34 (A-25452-1). REFER TO M500 ELECTRICAL SCHEMATIC (058773) FOR DETAILS.

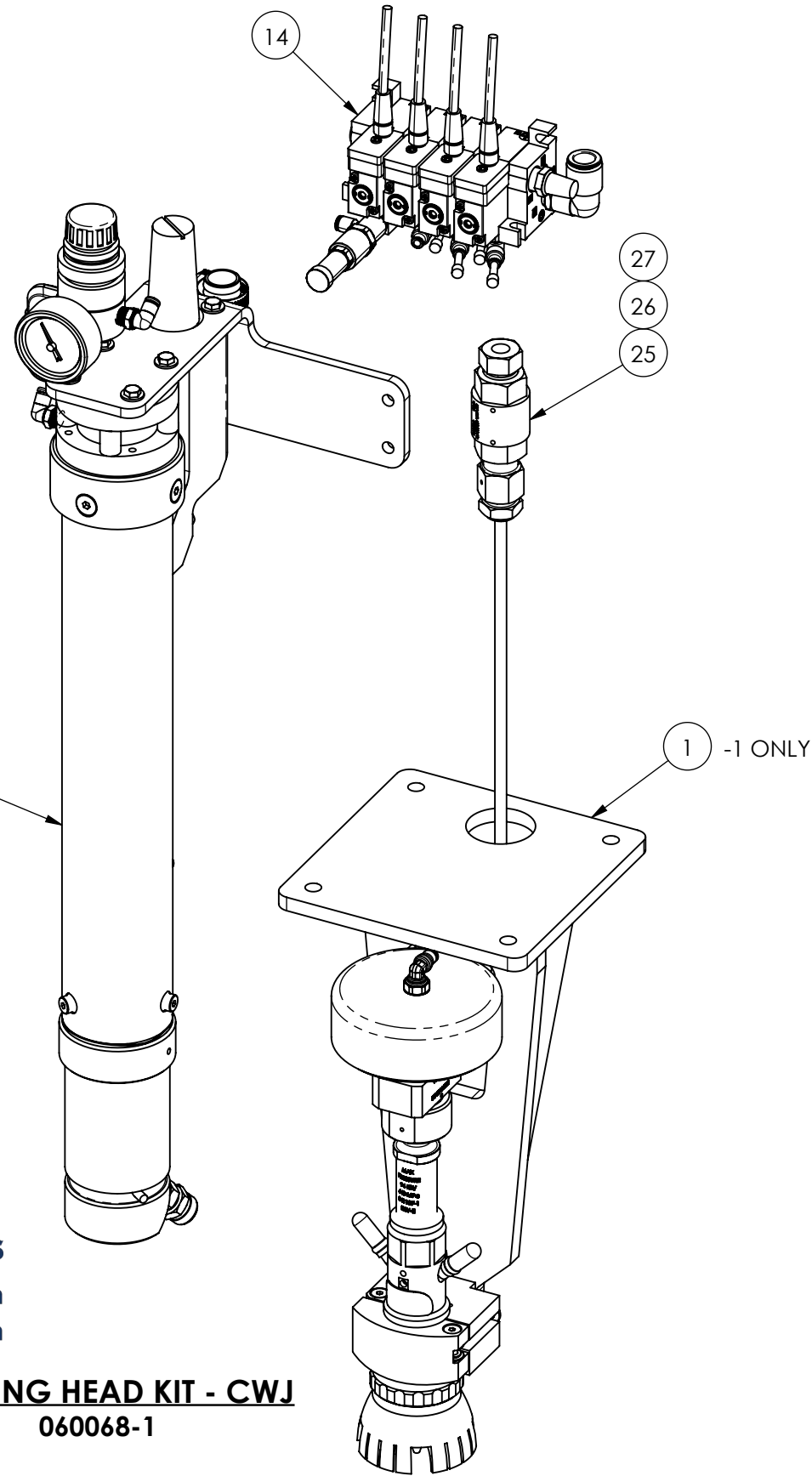

ITEM	-12	-1	U/M	PART NO.	DESCRIPTION
1	-	1	EA	059890-1	CUTTING HEAD ASSY;87 KSI;FXD HD
9	1	-	EA	059890-3	CUTTING HEAD ASSY;60 KSI;FXD HD
13	4000	4000	MM	A-20193-5	TUBE;PUR;HIGH DUROMETER;BLU;2.4 MM ID
14	1	1	EA	055434-10	VALVE ASSY;SOL;MANIFOLD;120 PSI
15	1	1	EA	060096-1	METERING VALVE ASSY;SINGLE
16	8	3	FT	A-24517-6	TUBE;PUR;SOFT A68;BLU;3/16 IN ID
21	4	4	EA	A-00642-5	WASHER;FLAT;SST;M8
22	2	2	EA	A-13504-6-14	SCREW;BUTTON HD SCK;SST;M6X1.0;14 MM
23	2	2	EA	A-00642-4	WASHER;FLAT;SST;M6
25	1	1	EA	012005-1	COUPLING;100 KSI;3/8 IN
26	1	1	EA	A-2838	GLAND;87 KSI;3/8 IN
27	1	1	EA	A-2839	COLLAR;87 KSI;3/8 IN
30	4	4	EA	A-13505-8-30	SCREW;SHCS;SST;M8X1.25;30 MM
34	6	6	EA	A-25452-1	CAP;PLASTIC;BLK;THREADED;M8
35	2	2	EA	A-13505-5-14	SCREW;SHCS;SST;M5X0.8;14 MM
36	2	2	EA	A-00642-9	WASHER;FLAT;SST;M5
37	1	-	EA	A-13928-2	REDUCER;TUBE END;NYLON;NA;4 MM;6 MM

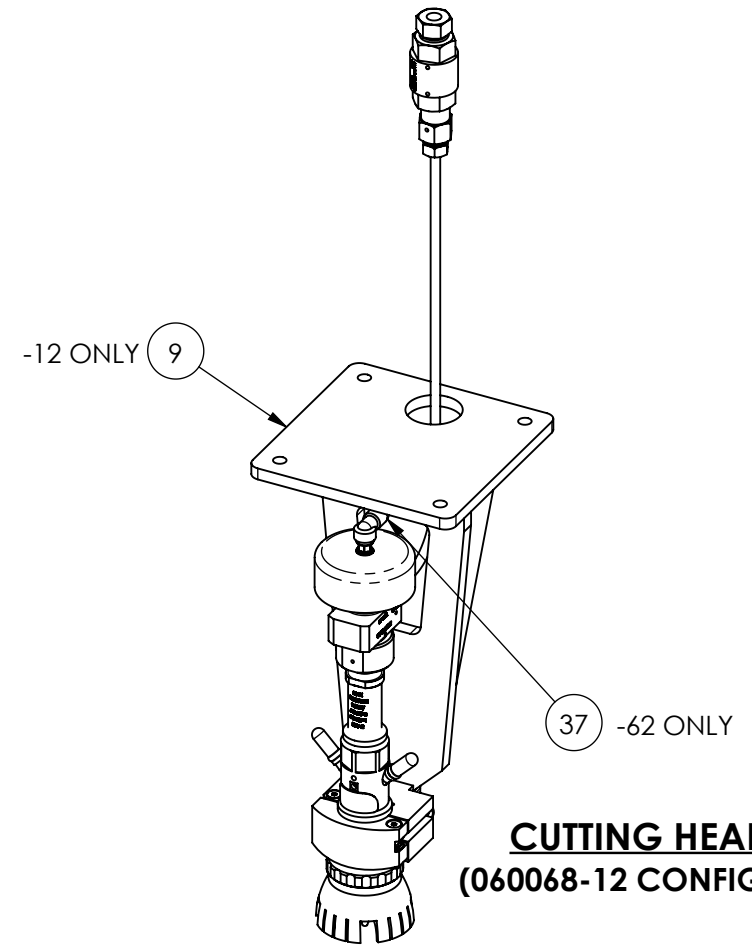

COMPLETE METALWORKING SOLUTIONS
 (800) 991-4225 www.ahbinc.com
 ISO Certified customerservice@ahbinc.com

CUTTING HEAD KIT - CWJ
 060068-1

CUTTING HEAD KIT - CWJ
 (060068-12 CONFIGURATION - M200)

THIRD ANGLE PROJECTION				THIS DRAWING IS THE PROPERTY OF FLOW INTERNATIONAL CORPORATION AND IS NOT TO BE COPIED OR REPRODUCED WITHOUT THE WRITTEN CONSENT OF FLOW INTERNATIONAL CORPORATION.	
DRAWN BY R. MANN		STARTED 2016-06-24	ENG M.CERAMI	EST WEIGHT x	MODELED IN SOLIDWORKS
TITLE CUTTING HEAD KIT					
REVISION D	SCALE 1:3.5	BASE PART NUMBER 060068		2 OF 8	

NOTES:

- [301] ITEM NOT SHOWN.
- [302] BAG FASTENERS AND INCLUDE WITH ASSEMBLY.
- [303] PLUG UNUSED I/O PORTS ON A-31275-1 (LOCATED ON 058680 - VERTICAL AXIS ASSY) WITH ITEM 34 (A-25452-1). REFER TO M500 ELECTRICAL SCHEMATIC (058773) FOR DETAILS.

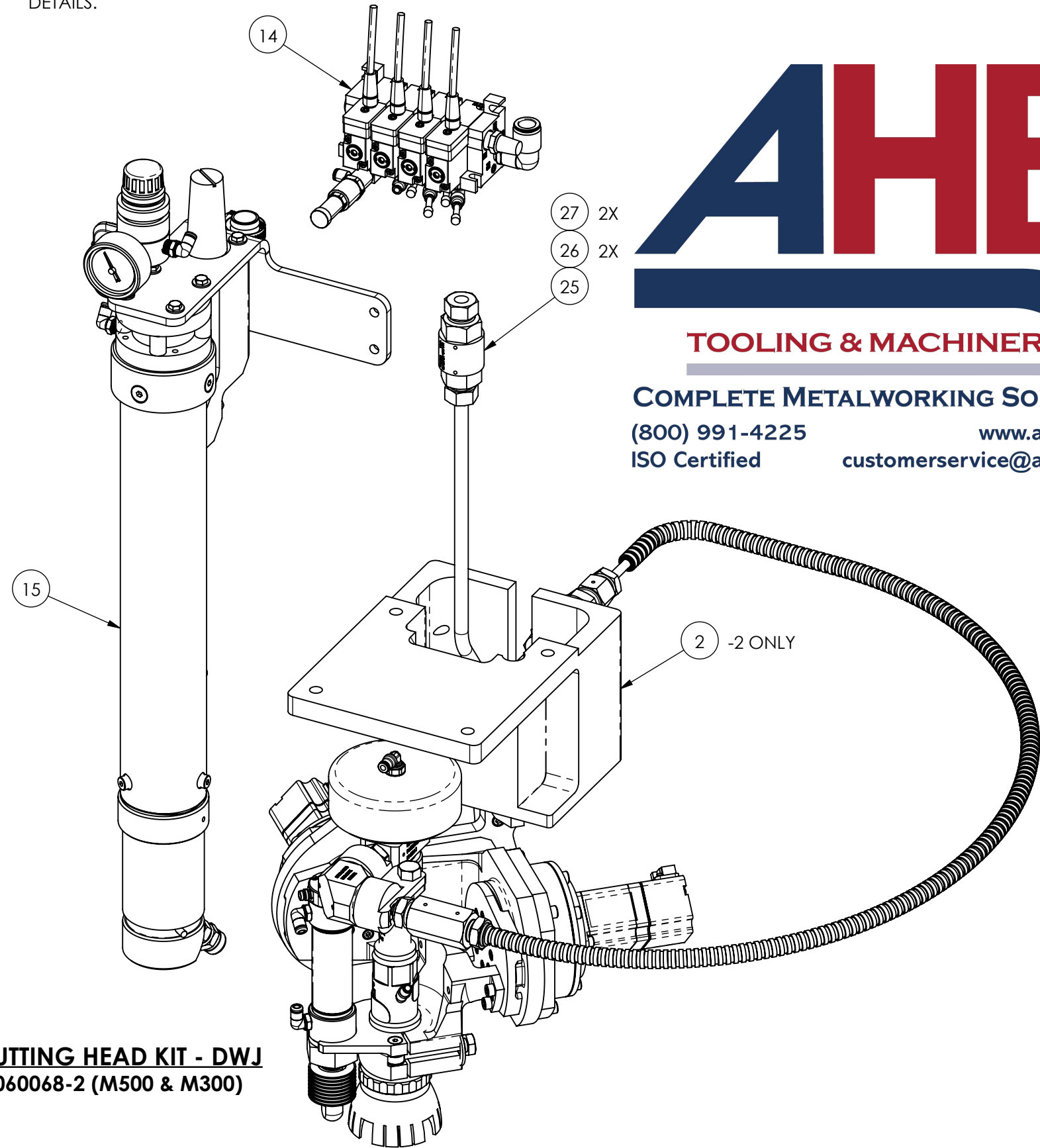

CUTTING HEAD KIT - DWJ
060068-2 (M500 & M300)

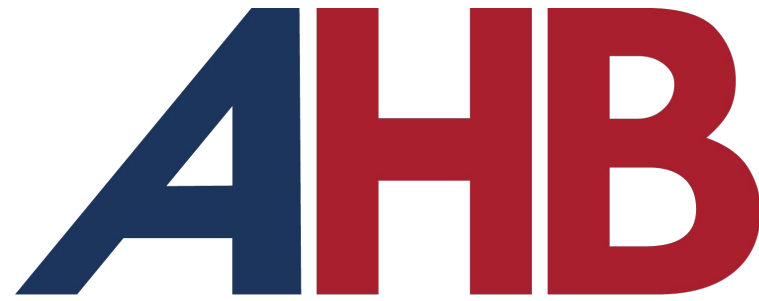

TOOLING & MACHINERY

COMPLETE METALWORKING SOLUTIONS

(800) 991-4225

www.ahbinc.com

ISO Certified

customerservice@ahbinc.com

ITEM	-22	-2	U/M	PART NO.	DESCRIPTION
2	-	1	EA	058796-2	WRIST ASSY;DYN;M500;87 KSI
8	1	-	EA	058796-22	WRIST ASSY;DYN;M200;87 KSI
[301] 13	4000	4000	MM	A-20193-5	TUBE;PUR;HIGH DUROMETER;BLU;2.4 MM ID
14	1	1	EA	055434-10	VALVE ASSY;SOLENOID;MANIFOLD;120 PSI
15	1	1	EA	060096-1	METERING VALVE ASSY;SINGLE
[301] 16	8	4	FT	A-24517-6	TUBE;PUR;SOFT A68;BLU;3/16 IN ID
[301] [302] 21	4	4	EA	A-00642-5	WASHER;FLAT;SST;M8
[301] [302] 22	2	2	EA	A-13504-6-14	SCREW;BUTTON HD SCK;SST;M6X1.0;14 MM
[301] [302] 23	2	2	EA	A-00642-4	WASHER;FLAT;SST;M6
25	1	1	EA	012005-1	COUPLING;100 KSI;3/8 IN
26	2	2	EA	A-2838	GLAND;87 KSI;3/8 IN
27	2	2	EA	A-2839	COLLAR;87 KSI;3/8 IN
[301] [302] 30	4	4	EA	A-13505-8-30	SCREW;SHCS;SST;M8X1.25;30 MM
[301] [303] 34	5	5	EA	A-25452-1	CAP;PLASTIC;BLK;THREADED;M8
[301] [302] 35	2	2	EA	A-13505-5-14	SCREW;SHCS;SST;M5X0.8;14 MM
[301] [302] 36	2	2	EA	A-00642-9	CAP;PLASTIC;BLK;THREADED;M5

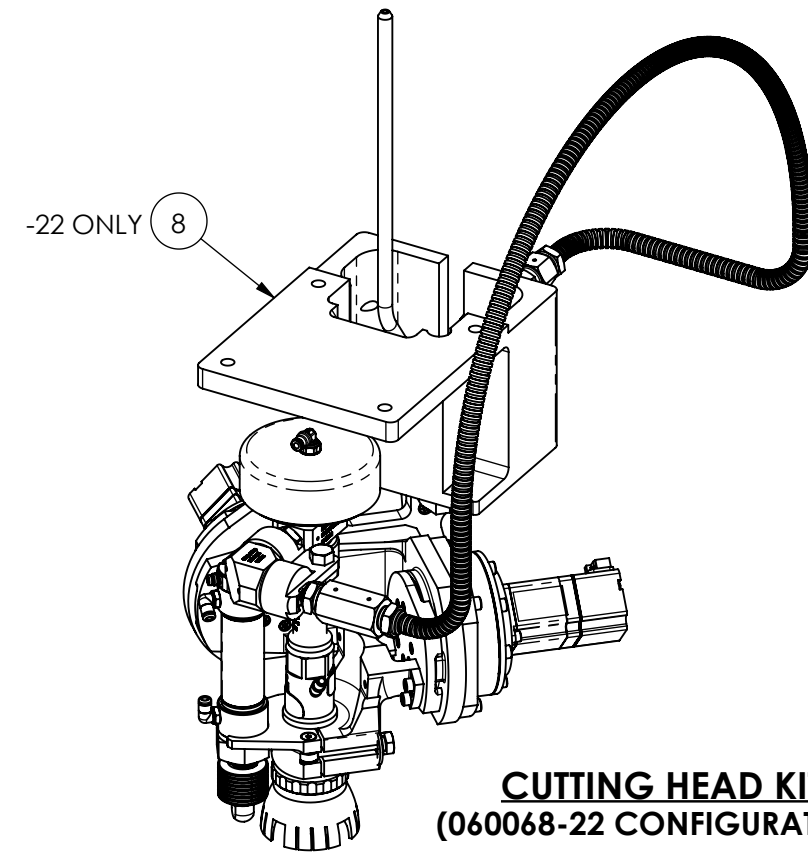

CUTTING HEAD KIT - DWJ
(060068-22 CONFIGURATION - M200)

THIRD ANGLE PROJECTION				THIS DRAWING IS THE PROPERTY OF FLOW INTERNATIONAL CORPORATION AND IS NOT TO BE COPIED OR REPRODUCED WITHOUT THE WRITTEN CONSENT OF FLOW INTERNATIONAL CORPORATION.	
		MATERIAL		SEE BOM	
DRAWN BY R. MANN	STARTED 2016-06-24	ENG M.CERAMI	EST WEIGHT x	MODELED IN SOLIDWORKS	
TITLE CUTTING HEAD KIT					
REVISION D	SCALE 1:3.5	BASE PART NUMBER	060068		3 OF 8

NOTES:

401 ITEM NOT SHOWN.

402 BAG FASTENERS AND INCLUDE WITH ASSEMBLY.

403 PLUG UNUSED I/O PORTS ON A-31275-1 (LOCATED ON 058680 - VERTICAL AXIS ASSY) WITH ITEM 34 (A-25452-1). REFER TO M500 ELECTRICAL SCHEMATIC (058773) FOR DETAILS.

AHB

TOOLING & MACHINERY

COMPLETE METALWORKING SOLUTIONS

(800) 991-4225

www.ahbinc.com

ISO Certified

customerservice@ahbinc.com

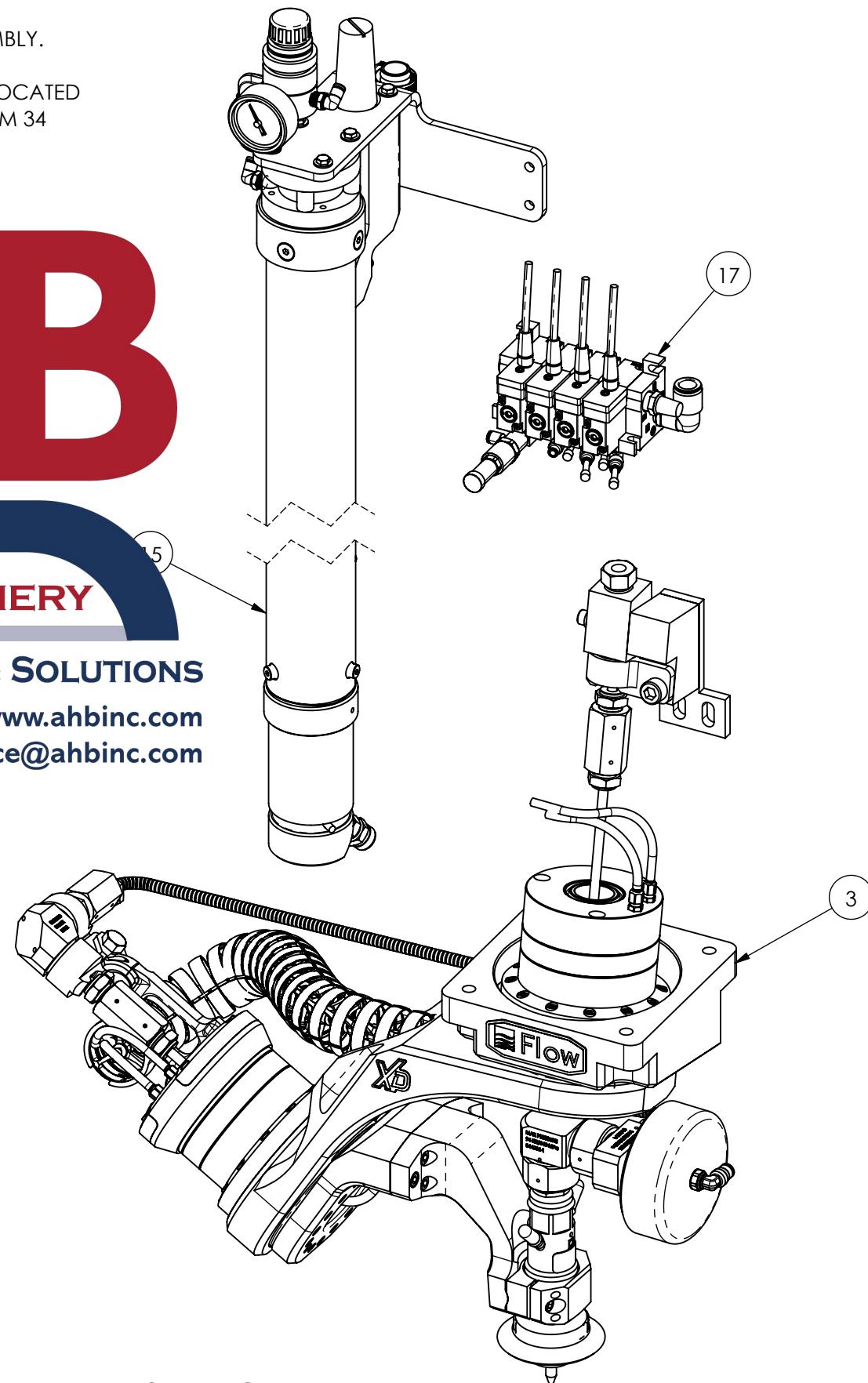

CUTTING HEAD KIT - XD
060068-3

ITEM	-3	U/M	PART NO.	DESCRIPTION
3	1	EA	059355-1	WRIST ASSY;DWJ-XD;M500
401 13	4000	MM	A-20193-5	TUBE;PUR;HIGH DUROMETER;BLU;2.4 MM ID
15	1	EA	060096-1	METERING VALVE ASSY;SINGLE
△ 401 16	6.5	FT	A-24517-6	TUBE;PUR;SOFT A68;BLU;3/16 IN ID
17	1	EA	055434-3	VALVE ASSY;SOLENIOD;MANIFOLD;120 PSI
401 402 20	2	EA	A-13505-8-20	SCREW;SHCS;SST;M8X1.25;20 MM
401 402 21	6	EA	A-00642-5	WASHER;FLAT;SST;M8
401 402 22	2	EA	A-13504-6-14	SCREW;BUTTON HD SCK;SST;M6X1.0;14 MM
401 402 23	2	EA	A-00642-4	WASHER;FLAT;SST;M6
401 402 30	4	EA	A-13504-8-30	SCREW;SHCS;SST;M8X1.25;30 MM
401 31	1	EA	047270-1	ALIGNMENT ASSY;LIGHT GATE;CUTTING HD
401 32	1	EA	047270-DWG	ALIGNMENT ASSY;LIGHT GATE;CUTTING HD
401 33	1	EA	A-19817-21	CORDSET;M12;4 P;90D FEM/FL;8 M LG
401 403 34	6	EA	A-25452-1	CAP;PLASTIC;BLK;THREADED;M8
401 402 35	2	EA	A-13505-5-14	SCREW;SHCS;SST;M5X0.8;14 MM
401 402 36	2	EA	A-00642-9	WASHER;FLAT;SST;M5

THIRD ANGLE PROJECTION				THIS DRAWING IS THE PROPERTY OF FLOW INTERNATIONAL CORPORATION AND IS NOT TO BE COPIED OR REPRODUCED WITHOUT THE WRITTEN CONSENT OF FLOW INTERNATIONAL CORPORATION.	
		MATERIAL		SEE BOM	
DRAWN BY R. MANN	STARTED 2016-06-24	ENG M.CERAMI	EST WEIGHT x	MODELED IN SOLIDWORKS	
TITLE		CUTTING HEAD KIT			
REVISION D	SCALE 1:4	BASE PART NUMBER	060068		4 OF 8

NOTES:

[501] ITEM NOT SHOWN.

[502] BAG FASTENERS AND INCLUDE WITH ASSEMBLY.

[503] PLUG UNUSED I/O PORTS ON A-31275-1 (LOCATED ON 058680 - VERTICAL AXIS ASSY) WITH ITEM 34 (A-25452-1). REFER TO M500 ELECTRICAL SCHEMATIC (058773) FOR DETAILS.



TOOLING & MACHINERY

COMPLETE METALWORKING SOLUTIONS

(800) 991-4225

www.ahbinc.com

ISO Certified

customerservice@ahbinc.com

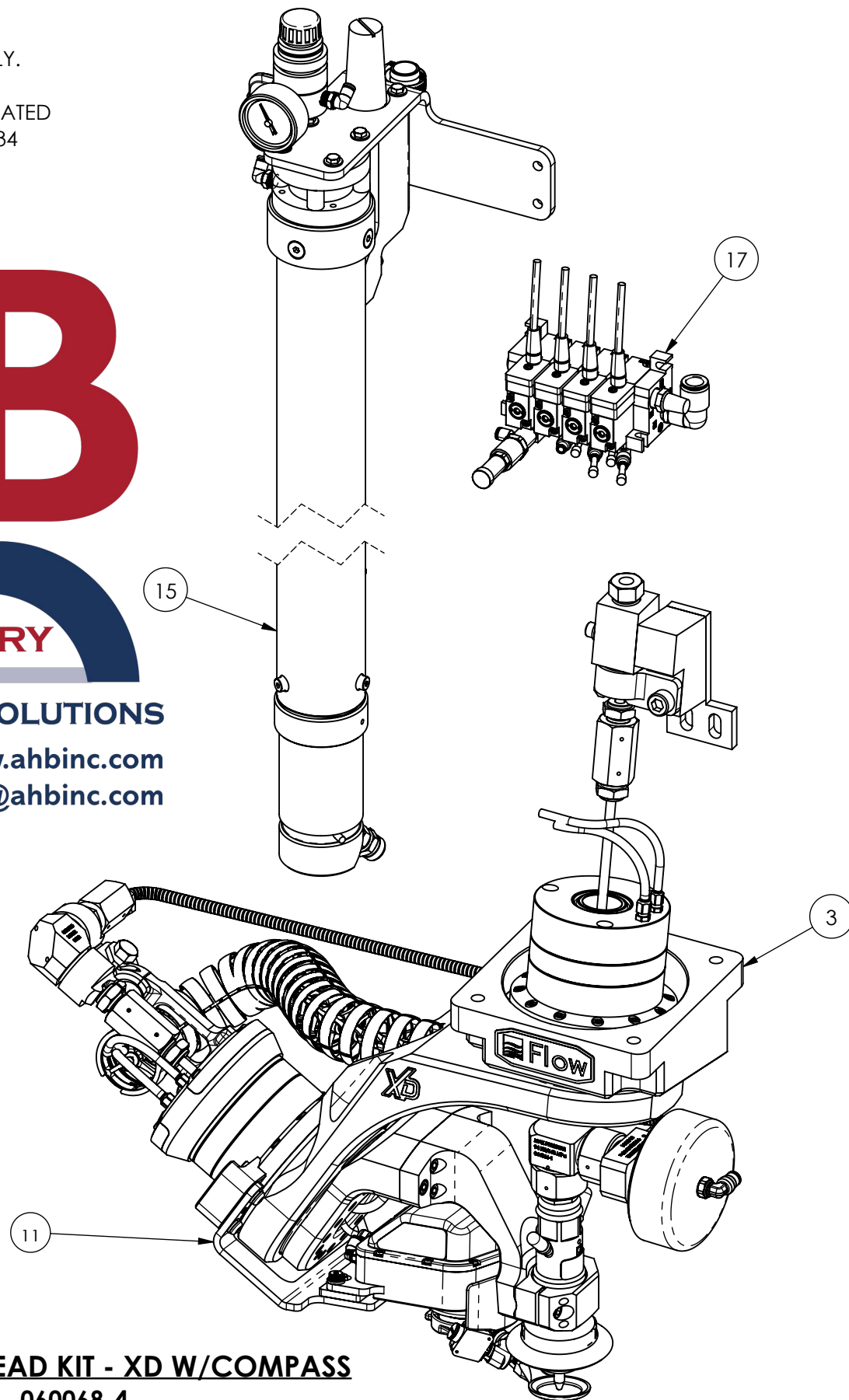

CUTTING HEAD KIT - XD W/COMPASS

060068-4

ITEM	-4	U/M	PART NO.	DESCRIPTION
3	1	EA	059355-1	WRIST ASSY;DWJ-XD;M500
11	1	EA	059978-1	UPGRADE KIT;COMPASS;M500;PRODUCTION
[501] 13	4000	MM	A-20193-5	TUBE;PUR;HIGH DUROMETER;BLU;2.4 MM ID
15	1	EA	060096-1	METERING VALVE ASSY;SINGLE
[501] 16	8	FT	A-24517-6	TUBE;PUR;SOFT A68;BLU;3/16 IN ID
17	1	EA	055434-3	VALVE ASSY;SOLENOID;MANIFOLD;120 PSI
[501] [502] 20	2	EA	A-13505-8-20	SCREW;SHCS;SST;M8X1.25;20 MM
[501] [502] 21	6	EA	A-00642-5	WASHER;FLAT;SST;M8
[501] [502] 22	2	EA	A-13504-6-14	SCREW;BUTTON HD SCK;SST;M6X1.0;14 MM
[501] [502] 23	2	EA	A-00642-4	WASHER;FLAT;SST;M6
[501] [502] 30	4	EA	A-13505-8-30	SCREW;SHCS;SST;M8X1.25;30 MM
[501] 31	1	EA	047270-1	ALIGNMENT ASSY;LIGHT GATE;CUTTING HD
[501] 32	1	EA	047270-DWG	ALIGNMENT ASSY;LIGHT GATE;CUTTING HD
[501] 33	1	EA	A-19817-21	CORDSET;M12;4 P;90D FEM/FL;8 M LG
[501] [503] 34	4	EA	A-25452-1	CAP;PLASTIC;BLK;THREADED;M8
[501] [502] 35	2	EA	A-13505-5-14	SCREW;SHCS;SST;M5X0.8;14 MM
[501] [502] 36	2	EA	A-00642-9	WASHER;FLAT;SST;M5

THIRD ANGLE PROJECTION				THIS DRAWING IS THE PROPERTY OF FLOW INTERNATIONAL CORPORATION AND IS NOT TO BE COPIED OR REPRODUCED WITHOUT THE WRITTEN CONSENT OF FLOW INTERNATIONAL CORPORATION.	
		MATERIAL		SEE BOM	
DRAWN BY R. MANN	STARTED 2016-06-24	ENG M.CERAMI	EST WEIGHT x	MODELED IN SOLIDWORKS	
TITLE		CUTTING HEAD KIT			
REVISION D	SCALE 1:4	BASE PART NUMBER	060068		5 OF 8

NOTES:

601 ITEM NOT SHOWN.

602 BAG FASTENERS AND INCLUDE WITH ASSEMBLY.

603 PLUG UNUSED I/O PORTS ON A-31275-1 (LOCATED ON 058680 - VERTICAL AXIS ASSY) WITH ITEM 34 (A-25452-1). REFER TO M500 ELECTRICAL SCHEMATIC (058773) FOR DETAILS.

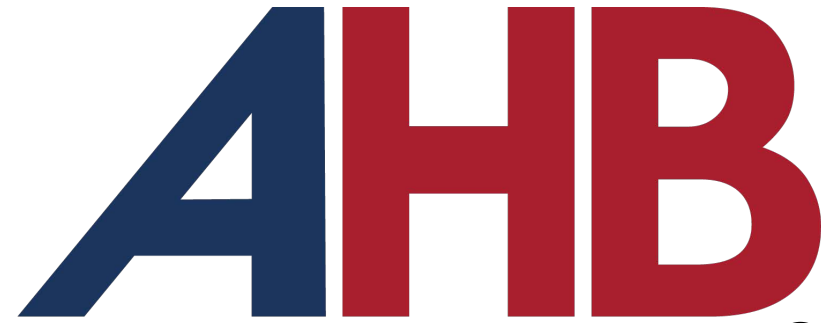

TOOLING & MACHINERY

COMPLETE METALWORKING SOLUTIONS

(800) 991-4225

www.ahbinc.com

ISO Certified

customerservice@ahbinc.com

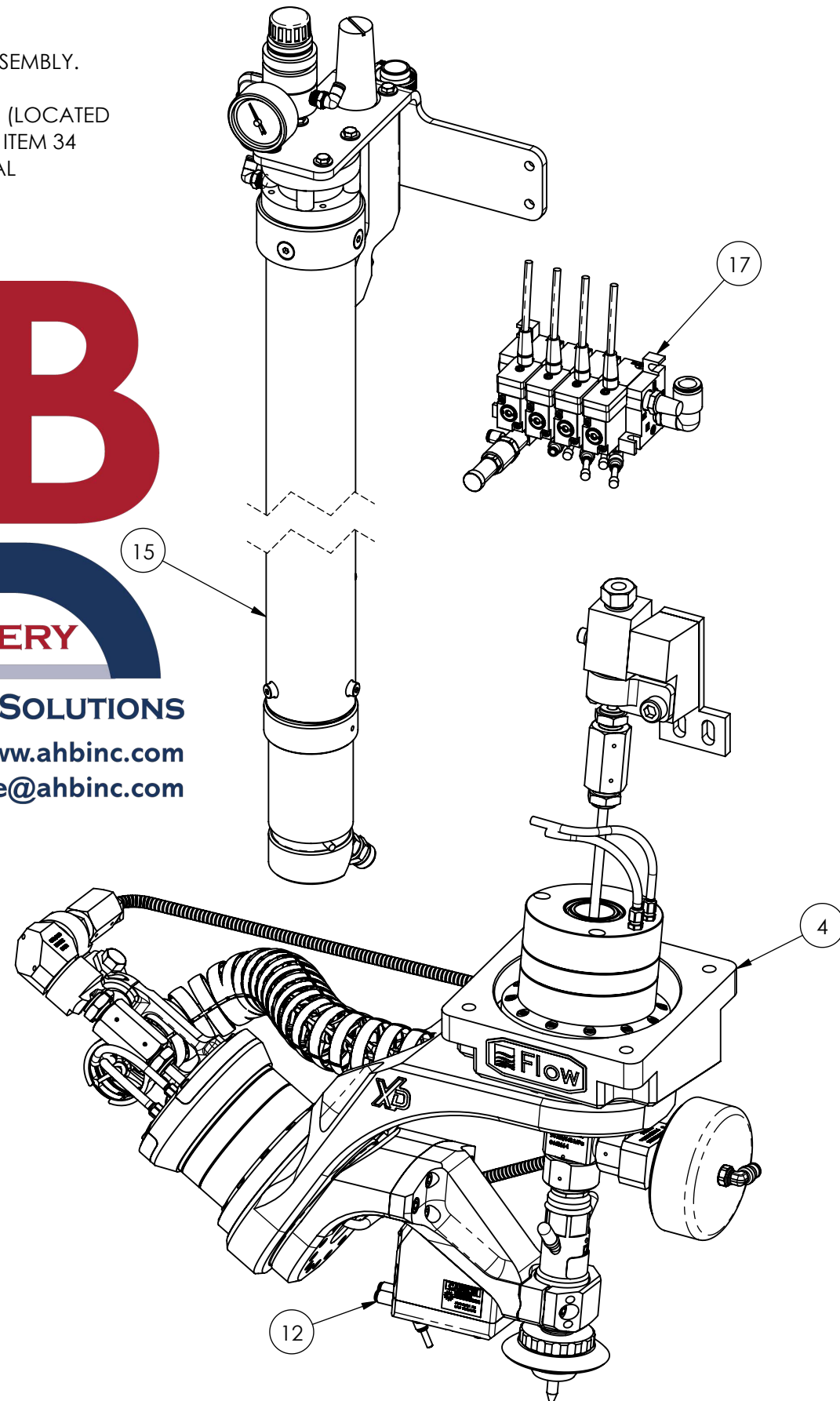

ITEM	-5	U/M	PART NUMBER	DESCRIPTION		
4	1	EA	059355-2	WRIST ASSY;DWJ-XD;M500		
12	1	EA	052350-1	UPGRADE KIT;LHS;XD WRIST;RETROFIT		
601	13	4000	MM	A-20193-5	TUBE;PUR;HIGH DUROMETER;BLU;2.4 MM ID	
601	15	1	EA	060096-1	METERING VALVE ASSY;SINGLE	
601	16	8	FT	A-24517-6	TUBE;PUR;SOFT A68;BLU;3/16 IN ID	
601	17	1	EA	055434-3	VALVE ASSY;SOLENOID;MANIFOLD;120 PSI	
601	602	20	2	EA	A-13505-8-20	SCREW;SHCS;SST;M8X1.25;20 MM
601	602	21	6	EA	A-00642-5	WASHER;FLAT;SST;M8
601	602	22	2	EA	A-13504-6-14	SCREW;BUTTON HD SCK;SST;M6X1.0;14 MM
601	602	23	2	EA	A-00642-4	WASHER;FLAT;SST;M6
601	24	1	EA	059416-1	HEIGHT SENSOR ASSY;LASER;M500	
601	602	30	4	EA	A-13505-8-30	SCREW;SHCS;SST;M8X1.25;30 MM
601	31	1	EA	047270-1	ALIGNMENT ASSY;LIGHT GATE;CUTTING HD	
601	32	1	EA	047270-DWG	ALIGNMENT ASSY;LIGHT GATE;CUTTING HD	
601	33	1	EA	A-19817-21	CORDSET;M12;4 P;90D FEM/FL;8 M LG	
601	603	34	4	EA	A-25452-1	CAP;PLASTIC;BLK;THREADED;M8
601	602	35	2	EA	A-13505-5-14	SCREW;SHCS;SST;M5X0.8;14 MM
601	602	36	2	EA	A-00642-9	WASHER;FLAT;SST;M5

CUTTING HEAD KIT - XD W/LASER HEIGHT SETTER
060068-5

UNCONTROLLED COPY. USER IS RESPONSIBLE FOR VERIFYING THE CURRENT REVISION LEVEL.

THIRD ANGLE PROJECTION			THIS DRAWING IS THE PROPERTY OF FLOW INTERNATIONAL CORPORATION AND IS NOT TO BE COPIED OR REPRODUCED WITHOUT THE WRITTEN CONSENT OF FLOW INTERNATIONAL CORPORATION.		
			MATERIAL SEE BOM		
DRAWN BY R. MANN	STARTED 2016-06-24	ENG M.CERAMI	EST WEIGHT x	MODELED IN SOLIDWORKS	
TITLE		CUTTING HEAD KIT			
REVISION D	SCALE 1:4	BASE PART NUMBER	060068		6 OF 8

NOTES:

701 ITEM NOT SHOWN.

702 BAG FASTENERS AND INCLUDE WITH ASSEMBLY.

703 PLUG UNUSED I/O PORTS ON A-31275-1 (LOCATED ON 058680 - VERTICAL AXIS ASSY) WITH ITEM 34 (A-25452-1). REFER TO M500 ELECTRICAL SCHEMATIC (058773) FOR DETAILS.



COMPLETE METALWORKING SOLUTIONS
 (800) 991-4225 www.ahbinc.com
 ISO Certified customerservice@ahbinc.com

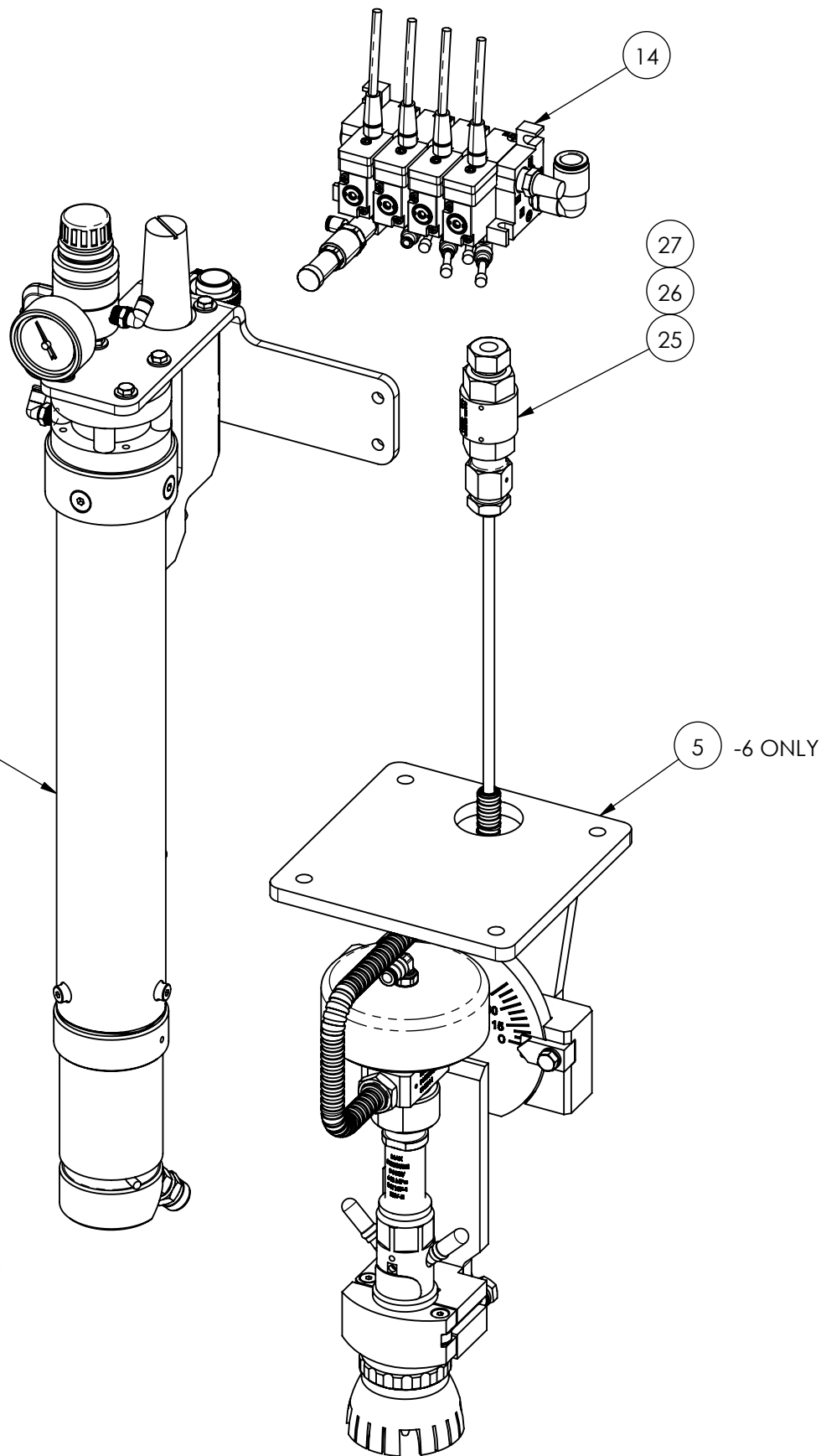

CUTTING HEAD KIT - CWJ MANUAL TILT
 060068-6

ITEM	-62	-6	U/M	PART NUMBER	DESCRIPTION
5	-	1	EA	061058-1	CUTTING HEAD ASSY;87 KSI;TLT HD
10	1	-	EA	061058-2	CUTTING HEAD ASSY;60 KSI;TLT HD
701 13	4000	4000	MM	A-20193-5	TUBE;PUR;HIGH DUROMETER;BLU;2.4 MM ID
14	1	1	EA	055434-10	VALVE ASSY;SOLENOID;MANIFOLD;120 PSI
15	1	1	EA	060096-1	METERING VALVE ASSY;SGL
701 16	8	8	FT	A-24517-6	TUBE;PUR;SOFT A68;BLU;3/16 IN ID
701 702 21	4	4	EA	A-00642-5	WASHER;FLAT;SST;M8
701 702 22	2	2	EA	A-13504-6-14	SCREW;BUTTON HD SCK;SST;M6X1.0;14 MM
701 702 23	2	2	EA	A-00642-4	WASHER;FLAT;SST;M6
25	1	1	EA	012005-1	COUPLING;100 KSI;3/8 IN
26	1	1	EA	A-2838	GLAND;87 KSI;3/8 IN
27	1	1	EA	A-2839	COLLAR;87 KSI;3/8 IN
701 702 30	4	4	EA	A-13505-8-30	SCREW;SHCS;SST;M8X1.25;30 MM
701 703 34	6	6	EA	A-25452-1	CAP;PLASTIC;BLK;THREADED;M8
701 702 35	2	2	EA	A-13505-5-14	SCREW;SHCS;SST;M5X0.8;14 MM
701 702 36	2	2	EA	A-00642-9	WASHER;FLAT;SST;M5
37	1	-	EA	A-13928-2	REDUCER;TUBE END;NYLON;NA;4 MM;6 MM

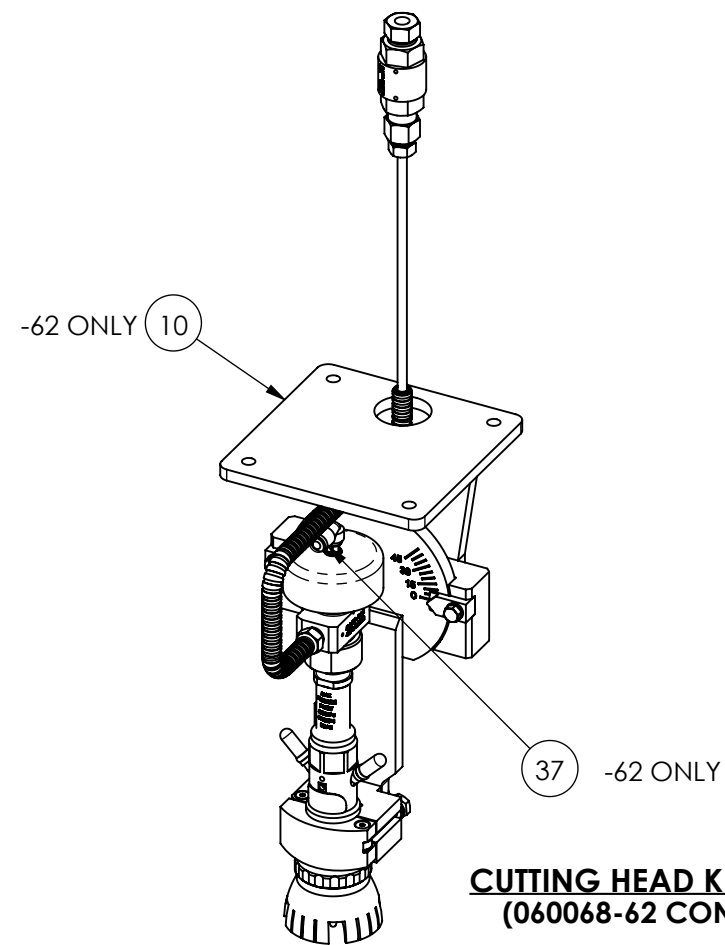

CUTTING HEAD KIT - CWJ MANUAL TILT
 (060068-62 CONFIGURATION - M200)

THIRD ANGLE PROJECTION				THIS DRAWING IS THE PROPERTY OF FLOW INTERNATIONAL CORPORATION AND IS NOT TO BE COPIED OR REPRODUCED WITHOUT THE WRITTEN CONSENT OF FLOW INTERNATIONAL CORPORATION.	
DRAWN BY R. MANN		STARTED 2016-06-24	ENG M.CERAMI	EST WEIGHT x	MODELED IN SOLIDWORKS
TITLE CUTTING HEAD KIT					
REVISION D	SCALE 1:3.5	BASE PART NUMBER	060068		7 OF 8

NOTES:

801 ITEM NOT SHOWN.

802 BAG FASTENERS AND INCLUDE WITH ASSEMBLY.

803 PLUG UNUSED I/O PORTS ON A-31275-1 (LOCATED ON 058680 - VERTICAL AXIS ASSY) WITH ITEM 34 (A-25452-1). REFER TO M200 ELECTRICAL SCHEMATIC (060222) FOR DETAILS.

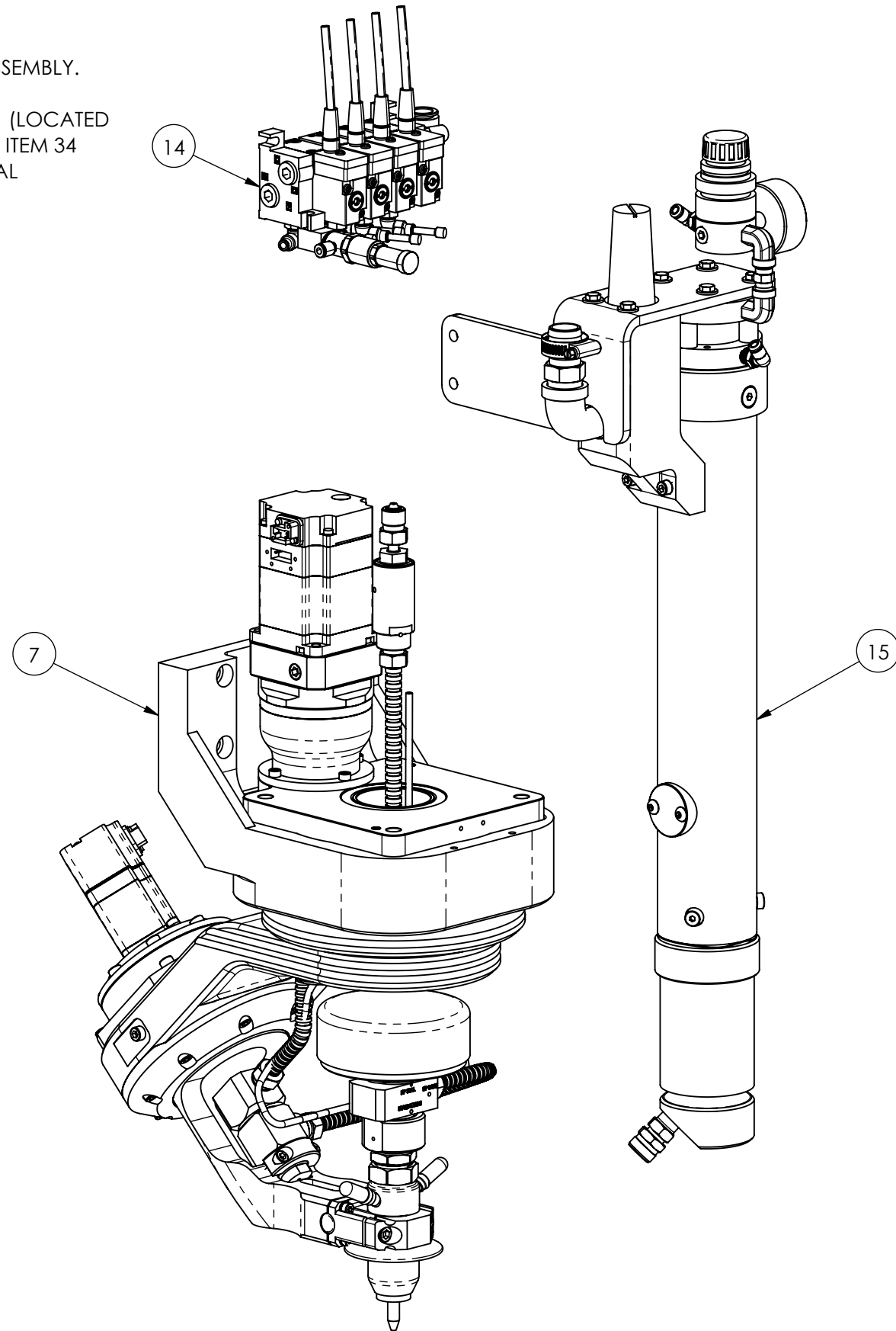

CUTTING HEAD KIT - M200 PIVOT PLUS
060068-7

ITEM	-7	U/M	PART NUMBE	DESCRIPTION
7	1	EA	060244-1	WRIST ASSY;DWJ PVT PLUS;M200
13	4000	MM	A-20193-5	TUBE;PUR;HIGH DUROMETER;BLU;2.4 MM ID
14	1	EA	055434-10	VALVE ASSY;SOL;MANIFOLD;120 PSI
15	1	EA	060096-1	METERING VALVE ASSY;SGL
16	3	FT	A-24517-6	TUBE;PUR;SOFT A68;BLU;3/16 IN ID
22	2	EA	A-13505-6-14	SCREW;SHCS;SST;M6X1.0;14 MM
23	2	EA	A-00642-4	WASHER;FLAT;SST;M6
30	4	EA	A-13505-8-30	SCREW;SHCS;SST;M8X1.25;30 MM
34	6	EA	A-25452-1	CAP;PLASTIC;BLK;THREADED M8
35	2	EA	A-13505-5-14	SCREW;SHCS;SST;M5X0.8;14 MM
36	2	EA	A-00642-9	WASHER;FLAT;SST;M5



COMPLETE METALWORKING SOLUTIONS
(800) 991-4225 www.ahbinc.com
ISO Certified customerservice@ahbinc.com

THIRD ANGLE PROJECTION			THIS DRAWING IS THE PROPERTY OF FLOW INTERNATIONAL CORPORATION AND IS NOT TO BE COPIED OR REPRODUCED WITHOUT THE WRITTEN CONSENT OF FLOW INTERNATIONAL CORPORATION.		
DRAWN BY R. MANN		STARTED 2016-06-24	ENG M.CERAMI	EST WEIGHT x	MODELED IN SOLIDWORKS
TITLE		CUTTING HEAD KIT			
REVISION D	SCALE 1:3.5	BASE PART NUMBER	060068		8 OF 8