



# Flow

## MACH 3 WATERJET SERIES

# AHB

TOOLING & MACHINERY, INC.

COMPLETE METALWORKING SOLUTIONS

(800) 991-4225

[www.ahbinc.com](http://www.ahbinc.com)

ISO Certified

[customerservice@ahbinc.com](mailto:customerservice@ahbinc.com)



# *MACH 3*

## THE WORLD'S MOST POPULAR WATERJET





## PROVEN PERFORMANCE

Thousands of installations worldwide have earned our Mach 3 the title of "The World's Most Popular Waterjet." More importantly, reliable performance, day in and day out is what means the most to our customers, and the Mach 3 consistently delivers proven results.

## CUTTING HEAD TECHNOLOGY



### PURE WATERJET

Hair-thin pure waterjet stream cuts soft materials.

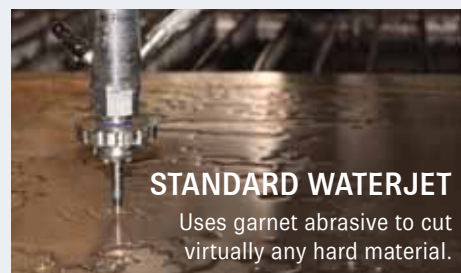

### STANDARD WATERJET

Uses garnet abrasive to cut virtually any hard material.



### DYNAMIC WATERJET®

Three times faster and more accurate than Standard Waterjet.

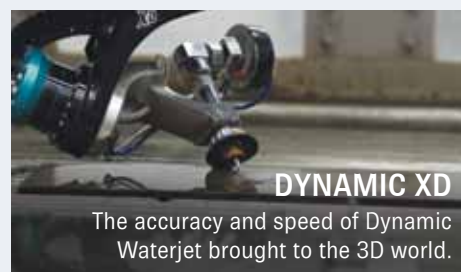

### DYNAMIC XD

The accuracy and speed of Dynamic Waterjet brought to the 3D world.



## UNMATCHED WATERJET AT A COMPETITIVE PRICE



### MACH 3 2513b

\*See additional sizes and specifications on back

## A PUMP FOR EVERY APPLICATION

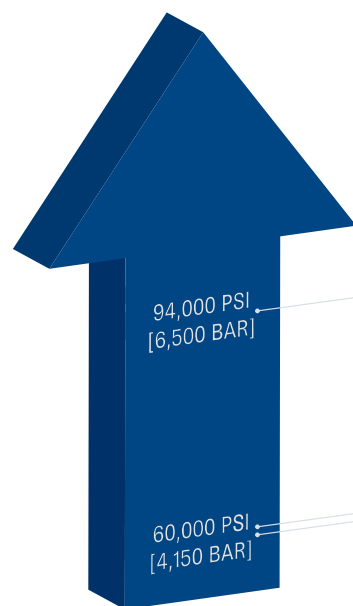

### HYPERJET®

94,000 PSI [6,500 BAR]

With pressures rated at an industry leading 94,000 psi [6,500 bar] and continuous operating pressures of 87,000 psi [6,000 bar], HyperJet pumps provide maximum productivity.

### INTENSIFIER

60,000 PSI [4,150 BAR]

With continuous operating pressure at 60,000 psi [4,150 bar], this is the longest lasting, lowest maintenance ultrahigh-pressure pump in the industry.

### HYPLEX® PRIME

60,000 PSI [4,150 BAR]

With pressures rated at 60,000 psi [4,150 bar] and continuous operating pressures of 55,000 psi [3,800 bar], HyPlex Prime pumps are the highest pressure, most advanced direct drive pumps available today.

## PRESSURE = PRODUCTIVITY

Flow offers the widest array of high-pressure pumps. Each is fully integrated with sensor driven diagnostics that are monitored by the Mach 3 operator station.

## THE WORLD'S MOST POPULAR WATERJET



### RUGGED MECHANICAL DESIGN

Heavy-duty two piece steel construction. Laser calibrated and ball bar inspected.



### PREMIUM MOTION SYSTEM

Precision ball screw with spin-the-nut technology and high-resolution digital drives provides highly accurate, quick movement.



### ULTIMATE ACCESSIBILITY

Open design with full worktable access on three sides for easy loading and unloading of material.



### PASER CUTTING SYSTEM

Reliable abrasive delivery and cutting package that precisely meters abrasive and provides perfect stream alignment.



### COMPREHENSIVE SOFTWARE SUITES

Easy to use FlowMaster® and FlowXpert™ software suites allow you to program a part in minutes—virtually any material, any thickness.



### ROLL-AROUND CONTROL

Convenient roll-around operating console easily reaches your entire work envelope. All diagnostics from your integrated waterjet are displayed on your PC.

## PRESSURE = PRODUCTIVITY

The physics are simple and the results are conclusive: the faster your waterjet stream moves, the faster you can cut. A faster waterjet stream also uses less abrasive.

Cut Faster | Lower Costs | Increase Production

Whether you are prototyping one-off parts or producing large quantities of parts, higher pressure will get your job done significantly faster and at an overall lower cost.



## SMARTSTREAM™ TECHNOLOGY

Our exclusive SmartStream technology uses patented complex mathematical models that automatically adjust your cutting stream based on the material parameters you choose. Simply select your material type and thickness from the library of over 100 tested and pre-programmed materials. SmartStream will calculate the correct speed and angles to provide you with a precise part at the fastest speed possible.

## DYNAMIC WATERJET®—DYNAMICALLY SUPERIOR PARTS

Our patented Dynamic Waterjet works unlike any other system. Using our SmartStream technology, Dynamic Waterjet not only counters stream lag and taper (characteristics inherent to waterjet), but also automatically tilts and monitors the speed of your cutting head on the fly. This ensures the part you pick up off the table is cut as quickly as possible, and to high precision.

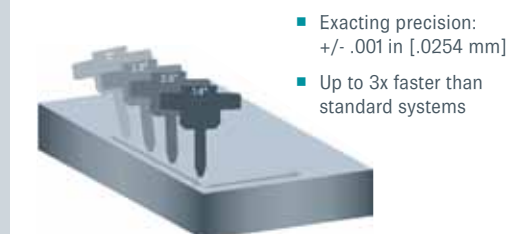

- Exacting precision: +/- .001 in [.0254 mm]
- Up to 3x faster than standard systems

## DYNAMIC WATERJET® XD—DYNAMICALLY SUPERIOR PARTS

Dynamic XD incorporates the unique capabilities of SmartStream technology and Dynamic Waterjet for bevel cutting. This distinctive Flow technology can cut with 5-axis motion, even cutting compound angles with improved speed and accuracy. Easily cut flat stock with up to +/- 60° of motion.

Test cut for safety required on all formed and 3D parts.

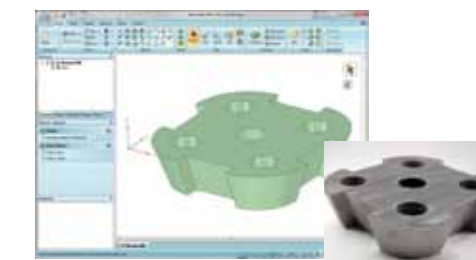

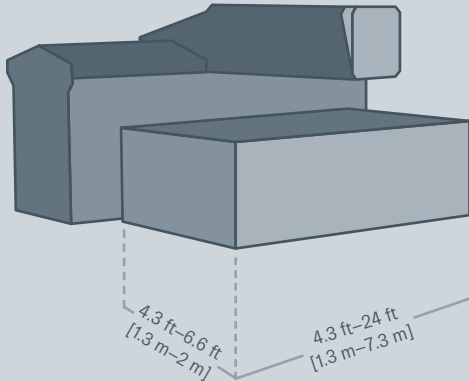

### Mach 3 Specifications

Linear Straightness Accuracy	0.0015 in per 3 ft	.0381 mm per 1 m
Cut Speed	Up to 300 ipm	7.6 m/min
Traverse Speed	Up to 500 ipm	12.7 m/min
Repeatability	.002 in	.050 mm
Z Travel	7 in	178 mm
Sizes		
1313b	4 ft x 4 ft	1.3 m x 1.3 m
2513b	8 ft x 4 ft	2.5 m x 1.3 m
3020b	10 ft x 6.5 ft	3.0 m x 2.0 m
4020b	13 ft x 6.5 ft	4.0 m x 2.0 m
7320b	24 ft x 6.5 ft	7.3 m x 2.0 m

### ADDITIONAL OPTIONS & ACCESSORIES

- High-Performance Motion Package
- Operator Convenience Package
- FlowTeach™ with Wireless Pendant
- HydroClean™ Abrasive Removal System
- UltraPierce™ Material Piercing Assist
- Laser Edge Finder
- FlowNest® Software
- FlowShift Vectorization Software
- High-Pressure Pump Option up to 94,000 psi [6,500 bar]
- ProXtract™ Part Removal Wand
- And More



#### UNITED STATES & CANADA

23500 64th Avenue South  
 Kent, Washington 98032 USA  
 Tel: 253-850-3500  
 TOLL-FREE: 800-446-3569  
 Fax: 253-813-3285  
 info@flowcorp.com  
 FlowWaterjet.com

#### CENTRAL AMERICA, SOUTH AMERICA, MEXICO & CARIBBEAN

Tel: +55-11-3616-2822  
 flowlatino@flowlatino.com  
 FlowLatino.com

#### EUROPE, MIDDLE EAST & AFRICA

Tel: +49-7252-538-0  
 info@flowgmbh.com  
 FlowEurope.com

#### TAIWAN, CHINA, KOREA, SOUTHEAST ASIA, AUSTRALIA & NEW ZEALAND

Tel: +886-3-577-2102  
 sales@flowasia.com.tw  
 FlowAsia.com

#### JAPAN

Tel: +81-52-701-7021  
 fjc@flowjapan.co.jp  
 FlowAsia.com

© 2011 Flow International Corporation. All Rights Reserved. Specification and depictions are correct at time of printing.

Flow reserves the right to make specification and design changes. Version 0711.



#### COMPLETE METALWORKING SOLUTIONS

(800) 991-4225  
 ISO Certified

www.ahbinc.com  
 customerservice@ahbinc.com