

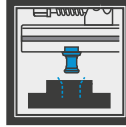

**METAL CUTTING<sup>®</sup>**  
**SPECIALISTS**  
**FULL CIRCLE SOLUTIONS**

## I COMPACT GRIP VISES APPLICATION EXAMPLES ON 5 AXIS MACHINES

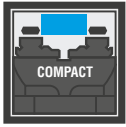

### Art.650 Compact Grip

The absolute news for 5 axis machine centres and new multiclamping system are the self-centering Compact Grip vises. Their name identifies the main vise features which are the extreme compactness and easiest handling and the system of inserts which adopts, so called "GRIP". This system includes a range of jaw plates assembled on the top of the main jaw with the function of clamping the workpiece through sharp or duly shaped teeth according to the material type and hardness to clamp.



7

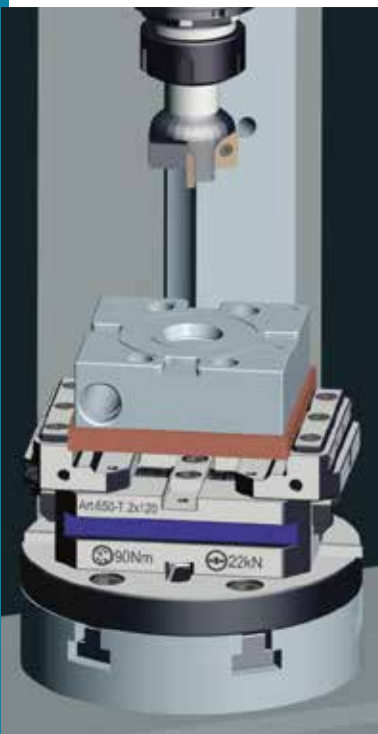

Through the Grip insert you can rough mill and finish the workpiece on five sides.



Insert Grip detail.

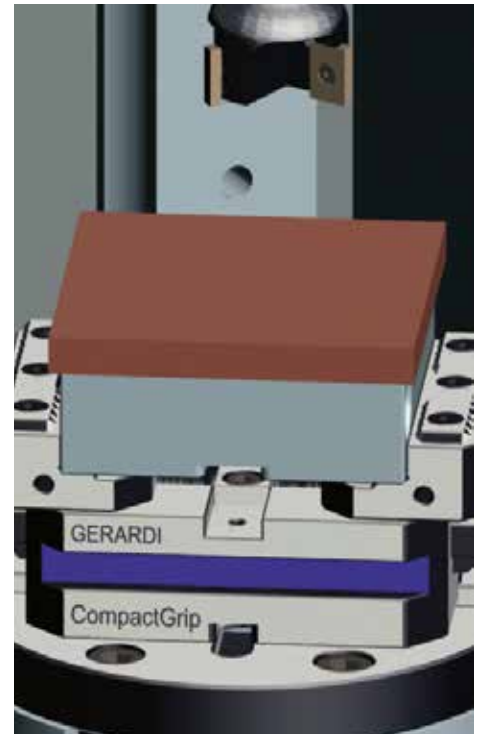

Then through the smooth jaw step you can remove the remaining stock allowance from the workpiece and finish the workpiece

## FMS VISES APPLICATION EXAMPLES ON 5 AXIS MACHINES

**NEW!**

**Art.868 FMS series**

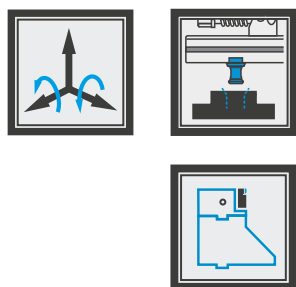

Thanks to the extreme versatility of the Gerardi Modular System even the FMS vises, properly reconfigured, can be used as Multitasking vises for 5 axis machine centres.

It will be enough to assemble the movable base Art.814 with the Art.805V jaws on the universal vise base module Art.855

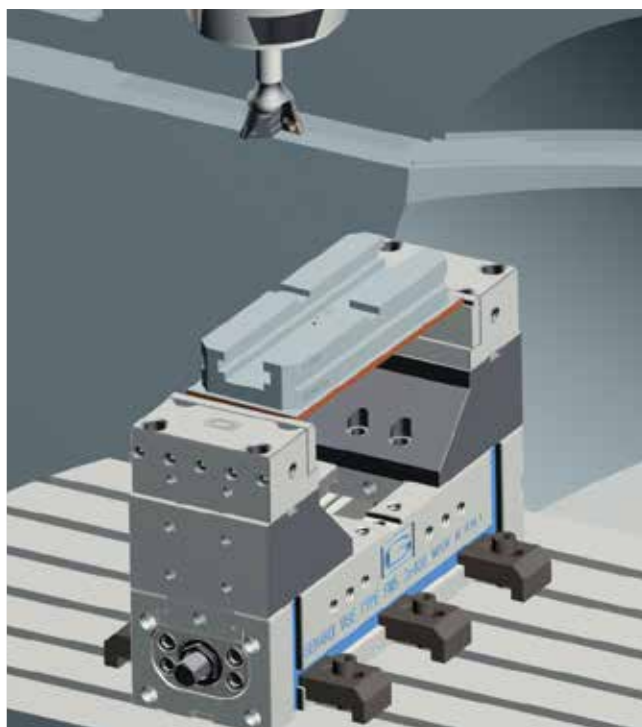
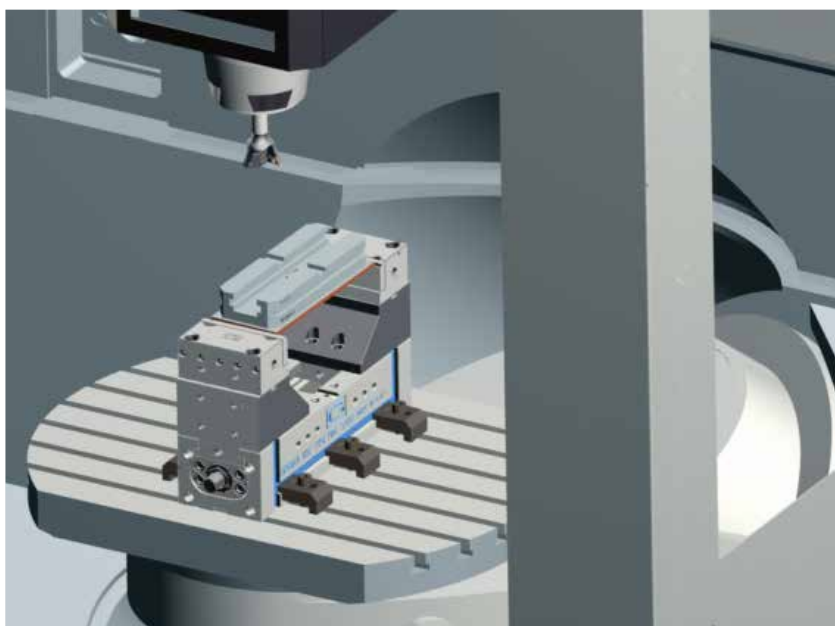

Particolare sollevato tramite base mobile Art.814  
Workpiece raised by movable base Art.814



Dettaglio serraggio tramite piastrina GRIP Art.247T  
Detail of clamping by GRIP jaw plate Art.247T

| Tipo (grandezza) morsa / Vise (type) size | 1    |            |            | 2          |  |  |
|---|------|------------|------------|------------|--|--|
|   | kN   | 12 kN      |            | 22 kN      |  |  |
| <b>Art. 650</b> Tipo / Type <b>1x120</b>  | A    | 48         | 88         | 128        |  |  |
|   | A1   |            | 6          |            |  |  |
|   | W    |            | 50         |            |  |  |
|   | B    |            | 65         |            |  |  |
|   | C    |            | 45         |            |  |  |
|   | C1   |            | 53         |            |  |  |
|   | C2   |            | 61         |            |  |  |
|   | D    |            | 80         |            |  |  |
|   | E    | 80         | 120        | 160        |  |  |
|   | F    |            | 52         |            |  |  |
|   | L    |            | 12         |            |  |  |
|   | L1   |            | M8         |            |  |  |
|   | kg   | 1,8        | 2,6        | 3,4        |  |  |
|   | Cod. | 7.65.01080 | 7.65.01120 | 7.65.01160 |  |  |

Morsa Autocentrante Compact Grip con ganasce reversibili, ideale per centri a 5 assi

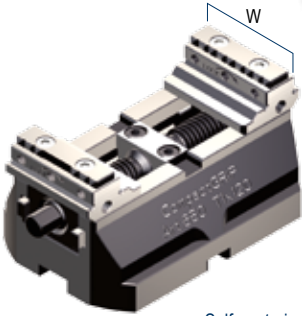

Self-centering Compact Grip vise. with reversible jaws, Ideal for five axis centres.

**COMPACT GRIP**  
**NEW!**

**Art. 650** Tipo / Type **2x160**

**COMPACT GRIP**  
**NEW!**

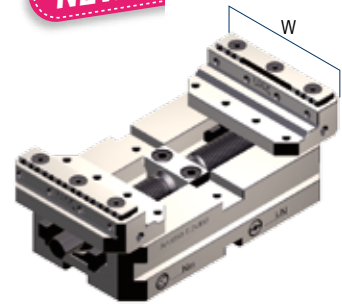

**AMPLIA LE TUE APPLICAZIONI TRAMITE GLI ACCESSORI MODULARI !**

**Art. 651H**

Tipo / Type **1**

Rialzo Semplice  
Simple Riser

Vedi gamma completa - See the complete range Page 7.26 / 7.27

|      |                  |                  |                  |
|------|------------------|------------------|------------------|
| Cod. | 7.65.1H108 / 100 | 7.65.1H112 / 100 | 7.65.1H116 / 100 |
|------|------------------|------------------|------------------|

**Art. 651H**

Tipo / Type **2**

Rialzo Semplice  
Simple Riser

**Art. 660**

Interasse / Type **52 mm**

Tavola cambio rapido  
Quick change table

Vedi gamma completa - See the complete range Page 7.28 / 7.29

|      |            |
|------|------------|
| Cod. | 9.66.05200 |
|------|------------|

**Art. 660**

Interasse / Type **52 mm**

Tavola cambio rapido  
Quick change table

**Art. 650T G01**

Inseri ganasce - Top jaw inserts  
**GRIP (Passo - Pitch 1,5mm)**

|      |               |
|------|---------------|
| Cod. | 7.65.0T100/01 |
| €    |               |

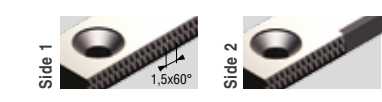

**Art. 650T G02**

Inseri ganasce - Top jaw inserts  
**GRIP (Passo - Pitch 2mm)**

|      |               |
|------|---------------|
| Cod. | 7.65.0T100/02 |
| €    |               |

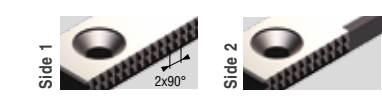

**Art. 650T G11**

Inseri ganasce - Top jaw inserts  
**GRIP (Passo - Pitch 11mm)**

|      |               |
|------|---------------|
| Cod. | 7.65.0T100/11 |
| €    |               |

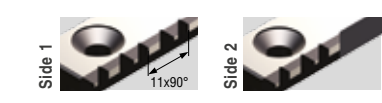

**Dotazione standard:**

- 1 chiave a pipa Art.375 ■ 1 coppia di inserti extra Art.650T ■ 1 perno calibrato per centraggio e orientamento Art.79 oppure 1 tirante zero point Art.11S ■ 1 arresto laterale Art.370
- 2 tasselli di posizionamento Art.297 ■ 2 tasselli per regolazione autocentrante Art.650G

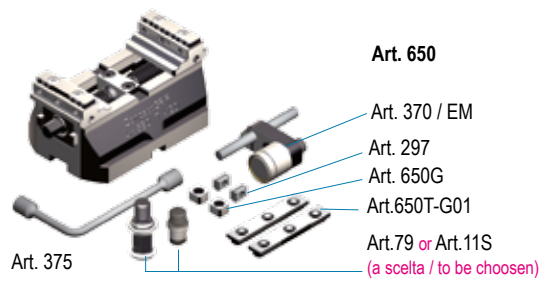

**Standard equipment:**

- 1 box wrench Art.375 ■ 1 extra pair of top jaw inserts Art.650T- G01
- 1 calibrated centering and orientation pin (Art.79) or 1 pull stud for zero point (Art.11A)
- 2 positioning key-nuts Art.297 ■ 2 self-centering key-nuts Art.650G ■ 1 workshop Art.370

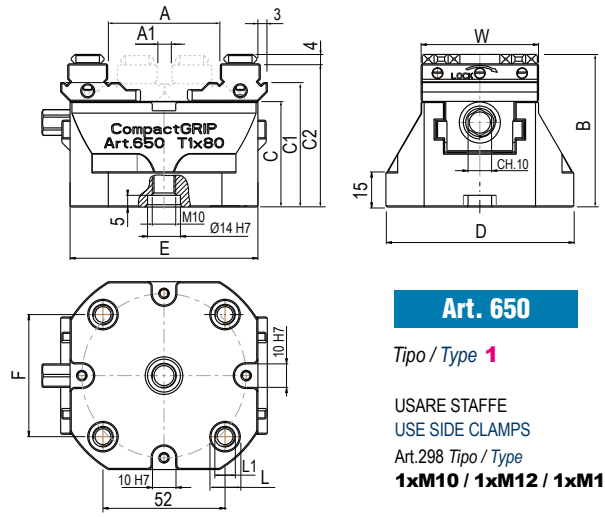

**Art. 650**

Tipo / Type **1**

USARE STAFFE  
USE SIDE CLAMPS

Art.298 Tipo / Type  
**1xM10 / 1xM12 / 1xM16**

|      |            | 2<br>22 kN |            |            |  |
|------|------------|------------|------------|------------|--|
| kN   |            | 22 kN      |            |            |  |
| A    | 96         | 136        | 176        | 216        |  |
| A1   |            | 10         |            |            |  |
| W    |            | 88         |            |            |  |
| B    |            | 65         |            |            |  |
| C    |            | 38         |            |            |  |
| C1   |            | 51         |            |            |  |
| C2   |            | 61         |            |            |  |
| D    |            | 90         |            |            |  |
| E    | 120        | 160        | 200        | 240        |  |
| F    |            | 52         |            |            |  |
| L    |            | 12         |            |            |  |
| L1   |            | M8         |            |            |  |
| kg   | 3,6        | 4,4        | 5,2        | 5,8        |  |
| Cod. | 7.65.02120 | 7.65.02160 | 7.65.02200 | 7.65.02240 |  |

|      |            | 3<br>32 kN |            |            |            |  |
|------|------------|------------|------------|------------|------------|--|
|      |            | 32 kN      |            |            |            |  |
| A    | 126        | 176        | 226        | 276        | 326        |  |
| A1   |            | 10         |            |            |            |  |
| W    |            | 123        |            |            |            |  |
| B    |            | 89         |            |            |            |  |
| C    |            | 57         |            |            |            |  |
| C1   |            | 75         |            |            |            |  |
| C2   |            | 85         |            |            |            |  |
| D    |            | 125        |            |            |            |  |
| E    | 160        | 210        | 260        | 310        | 360        |  |
| F    |            | 96         |            |            |            |  |
| L    |            | 16         |            |            |            |  |
| L1   |            | M10        |            |            |            |  |
| kg   | 9,1        | 10,9       | 12,8       | 14,8       | 17         |  |
| Cod. | 7.65.03160 | 7.65.03210 | 7.65.03260 | 7.65.03310 | 7.65.03360 |  |

**Art. 650**

 Tipo / Type **3x310**
**COMPACT GRIP**  
**NEW!**

**UPGRADE YOUR VISE APPLICATIONS THROUGH MODULAR ACCESSORIES !**
**Art. 651H**

 Tipo / Type **2**
**Art. 651H**

Vedi gamma completa - See the complete range Page 7.26 / 7.27

|      |                  |                  |                  |                  |
|------|------------------|------------------|------------------|------------------|
| Cod. | 7.65.1H212 / 100 | 7.65.1H216 / 100 | 7.65.1H220 / 100 | 7.65.1H224 / 100 |
|------|------------------|------------------|------------------|------------------|

 Tipo / Type **3**

|                  |                  |                  |                  |                  |
|------------------|------------------|------------------|------------------|------------------|
| 7.65.1H316 / 100 | 7.65.1H321 / 100 | 7.65.1H326 / 100 | 7.65.1H331 / 100 | 7.65.1H336 / 100 |
|------------------|------------------|------------------|------------------|------------------|

**Art. 660**

 Interasse / Type **52mm**
**Art. 660**

Vedi gamma completa - See the complete range Page 7.28 / 7.29

|      |            |
|------|------------|
| Cod. | 9.66.05200 |
|------|------------|

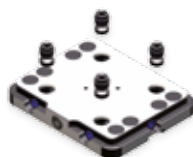
 Tipo / Type **3**

|            |
|------------|
| 9.66.09600 |
|------------|

|      |               |
|------|---------------|
| Cod. | 7.65.0T200/01 |
|------|---------------|

**Art. 650 G01**

 Per materiali di durezza normale  
 For standard workpieces hardness clamping

|               |
|---------------|
| 7.65.0T300/01 |
|---------------|

|      |               |
|------|---------------|
| Cod. | 7.65.0T200/02 |
|------|---------------|

**Art. 650 G02**

 Per materiali di notevole durezza  
 For hardened workpieces clamping

|               |
|---------------|
| 7.65.0T300/02 |
|---------------|

|      |               |
|------|---------------|
| Cod. | 7.65.0T200/11 |
|------|---------------|

**Art. 650 G11**

 Per materiali teneri  
 For soft material clamping

|               |
|---------------|
| 7.65.0T300/11 |
|---------------|

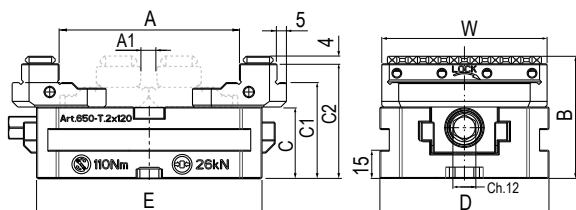
**Art. 650**

 Tipo / Type **2**

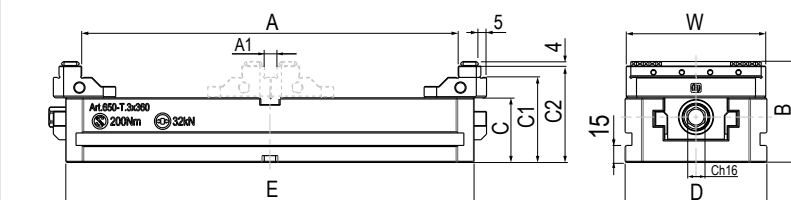
 USARE STAFFE  
 USE SIDE CLAMPS  
 Art.298 Tipo / Type  
**1xM10 / 1xM12 / 1xM16**

**Art. 650**

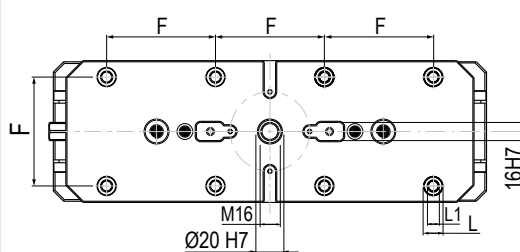
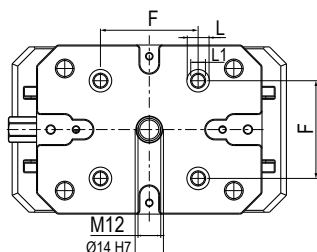
 Tipo / Type **3**

 USARE STAFFE  
 USE SIDE CLAMPS  
 Art.298 Tipo / Type  
**1xM10 / 1xM12 / 1xM16**



**Art. 650**

Tipo / Type 1

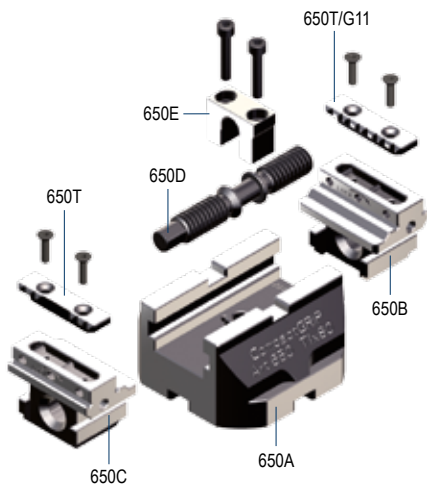
**NEW!**

| Tipo / Type 1  | 1x80             | 1x120             | 1x160       |
|--|------------------|-------------------|-------------|
| <b>Art. 650A</b><br>Corpo base - Base body                                     | Cod. 7.65.0A1080 | 7.65.0A1120       | 7.65.0A1160 |
| <b>Art. 650B</b> *<br>Ganascia integrale destra<br>Solid jaw right hand        | Cod.             | 7.65.0B1000       |             |
| <b>Art. 650C</b> *<br>Ganascia integrale sinistra<br>Solid jaw left hand       | Cod.             | 7.65.0C1000       |             |
| <b>Art. 650D</b><br>Vite di bloccaggio - Main screw                            | Cod. 7.65.0D1080 | 7.65.0D1120       | 7.65.0D1160 |
| <b>Art. 650E</b><br>Forcella - Yoke  | Cod.             | 7.65.0E1000       |             |
| <b>Art. 650T / G11</b><br>Coppia di inserti ganasce<br>Pair of top jaw inserts | Cod.             | 7.65.0T1000 / G11 |             |

**Art. 650**

Tipo / Type 2

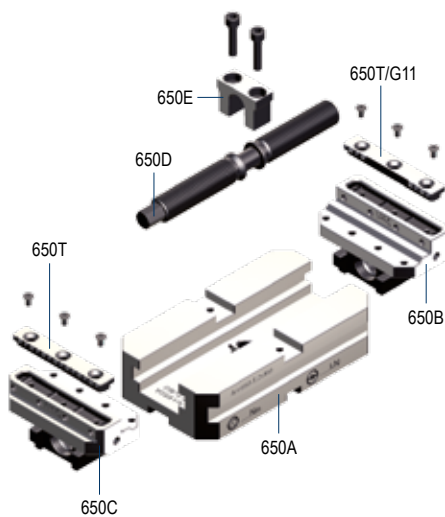
**NEW!**

| Tipo / Type 2  | 2x120            | 2x160             | 2x200       | 2x240       |
|--|------------------|-------------------|-------------|-------------|
| <b>Art. 650A</b><br>Corpo base - Base body                                     | Cod. 7.65.0A2120 | 7.65.0A2160       | 7.65.0A2200 | 7.65.0A2240 |
| <b>Art. 650B</b> *<br>Ganascia integrale destra<br>Solid jaw right hand        | Cod.             | 7.65.0B2000       |             |             |
| <b>Art. 650C</b> *<br>Ganascia integrale sinistra<br>Solid jaw left hand       | Cod.             | 7.65.0C2000       |             |             |
| <b>Art. 650D</b><br>Vite di bloccaggio - Main screw                            | Cod. 7.65.0D2120 | 7.65.0D2160       | 7.65.0D2200 | 7.65.0D2240 |
| <b>Art. 650E</b><br>Forcella - Yoke  | Cod.             | 7.65.0E2000       |             |             |
| <b>Art. 650T / G11</b><br>Coppia di inserti ganasce<br>Pair of top jaw inserts | Cod.             | 7.65.0T2000 / G11 |             |             |

**Art. 650**

Tipo / Type 3

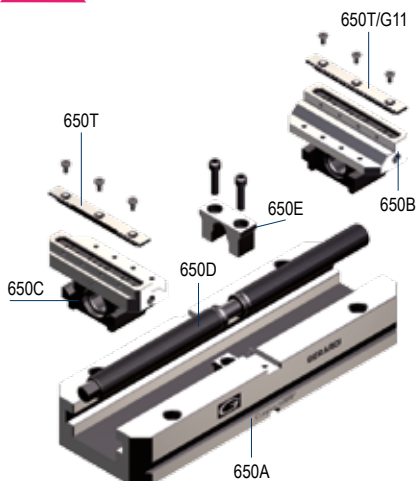
**NEW!**

| Tipo / Type 3  | 3x160            | 3x210           | 3x260       | 3x310       | 3x360       |
|--|------------------|-----------------|-------------|-------------|-------------|
| <b>Art. 650A</b><br>Corpo base - Base body                                     | Cod. 7.65.0A3160 | 7.65.0A3210     | 7.65.0A3260 | 7.65.0A3260 | 7.65.0A3360 |
| <b>Art. 650B</b> *<br>Ganascia integrale destra<br>Solid jaw right hand        | Cod.             | 7.65.0B3000     |             |             |             |
| <b>Art. 650C</b> *<br>Ganascia integrale sinistra<br>Solid jaw left hand       | Cod.             | 7.65.0C3000     |             |             |             |
| <b>Art. 650D</b><br>Vite di bloccaggio - Main screw                            | Cod. 7.65.0D3160 | 7.65.0D3210     | 7.65.0D3260 | 7.65.0D3310 | 7.65.0D3360 |
| <b>Art. 650E</b><br>Forcella - Yoke  | Cod.             | 7.65.0D3000     |             |             |             |
| <b>Art. 650T / G11</b><br>Coppia di inserti ganasce<br>Pair of top jaw inserts | Cod.             | 7.65.0T3000/G11 |             |             |             |

# ACCESSORI PER MORSE COMPACT GRIP Art.650

## Art.650 COMPACT GRIP VISES ACCESSORIES

**COMPACT GRIP**  
**NEW!**

Coppie di inserti ganasce - Pair of top jaw inserts

1

2

3

### Art. 650S

**LISCI + RUVIDI - SMOOTH + ROUGH**

Materiali teneri e lavorazioni finali  
Soft material clamping and final machining

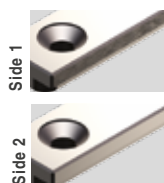

Cod. 7.65.0S100 7.65.0S200 7.65.0S300



### Art. 650R

**CODA DI RONDINE - DOVE TAIL**

Miglior presa pezzo  
Best workpiece clamping

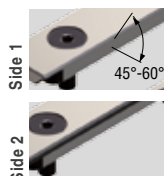

Cod. 7.65.0R100 7.65.0R200 7.65.0R300



### Art. 650T G01

**GRIP (Passo - Pitch 1,5mm)**

Per materiali di durezza normale  
For standard workpieces hardness clamping

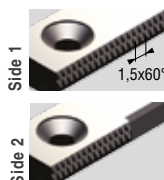

Cod. 7.65.0T100/G01 7.65.0T200/G01 7.65.0T300/G01



### Art. 650T G02

**GRIP (Passo - Pitch 2mm)**

Per materiali di notevole durezza  
For hardened workpieces clamping

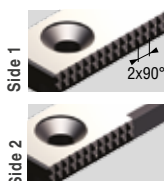

Cod. 7.65.0T100/G02 7.65.0T200/G02 7.65.0T300/G02



### Art. 650T G11

**GRIP (Passo - Pitch 11mm)**

Per materiali teneri  
For soft material clamping

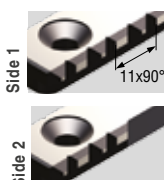

Cod. 7.65.0T100/G11 7.65.0T200/G11 7.65.0T300/G11



### Art. 79

Perno calibrato per centraggio e orientamento  
Calibrated centering and orientation pin

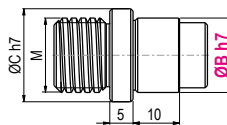

|       |                             |               |               |
|-------|-----------------------------|---------------|---------------|
| ØC h7 | 14                          | 14            | 20            |
| M     | 10                          | 12            | 16            |
| ØB    | 10 - 12 - 14 - 16 - 18 - 20 |               |               |
| Cod.  | 7.79.14M10/ØB               | 7.79.14M12/ØB | 7.79.20M16/ØB |

### Art. 297

Coppia di tasselli di posizionamento  
completi di vite M5 x 10  
Pair of positioning key-nuts with M5 x 10 clamping screw

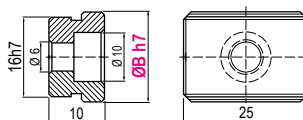

|          |   |
|----------|---|
| <b>B</b> | 10 - 12 - 14 - 16 - 18 - 20 - 22 - 24 - 28 - 36 |
| Cod.     | 2.29.71000                                      |

### Art. 650G

Coppia di tasselli di posizionamento  
e regolazione autocentrante  
Pair of key-nuts for positioning  
and self-centering

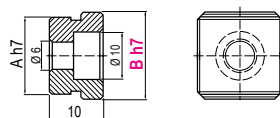

|          |   |             |
|----------|---|-------------|
| <b>A</b> | 10  | 16          |
| <b>B</b> | 10 - 12 - 14 - 16 - 18 - 20 - 22 - 24 - 28 - 36 |             |
| Cod.     | 7.65.0G1000                                     | 7.65.0G2000 |

Specificare sempre quota B - Specify always B dimension

### Art. 298 / CGR

Staffa per Compact Grip  
Compact Grip holding clamp

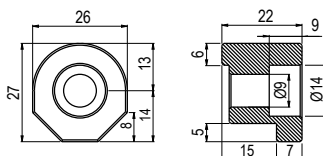

Cod. 7.29.81000/CGR

Tipo (grandezza) morsa / Vise (type) size

| kN   | 2          |            |            |            |
|------|------------|------------|------------|------------|
|      | 22 kN      |            |            |            |
| A    | 30         | 70         | 110        | 150        |
| W    | 128        |            |            |            |
| B    | 93         |            |            |            |
| C    | 38         |            |            |            |
| C1   | 53         |            |            |            |
| D    | 90         |            |            |            |
| E    | 120        | 160        | 200        | 240        |
| F    | 52         |            |            |            |
| G    | 49         |            |            |            |
| L    | Ø12        |            |            |            |
| L1   | M8         |            |            |            |
| kg   | 7,9        | 8,7        | 9,5        | 10,1       |
| Cod. | 7.95.02120 | 7.95.02160 | 7.95.02200 | 7.95.02240 |

**Art. 950**

 Tipo / Type **2x160**

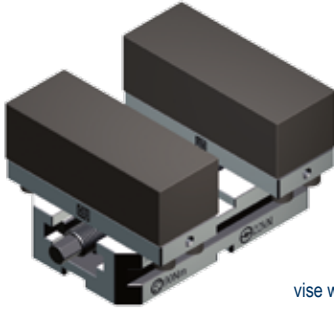
 Morsa Autocentrante Compact Grip con ganasce **lavorabili in acciaio**, ideale per centri a 5 assi

**COMPACT GRIP**  
**NEW!**

 Self-centering Compact Grip vise with **machineable steel jaws**, Ideal for five axis centres.

**AMPLIA LE TUE APPLICAZIONI TRAMITE GLI ACCESSORI MODULARI !**
**Art. 651H**

 Tipo / Type **2**

 Rialzo Semplice  
 Simple Riser

Vedi gamma completa - See the complete range Page 7.26 / 7.27

|      |                  |                  |                  |                  |
|------|------------------|------------------|------------------|------------------|
| Cod. | 7.65.1H212 / 100 | 7.65.1H216 / 100 | 7.65.1H220 / 100 | 7.65.1H224 / 100 |
|------|------------------|------------------|------------------|------------------|

**Art. 660**

 Interasse / Type **52 mm**

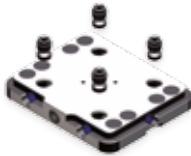
 Tavola cambio rapido  
 Quick change table

Vedi gamma completa - See the complete range Page 7.28 / 7.29

|      |            |  |  |  |
|------|------------|--|--|--|
| Cod. | 9.66.05200 |  |  |  |
|------|------------|--|--|--|

**Art. 950B**

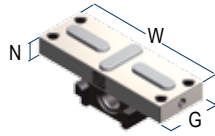
 Slitta **DESTRA** con chiavette  
 Solid hardened slide **RIGHT HAND** with positioning key nuts

|      |             |  |  |  |
|------|-------------|--|--|--|
| Cod. | 7.95.0B2000 |  |  |  |
|------|-------------|--|--|--|

**Art. 950C**

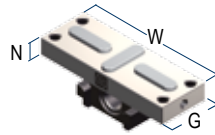
 Slitta **SINISTRA** con chiavette  
 Solid hardened slide **LEFT HAND** with positioning key nuts

|      |             |  |  |  |
|------|-------------|--|--|--|
| Cod. | 7.95.0C2000 |  |  |  |
|------|-------------|--|--|--|

**Art. 950D**

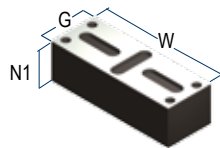
 Ganasce lavorabile in acciaio  
 Machineable steel jaw

|      |             |  |  |  |
|------|-------------|--|--|--|
| Cod. | 7.95.0D2000 |  |  |  |
|------|-------------|--|--|--|

**Dotazione standard:**

- 1 chiave a pipa Art.375 ■ 1 coppia di inserti extra Art.650T ■ 1 perno calibrato per centraggio e orientamento Art.79 oppure 1 tirante zero point Art.11S
- 1 arresto laterale Art.370 ■ 2 tasselli di posizionamento Art.297
- 2 tasselli per regolazione autocentrante Art.650G

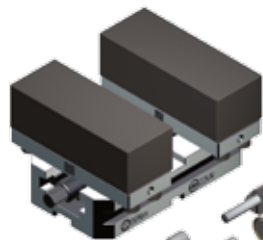
**Art. 950**

Art. 370 / EM

 Art. 297  
 Art. 650G

 Art.79 or Art.11S  
 (a scelta / to be choosen)

Art. 375

**Standard equipment:**

- 1 box wrench Art.375 ■ 1 extra pair of top jaw inserts Art.650T- G01
- 1 calibrated centering and orientation pin (Art.79) or 1 pull stud for zero point (Art.11A)
- 2 positioning key-nuts Art.297 ■ 2 self-centering key-nuts Art.650G ■ 1 workstop Art.370

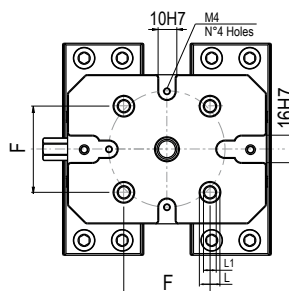
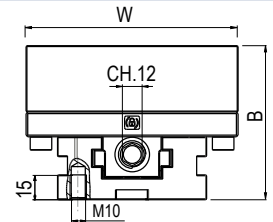
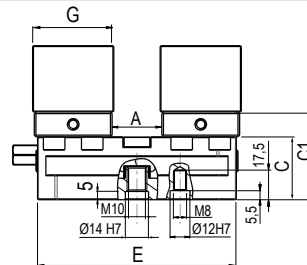
**Art. 950**

 Tipo / Type **2**

 USARE STAFFE  
 USE SIDE CLAMPS

 Art.298 Tipo / Type  
**1xM10 / 1xM12 / 1xM16**



MADE IN ITALY

Tipo (grandezza) morsa / Vise (type) size

3

| kN   | 32 kN      |            |            |            |            |
|------|------------|------------|------------|------------|------------|
| A    | 40         | 90         | 130        | 180        | 230        |
| W    | 160        |            |            |            |            |
| B    | 124        |            |            |            |            |
| C    | 57         |            |            |            |            |
| C1   | 77         |            |            |            |            |
| D    | 125        |            |            |            |            |
| E    | 160        | 210        | 260        | 310        | 360        |
| F    | 96         |            |            |            |            |
| G    | 59         |            |            |            |            |
| L    | Ø16        |            |            |            |            |
| L1   | M10        |            |            |            |            |
| kg   | 16.9       | 18.7       | 20.6       | 22.6       | 24.8       |
| Cod. | 7.95.03160 | 7.95.03210 | 7.95.03260 | 7.95.03310 | 7.95.03360 |

## Art. 950

Tipo / Type **3x360**

Morsa Autocentrante Compact Grip con ganasce **lavorabili in acciaio**, ideale per centri a 5 assi

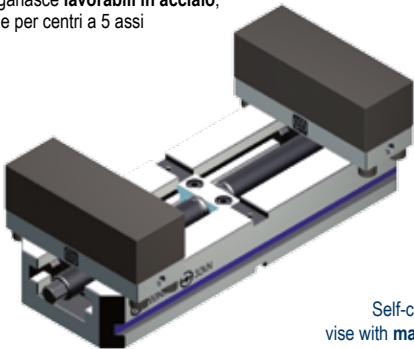

**COMPACT GRIP**  
**NEW!**

Self-centering Compact Grip vise with **machineable steel jaws**, Ideal for five axis centres.

### UPGRADE YOUR VISE APPLICATIONS THROUGH MODULAR ACCESSORIES !

#### Art. 651H

Tipo / Type **3**

Rialzo Semplice  
Simple Riser



Vedi gamma completa - See the complete range Page 7.26 / 7.27

Cod. 7.65.1H316 / 100 7.65.1H321 / 100 7.65.1H326 / 100 7.65.1H331 / 100 7.65.1H336 / 100

#### Art. 660

Interasse / Type **96 mm**

Tavola cambio rapido  
Quick change table

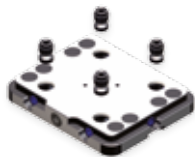

Vedi gamma completa - See the complete range Page 7.28 / 7.29

Cod. 9.66.09600

#### Art. 950B

Slitta **DESTRA** con chiavette  
Solid hardened slide **RIGHT HAND** with positioning key nuts

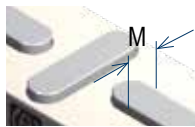

Cod. 7.95.0B3000

#### Art. 950C

Slitta **SINISTRA** con chiavette  
Solid hardened slide **LEFT HAND** with positioning key nuts



Cod. 7.95.0C3000

#### Art. 950D

Machineable steel jaw



Cod. 7.95.0D3000

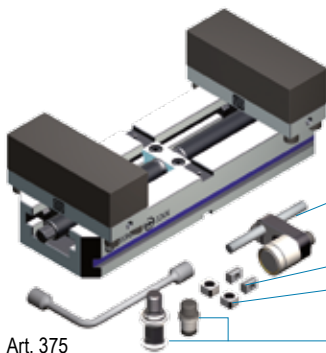

Art. 950

Art. 370 / EM

Art. 297

Art. 650G

Art.79 or Art.11S  
(a scelta / to be chosen)

Art. 375

#### Standard equipment:

- 1 box wrench Art.375 ■ 1 extra pair of top jaw inserts Art.650T- G01
- 1 calibrated centering and orientation pin (Art.79) or 1 pull stud for zero point (Art.11A)
- 2 positioning key-nuts Art.297 ■ 2 self-centering key-nuts Art.650G ■ 1 workshop Art.370

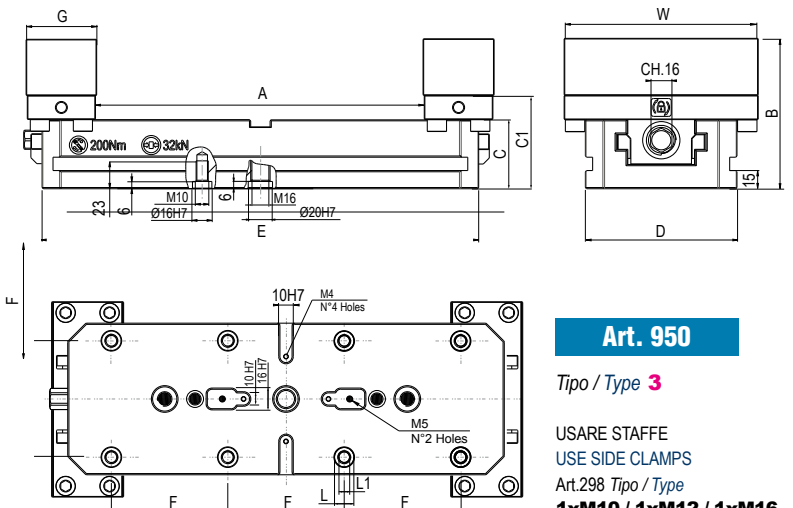

#### Art. 950

Tipo / Type **3**

USARE STAFFE  
USE SIDE CLAMPS

Art.298 Tipo / Type

**1xM10 / 1xM12 / 1xM16**