

COMPACT TILTING ROTARY TABLE

NIKKEN

- Rotary and tilting axes are controlled by CNC
- Various kinds of attachments



5AX-130FA

MOTOR MOUNTED		FACE PLATE		M-SIGNAL METHOD			
R RIGHT HAND	L LEFT HAND	WITH FACE PLATE	W/O FACE PLATE	α21 CTRL P.59	EZ CTRL P.69	ADD. AXIS P.57	ACCURACY SPEC. P.99
ROTARY JOINT P.89	ULTRA PRECISION P.87	SUPPORT TABLE P.79	TAIL STOCK P.81	SCROLL CHUCK P.83	POWER CHUCK P.84	CLAMP DEVICE P.85	T-NUT P.86



Specifications

Item / Code No.		5AX-130		5AX-201	
Diameter of Table		φ105(with φ130 sub table)		200	
Diameter of Spindle Hole		φ60H7 φ30		φ60H7 φ50	
Center Height (90°)		150		180	
Table Height in Horizontal Position (0°)		235		260	
Width of T Slot		φ10H7 Pin hole		12 ^{+0.018} ₀	
Axis		Rotary	Tilting (0°~105°)	Rotary	Tilting (0°~105°)
Clamping System		Pneumatic*2	Pneumatic*2	Pneumatic*1*2/ Hydraulic	Pneumatic*1*2/ Hydraulic
Clamping Torque		205	303	303*1*2/ 588	303*1*2/ 612
Table Inertia at Motor Shaft $(\frac{GD^2}{4})$		0.09	0.12	0.11	0.16
Servo Motor		α iF2·3000	α iF2·3000	α iF2·2000	α iS4·2000
MIN. Increment		0.001°	0.001°	0.001°	0.001°
Rotation Speed		33.3	16.6	22.2	16.6
Total Reduction Ratio		1/90	1/180	1/90	1/120
Indexing Accuracy		±30	60	20	60
Net Weight		115		160	
MAX. Work Load on the Table	0° to 30°	50		60	
	30° to 90°	20		40	
MAX. Thrust Load applicable on the Table	Tilting Angle = 0°	5880		9800	
	Tilting Angle = 0°	L=65mm F=2940N		L=100mm F=4900N	
	Tilting Angle = 90°	L ₁ =0mm F ₁ =3460N L ₂ =100mm F ₂ =1590N		L ₁ =0mm F ₁ =588N L ₂ =100mm F ₂ =2940N	
	Tilting Angle = 90°	98		382	
MAX. Work Inertia		0.12		0.5	
Driving Torque		72		72	

*1 Air brake system is also available for 5AX-201.

*2 Air Intensifying Booster system is available if the supplied air pressure is under 0.5MPa or the brake torque is required to increase. P.95

*Location of tilting axis motor can be changed as an option. e.g. 5AX-B130.

5AX-130, 5AX-201



External dimensions depend on the type of the servo motor. Indicated dimensions are in case of FANUC. Please contact us for CAD files (2D:DXF, 3D:PARASOLID).

5AX-130

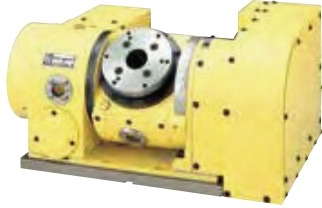
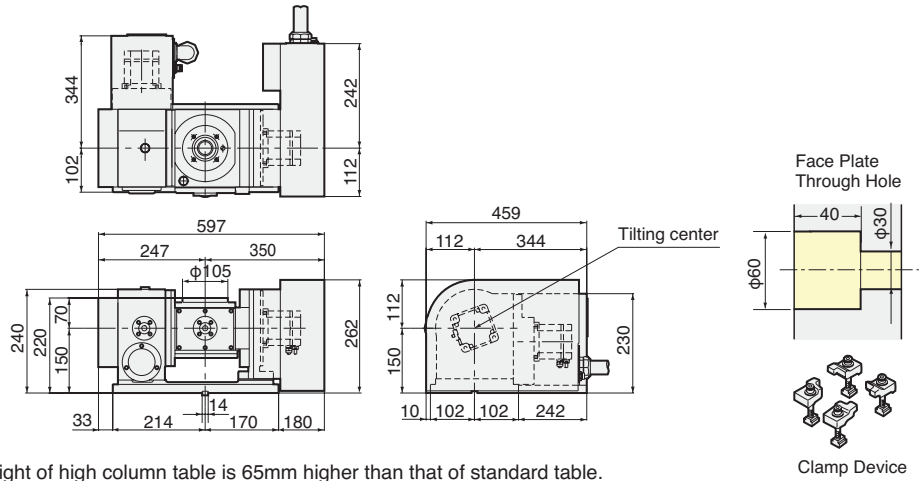

Photo with $\phi 130\text{mm}$ plate.



Center height of high column table is 65mm higher than that of standard table.



5AX-201

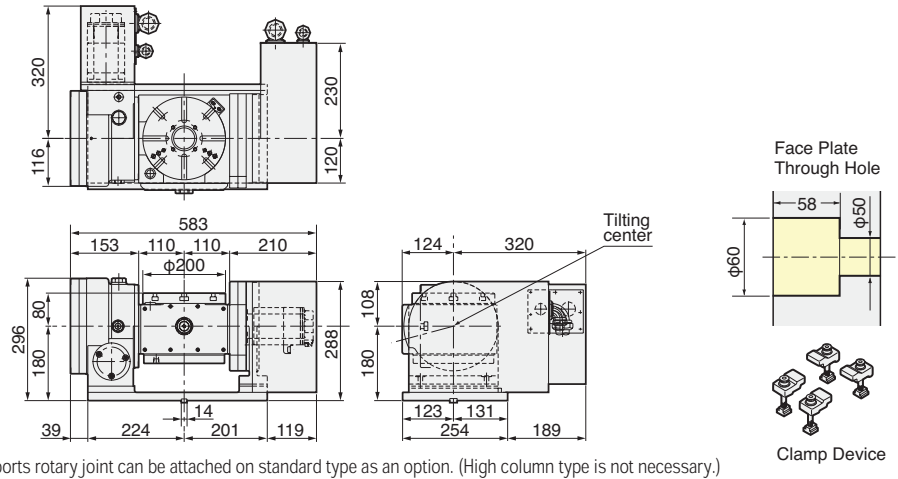
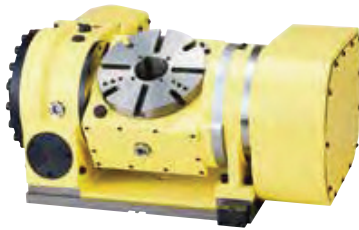

Built-in type 4 ports rotary joint can be attached on standard type as an option. (High column type is not necessary.)



The Area of Noninterference in Tilting Position.

Angle	5AX-130	5AX-201
0°		
45°		
90°		
105°		

5AX-130BA The tilting axis motor is mounted at back side.

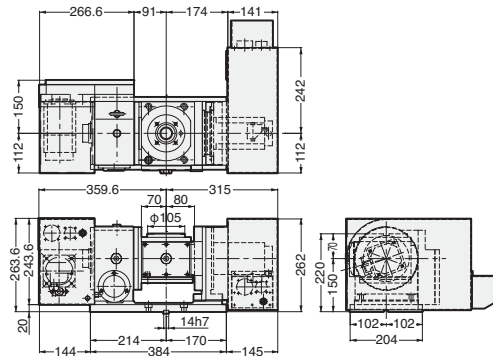

5AX-201BAFA The tilting axis motor is mounted at back side.

